

LOCATION DRAWING

WILLMANN PC G16-27D

SECTION: 16
TOWNSHIP: 4N
RANGE: 65W

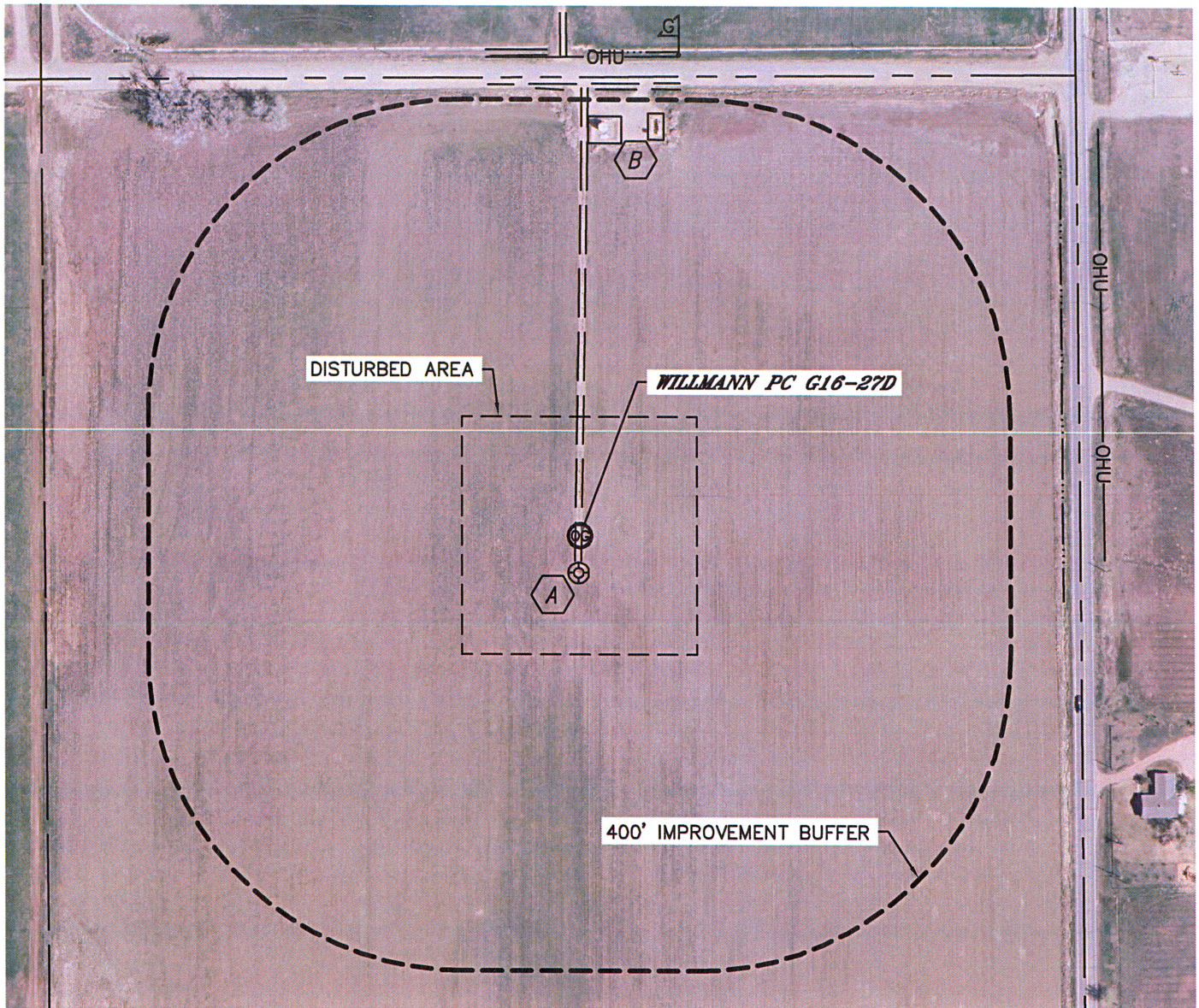

IMPROVEMENTS:



EX. WILLMAN H 41-16 47' SOUTH



EX. PRODUCTION FACILITY (NOBLE) 501' NORTH

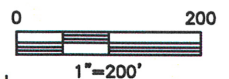

NEAREST: BUILDING 786' SE, PUBLIC ROAD 569' NORTH (CR 46),
ABOVE GROUND UTILITY 604' NORTH, RAILROAD 5280'+, PROPERTY LINE 578' NORTH