



KERR MCGEE OIL & GAS ONSHORE LP

Location: COLORADO Slot: SLOT#05 WINTERS 29-3 (1895'FNL & 517'FWL)
Field: WELD COUNTY (KERR MCGEE) Well: WINTERS 29-3
Facility: SEC.03-T5N-R65W Wellbore: WINTERS 29-3 PWB

Plus reference wellpath is WINTERS 29-3 (REV-8.0) PWP	Grid System: NAD83 / Lambert Colorado State Planes, Northern Zone (501), US feet
True vertical depths are referenced to XTREME 6 (RKB)	North Reference: True north
Measured depths are referenced to XTREME 6 (RKB)	Scale: True distance
XTREME 6 (RKB) to Mean Sea Level: 4674 feet	Depths are in feet
Mean Sea Level to Mud line (Facility: SEC.03-T5N-R65W): 0 feet	Created by: cookdann on 2/3/2011
Coordinates are in feet referenced to Slot	



INTEQ

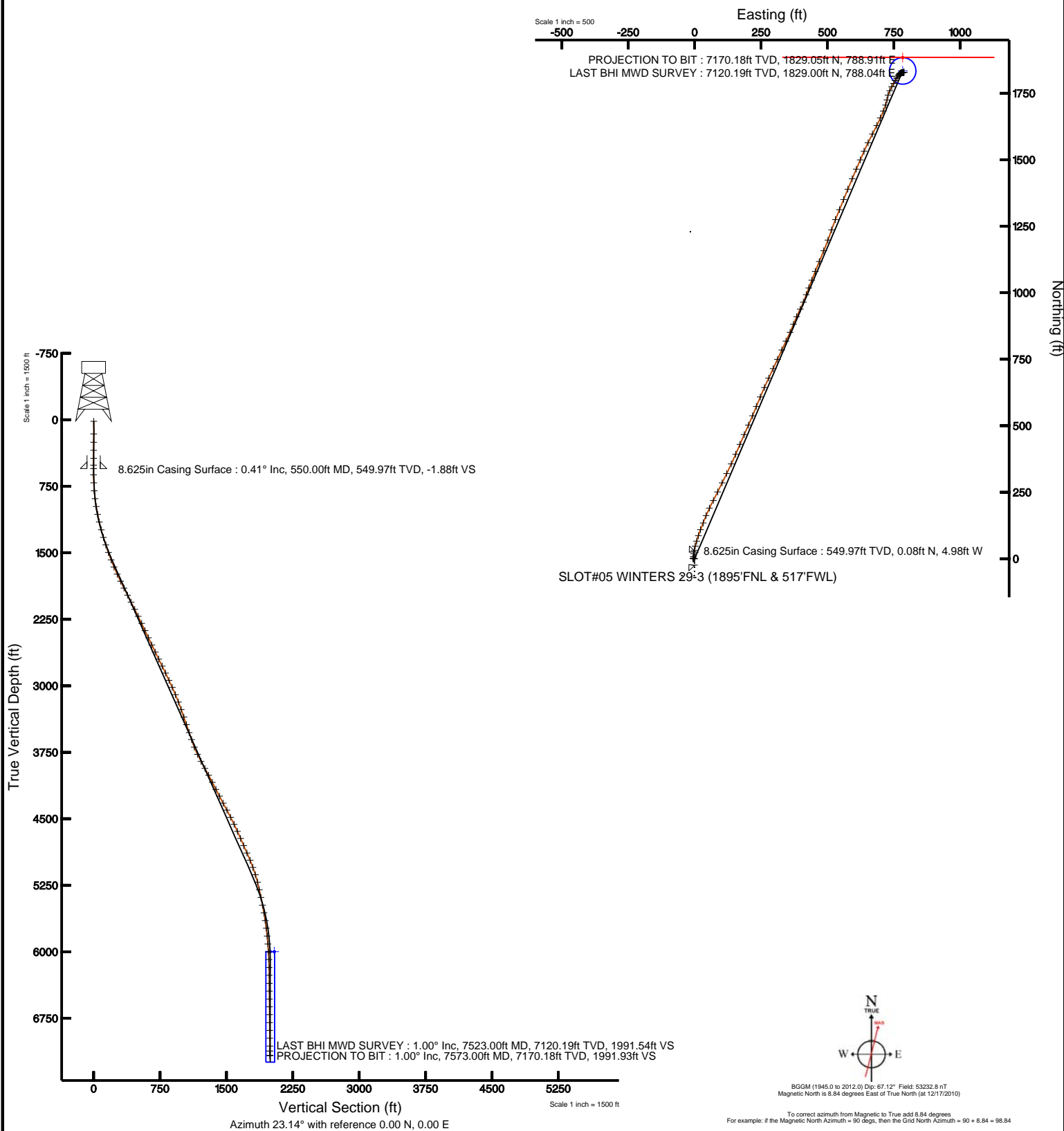



Actual Wellpath Report

WINTERS 29-3 AWP

Page 1 of 5



INTEQ

REFERENCE WELLPATH IDENTIFICATION

Operator	KERR MCGEE OIL & GAS ONSHORE LP	Slot	SLOT#05 WINTERS 29-3 (1895'FNL & 517'FWL)
Area	COLORADO	Well	WINTERS 29-3
Field	WELD COUNTY (KERR MCGEE)	Wellbore	WINTERS 29-3 AWB
Facility	SEC.03-T5N-R65W		

REPORT SETUP INFORMATION

Projection System	NAD83 / Lambert Colorado State Planes, Northern Zone (501), US feet	Software System	WellArchitect® 2.0
North Reference	True	User	Cookdanm
Scale	0.999962	Report Generated	2/3/2011 at 12:16:06 PM
Convergence at slot	0.54° East	Database/Source file	Denver Server/WINTERS_29-3_AWB.xml

WELLPATH LOCATION

	Local coordinates		Grid coordinates		Geographic coordinates	
	North[ft]	East[ft]	Easting[USft]	Northing[USft]	Latitude	Longitude
Slot Location	64.12	1.39	3234694.50	1400646.54	40°25'48.410"N	104°39'24.966"W
Facility Reference Pt			3234693.72	1400582.41	40°25'47.777"N	104°39'24.984"W
Field Reference Pt			3197771.84	1268891.29	40°04'09.600"N	104°47'36.000"W

WELLPATH DATUM

Calculation method	Minimum curvature	XTREME 6 (RKB) to Facility Vertical Datum	4674.00ft
Horizontal Reference Pt	Slot	XTREME 6 (RKB) to Mean Sea Level	4674.00ft
Vertical Reference Pt	XTREME 6 (RKB)	Facility Vertical Datum to Mud Line (Facility)	0.00ft
MD Reference Pt	XTREME 6 (RKB)	Section Origin	N 0.00, E 0.00 ft
Field Vertical Reference	Mean Sea Level	Section Azimuth	23.14°



Actual Wellpath Report

WINTERS 29-3 AWP

Page 2 of 5



REFERENCE WELLPATH IDENTIFICATION

Operator	KERR MCGEE OIL & GAS ONSHORE LP	Slot	SLOT#05 WINTERS 29-3 (1895'FNL & 517'FWL)
Area	COLORADO	Well	WINTERS 29-3
Field	WELD COUNTY (KERR MCGEE)	Wellbore	WINTERS 29-3 AWP
Facility	SEC.03-T5N-R65W		

WELLPATH DATA (87 stations) † = interpolated/extrapolated station

MD [ft]	Inclination [°]	Azimuth [°]	TVD [ft]	Vert Sect [ft]	North [ft]	East [ft]	DLS [°/100ft]	Comments
0.00†	0.000	274.000	0.00	0.00	0.00	0.00	0.00	
16.00	0.000	274.000	16.00	0.00	0.00	0.00	0.00	
158.00	0.800	274.000	158.00	-0.33	0.07	-0.99	0.56	
252.00	0.700	272.000	251.99	-0.75	0.13	-2.22	0.11	
343.00	0.500	298.000	342.98	-0.91	0.34	-3.12	0.37	
433.00	0.600	267.600	432.98	-1.08	0.51	-3.94	0.34	
510.00	0.600	238.100	509.97	-1.59	0.28	-4.69	0.40	
620.00	0.100	206.400	619.97	-2.16	-0.11	-5.22	0.47	
711.00	2.400	360.000	710.95	-0.48	1.72	-5.25	2.74	
800.00	5.500	4.300	799.72	5.27	7.84	-4.93	3.50	
890.00	7.700	8.900	889.12	15.20	18.10	-3.68	2.51	
980.00	9.200	9.700	978.14	28.04	31.15	-1.53	1.67	
1069.00	12.000	14.200	1065.62	44.10	47.13	1.94	3.28	
1158.00	13.000	19.100	1152.51	63.23	65.56	7.48	1.64	
1248.00	14.900	16.200	1239.85	84.81	86.24	14.02	2.25	
1337.00	16.500	22.000	1325.53	108.81	108.95	21.95	2.52	
1427.00	18.700	22.000	1411.32	136.02	134.18	32.15	2.44	
1517.00	20.000	21.200	1496.23	165.83	161.91	43.12	1.47	
1606.00	20.400	27.100	1579.76	196.51	189.91	55.69	2.33	
1693.00	23.000	27.500	1660.59	228.59	218.49	70.45	2.99	
1781.00	25.500	26.000	1740.82	264.66	250.77	86.69	2.93	
1869.00	26.100	26.300	1820.05	302.91	285.15	103.57	0.70	
1956.00	26.900	26.100	1897.91	341.67	319.98	120.71	0.93	
2045.00	26.700	25.000	1977.35	381.76	356.18	138.02	0.60	
2134.00	26.700	24.000	2056.86	421.74	392.57	154.60	0.50	
2224.00	27.000	23.000	2137.16	462.39	429.85	170.81	0.60	
2313.00	26.500	24.000	2216.63	502.44	466.58	186.78	0.76	
2402.00	25.600	24.300	2296.59	541.52	502.25	202.77	1.02	
2491.00	25.300	23.300	2376.95	579.76	537.24	218.20	0.59	
2581.00	24.700	21.200	2458.52	617.79	572.43	232.61	1.19	
2671.00	25.800	23.600	2539.92	656.17	607.91	247.25	1.67	
2760.00	25.800	23.600	2620.05	694.90	643.41	262.76	0.00	
2848.00	26.700	25.700	2698.98	733.81	678.77	279.00	1.47	
2936.00	26.900	25.000	2777.53	773.45	714.63	295.98	0.42	
3024.00	25.100	24.700	2856.62	812.01	749.63	312.20	2.05	
3115.00	25.100	24.700	2939.02	850.60	784.70	328.33	0.00	
3202.00	25.100	26.100	3017.81	887.47	818.04	344.16	0.68	
3292.00	22.700	24.300	3100.09	923.90	851.01	359.70	2.79	
3382.00	20.100	19.800	3183.88	956.71	881.40	372.09	3.41	
3471.00	20.800	26.400	3267.28	987.76	909.95	384.30	2.71	
3562.00	19.300	25.700	3352.76	1018.92	937.97	398.01	1.67	
3653.00	17.900	21.900	3439.01	1047.92	964.50	409.75	2.03	
3747.00	19.700	19.800	3528.00	1078.19	992.81	420.50	2.05	
3830.00	18.600	21.500	3606.40	1105.38	1018.29	430.09	1.49	
3921.00	21.300	21.200	3691.93	1136.41	1047.21	441.39	2.97	



Actual Wellpath Report

WINTERS 29-3 AWP

Page 3 of 5



INTEQ

REFERENCE WELLPATH IDENTIFICATION

Operator	KERR MCGEE OIL & GAS ONSHORE LP	Slot	SLOT#05 WINTERS 29-3 (1895'FNL & 517'FWL)
Area	COLORADO	Well	WINTERS 29-3
Field	WELD COUNTY (KERR MCGEE)	Wellbore	WINTERS 29-3 AWB
Facility	SEC.03-T5N-R65W		

WELLPATH DATA (87 stations)

MD [ft]	Inclination [°]	Azimuth [°]	TVD [ft]	Vert Sect [ft]	North [ft]	East [ft]	DLS [°/100ft]	Comments
4010.00	25.800	21.900	3773.50	1171.95	1080.27	454.47	5.07	
4099.00	28.100	22.600	3852.83	1212.28	1117.59	469.75	2.61	
4189.00	29.900	22.200	3931.54	1255.91	1157.93	486.37	2.01	
4278.00	28.000	21.200	4009.42	1298.97	1197.95	502.31	2.20	
4367.00	26.700	18.000	4088.47	1339.77	1236.45	516.04	2.20	
4457.00	27.700	22.000	4168.52	1380.82	1275.08	530.13	2.31	
4544.00	27.600	23.000	4245.59	1421.19	1312.38	545.58	0.55	
4633.00	28.000	21.900	4324.32	1462.70	1350.74	561.43	0.73	
4722.00	28.000	22.600	4402.90	1504.48	1389.41	577.25	0.37	
4813.00	27.300	23.000	4483.51	1546.70	1428.34	593.61	0.80	
4901.00	26.100	23.300	4562.12	1586.24	1464.70	609.15	1.37	
4990.00	24.400	22.600	4642.62	1624.21	1499.65	623.96	1.94	
5077.00	23.500	25.000	4722.13	1659.51	1531.97	638.20	1.52	
5166.00	23.300	26.100	4803.81	1694.83	1563.85	653.44	0.54	
5257.00	24.400	26.800	4887.04	1731.56	1596.79	669.83	1.25	
5346.00	23.000	26.400	4968.53	1767.27	1628.78	685.86	1.58	
5433.00	20.000	25.000	5049.47	1799.11	1657.49	699.70	3.50	
5520.00	17.600	22.600	5131.82	1827.14	1683.12	711.05	2.90	
5607.00	14.400	18.700	5215.44	1851.08	1705.52	719.57	3.88	
5694.00	12.200	8.900	5300.11	1870.79	1724.86	724.46	3.61	
5784.00	11.900	17.600	5388.14	1889.24	1743.10	728.74	2.04	
5873.00	11.300	24.000	5475.32	1907.09	1759.81	735.06	1.59	
5962.00	10.500	29.900	5562.72	1923.87	1774.81	742.65	1.54	
6049.00	8.700	28.900	5648.50	1938.29	1787.44	749.79	2.08	
6136.00	7.100	28.900	5734.67	1950.18	1797.91	755.56	1.84	
6225.00	5.800	28.900	5823.10	1960.13	1806.66	760.40	1.46	
6315.00	4.700	32.800	5912.72	1968.29	1813.74	764.59	1.28	
6404.00	3.500	38.300	6001.50	1974.51	1818.94	768.25	1.42	
6491.00	2.400	38.400	6088.38	1978.83	1822.45	771.03	1.26	
6580.00	1.500	57.400	6177.33	1981.59	1824.54	773.17	1.23	
6668.00	1.100	61.600	6265.30	1983.20	1825.56	774.88	0.47	
6759.00	0.500	81.600	6356.30	1984.09	1826.03	776.04	0.72	
6848.00	0.800	70.000	6445.29	1984.72	1826.30	777.01	0.37	
6936.00	0.800	84.100	6533.28	1985.44	1826.58	778.20	0.22	
7024.00	0.800	67.900	6621.27	1986.17	1826.87	779.38	0.26	
7113.00	1.000	63.700	6710.26	1987.20	1827.45	780.65	0.24	
7203.00	1.100	80.600	6800.25	1988.27	1827.94	782.21	0.36	
7290.00	1.100	79.200	6887.23	1989.18	1828.23	783.85	0.03	
7378.00	1.000	76.000	6975.22	1990.12	1828.57	785.42	0.13	
7467.00	1.100	81.300	7064.20	1991.04	1828.89	787.02	0.16	
7523.00	1.000	86.600	7120.19	1991.54	1829.00	788.04	0.25	LAST BHI MWD SURVEY
7573.00	1.000	86.600	7170.18	1991.93	1829.05	788.91	0.00	PROJECTION TO BIT



Actual Wellpath Report

WINTERS 29-3 AWP

Page 4 of 5



INTEQ

REFERENCE WELLPATH IDENTIFICATION			
Operator	KERR MCGEE OIL & GAS ONSHORE LP	Slot	SLOT#05 WINTERS 29-3 (1895'FNL & 517'FWL)
Area	COLORADO	Well	WINTERS 29-3
Field	WELD COUNTY (KERR MCGEE)	Wellbore	WINTERS 29-3 AWB
Facility	SEC.03-T5N-R65W		

HOLE & CASING SECTIONS Ref Wellbore: WINTERS 29-3 AWB Ref Wellpath: WINTERS 29-3 AWP									
String/Diameter	Start MD [ft]	End MD [ft]	Interval [ft]	Start TVD [ft]	End TVD [ft]	Start N/S [ft]	Start E/W [ft]	End N/S [ft]	End E/W [ft]
12.25in Open Hole	16.00	565.00	549.00	16.00	564.97	0.00	0.00	0.03	-5.06
8.625in Casing Surface	16.00	550.00	534.00	16.00	549.97	0.00	0.00	0.08	-4.98
7.875in Open Hole	550.00	7573.00	7023.00	549.97	7170.18	0.08	-4.98	1829.05	788.91

TARGETS									
Name	MD [ft]	TVD [ft]	North [ft]	East [ft]	Grid East [srv ft]	Grid North [srv ft]	Latitude	Longitude	Shape
WINTERS 29-3 GEO TARGET 50' RADIUS (50'FNL & 1270'FWL, REV-1)		6000.00	1834.33	783.91	3235460.90	1402488.17	40°26'06.536"N	104°39'14.828"W	circle
WINTERS 29-3 HARDLINE 50'N OF GEO TARGET		6000.00	1884.33	783.91	3235460.43	1402538.16	40°26'07.030"N	104°39'14.828"W	point

WELLPATH COMPOSITION Ref Wellbore: WINTERS 29-3 AWB Ref Wellpath: WINTERS 29-3 AWP				
Start MD [ft]	End MD [ft]	Positional Uncertainty Model	Log Name/Comment	Wellbore
16.00	510.00	NaviTrak (Standard)	BHI MWD SURVEY 12.25 HOLE <158-510>	WINTERS 29-3 AWB
510.00	7523.00	NaviTrak (Standard)	BHI MWD SURVEY 7.875 HOLE <620-7523>	WINTERS 29-3 AWB
7523.00	7573.00	Blind Drilling (std)	Projection to bit	WINTERS 29-3 AWB



Actual Wellpath Report

WINTERS 29-3 AWP

Page 5 of 5



INTEQ

REFERENCE WELLPATH IDENTIFICATION

Operator	KERR MCGEE OIL & GAS ONSHORE LP	Slot	SLOT#05 WINTERS 29-3 (1895'FNL & 517'FWL)
Area	COLORADO	Well	WINTERS 29-3
Field	WELD COUNTY (KERR MCGEE)	Wellbore	WINTERS 29-3 AWB
Facility	SEC.03-T5N-R65W		

WELLPATH COMMENTS

MD [ft]	Inclination [°]	Azimuth [°]	TVD [ft]	Comment
7523.00	1.000	86.600	7120.19	LAST BHI MWD SURVEY
7573.00	1.000	86.600	7170.18	PROJECTION TO BIT