



KERR MCGEE OIL & GAS ONSHORE LP

Location: COLORADO Slot: SLOT#02 WINTERS 22-3 (1943'FNL & 517'FWL)
Field: WELD COUNTY (KERR MCGEE) Well: WINTERS 22-3
Facility: SEC.03-T5N-R65W Wellbore: WINTERS 22-3 PWB



Plot reference wellpath is WINTERS 22-3 (REV-8.0) PWP	
True vertical depths are referenced to XTREME 6 (RKB)	Grid System: NAD83 / Lambert Colorado State Planes, Northern Zone (501), US feet
Measured depths are referenced to XTREME 6 (RKB)	North Reference: True north
XTREME 6 (RKB) to Mean Sea Level: 4673 feet	Scale: True distance
Mean Sea Level to Mud line (Facility: SEC.03-T5N-R65W): 0 feet	Depths are in feet
Coordinates are in feet referenced to Slot	Created by: cookdamm on 2/3/2011

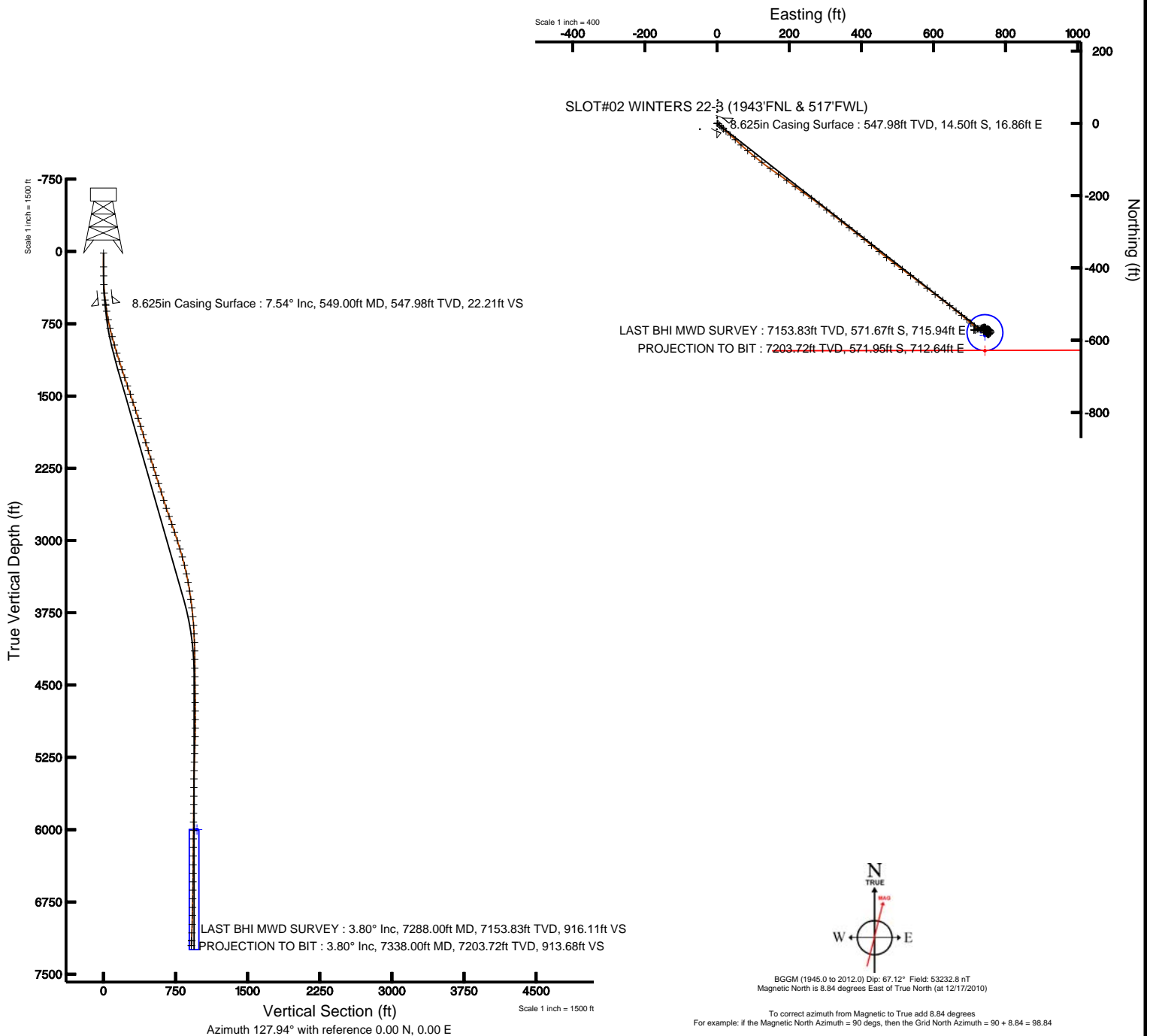



Actual Wellpath Report

WINTERS 22-3 AWP

Page 1 of 5



INTEQ

REFERENCE WELLPATH IDENTIFICATION

Operator	KERR MCGEE OIL & GAS ONSHORE LP	Slot	SLOT#02 WINTERS 22-3 (1943'FNL & 517'FWL)
Area	COLORADO	Well	WINTERS 22-3
Field	WELD COUNTY (KERR MCGEE)	Wellbore	WINTERS 22-3 AWB
Facility	SEC.03-T5N-R65W		

REPORT SETUP INFORMATION

Projection System	NAD83 / Lambert Colorado State Planes, Northern Zone (501), US feet	Software System	WellArchitect® 2.0
North Reference	True	User	Cookdanm
Scale	0.999962	Report Generated	2/3/2011 at 11:44:34 AM
Convergence at slot	0.54° East	Database/Source file	Denver Server/WINTERS_22-3_AWB.xml

WELLPATH LOCATION

	Local coordinates		Grid coordinates		Geographic coordinates	
	North[ft]	East[ft]	Easting[USft]	Northing[USft]	Latitude	Longitude
Slot Location	16.03	0.56	3234694.12	1400598.44	40°25'47.935"N	104°39'24.977"W
Facility Reference Pt			3234693.72	1400582.41	40°25'47.777"N	104°39'24.984"W
Field Reference Pt			3197771.84	1268891.29	40°04'09.600"N	104°47'36.000"W

WELLPATH DATUM

Calculation method	Minimum curvature	XTREME 6 (RKB) to Facility Vertical Datum	4673.00ft
Horizontal Reference Pt	Slot	XTREME 6 (RKB) to Mean Sea Level	4673.00ft
Vertical Reference Pt	XTREME 6 (RKB)	Facility Vertical Datum to Mud Line (Facility)	0.00ft
MD Reference Pt	XTREME 6 (RKB)	Section Origin	N 0.00, E 0.00 ft
Field Vertical Reference	Mean Sea Level	Section Azimuth	127.94°



Actual Wellpath Report

WINTERS 22-3 AWP

Page 2 of 5



INTEQ

REFERENCE WELLPATH IDENTIFICATION

Operator	KERR MCGEE OIL & GAS ONSHORE LP	Slot	SLOT#02 WINTERS 22-3 (1943'FNL & 517'FWL)
Area	COLORADO	Well	WINTERS 22-3
Field	WELD COUNTY (KERR MCGEE)	Wellbore	WINTERS 22-3 AWB
Facility	SEC.03-T5N-R65W		

WELLPATH DATA (85 stations) † = interpolated/extrapolated station

MD [ft]	Inclination [°]	Azimuth [°]	TVD [ft]	Vert Sect [ft]	North [ft]	East [ft]	DLS [°/100ft]	Comments
0.00†	0.000	99.600	0.00	0.00	0.00	0.00	0.00	
16.00	0.000	99.600	16.00	0.00	0.00	0.00	0.00	
159.00	0.500	99.600	159.00	0.55	-0.10	0.62	0.35	
252.00	0.500	81.000	251.99	1.18	-0.11	1.42	0.17	
344.00	2.100	127.000	343.97	3.14	-1.06	3.16	1.94	
433.00	5.200	135.800	432.78	8.77	-4.93	7.27	3.53	
504.00	7.300	135.000	503.35	16.43	-10.43	12.71	2.96	
560.00	7.600	133.600	558.88	23.65	-15.50	17.90	0.63	
622.00	9.600	132.300	620.18	32.89	-21.81	24.70	3.24	
712.00	11.000	130.100	708.73	48.95	-32.39	36.82	1.62	
801.00	13.000	134.700	795.78	67.38	-44.90	50.43	2.49	
891.00	15.000	130.500	883.10	89.07	-59.59	66.48	2.49	
982.00	16.000	131.600	970.79	113.35	-75.56	84.82	1.15	
1070.00	17.000	129.100	1055.17	138.32	-91.73	103.87	1.39	
1159.00	17.500	128.400	1140.17	164.70	-108.25	124.45	0.61	
1250.00	18.700	125.000	1226.66	192.96	-125.11	147.13	1.76	
1338.00	18.200	124.200	1310.14	220.76	-140.93	170.05	0.64	
1428.00	19.000	127.000	1395.44	249.43	-157.65	193.38	1.33	
1519.00	18.500	126.300	1481.61	278.68	-175.11	216.84	0.60	
1608.00	18.600	125.600	1565.99	306.97	-191.73	239.76	0.27	
1695.00	18.000	125.200	1648.59	334.26	-207.56	262.03	0.70	
1782.00	17.300	127.300	1731.49	360.63	-223.14	283.30	1.09	
1871.00	17.400	129.100	1816.44	387.16	-239.56	304.16	0.61	
1958.00	17.500	128.400	1899.44	413.25	-255.89	324.50	0.27	
2047.00	17.300	127.300	1984.37	439.86	-272.22	345.52	0.43	
2135.00	17.600	128.000	2068.32	466.25	-288.34	366.41	0.42	
2226.00	17.300	128.000	2155.13	493.54	-305.14	387.91	0.33	
2314.00	16.800	128.400	2239.26	519.34	-321.09	408.19	0.58	
2403.00	17.500	129.800	2324.30	545.58	-337.65	428.55	0.91	
2492.00	17.600	129.800	2409.16	572.40	-354.83	449.17	0.11	
2582.00	17.100	126.300	2495.07	599.23	-371.37	470.29	1.29	
2673.00	17.600	128.000	2581.93	626.36	-387.76	491.91	0.78	
2761.00	18.600	126.300	2665.57	653.69	-404.26	513.71	1.29	
2850.00	19.400	127.000	2749.72	682.66	-421.56	536.95	0.93	
2937.00	19.000	127.700	2831.89	711.27	-438.91	559.70	0.53	
3026.00	18.300	126.300	2916.21	739.72	-456.05	582.42	0.93	
3116.00	18.500	128.400	3001.61	768.13	-473.28	605.00	0.77	
3205.00	16.800	127.000	3086.42	795.11	-489.79	626.34	1.97	
3293.00	15.400	129.100	3170.97	819.51	-504.82	645.56	1.72	
3383.00	13.700	129.000	3258.08	842.11	-519.06	663.12	1.89	
3473.00	12.100	129.100	3345.80	862.20	-531.72	678.73	1.78	
3563.00	10.800	129.400	3434.01	880.06	-543.02	692.56	1.45	
3654.00	8.400	133.700	3523.73	895.20	-553.03	703.96	2.75	
3743.00	8.000	127.300	3611.82	907.86	-561.27	713.58	1.12	
3832.00	6.900	121.700	3700.07	919.37	-567.83	723.06	1.48	



Actual Wellpath Report

WINTERS 22-3 AWP

Page 3 of 5



INTEQ

REFERENCE WELLPATH IDENTIFICATION

Operator	KERR MCGEE OIL & GAS ONSHORE LP	Slot	SLOT#02 WINTERS 22-3 (1943'FNL & 517'FWL)
Area	COLORADO	Well	WINTERS 22-3
Field	WELD COUNTY (KERR MCGEE)	Wellbore	WINTERS 22-3 AWB
Facility	SEC.03-T5N-R65W		

WELLPATH DATA (85 stations)

MD [ft]	Inclination [°]	Azimuth [°]	TVD [ft]	Vert Sect [ft]	North [ft]	East [ft]	DLS [°/100ft]	Comments
3923.00	5.700	111.900	3790.52	929.15	-572.39	731.90	1.77	
4012.00	4.400	123.800	3879.18	936.80	-575.94	738.84	1.87	
4100.00	3.100	123.100	3966.99	942.54	-579.12	743.64	1.48	
4191.00	2.000	103.000	4057.90	946.43	-580.82	747.25	1.54	
4279.00	0.600	169.900	4145.88	948.17	-581.62	748.83	2.10	
4368.00	0.700	140.300	4234.87	949.04	-582.49	749.26	0.39	
4459.00	0.700	134.700	4325.86	950.14	-583.31	750.01	0.08	
4546.00	0.600	109.100	4412.86	951.10	-583.84	750.81	0.35	
4634.00	0.500	112.600	4500.85	951.90	-584.13	751.60	0.12	
4723.00	0.600	66.900	4589.85	952.50	-584.10	752.39	0.49	
4814.00	0.900	75.300	4680.84	953.17	-583.73	753.52	0.35	
4903.00	1.700	56.300	4769.82	954.01	-582.82	755.30	1.01	
4992.00	2.300	51.400	4858.76	954.84	-580.98	757.79	0.70	
5079.00	1.800	22.600	4945.71	954.88	-578.62	759.68	1.30	
5168.00	2.100	333.000	5034.66	953.04	-575.88	759.48	1.86	
5258.00	1.800	318.200	5124.61	950.15	-573.36	757.79	0.65	
5347.00	1.700	309.100	5213.57	947.46	-571.48	755.83	0.33	
5434.00	1.700	301.700	5300.53	944.88	-569.99	753.73	0.25	
5521.00	1.800	289.100	5387.49	942.31	-568.87	751.34	0.46	
5608.00	1.400	253.200	5474.46	940.40	-568.73	749.03	1.21	
5698.00	0.800	214.500	5564.45	939.80	-569.56	747.62	1.03	
5787.00	0.700	304.900	5653.44	939.30	-569.76	746.83	1.20	
5876.00	0.700	328.400	5742.43	938.25	-568.99	746.09	0.32	
5965.00	0.700	330.200	5831.43	937.23	-568.05	745.54	0.02	
6055.00	0.500	339.000	5921.42	936.39	-567.21	745.13	0.24	
6143.00	0.500	339.000	6009.42	935.73	-566.49	744.85	0.00	
6231.00	0.400	331.600	6097.42	935.12	-565.86	744.57	0.13	
6320.00	0.400	295.400	6186.41	934.53	-565.46	744.14	0.28	
6408.00	0.700	294.700	6274.41	933.71	-565.10	743.37	0.34	
6499.00	0.800	284.100	6365.40	932.59	-564.71	742.25	0.19	
6587.00	1.100	261.000	6453.39	931.45	-564.70	740.82	0.55	
6676.00	1.100	257.000	6542.37	930.33	-565.02	739.15	0.09	
6763.00	1.200	250.400	6629.36	929.31	-565.52	737.47	0.19	
6853.00	1.600	251.800	6719.33	928.11	-566.22	735.39	0.45	
6943.00	2.000	254.600	6809.28	926.47	-567.03	732.68	0.45	
7024.00	2.400	253.900	6890.22	924.63	-567.88	729.69	0.49	
7118.00	3.000	248.300	6984.12	922.23	-569.34	725.52	0.70	
7207.00	3.300	255.300	7072.99	919.50	-570.85	720.87	0.55	
7288.00	3.800	265.100	7153.83	916.11	-571.67	715.94	0.97	LAST BHI MWD SURVEY
7338.00	3.800	265.100	7203.72	913.68	-571.95	712.64	0.00	PROJECTION TO BIT



Actual Wellpath Report

WINTERS 22-3 AWP

Page 4 of 5



INTEQ

REFERENCE WELLPATH IDENTIFICATION			
Operator	KERR MCGEE OIL & GAS ONSHORE LP	Slot	SLOT#02 WINTERS 22-3 (1943'FNL & 517'FWL)
Area	COLORADO	Well	WINTERS 22-3
Field	WELD COUNTY (KERR MCGEE)	Wellbore	WINTERS 22-3 AWB
Facility	SEC.03-T5N-R65W		

HOLE & CASING SECTIONS Ref Wellbore: WINTERS 22-3 AWB Ref Wellpath: WINTERS 22-3 AWP									
String/Diameter	Start MD [ft]	End MD [ft]	Interval [ft]	Start TVD [ft]	End TVD [ft]	Start N/S [ft]	Start E/W [ft]	End N/S [ft]	End E/W [ft]
12.25in Open Hole	0.00	559.00	559.00	0.00	557.89	0.00	0.00	-15.41	17.81
8.625in Casing Surface	16.00	549.00	533.00	16.00	547.98	0.00	0.00	-14.50	16.86
7.875in Open Hole	549.00	7338.00	6789.00	547.98	7203.72	-14.50	16.86	-571.95	712.64

TARGETS									
Name	MD [ft]	TVD [ft]	North [ft]	East [ft]	Grid East [srv ft]	Grid North [srv ft]	Latitude	Longitude	Shape
WINTERS 22-3 BHL ON PLAT (2530'FNL & 1270'FWL, REV-1)		6000.00	-587.26	743.06	3235442.70	1400018.29	40°25'42.132"N	104°39'15.368"W	point
WINTERS 22-3 GEO TARGET 50' RADIUS (2522'FNL & 1270'FWL, REV-2)		6000.00	-579.26	743.06	3235442.63	1400026.30	40°25'42.211"N	104°39'15.368"W	circle
WINTERS 22-3 HARDLINE 50'S OF GEO TARGET		6000.00	-629.26	743.06	3235443.10	1399976.30	40°25'41.717"N	104°39'15.368"W	point

WELLPATH COMPOSITION Ref Wellbore: WINTERS 22-3 AWB Ref Wellpath: WINTERS 22-3 AWP				
Start MD [ft]	End MD [ft]	Positional Uncertainty Model	Log Name/Comment	Wellbore
16.00	560.00	NaviTrak (Standard)	BHI MWD SURVEY 12.25 HOLE <159-560>	WINTERS 22-3 AWB
560.00	7288.00	NaviTrak (Standard)	BHI MWD SURVEYS 7.875 HOLE <622-7288>	WINTERS 22-3 AWB
7288.00	7338.00	Blind Drilling (std)	Projection to bit	WINTERS 22-3 AWB



Actual Wellpath Report

WINTERS 22-3 AWP

Page 5 of 5



INTEQ

REFERENCE WELLPATH IDENTIFICATION

Operator	KERR MCGEE OIL & GAS ONSHORE LP	Slot	SLOT#02 WINTERS 22-3 (1943'FNL & 517'FWL)
Area	COLORADO	Well	WINTERS 22-3
Field	WELD COUNTY (KERR MCGEE)	Wellbore	WINTERS 22-3 AWB
Facility	SEC.03-T5N-R65W		

WELLPATH COMMENTS

MD [ft]	Inclination [°]	Azimuth [°]	TVD [ft]	Comment
7288.00	3.800	265.100	7153.83	LAST BHI MWD SURVEY
7338.00	3.800	265.100	7203.72	PROJECTION TO BIT