

EOG RESOURCES, INC.  
IGO CREEK #22-28H  
SECTION 28, T9N, R59W, 6<sup>th</sup> P.M.

PROCEED IN A SOUTHWESTERLY, THEN NORTHWESTERLY DIRECTION FROM RAYMER, COLORADO ALONG HIGHWAY 14 APPROXIMATELY 7.5 MILES TO THE JUNCTION OF THIS ROAD AND COUNTY ROAD 115 TO THE NORTH; TURN RIGHT AND PROCEED IN A NORTHERLY DIRECTION APPROXIMATELY 5.3 MILES TO THE BEGINNING OF THE PROPOSED ACCESS ROAD FOR IGO CREEK #24-30H TO THE NORTH; FOLLOW ROAD FLAGS IN A NORTHERLY, THEN NORTHWESTERLY, THEN WESTERLY DIRECTION APPROXIMATELY 12,207' TO THE BEGINNING OF THE PROPOSED ACCESS TO THE NORTH; FOLLOW ROAD FLAGS IN A NORTHERLY, THEN NORTHEASTERLY, THEN NORTHERLY DIRECTION APPROXIMATELY 5,300' TO THE PROPOSED LOCATION.

TOTAL DISTANCE FROM RAYMER, COLORADO TO THE PROPOSED LOCATION IS APPROXIMATELY 16.1 MILES.

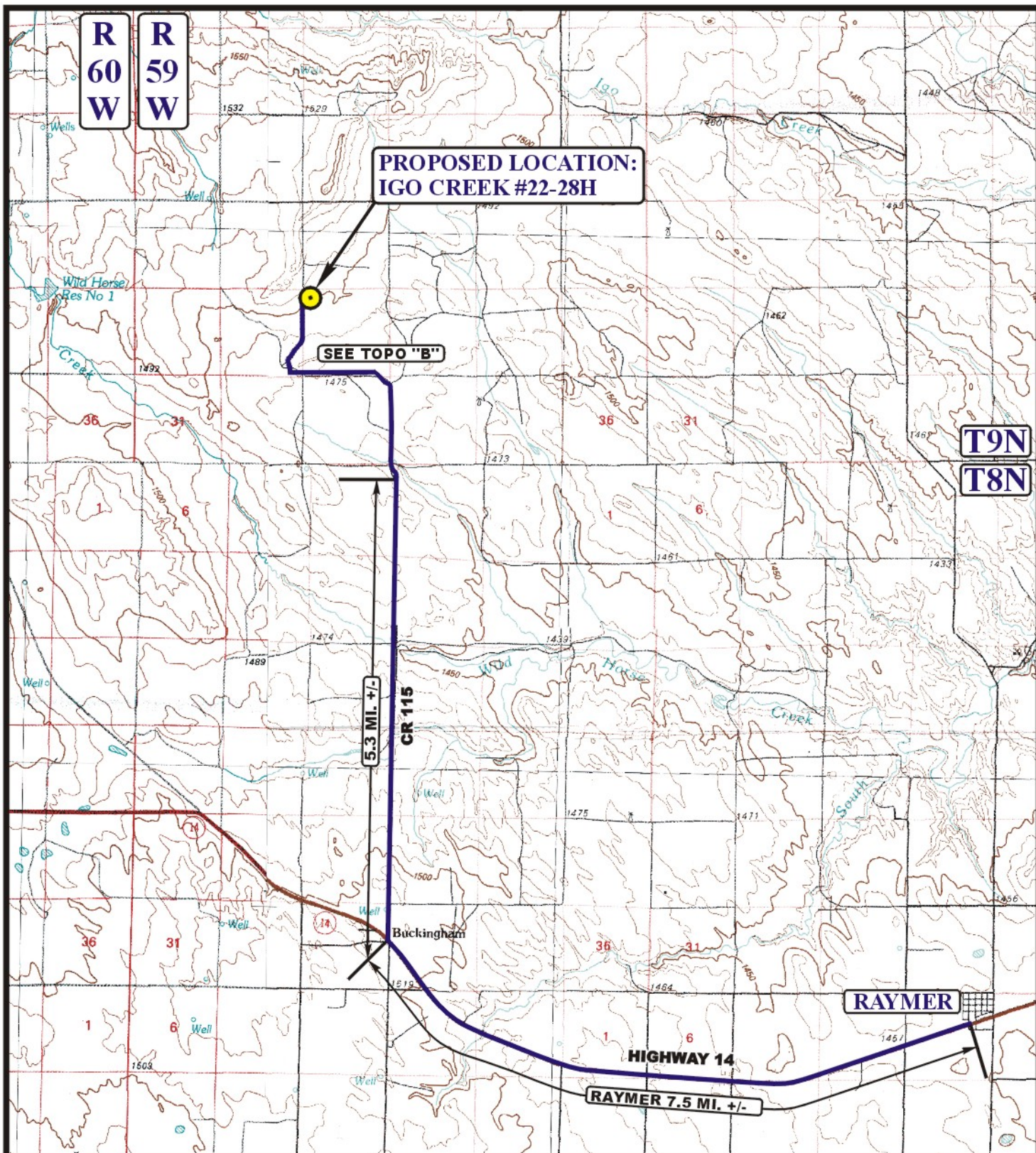

# LEGEND:

PROPOSED LOCATION



**Uintah Engineering & Land Surveying**  
 85 South 200 East Vernal, Utah 84078  
 (435) 789-1017 \* FAX (435) 789-1813



# EOG RESOURCES, INC.

**IGO CREEK #22-28H**  
**SECTION 28, T9N, R59W, 6th P.M.**  
**501' FNL 501' FWL**

**ACCESS ROAD**  
**MAP**

**01 14 11**  
 MONTH DAY YEAR

SCALE: 1:100,000 DRAWN BY: S.F. REVISED: 00-00-00





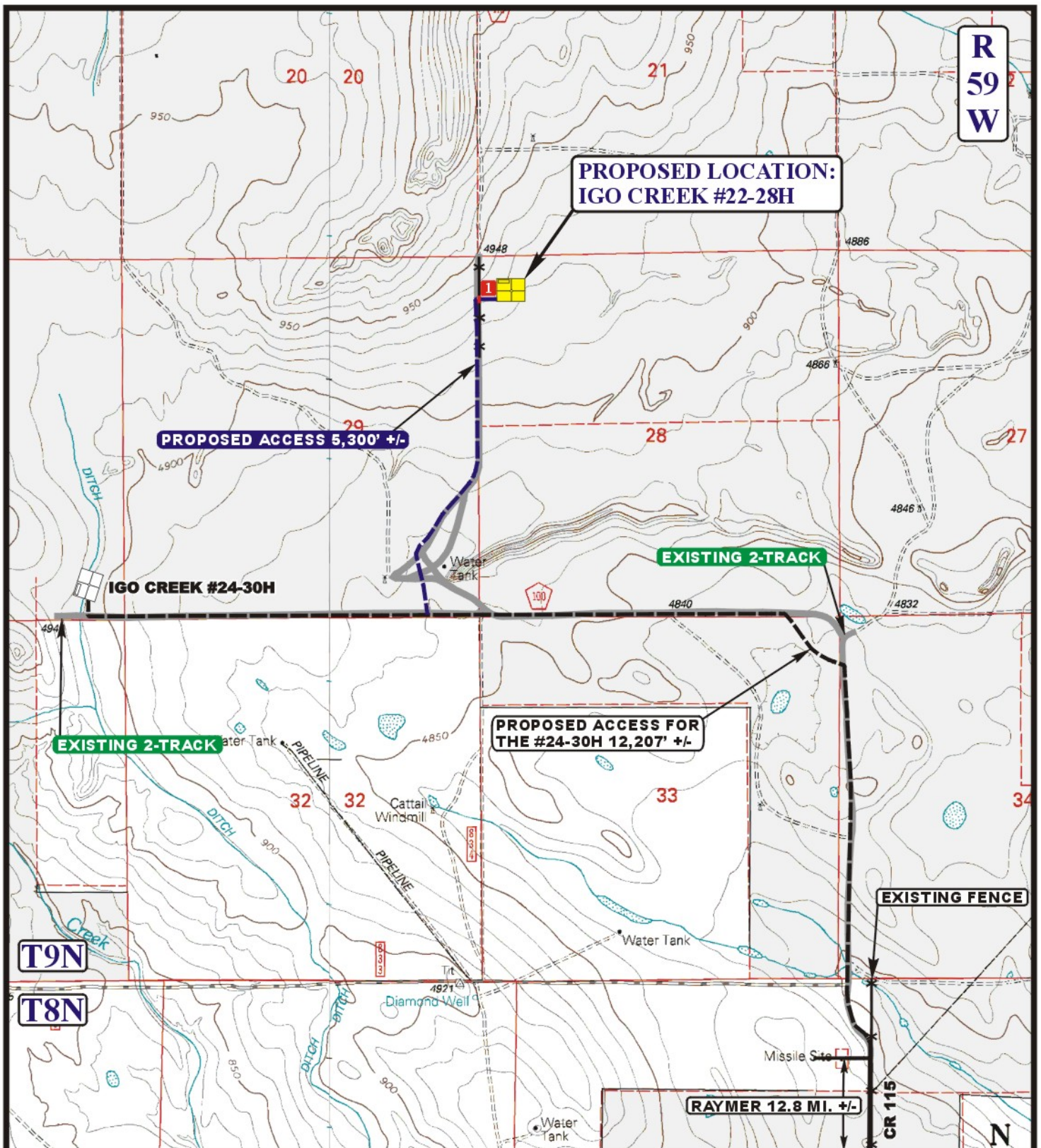

# LEGEND:

- EXISTING ROAD
- - - PROPOSED ACCESS ROAD
- \* \* \* EXISTING FENCE
- 1 INSTALL CATTLE GUARD



Utah Engineering & Land Surveying  
85 South 200 East Vernal, Utah 84078  
(435) 789-1017 \* FAX (435) 789-1813



EOG RESOURCES, INC.

IGO CREEK #22-28H  
SECTION 28, T9N, R59W, 6th P.M.  
501' FNL 501' FWL

ACCESS ROAD  
MAP

01 14 11  
MONTH DAY YEAR

B  
TOPO

SCALE: 1" = 2000' DRAWN BY: S.F. REVISED: 00-00-00