

KERR MCGEE OIL & GAS ONSHORE LP

Location: COLORADO Slot: SLOT#05 MIRACLE 9-12 (2480'FSL & 315'FEL)
 Field: LARIMER COUNTY Well: MIRACLE 9-12
 Facility: SEC.12-T5N-R68W Wellbore: MIRACLE 9-12 PWB

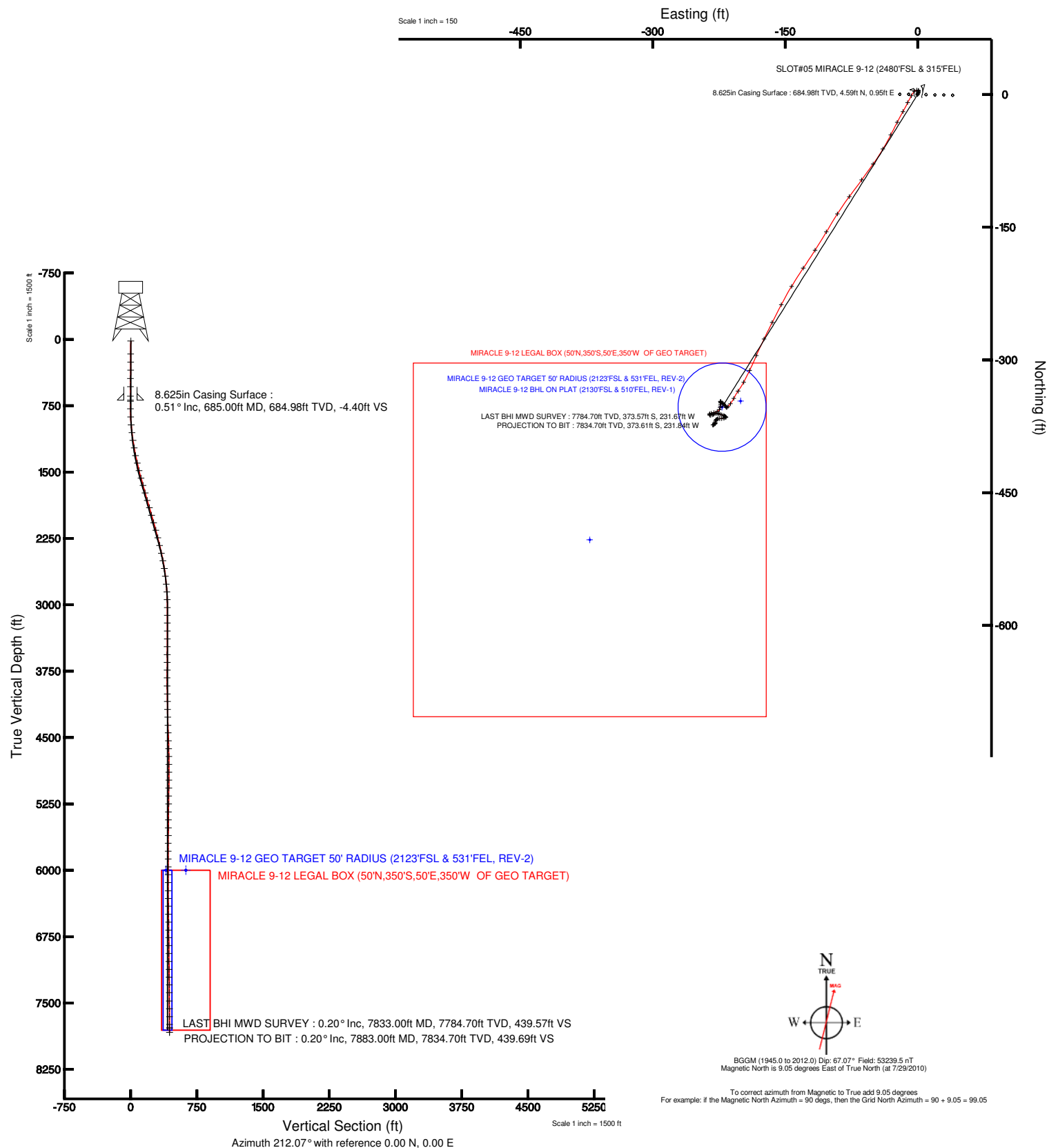

Plot reference wellpath is MIRACLE 9-12 (REV-B.0) PWP	
True vertical depths are referenced to XTREME 6 (RT)	Grid System: NAD83 / Lambert Colorado State Planes, Northern Zone (501), US feet
Measured depths are referenced to XTREME 6 (RT)	North Reference: True north
XTREME 6 (RT) to Mean Sea Level: 4964 feet	Scale: True distance
Mean Sea Level to Mud line (Facility: SEC.12-T5N-R68W): 0 feet	Depths are in feet
Coordinates are in feet referenced to Slot	Created by: bensjacj on 8/18/2010





Actual Wellpath Report

MIRACLE 9-12 AWP

Page 1 of 5



INTEQ

REFERENCE WELLPATH IDENTIFICATION

Operator	KERR MCGEE OIL & GAS ONSHORE LP	Slot	SLOT#05 MIRACLE 9-12 (2480'FSL & 315'FEL)
Area	COLORADO	Well	MIRACLE 9-12
Field	LARIMER COUNTY	Wellbore	MIRACLE 9-12 AWB
Facility	SEC.12-T5N-R68W		

REPORT SETUP INFORMATION

Projection System	NAD83 / Lambert Colorado State Planes, Northern Zone (501), US feet	Software System	WellArchitect® 2.0
North Reference	True	User	Bensjacj
Scale	0.999961	Report Generated	8/18/2010 at 3:22:10 PM
Convergence at slot	0.36° East	Database/Source file	WA_Denver/MIRACLE_9-12_AWB.xml

WELLPATH LOCATION

	Local coordinates		Grid coordinates		Geographic coordinates	
	North[ft]	East[ft]	Easting[USft]	Northing[USft]	Latitude	Longitude
Slot Location	0.73	-39.82	3154380.71	1394064.12	40°24'49.619"N	104°56'44.070"W
Facility Reference Pt			3154420.53	1394063.64	40°24'49.612"N	104°56'43.555"W
Field Reference Pt			3154420.53	1394063.64	40°24'49.612"N	104°56'43.555"W

WELLPATH DATUM

Calculation method	Minimum curvature	XTREME 6 (RT) to Facility Vertical Datum	4964.00ft
Horizontal Reference Pt	Slot	XTREME 6 (RT) to Mean Sea Level	4964.00ft
Vertical Reference Pt	XTREME 6 (RT)	Facility Vertical Datum to Mud Line (Facility)	0.00ft
MD Reference Pt	XTREME 6 (RT)	Section Origin	N 0.00, E 0.00 ft
Field Vertical Reference	Mean Sea Level	Section Azimuth	212.07°



Actual Wellpath Report

MIRACLE 9-12 AWP

Page 2 of 5



REFERENCE WELLPATH IDENTIFICATION

Operator	KERR MCGEE OIL & GAS ONSHORE LP	Slot	SLOT#05 MIRACLE 9-12 (2480'FSL & 315'FEL)
Area	COLORADO	Well	MIRACLE 9-12
Field	LARIMER COUNTY	Wellbore	MIRACLE 9-12 AWB
Facility	SEC.12-T5N-R68W		

WELLPATH DATA (91 stations) † = interpolated/extrapolated station

MD [ft]	Inclination [°]	Azimuth [°]	TVD [ft]	Vert Sect [ft]	North [ft]	East [ft]	DLS [°/100ft]	Comments
0.00†	0.000	24.200	0.00	0.00	0.00	0.00	0.00	
16.00	0.000	24.200	16.00	0.00	0.00	0.00	0.00	
163.00	0.500	24.200	163.00	-0.64	0.59	0.26	0.34	
256.00	0.500	11.500	255.99	-1.42	1.35	0.51	0.12	
347.00	0.400	20.300	346.99	-2.10	2.04	0.70	0.13	
440.00	0.500	14.300	439.99	-2.80	2.74	0.91	0.12	
532.00	0.600	5.900	531.98	-3.62	3.61	1.06	0.14	
640.00	0.200	349.700	639.98	-4.27	4.35	1.09	0.38	
697.00	0.600	321.200	696.98	-4.44	4.68	0.88	0.76	
784.00	1.700	271.300	783.96	-3.93	5.07	-0.69	1.60	
875.00	2.700	225.300	874.90	-1.15	3.59	-3.57	2.14	
965.00	4.900	209.100	964.70	4.75	-1.26	-6.94	2.70	
1054.00	6.600	207.300	1053.25	13.65	-9.13	-11.14	1.92	
1141.00	8.400	208.400	1139.50	24.97	-19.16	-16.46	2.08	
1228.00	9.700	208.300	1225.42	38.63	-31.20	-22.95	1.49	
1316.00	11.300	206.300	1311.94	54.61	-45.46	-30.29	1.86	
1404.00	12.900	211.200	1397.99	73.01	-61.59	-39.20	2.16	
1490.00	14.200	215.400	1481.59	93.14	-78.40	-50.28	1.89	
1578.00	15.200	216.100	1566.71	115.42	-96.52	-63.33	1.15	
1665.00	16.000	216.800	1650.50	138.75	-115.34	-77.23	0.94	
1752.00	15.700	212.600	1734.20	162.47	-134.86	-90.76	1.36	
1840.00	15.900	210.500	1818.88	186.42	-155.28	-103.29	0.69	
1927.00	16.400	213.000	1902.44	210.62	-175.84	-116.03	0.98	
2014.00	16.200	214.000	1985.95	235.03	-196.21	-129.51	0.40	
2103.00	15.900	211.200	2071.48	259.63	-216.93	-142.76	0.93	
2191.00	15.300	207.700	2156.24	283.26	-237.52	-154.41	1.27	
2280.00	14.100	206.300	2242.32	305.75	-257.63	-164.67	1.41	
2368.00	13.400	206.300	2327.80	326.56	-276.39	-173.93	0.80	
2458.00	13.100	203.500	2415.41	347.02	-295.09	-182.62	0.79	
2545.00	11.100	205.200	2500.47	365.09	-311.71	-190.12	2.33	
2635.00	8.400	209.800	2589.16	380.26	-325.26	-197.08	3.12	
2724.00	7.000	214.000	2677.36	392.18	-335.39	-203.34	1.69	
2813.00	5.400	207.700	2765.84	401.77	-343.60	-208.32	1.95	
2900.00	3.800	218.900	2852.55	408.72	-349.47	-212.03	2.10	
2989.00	1.600	221.400	2941.45	412.87	-352.69	-214.71	2.47	
3079.00	0.700	253.000	3031.43	414.53	-353.80	-216.07	1.19	
3166.00	0.500	312.800	3118.43	414.86	-353.70	-216.85	0.72	
3254.00	0.900	338.500	3206.42	414.38	-352.79	-217.39	0.57	
3343.00	1.000	316.700	3295.41	413.77	-351.58	-218.18	0.42	
3432.00	1.100	321.200	3384.39	413.29	-350.34	-219.24	0.15	
3520.00	0.800	304.000	3472.38	412.99	-349.34	-220.28	0.47	
3611.00	0.900	302.600	3563.37	412.97	-348.60	-221.41	0.11	
3698.00	1.100	293.100	3650.36	413.09	-347.91	-222.75	0.30	
3785.00	0.400	12.900	3737.35	412.93	-347.28	-223.46	1.27	
3874.00	0.200	34.700	3826.35	412.48	-346.85	-223.30	0.25	



Actual Wellpath Report

MIRACLE 9-12 AWP

Page 3 of 5



REFERENCE WELLPATH IDENTIFICATION

Operator	KERR MCGEE OIL & GAS ONSHORE LP	Slot	SLOT#05 MIRACLE 9-12 (2480'FSL & 315'FEL)
Area	COLORADO	Well	MIRACLE 9-12
Field	LARIMER COUNTY	Wellbore	MIRACLE 9-12 AWB
Facility	SEC.12-T5N-R68W		

WELLPATH DATA (91 stations)

MD [ft]	Inclination [°]	Azimuth [°]	TVD [ft]	Vert Sect [ft]	North [ft]	East [ft]	DLS [°/100ft]	Comments
3965.00	0.600	159.900	3917.35	412.62	-347.17	-223.04	0.81	
4054.00	1.200	184.800	4006.34	413.73	-348.54	-222.96	0.79	
4141.00	1.200	195.400	4093.32	415.41	-350.32	-223.28	0.25	
4230.00	1.200	182.000	4182.30	417.11	-352.15	-223.56	0.31	
4318.00	1.200	191.900	4270.28	418.78	-353.97	-223.78	0.24	
4409.00	1.800	205.200	4361.25	421.09	-356.20	-224.59	0.76	
4496.00	2.700	245.300	4448.19	424.16	-358.29	-227.03	2.02	
4585.00	2.500	258.000	4537.10	427.26	-359.57	-230.83	0.68	
4674.00	1.500	250.200	4626.04	429.53	-360.37	-233.83	1.16	
4763.00	0.700	255.900	4715.02	430.84	-360.90	-235.45	0.91	
4852.00	0.700	166.600	4804.02	431.61	-361.56	-235.85	1.11	
4940.00	0.600	156.000	4892.01	432.25	-362.50	-235.54	0.18	
5030.00	1.200	70.200	4982.01	431.77	-362.61	-234.46	1.45	
5119.00	0.900	83.200	5070.99	430.60	-362.22	-232.89	0.43	
5210.00	0.500	71.200	5161.98	429.84	-362.00	-231.81	0.47	
5300.00	1.200	47.700	5251.97	428.63	-361.24	-230.74	0.85	
5389.00	0.900	80.400	5340.96	427.27	-360.50	-229.36	0.74	
5479.00	1.000	90.000	5430.95	426.38	-360.38	-227.88	0.21	
5569.00	0.900	100.500	5520.93	425.70	-360.51	-226.40	0.22	
5657.00	0.600	115.600	5608.93	425.40	-360.83	-225.30	0.41	
5745.00	1.400	110.000	5696.91	425.12	-361.40	-223.87	0.91	
5833.00	1.200	108.900	5784.89	424.68	-362.07	-221.99	0.23	
5922.00	1.100	110.000	5873.87	424.29	-362.66	-220.31	0.12	
6011.00	0.700	123.700	5962.86	424.13	-363.25	-219.05	0.51	
6099.00	0.600	115.200	6050.86	424.09	-363.75	-218.19	0.16	
6189.00	0.400	144.000	6140.85	424.15	-364.20	-217.58	0.35	
6280.00	0.500	137.000	6231.85	424.37	-364.75	-217.12	0.13	
6368.00	1.000	250.200	6319.84	425.07	-365.29	-217.58	1.46	
6456.00	0.800	264.000	6407.83	426.06	-365.62	-218.91	0.33	
6546.00	1.100	245.700	6497.82	427.16	-366.04	-220.33	0.47	
6635.00	1.400	271.000	6586.80	428.44	-366.37	-222.19	0.70	
6725.00	1.300	268.100	6676.78	429.57	-366.39	-224.31	0.13	
6812.00	0.500	254.800	6763.76	430.40	-366.52	-225.67	0.94	
6900.00	1.000	255.500	6851.76	431.24	-366.81	-226.78	0.57	
6990.00	0.400	218.200	6941.75	432.13	-367.25	-227.73	0.80	
7081.00	0.400	229.100	7032.75	432.75	-367.71	-228.17	0.08	
7170.00	1.000	208.700	7121.74	433.82	-368.60	-228.78	0.72	
7259.00	0.900	183.800	7210.73	435.21	-369.97	-229.20	0.47	
7346.00	0.800	179.200	7297.72	436.32	-371.26	-229.23	0.14	
7434.00	0.200	191.200	7385.72	436.98	-372.03	-229.26	0.69	
7527.00	0.400	240.400	7478.71	437.42	-372.35	-229.57	0.33	
7615.00	0.500	243.200	7566.71	438.02	-372.67	-230.18	0.12	
7704.00	0.700	231.900	7655.71	438.86	-373.18	-230.95	0.26	
7793.00	0.200	259.400	7744.70	439.48	-373.55	-231.53	0.60	
7833.00	0.200	259.400	7784.70	439.57	-373.57	-231.67	0.00	LAST BHI MWD SURVEY



Actual Wellpath Report

MIRACLE 9-12 AWP

Page 4 of 5



INTEQ

REFERENCE WELLPATH IDENTIFICATION

Operator	KERR MCGEE OIL & GAS ONSHORE LP	Slot	SLOT#05 MIRACLE 9-12 (2480'FSL & 315'FEL)
Area	COLORADO	Well	MIRACLE 9-12
Field	LARIMER COUNTY	Wellbore	MIRACLE 9-12 AWB
Facility	SEC.12-T5N-R68W		

WELLPATH DATA (91 stations)

MD [ft]	Inclination [°]	Azimuth [°]	TVD [ft]	Vert Sect [ft]	North [ft]	East [ft]	DLS [°/100ft]	Comments
7883.00	0.200	259.400	7834.70	439.69	-373.61	-231.84	0.00	PROJECTION TO BIT

HOLE & CASING SECTIONS Ref Wellbore: MIRACLE 9-12 AWB Ref Wellpath: MIRACLE 9-12 AWP

String/Diameter	Start MD [ft]	End MD [ft]	Interval [ft]	Start TVD [ft]	End TVD [ft]	Start N/S [ft]	Start E/W [ft]	End N/S [ft]	End E/W [ft]
12.25in Open Hole	16.00	695.00	679.00	16.00	694.98	0.00	0.00	4.67	0.89
8.625in Casing Surface	16.00	685.00	669.00	16.00	684.98	0.00	0.00	4.59	0.95
7.875in Open Hole	685.00	7755.00	7070.00	684.98	7706.70	4.59	0.95	-373.47	-231.35

TARGETS

Name	MD [ft]	TVD [ft]	North [ft]	East [ft]	Grid East [srv ft]	Grid North [srv ft]	Latitude	Longitude	Shape
MIRACLE 9-12 BHL ON PLAT (2130'FSL & 510'FEL, REV-1)		6000.00	-346.46	-200.50	3154182.38	1393716.43	40°24'46.195"N	104°56'46.662"W	point
MIRACLE 9-12 GEO TARGET 50' RADIUS (2123'FSL & 531'FEL, REV-2)		6000.00	-353.46	-221.50	3154161.43	1393709.30	40°24'46.126"N	104°56'46.934"W	circle
MIRACLE 9-12 LEGAL BOX (50'N,350'S,50'E,350'W OF GEO TARGET)		6000.00	-503.46	-371.50	3154012.38	1393558.37	40°24'44.644"N	104°56'48.873"W	square

WELLPATH COMPOSITION Ref Wellbore: MIRACLE 9-12 AWB Ref Wellpath: MIRACLE 9-12 AWP

Start MD [ft]	End MD [ft]	Positional Uncertainty Model	Log Name/Comment	Wellbore
16.00	7833.00	NaviTrak (Standard)	BHI MWD SURVEYS <163-7833>	MIRACLE 9-12 AWB
7833.00	7883.00	Blind Drilling (std)	Projection to bit	MIRACLE 9-12 AWB



Actual Wellpath Report

MIRACLE 9-12 AWP

Page 5 of 5



INTEQ

REFERENCE WELLPATH IDENTIFICATION

Operator	KERR MCGEE OIL & GAS ONSHORE LP	Slot	SLOT#05 MIRACLE 9-12 (2480'FSL & 315'FEL)
Area	COLORADO	Well	MIRACLE 9-12
Field	LARIMER COUNTY	Wellbore	MIRACLE 9-12 AWB
Facility	SEC.12-T5N-R68W		

WELLPATH COMMENTS

MD [ft]	Inclination [°]	Azimuth [°]	TVD [ft]	Comment
7833.00	0.200	259.400	7784.70	LAST BHI MWD SURVEY
7883.00	0.200	259.400	7834.70	PROJECTION TO BIT