

**EnCana Oil & Gas (USA) Inc.**

**Well Pad (F25NWB)  
SEC. 25, T6S, R93W, 6th P.M.**



**Tri-State  
Land Surveying Inc.**  
(435) 781-2501  
180 North Vernal Ave. Vernal, Utah 84078

**SCALE: 1 = 100,000  
DRAWN BY: JAS  
DATE: 02-15-2011**

**Legend**  
Existing Road  
Proposed Access

**TOPOGRAPHIC MAP  
"A"**  
**SHEET 9  
OF 11**



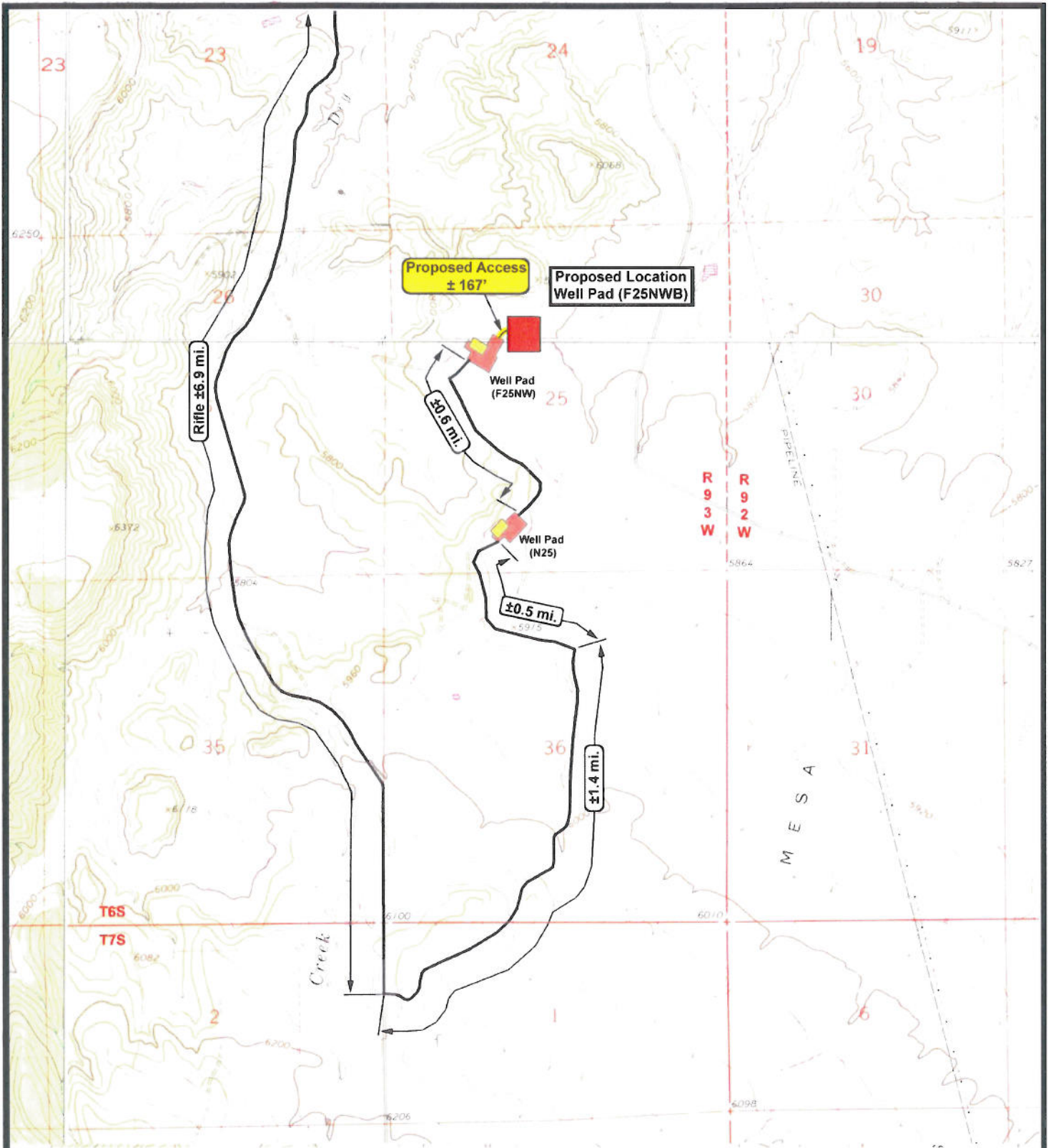

**EnCana Oil & Gas (USA) Inc.**

**Well Pad (F25NWB)  
SEC. 25, T6S, R93W, 6th P.M.**



**Tri-State  
Land Surveying Inc.**  
(435) 781-2501  
180 North Vernal Ave. Vernal, Utah 84078

**SCALE: 1" = 2,000'**  
**DRAWN BY: JAS**  
**DATE: 02-15-2011**

**Legend**  
Existing Road  
Proposed Access

**TOPOGRAPHIC MAP**  
**"B"**  
**SHEET 10 OF 11**