

# MULTI-WELL PLAN

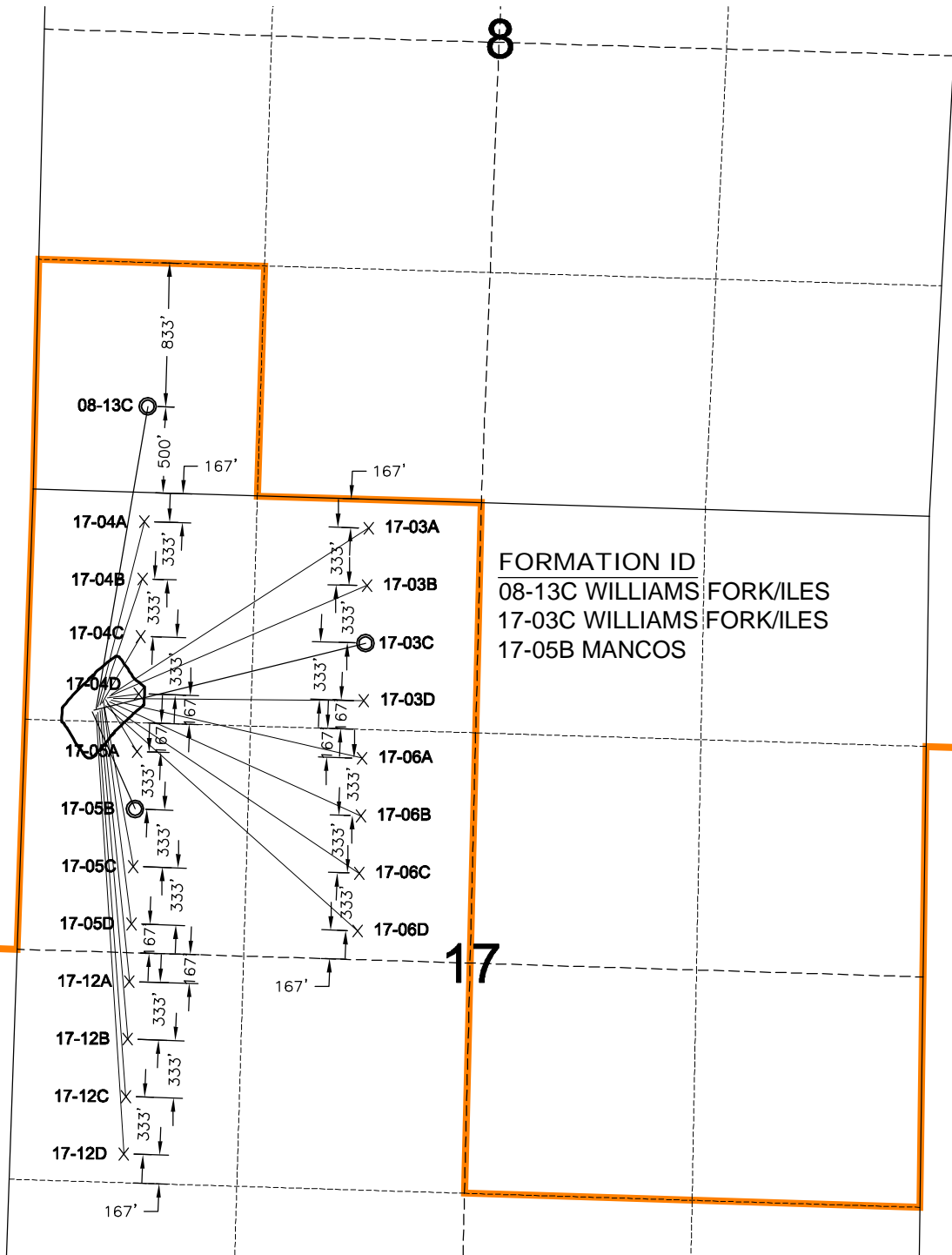

LARAMIE ENERGY II LEASE BOUNDARY

⊙ PROPOSED BOTTOM HOLE LOCATION

× PROPOSED FUTURE BOTTOM HOLE LOCATION  
 PENDING 10-ACRE DOWNSPACING

2/9/11



North

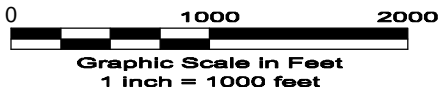

LAND SURVEYING AND MAPPING  
 LAFAYETTE - WINTER PARK  
 Ph 303 666 0379 Fx 303 665 6320

**LARAMIE ENERGY II LLC**  
**HAWXHURST 17-04 PAD**

**NW1/4 NW1/4 SEC. 17 T9S R94W**  
**6th PM MESA COUNTY COLORADO**