

Anadarko, Weld County CO

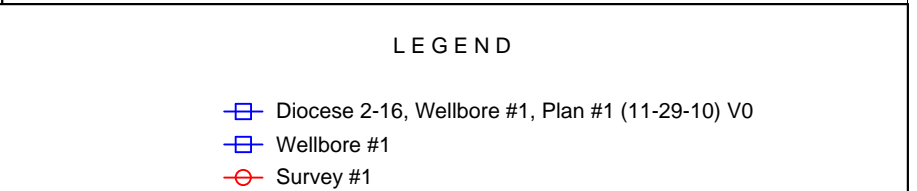
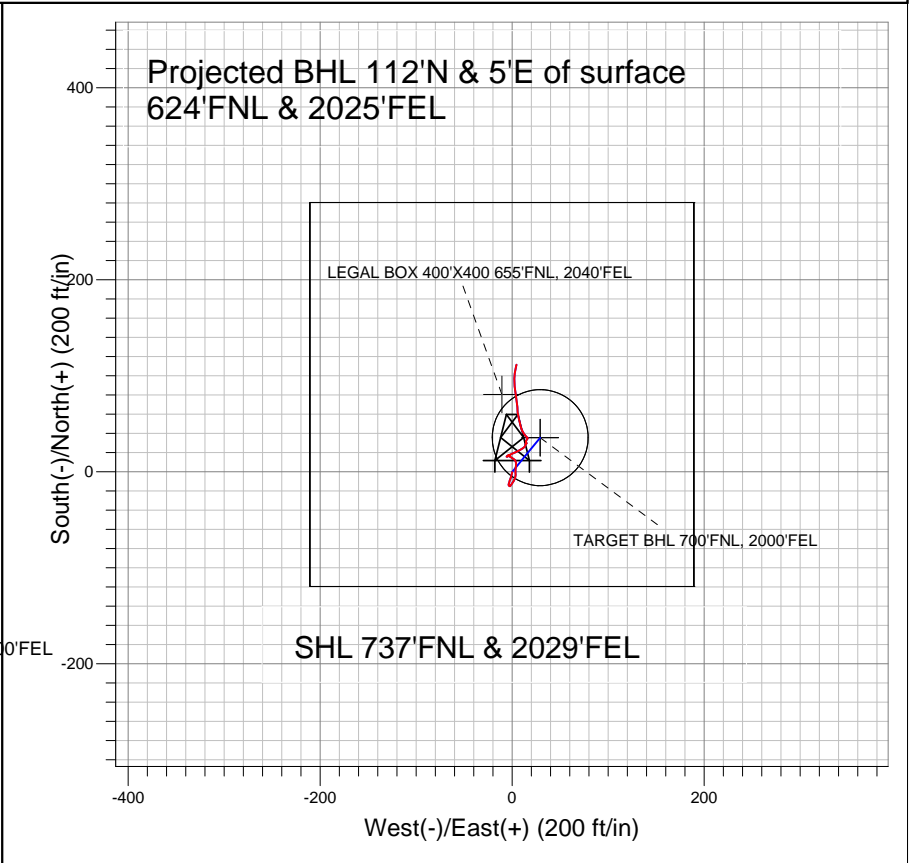

Final Survey Plot

Projected Final Survey -
 7445'MD & 7442'TVD @ 89' VS
 2.7 deg Inc 14.0 deg AZ

Project: SEC.16-T4N-R67W
 Site: Diocese 2-16 Pad Sec.16-T4N-R67W
 Well: Diocese 2-16
 Plan: Wellbore #1



Directional

Anadarko, Weld County CO

SEC.16-T4N-R67W

Diocese 2-16 Pad Sec.16-T4N-R67W

Diocese 2-16

Wellbore #1

Survey: Survey #1

Standard Survey Report

21 December, 2010



Company:	Anadarko, Weld County CO	Local Co-ordinate Reference:	Site Diocese 2-16 Pad Sec.16-T4N-R67W
Project:	SEC.16-T4N-R67W	TVD Reference:	WELL @ 4846.0ft (Original Well Elev)
Site:	Diocese 2-16 Pad Sec.16-T4N-R67W	MD Reference:	WELL @ 4846.0ft (Original Well Elev)
Well:	Diocese 2-16	North Reference:	True
Wellbore:	Wellbore #1	Survey Calculation Method:	Minimum Curvature
Design:	Wellbore #1	Database:	Landmark

Project	SEC.16-T4N-R67W, Weld County, Colorado		
Map System:	US State Plane 1983	System Datum:	Mean Sea Level
Geo Datum:	North American Datum 1983		Using Well Reference Point
Map Zone:	Colorado Northern Zone		Using geodetic scale factor

Site	Diocese 2-16 Pad Sec.16-T4N-R67W		
Site Position:		Northing:	1,359,220.95 ft
From:	Lat/Long	Easting:	3,169,041.20 ft
Position Uncertainty:	0.0 ft	Slot Radius:	"
		Latitude:	40° 19' 4.354 N
		Longitude:	104° 53' 37.615 W
		Grid Convergence:	0.39 °

Well	Diocese 2-16		
Well Position	+N-S	0.0 ft	Northing: 1,359,220.94 ft
	+E-W	0.0 ft	Easting: 3,169,041.20 ft
Position Uncertainty	0.0 ft	Wellhead Elevation:	ft
		Latitude:	40° 19' 4.353 N
		Longitude:	104° 53' 37.615 W
		Ground Level:	4,832.0 ft

Wellbore	Wellbore #1				
Magnetics	Model Name	Sample Date	Declination (°)	Dip Angle (°)	Field Strength (nT)
	IGRF2010	12/15/2010	8.99	66.98	53,127

Design	Wellbore #1				
Audit Notes:					
Version:	1.0	Phase:	ACTUAL	Tie On Depth:	0.0
Vertical Section:	Depth From (TVD) (ft)	+N-S (ft)	+E-W (ft)	Direction (°)	
	0.0	0.0	0.0	2.39	

Survey Program	Date	12/21/2010			
From (ft)	To (ft)	Survey (Wellbore)	Tool Name	Description	
77.0	7,445.0	Survey #1 (Wellbore #1)	MWD	MWD - Standard	

Survey										
Measured Depth (ft)	Inclination (°)	Azimuth (°)	Vertical Depth (ft)	+N-S (ft)	+E-W (ft)	Vertical Section (ft)	Dogleg Rate (°/100ft)	Build Rate (°/100ft)	Turn Rate (°/100ft)	
0.0	0.00	0.00	0.0	0.0	0.0	0.0	0.00	0.00	0.00	
77.0	0.90	185.50	77.0	-0.6	-0.1	-0.6	1.17	1.17	0.00	
170.0	1.10	193.60	170.0	-2.2	-0.3	-2.2	0.26	0.22	8.71	
263.0	1.10	190.50	263.0	-4.0	-0.7	-4.0	0.06	0.00	-3.33	
358.0	1.00	198.20	357.9	-5.6	-1.1	-5.7	0.18	-0.11	8.11	
445.0	1.10	205.30	444.9	-7.1	-1.7	-7.2	0.19	0.11	8.16	
532.0	1.40	191.60	531.9	-8.9	-2.3	-9.0	0.48	0.34	-15.75	
620.0	1.40	201.80	619.9	-11.0	-2.9	-11.1	0.28	0.00	11.59	
712.0	1.10	193.20	711.9	-12.9	-3.5	-13.0	0.38	-0.33	-9.35	
802.0	1.10	137.90	801.9	-14.3	-3.2	-14.5	1.13	0.00	-61.44	
932.0	0.40	40.00	931.8	-14.9	-2.0	-15.0	0.94	-0.54	-75.31	
1,064.0	0.20	2.20	1,063.8	-14.3	-1.7	-14.4	0.21	-0.15	-28.64	
1,197.0	1.50	40.30	1,196.8	-12.8	-0.6	-12.8	1.01	0.98	28.65	

Company:	Anadarko, Weld County CO	Local Co-ordinate Reference:	Site Diocese 2-16 Pad Sec.16-T4N-R67W
Project:	SEC.16-T4N-R67W	TVD Reference:	WELL @ 4846.0ft (Original Well Elev)
Site:	Diocese 2-16 Pad Sec.16-T4N-R67W	MD Reference:	WELL @ 4846.0ft (Original Well Elev)
Well:	Diocese 2-16	North Reference:	True
Wellbore:	Wellbore #1	Survey Calculation Method:	Minimum Curvature
Design:	Wellbore #1	Database:	Landmark

Survey

Measured Depth (ft)	Inclination (°)	Azimuth (°)	Vertical Depth (ft)	+N/-S (ft)	+E/-W (ft)	Vertical Section (ft)	Dogleg Rate (°/100ft)	Build Rate (°/100ft)	Turn Rate (°/100ft)
1,330.0	1.20	27.60	1,329.8	-10.2	1.2	-10.2	0.32	-0.23	-9.55
1,463.0	1.50	26.50	1,462.8	-7.4	2.6	-7.3	0.23	0.23	-0.83
1,594.0	1.30	6.30	1,593.7	-4.4	3.5	-4.3	0.40	-0.15	-15.42
1,728.0	1.30	353.80	1,727.7	-1.4	3.5	-1.2	0.21	0.00	-9.33
1,863.0	2.00	5.20	1,862.6	2.5	3.6	2.6	0.57	0.52	8.44
2,010.0	1.30	5.80	2,009.6	6.7	4.0	6.9	0.48	-0.48	0.41
2,142.0	1.10	353.60	2,141.5	9.4	4.0	9.6	0.24	-0.15	-9.24
2,273.0	1.00	333.20	2,272.5	11.7	3.3	11.8	0.29	-0.08	-15.57
2,405.0	1.50	302.50	2,404.5	13.7	1.4	13.7	0.62	0.38	-23.26
2,538.0	1.70	299.80	2,537.4	15.6	-1.8	15.5	0.16	0.15	-2.03
2,673.0	0.60	326.90	2,672.4	17.2	-3.9	17.0	0.89	-0.81	20.07
2,750.8	0.34	90.96	2,750.2	17.5	-3.9	17.3	1.08	-0.34	159.53
TARGET BHL 700'FNL, 2000'FEL									
2,807.0	0.90	114.50	2,806.4	17.3	-3.4	17.2	1.08	1.00	41.86
2,941.0	0.10	188.20	2,940.4	16.8	-2.4	16.7	0.65	-0.60	55.00
3,075.0	0.50	268.30	3,074.4	16.6	-3.0	16.5	0.37	0.30	59.78
3,209.0	1.20	251.90	3,208.4	16.2	-4.9	16.0	0.55	0.52	-12.24
3,343.0	0.40	70.60	3,342.4	15.9	-5.8	15.7	1.19	-0.60	133.36
3,475.0	1.30	56.60	3,474.3	16.9	-4.1	16.7	0.69	0.68	-10.61
3,609.0	2.40	67.00	3,608.3	18.8	-0.3	18.8	0.85	0.82	7.76
3,743.0	2.00	63.70	3,742.2	20.9	4.4	21.1	0.31	-0.30	-2.46
3,876.0	1.70	60.30	3,875.1	22.9	8.2	23.3	0.24	-0.23	-2.56
4,008.0	1.30	62.30	4,007.1	24.6	11.2	25.1	0.31	-0.30	1.52
4,140.0	0.80	37.80	4,139.0	26.0	13.1	26.6	0.50	-0.38	-18.56
4,274.0	0.70	16.00	4,273.0	27.6	13.9	28.1	0.22	-0.07	-16.27
4,406.0	0.70	355.30	4,405.0	29.1	14.0	29.7	0.19	0.00	-15.68
4,539.0	0.20	188.90	4,538.0	29.7	13.9	30.3	0.67	-0.38	-125.11
4,672.0	0.50	97.90	4,671.0	29.4	14.5	30.0	0.41	0.23	-68.42
4,807.0	0.40	20.80	4,806.0	29.8	15.2	30.4	0.42	-0.07	-57.11
4,928.0	0.80	316.00	4,927.0	30.8	14.8	31.4	0.60	0.33	-53.55
5,058.0	0.70	20.00	5,057.0	32.2	14.4	32.8	0.61	-0.08	49.23
5,191.0	0.90	45.50	5,190.0	33.7	15.5	34.3	0.30	0.15	19.17
5,324.0	0.60	10.70	5,323.0	35.1	16.3	35.7	0.40	-0.23	-26.17
5,457.0	0.40	270.90	5,456.0	35.8	16.0	36.4	0.58	-0.15	-75.04
5,589.0	0.60	310.30	5,588.0	36.2	15.0	36.8	0.29	0.15	29.85
5,723.0	0.30	347.70	5,722.0	37.0	14.4	37.6	0.30	-0.22	27.91
5,854.0	0.40	329.90	5,853.0	37.8	14.1	38.3	0.11	0.08	-13.59
5,987.0	0.60	304.00	5,986.0	38.5	13.3	39.1	0.22	0.15	-19.47
6,119.0	1.00	327.60	6,117.9	39.9	12.1	40.4	0.39	0.30	17.88
6,253.0	1.00	331.70	6,251.9	41.9	10.9	42.4	0.05	0.00	3.06
6,383.0	1.80	345.40	6,381.9	44.9	9.9	45.3	0.66	0.62	10.54
6,518.0	2.50	341.90	6,516.8	49.8	8.4	50.1	0.53	0.52	-2.59
6,650.0	2.50	348.10	6,648.7	55.3	6.9	55.6	0.20	0.00	4.70
6,783.0	3.40	353.00	6,781.5	62.1	5.9	62.3	0.70	0.68	3.68
6,847.5	3.84	354.52	6,845.8	66.1	5.4	66.3	0.69	0.67	2.36
TARGET CIRCLE 700'FNL, 2000'FEL									
6,850.8	3.86	354.59	6,849.1	66.3	5.4	66.5	0.69	0.68	2.08
LEGAL BOX 400'X400 655'FNL, 2040'FEL									
6,916.0	4.30	355.80	6,914.2	70.9	5.0	71.1	0.69	0.68	1.86
7,051.0	5.40	349.80	7,048.7	82.2	3.5	82.3	0.90	0.81	-4.44
7,184.0	5.50	359.50	7,181.1	94.8	2.3	94.8	0.70	0.08	7.29
7,316.0	3.60	11.80	7,312.7	105.2	3.1	105.2	1.61	-1.44	9.32
7,395.0	2.70	14.00	7,391.6	109.4	4.1	109.5	1.15	-1.14	2.78
7,445.0	2.70	14.00	7,441.5	111.7	4.7	111.8	0.00	0.00	0.00

Company:	Anadarko, Weld County CO	Local Co-ordinate Reference:	Site Diocese 2-16 Pad Sec.16-T4N-R67W
Project:	SEC.16-T4N-R67W	TVD Reference:	WELL @ 4846.0ft (Original Well Elev)
Site:	Diocese 2-16 Pad Sec.16-T4N-R67W	MD Reference:	WELL @ 4846.0ft (Original Well Elev)
Well:	Diocese 2-16	North Reference:	True
Wellbore:	Wellbore #1	Survey Calculation Method:	Minimum Curvature
Design:	Wellbore #1	Database:	Landmark

Survey									
Measured Depth (ft)	Inclination (°)	Azimuth (°)	Vertical Depth (ft)	+N/-S (ft)	+E/-W (ft)	Vertical Section (ft)	Dogleg Rate (°/100ft)	Build Rate (°/100ft)	Turn Rate (°/100ft)

Checked By: _____	Approved By: _____	Date: _____
-------------------	--------------------	-------------