

Location:	COLORADO	Slot:	SLOT#12 DRY CREEK 7-27 (483FNL & 809/FEL)
Field:	WELD COUNTY (KERR MCGEE)	Well:	DRY CREEK 7-27
Facility:	SEC.27-T1N-R67W	Wellbore:	DRY CREEK 7-27 PWB

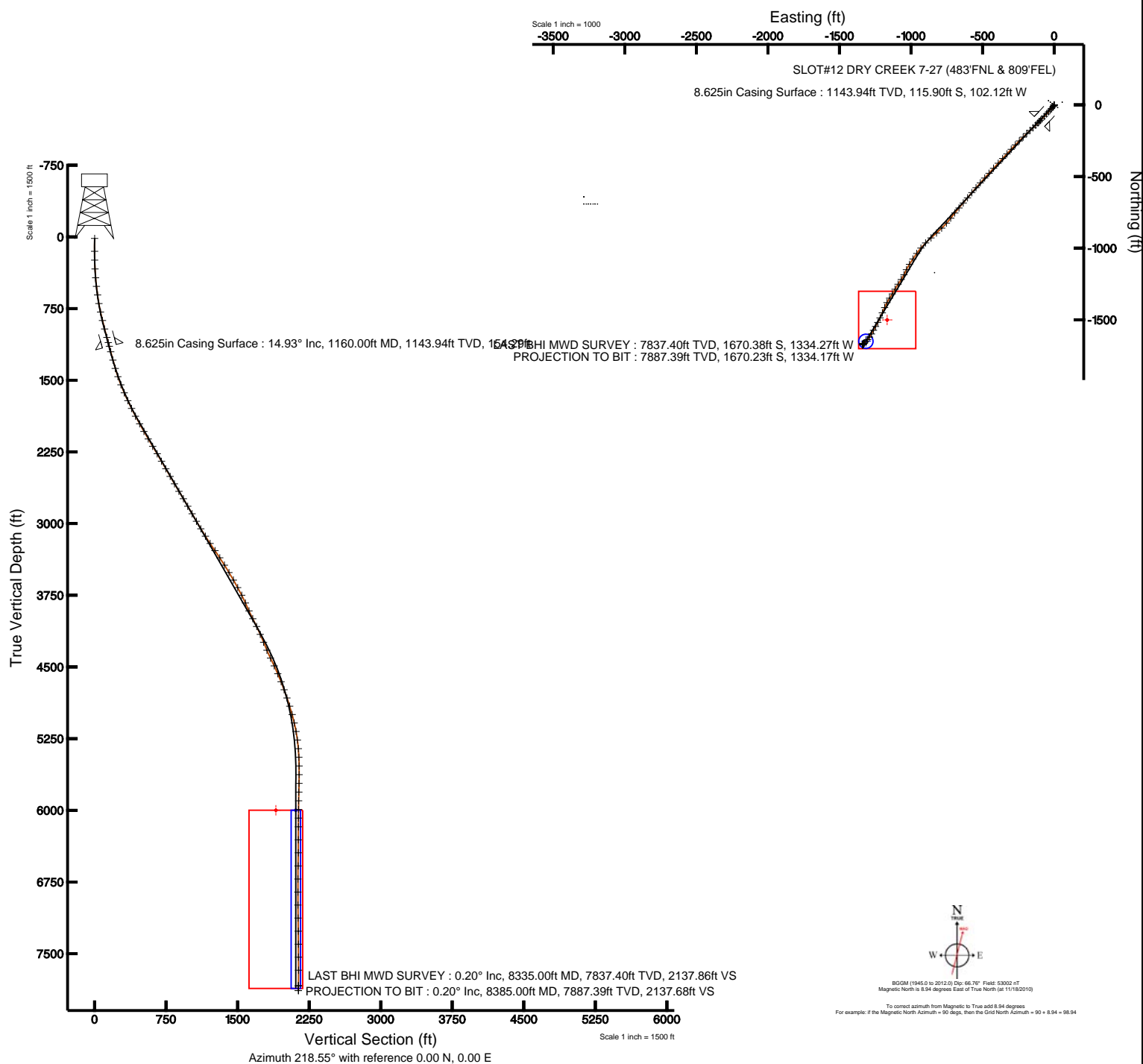

Post reference wellpath is DRY CREEK 77 (REV:L0) PWP	
True vertical depths are referenced to XTREME 12 (RKB)	Grid System: NAD83 / Lambert Colorado State Planes, Northern Zone (501), U.S. feet
Measured depths are referenced to XTREME 12 (RKB)	North Reference: True north
XTREME 12 (RKB) to Mean Sea Level: 5008 feet	Scale: True distance
Mean Sea Level to Mud line (Facility: SEC 27-T1N-R7W): 0 feet	Depths are in feet
Coordinates are in feet (easting): Not	Created by: croskinn on 12/28/2010





Actual Wellpath Report

DRY CREEK 7-27 AWP

Page 1 of 5



INTEQ

REFERENCE WELLPATH IDENTIFICATION

Operator	KERR MCGEE OIL & GAS ONSHORE LP	Slot	SLOT#12 DRY CREEK 7-27 (483'FNL & 809'FEL)
Area	COLORADO	Well	DRY CREEK 7-27
Field	WELD COUNTY (KERR MCGEE)	Wellbore	DRY CREEK 7-27 AWP
Facility	SEC.27-T1N-R67W		

REPORT SETUP INFORMATION

Projection System	NAD83 / Lambert Colorado State Planes, Northern Zone (501), US feet	Software System	WellArchitect® 2.0
North Reference	True	User	Cookdanm
Scale	0.999964	Report Generated	12/29/2010 at 10:42:10 AM
Convergence at slot	0.41° East	Database/Source file	Denver Server/DRY_CREEK_7-27_AWP.xml

WELLPATH LOCATION

	Local coordinates		Grid coordinates		Geographic coordinates	
	North[ft]	East[ft]	Easting[USft]	Northing[USft]	Latitude	Longitude
Slot Location	692.73	3286.65	3176379.61	1253684.21	40°01'40.912"N	104°52'12.554"W
Facility Reference Pt			3173097.99	1252968.61	40°01'34.068"N	104°52'54.804"W
Field Reference Pt			3197771.84	1268891.29	40°04'09.600"N	104°47'36.000"W

WELLPATH DATUM

Calculation method	Minimum curvature	XTREME 12 (RKB) to Facility Vertical Datum	5008.00ft
Horizontal Reference Pt	Slot	XTREME 12 (RKB) to Mean Sea Level	5008.00ft
Vertical Reference Pt	XTREME 12 (RKB)	Facility Vertical Datum to Mud Line (Facility)	0.00ft
MD Reference Pt	XTREME 12 (RKB)	Section Origin	N 0.00, E 0.00 ft
Field Vertical Reference	Mean Sea Level	Section Azimuth	218.55°



Actual Wellpath Report

DRY CREEK 7-27 AWP

Page 2 of 5



INTEQ

REFERENCE WELLPATH IDENTIFICATION

Operator	KERR MCGEE OIL & GAS ONSHORE LP	Slot	SLOT#12 DRY CREEK 7-27 (483'FNL & 809'FEL)
Area	COLORADO	Well	DRY CREEK 7-27
Field	WELD COUNTY (KERR MCGEE)	Wellbore	DRY CREEK 7-27 AWP
Facility	SEC.27-T1N-R67W		

WELLPATH DATA (88 stations) † = interpolated/extrapolated station

MD [ft]	Inclination [°]	Azimuth [°]	TVD [ft]	Vert Sect [ft]	North [ft]	East [ft]	DLS [°/100ft]	Comments
0.00†	0.000	122.900	0.00	0.00	0.00	0.00	0.00	
15.00	0.000	122.900	15.00	0.00	0.00	0.00	0.00	
150.00	0.800	122.900	150.00	-0.09	-0.51	0.79	0.59	
242.00	1.200	189.300	241.98	0.68	-1.81	1.17	1.24	
335.00	3.100	213.200	334.92	4.04	-4.88	-0.36	2.22	
427.00	4.700	221.600	426.70	10.28	-9.78	-4.22	1.84	
518.00	7.000	217.800	517.22	19.55	-16.95	-10.10	2.56	
608.00	7.700	222.300	606.48	31.05	-25.74	-17.52	1.01	
699.00	9.800	222.300	696.42	44.86	-35.98	-26.83	2.31	
790.00	12.100	221.600	785.75	62.12	-48.84	-38.38	2.53	
881.00	13.900	223.000	874.42	82.54	-63.97	-52.17	2.01	
972.00	14.800	224.100	962.58	105.01	-80.31	-67.71	1.03	
1064.00	15.500	224.500	1051.38	128.93	-97.52	-84.51	0.77	
1120.00	15.500	223.400	1105.34	143.83	-108.29	-94.89	0.52	
1219.00	14.100	224.100	1201.06	169.01	-126.56	-112.37	1.43	
1309.00	15.400	226.100	1288.09	191.77	-142.72	-128.61	1.55	
1400.00	16.600	226.900	1375.56	216.61	-159.98	-146.81	1.34	
1491.00	19.300	227.600	1462.13	244.33	-179.01	-167.41	2.98	
1582.00	21.500	225.900	1547.41	275.72	-200.76	-190.50	2.50	
1673.00	23.900	225.900	1631.36	310.55	-225.19	-215.71	2.64	
1763.00	25.800	225.200	1713.02	348.09	-251.68	-242.71	2.14	
1854.00	26.100	224.800	1794.85	387.65	-279.84	-270.86	0.38	
1945.00	27.800	221.600	1875.97	428.75	-309.92	-299.06	2.45	
2036.00	29.800	223.400	1955.71	472.47	-342.22	-328.69	2.40	
2127.00	29.100	223.000	2034.95	517.07	-374.83	-359.32	0.80	
2218.00	30.400	223.400	2113.95	562.07	-407.75	-390.23	1.45	
2309.00	32.200	222.000	2191.71	609.22	-442.50	-422.28	2.13	
2400.00	30.700	222.000	2269.34	656.61	-477.78	-454.04	1.65	
2490.00	29.700	223.400	2347.12	701.76	-511.06	-484.74	1.36	
2581.00	29.800	222.000	2426.13	746.80	-544.24	-515.36	0.77	
2673.00	29.100	219.900	2506.24	791.98	-578.39	-545.01	1.36	
2763.00	31.300	220.600	2584.02	837.23	-612.94	-574.26	2.48	
2854.00	31.100	219.900	2661.86	884.35	-648.91	-604.72	0.46	
2945.00	30.300	219.500	2740.11	930.80	-684.66	-634.40	0.91	
3036.00	30.500	220.900	2818.60	976.83	-719.83	-664.12	0.81	
3127.00	30.000	218.100	2897.21	1022.65	-755.19	-693.28	1.64	
3218.00	29.900	219.500	2976.06	1068.08	-790.59	-721.75	0.78	
3309.00	31.100	222.000	3054.47	1114.22	-825.56	-751.90	1.92	
3400.00	32.800	225.200	3131.69	1162.17	-860.40	-785.12	2.64	
3491.00	33.800	228.300	3207.75	1211.60	-894.61	-821.51	2.17	
3582.00	35.200	228.600	3282.74	1262.38	-928.79	-860.09	1.55	
3673.00	33.600	225.500	3357.83	1313.20	-963.79	-897.72	2.61	
3764.00	31.600	219.200	3434.51	1362.06	-999.93	-930.77	4.33	
3855.00	31.000	216.000	3512.27	1409.31	-1037.37	-959.61	1.94	
3946.00	30.600	213.900	3590.44	1455.81	-1075.55	-986.30	1.26	



Actual Wellpath Report

DRY CREEK 7-27 AWP

Page 3 of 5



INTEQ

REFERENCE WELLPATH IDENTIFICATION

Operator	KERR MCGEE OIL & GAS ONSHORE LP	Slot	SLOT#12 DRY CREEK 7-27 (483'FNL & 809'FEL)
Area	COLORADO	Well	DRY CREEK 7-27
Field	WELD COUNTY (KERR MCGEE)	Wellbore	DRY CREEK 7-27 AWP
Facility	SEC.27-T1N-R67W		

WELLPATH DATA (88 stations)

MD [ft]	Inclination [°]	Azimuth [°]	TVD [ft]	Vert Sect [ft]	North [ft]	East [ft]	DLS [°/100ft]	Comments
4037.00	28.400	212.500	3669.64	1500.42	-1113.03	-1010.85	2.53	
4128.00	28.200	205.500	3749.79	1542.90	-1150.70	-1031.74	3.65	
4218.00	24.200	206.500	3830.52	1581.67	-1186.42	-1049.14	4.47	
4309.00	24.700	213.900	3913.38	1618.87	-1218.90	-1068.07	3.41	
4400.00	27.300	213.600	3995.16	1658.62	-1252.07	-1090.22	2.86	
4491.00	25.800	208.900	4076.58	1698.94	-1286.79	-1111.35	2.84	
4582.00	24.200	211.800	4159.05	1736.99	-1319.98	-1130.75	2.21	
4672.00	22.200	212.800	4241.77	1772.23	-1349.96	-1149.68	2.26	
4763.00	23.700	208.600	4325.57	1807.35	-1380.47	-1167.75	2.44	
4854.00	26.200	203.000	4408.08	1844.73	-1415.03	-1184.36	3.78	
4944.00	26.500	204.000	4488.73	1883.31	-1451.66	-1200.29	0.60	
5035.00	23.700	204.800	4571.13	1920.73	-1486.81	-1216.22	3.10	
5126.00	22.100	208.300	4654.96	1955.34	-1518.49	-1232.01	2.31	
5216.00	20.100	208.300	4738.92	1987.22	-1547.02	-1247.37	2.22	
5307.00	19.200	208.600	4824.62	2017.35	-1573.92	-1261.94	1.00	
5398.00	18.000	209.700	4910.86	2045.98	-1599.28	-1276.07	1.37	
5489.00	15.000	214.600	4998.11	2071.63	-1621.19	-1289.73	3.63	
5580.00	12.700	220.900	5086.47	2093.38	-1638.45	-1302.97	3.02	
5671.00	10.700	222.200	5175.57	2111.81	-1652.27	-1315.20	2.22	
5762.00	8.100	224.800	5265.34	2126.61	-1663.08	-1325.39	2.89	
5853.00	4.900	215.300	5355.75	2136.87	-1670.80	-1332.15	3.70	
5943.00	1.900	233.600	5445.58	2142.15	-1674.82	-1335.58	3.50	
6034.00	1.100	258.900	5536.55	2144.27	-1675.89	-1337.65	1.12	
6125.00	0.900	320.000	5627.54	2144.79	-1675.51	-1338.97	1.13	
6216.00	1.500	27.200	5718.52	2143.48	-1673.90	-1338.88	1.56	
6307.00	0.900	30.700	5809.50	2141.61	-1672.23	-1337.97	0.66	
6398.00	1.000	32.100	5900.49	2140.11	-1670.94	-1337.18	0.11	
6489.00	0.900	13.500	5991.48	2138.67	-1669.57	-1336.60	0.35	
6580.00	0.600	30.400	6082.47	2137.56	-1668.46	-1336.19	0.41	
6671.00	0.400	29.300	6173.46	2136.77	-1667.78	-1335.79	0.22	
6807.00	0.100	106.000	6309.46	2136.26	-1667.40	-1335.44	0.29	
6943.00	0.700	102.500	6445.46	2135.85	-1667.61	-1334.52	0.44	
7080.00	1.000	41.600	6582.45	2134.28	-1666.89	-1332.91	0.66	
7217.00	0.500	59.900	6719.43	2132.53	-1665.70	-1331.60	0.40	
7354.00	0.200	101.400	6856.43	2131.87	-1665.45	-1330.85	0.27	
7490.00	0.400	204.400	6992.43	2132.22	-1665.93	-1330.81	0.36	
7626.00	1.000	217.100	7128.42	2133.87	-1667.31	-1331.72	0.45	
7763.00	0.600	251.500	7265.41	2135.66	-1668.49	-1333.12	0.44	
7899.00	0.500	232.500	7401.40	2136.84	-1669.07	-1334.27	0.15	
8035.00	0.400	189.300	7537.40	2137.83	-1669.90	-1334.82	0.25	
8172.00	0.200	116.900	7674.40	2138.20	-1670.48	-1334.68	0.28	
8335.00	0.200	33.600	7837.40	2137.86	-1670.38	-1334.27	0.16	LAST BHI MWD SURVEY
8385.00	0.200	33.600	7887.39	2137.68	-1670.23	-1334.17	0.00	PROJECTION TO BIT



Actual Wellpath Report

DRY CREEK 7-27 AWP

Page 4 of 5



INTEQ

REFERENCE WELLPATH IDENTIFICATION

Operator	KERR MCGEE OIL & GAS ONSHORE LP	Slot	SLOT#12 DRY CREEK 7-27 (483'FNL & 809'FEL)
Area	COLORADO	Well	DRY CREEK 7-27
Field	WELD COUNTY (KERR MCGEE)	Wellbore	DRY CREEK 7-27 AWP
Facility	SEC.27-T1N-R67W		

HOLE & CASING SECTIONS Ref Wellbore: DRY CREEK 7-27 AWP Ref Wellpath: DRY CREEK 7-27 AWP

String/Diameter	Start MD [ft]	End MD [ft]	Interval [ft]	Start TVD [ft]	End TVD [ft]	Start N/S [ft]	Start E/W [ft]	End N/S [ft]	End E/W [ft]
12.25in Open Hole	15.00	1175.00	1160.00	15.00	1158.44	0.00	0.00	-118.68	-104.78
8.625in Casing Surface	15.00	1160.00	1145.00	15.00	1143.94	0.00	0.00	-115.90	-102.12
7.875in Open Hole	1160.00	8385.00	7225.00	1143.94	7887.39	-115.90	-102.12	-1670.23	-1334.17

TARGETS

Name	MD [ft]	TVD [ft]	North [ft]	East [ft]	Grid East [srv ft]	Grid North [srv ft]	Latitude	Longitude	Shape
DRY CREEK 7-27 GEO TARGET 50' RADIUS (2130'FNL & 2130'FEL, REV-1)		6000.00	-1650.56	-1315.20	3175076.22	1252024.41	40°01'24.600"N	104°52'29.460"W	circle
DRY CREEK 7-27 LEGAL BOX (51'S,349'N,51'W,349'E OF GEO TARGET)		6000.00	-1501.55	-1166.20	3175224.15	1252174.47	40°01'26.073"N	104°52'27.545"W	square

WELLPATH COMPOSITION Ref Wellbore: DRY CREEK 7-27 AWP Ref Wellpath: DRY CREEK 7-27 AWP

Start MD [ft]	End MD [ft]	Positional Uncertainty Model	Log Name/Comment	Wellbore
15.00	1120.00	NaviTrak (Standard)	BHI MWD SURVEYS 12.25 HOLE <150-1120>	DRY CREEK 7-27 AWP
1120.00	8335.00	NaviTrak (Standard)	BHI MWD SURVEYS 7.875 HOLE <1219-8335>	DRY CREEK 7-27 AWP
8335.00	8385.00	Blind Drilling (std)	Projection to bit	DRY CREEK 7-27 AWP



Actual Wellpath Report

DRY CREEK 7-27 AWP

Page 5 of 5



INTEQ

REFERENCE WELLPATH IDENTIFICATION

Operator	KERR MCGEE OIL & GAS ONSHORE LP	Slot	SLOT#12 DRY CREEK 7-27 (483'FNL & 809'FEL)
Area	COLORADO	Well	DRY CREEK 7-27
Field	WELD COUNTY (KERR MCGEE)	Wellbore	DRY CREEK 7-27 AWB
Facility	SEC.27-T1N-R67W		

WELLPATH COMMENTS

MD [ft]	Inclination [°]	Azimuth [°]	TVD [ft]	Comment
8335.00	0.200	33.600	7837.40	LAST BHI MWD SURVEY
8385.00	0.200	33.600	7887.39	PROJECTION TO BIT