

US ROCKIES REGION PLANNING

COLORADO NORTHERN ZONE - 83

WELD_PARADIZE 4-15HZ

PARADIZE 4-15HZ

PARADIZE 4-15HZ

Plan: PARADIZE 4-15HZ (wp02)

Standard Planning Report

03 February, 2011





Azimuths to True North
Magnetic North: 8.95°

Magnetic Field
Strength: 53015.3snT
Dip Angle: 66.83°
Date: 2/1/2011
Model: IGRF2010

Project: COLORADO NORTHERN ZONE - 83
Site: WELD PARADIZE 4-15HZ
Well: PARADIZE 4-15HZ
Wellbore: PARADIZE 4-15HZ
Section:
SHL:
Design: PARADIZE 4-15HZ (wp02)
Latitude: 40.132254
Longitude: -104.878514
GL: 4997.00
KB: (17' RKB + 4997' GL) @ 5014.00ft

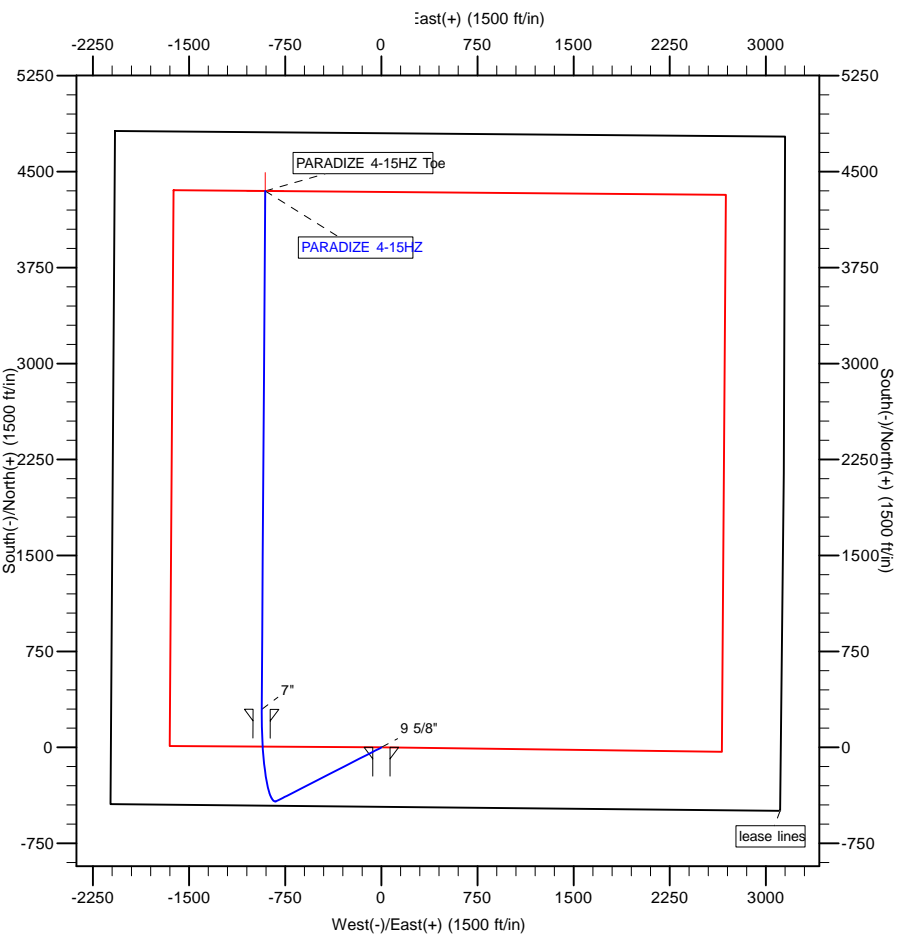

WELL DETAILS: PARADIZE 4-15HZ						
+N-S	+E-W	Northing	Ground Level: Easting	4997.00 Latitude 40.132254	Longitude -104.878514	Slot
0.00	0.00	1291632.80	3173772.46			

SECTION DETAILS									
MD	Inc	Azi	TVD	+N-S	+E-W	Dleg	TFace	Vsect	Target
0.00	0.00	0.00	0.00	0.00	0.00	0.00	0.00	0.00	
1150.00	0.00	0.00	1150.00	0.00	0.00	0.00	0.00	0.00	
1648.15	9.96	242.85	1645.64	-19.72	-38.44	2.00	242.85	-11.46	
6718.82	9.96	242.85	6639.85	-420.08	-819.04	0.00	0.00	-244.10	
7903.57	90.20	0.36	7404.00	297.00	-934.00	8.00	117.13	481.35	
8217.18	90.21	0.39	7402.88	610.61	-931.95	0.01	61.29	787.94	
11955.85	90.21	0.39	7389.00	4349.16	-906.62	0.00	0.00	4442.65	PARADIZE 4-15HZ Toe

WELLBORE TARGET DETAILS (MAP CO-ORDINATES AND LAT/LONG)						
Name	TVD	+N-S	+E-W	Latitude	Longitude	Shape
PARADIZE 4-15HZ Toe	7389.00	4349.16	-906.62	40.144193	-104.881757	Point

FORMATION TOP DETAILS		
TVDPath	MDPath	Formation
349.00	349.00	FOX HILLS
3177.00	3202.95	PARKMAN
4500.00	4546.21	SUSSEX
5060.00	5114.78	SHANNON
7264.00	7442.77	SHARON SPRINGS
7338.00	7589.28	NIOBRARA A CHALK
7373.00	7688.28	NIOBRARA B UPPER MARL
7392.00	7768.96	NIOBRARA B CHALK TARGET

CASING DETAILS			
TVD	MD	Name	Size
1000.00	1000.00	9 5/8"	9-5/8
7404.00	7903.57	7"	7

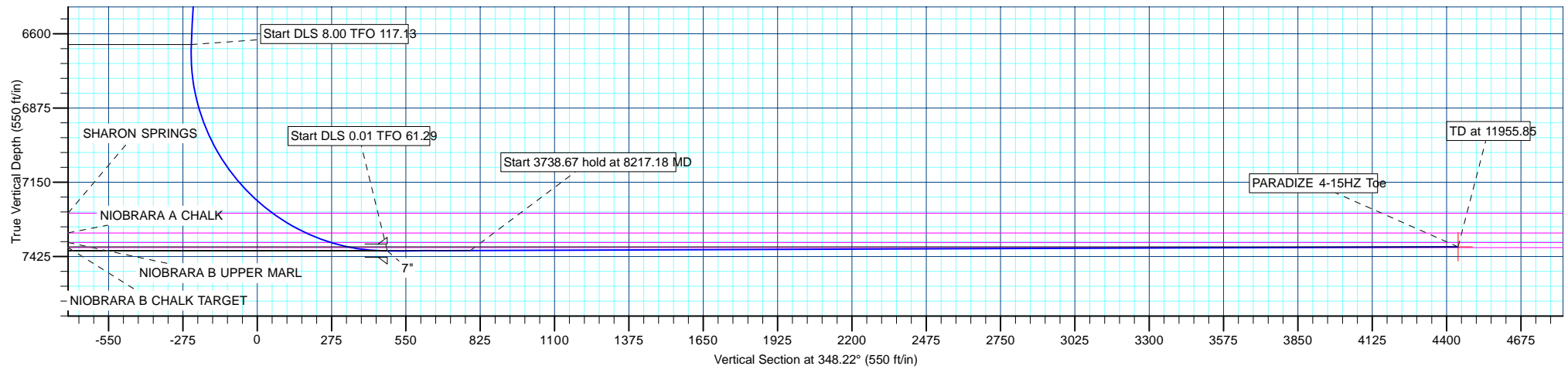

Database:	edm5000p	Local Co-ordinate Reference:	Well PARADIZE 4-15HZ
Company:	US ROCKIES REGION PLANNING	TVD Reference:	(17' RKB + 4997' GL) @ 5014.00ft
Project:	COLORADO NORTHERN ZONE - 83	MD Reference:	(17' RKB + 4997' GL) @ 5014.00ft
Site:	WELD_PARADIZE 4-15HZ	North Reference:	True
Well:	PARADIZE 4-15HZ	Survey Calculation Method:	Minimum Curvature
Wellbore:	PARADIZE 4-15HZ		
Design:	PARADIZE 4-15HZ (wp02)		

Project	COLORADO NORTHERN ZONE - 83		
Map System:	US State Plane 1983	System Datum:	Mean Sea Level
Geo Datum:	North American Datum 1983		
Map Zone:	Colorado Northern Zone		

Site		WELD_PARADIZE 4-15HZ			
Site Position:		Northing:	1,291,632.81 ft	Latitude:	40.132254
From:	Lat/Long	Easting:	3,173,772.46 ft	Longitude:	-104.878514
Position Uncertainty:	0.00 ft	Slot Radius:	0 "	Grid Convergence:	0.40

Well	PARADIZE 4-15HZ					
Well Position	+N-S	-0.01 ft	Northing:	1,291,632.80 ft	Latitude:	40.132254
	+E-W	0.00 ft	Easting:	3,173,772.46 ft	Longitude:	-104.878514
Position Uncertainty		0.00 ft	Wellhead Elevation:		Ground Level:	4,997.00 ft

Wellbore	PARADIZE 4-15HZ				
Magnetics	Model Name	Sample Date	Declination (°)	Dip Angle (°)	Field Strength (nT)
	IGRF2010	2/1/2011	8.95	66.83	53,015

Design	PARADIZE 4-15HZ (wp02)			
Audit Notes:				
Version:	Phase:	PLAN	Tie On Depth:	0.00
Vertical Section:	Depth From (TVD) (ft)	+N/-S (ft)	+E/-W (ft)	Direction (°)
	0.00	0.00	0.00	348.22

Plan Sections										
Measured Depth (ft)	Inclination (°)	Azimuth (°)	Vertical Depth (ft)	+N/-S (ft)	+E/-W (ft)	Dogleg Rate (°/100ft)	Build Rate (°/100ft)	Turn Rate (°/100ft)	TFO (°)	Target
0.00	0.00	0.00	0.00	0.00	0.00	0.00	0.00	0.00	0.00	
1,150.00	0.00	0.00	1,150.00	0.00	0.00	0.00	0.00	0.00	0.00	
1,648.15	9.96	242.85	1,645.64	-19.72	-38.44	2.00	2.00	0.00	242.85	
6,718.82	9.96	242.85	6,639.85	-420.08	-819.04	0.00	0.00	0.00	0.00	
7,903.57	90.20	0.36	7,404.00	297.00	-934.00	8.00	6.77	9.92	117.13	
8,217.18	90.21	0.39	7,402.88	610.61	-931.95	0.01	0.00	0.01	61.29	
11,955.85	90.21	0.39	7,389.00	4,349.16	-906.62	0.00	0.00	0.00	0.00	PARADIZE 4-15HZ

Database:	edm5000p	Local Co-ordinate Reference:	Well PARADIZE 4-15HZ
Company:	US ROCKIES REGION PLANNING	TVD Reference:	(17' RKB + 4997' GL) @ 5014.00ft
Project:	COLORADO NORTHERN ZONE - 83	MD Reference:	(17' RKB + 4997' GL) @ 5014.00ft
Site:	WELD_PARADIZE 4-15HZ	North Reference:	True
Well:	PARADIZE 4-15HZ	Survey Calculation Method:	Minimum Curvature
Wellbore:	PARADIZE 4-15HZ		
Design:	PARADIZE 4-15HZ (wp02)		

Planned Survey									
Measured Depth (ft)	Inclination (°)	Azimuth (°)	Vertical Depth (ft)	+N/-S (ft)	+E/-W (ft)	Vertical Section (ft)	Dogleg Rate (°/100ft)	Build Rate (°/100ft)	Turn Rate (°/100ft)
0.00	0.00	0.00	0.00	0.00	0.00	0.00	0.00	0.00	0.00
100.00	0.00	0.00	100.00	0.00	0.00	0.00	0.00	0.00	0.00
200.00	0.00	0.00	200.00	0.00	0.00	0.00	0.00	0.00	0.00
300.00	0.00	0.00	300.00	0.00	0.00	0.00	0.00	0.00	0.00
349.00	0.00	0.00	349.00	0.00	0.00	0.00	0.00	0.00	0.00
FOX HILLS									
400.00	0.00	0.00	400.00	0.00	0.00	0.00	0.00	0.00	0.00
500.00	0.00	0.00	500.00	0.00	0.00	0.00	0.00	0.00	0.00
600.00	0.00	0.00	600.00	0.00	0.00	0.00	0.00	0.00	0.00
700.00	0.00	0.00	700.00	0.00	0.00	0.00	0.00	0.00	0.00
800.00	0.00	0.00	800.00	0.00	0.00	0.00	0.00	0.00	0.00
900.00	0.00	0.00	900.00	0.00	0.00	0.00	0.00	0.00	0.00
1,000.00	0.00	0.00	1,000.00	0.00	0.00	0.00	0.00	0.00	0.00
9 5/8"									
1,100.00	0.00	0.00	1,100.00	0.00	0.00	0.00	0.00	0.00	0.00
1,150.00	0.00	0.00	1,150.00	0.00	0.00	0.00	0.00	0.00	0.00
Start Build 2.00									
1,200.00	1.00	242.85	1,200.00	-0.20	-0.39	-0.12	2.00	2.00	0.00
1,300.00	3.00	242.85	1,299.93	-1.79	-3.49	-1.04	2.00	2.00	0.00
1,400.00	5.00	242.85	1,399.68	-4.98	-9.70	-2.89	2.00	2.00	0.00
1,500.00	7.00	242.85	1,499.13	-9.75	-19.00	-5.66	2.00	2.00	0.00
1,600.00	9.00	242.85	1,598.15	-16.10	-31.38	-9.35	2.00	2.00	0.00
1,648.15	9.96	242.85	1,645.64	-19.72	-38.44	-11.46	2.00	2.00	0.00
Start 5070.67 hold at 1648.15 MD									
1,700.00	9.96	242.85	1,696.71	-23.81	-46.42	-13.84	0.00	0.00	0.00
1,800.00	9.96	242.85	1,795.20	-31.71	-61.82	-18.42	0.00	0.00	0.00
1,900.00	9.96	242.85	1,893.70	-39.60	-77.21	-23.01	0.00	0.00	0.00
2,000.00	9.96	242.85	1,992.19	-47.50	-92.61	-27.60	0.00	0.00	0.00
2,100.00	9.96	242.85	2,090.68	-55.39	-108.00	-32.19	0.00	0.00	0.00
2,200.00	9.96	242.85	2,189.17	-63.29	-123.40	-36.78	0.00	0.00	0.00
2,300.00	9.96	242.85	2,287.66	-71.18	-138.79	-41.36	0.00	0.00	0.00
2,400.00	9.96	242.85	2,386.16	-79.08	-154.18	-45.95	0.00	0.00	0.00
2,500.00	9.96	242.85	2,484.65	-86.98	-169.58	-50.54	0.00	0.00	0.00
2,600.00	9.96	242.85	2,583.14	-94.87	-184.97	-55.13	0.00	0.00	0.00
2,700.00	9.96	242.85	2,681.63	-102.77	-200.37	-59.72	0.00	0.00	0.00
2,800.00	9.96	242.85	2,780.12	-110.66	-215.76	-64.30	0.00	0.00	0.00
2,900.00	9.96	242.85	2,878.62	-118.56	-231.16	-68.89	0.00	0.00	0.00
3,000.00	9.96	242.85	2,977.11	-126.46	-246.55	-73.48	0.00	0.00	0.00
3,100.00	9.96	242.85	3,075.60	-134.35	-261.95	-78.07	0.00	0.00	0.00
3,200.00	9.96	242.85	3,174.09	-142.25	-277.34	-82.66	0.00	0.00	0.00
3,202.95	9.96	242.85	3,177.00	-142.48	-277.79	-82.79	0.00	0.00	0.00
PARKMAN									
3,300.00	9.96	242.85	3,272.58	-150.14	-292.73	-87.24	0.00	0.00	0.00
3,400.00	9.96	242.85	3,371.07	-158.04	-308.13	-91.83	0.00	0.00	0.00
3,500.00	9.96	242.85	3,469.57	-165.93	-323.52	-96.42	0.00	0.00	0.00
3,600.00	9.96	242.85	3,568.06	-173.83	-338.92	-101.01	0.00	0.00	0.00
3,700.00	9.96	242.85	3,666.55	-181.73	-354.31	-105.60	0.00	0.00	0.00
3,800.00	9.96	242.85	3,765.04	-189.62	-369.71	-110.18	0.00	0.00	0.00
3,900.00	9.96	242.85	3,863.53	-197.52	-385.10	-114.77	0.00	0.00	0.00
4,000.00	9.96	242.85	3,962.03	-205.41	-400.50	-119.36	0.00	0.00	0.00
4,100.00	9.96	242.85	4,060.52	-213.31	-415.89	-123.95	0.00	0.00	0.00
4,200.00	9.96	242.85	4,159.01	-221.20	-431.28	-128.54	0.00	0.00	0.00
4,300.00	9.96	242.85	4,257.50	-229.10	-446.68	-133.12	0.00	0.00	0.00
4,400.00	9.96	242.85	4,355.99	-237.00	-462.07	-137.71	0.00	0.00	0.00

Database:	edm5000p	Local Co-ordinate Reference:	Well PARADIZE 4-15HZ
Company:	US ROCKIES REGION PLANNING	TVD Reference:	(17' RKB + 4997' GL) @ 5014.00ft
Project:	COLORADO NORTHERN ZONE - 83	MD Reference:	(17' RKB + 4997' GL) @ 5014.00ft
Site:	WELD_PARADIZE 4-15HZ	North Reference:	True
Well:	PARADIZE 4-15HZ	Survey Calculation Method:	Minimum Curvature
Wellbore:	PARADIZE 4-15HZ		
Design:	PARADIZE 4-15HZ (wp02)		

Planned Survey									
Measured Depth (ft)	Inclination (°)	Azimuth (°)	Vertical Depth (ft)	+N/-S (ft)	+E/-W (ft)	Vertical Section (ft)	Dogleg Rate (°/100ft)	Build Rate (°/100ft)	Turn Rate (°/100ft)
4,500.00	9.96	242.85	4,454.49	-244.89	-477.47	-142.30	0.00	0.00	0.00
4,546.21	9.96	242.85	4,500.00	-248.54	-484.58	-144.42	0.00	0.00	0.00
SUSSEX									
4,600.00	9.96	242.85	4,552.98	-252.79	-492.86	-146.89	0.00	0.00	0.00
4,700.00	9.96	242.85	4,651.47	-260.68	-508.26	-151.48	0.00	0.00	0.00
4,800.00	9.96	242.85	4,749.96	-268.58	-523.65	-156.06	0.00	0.00	0.00
4,900.00	9.96	242.85	4,848.45	-276.47	-539.05	-160.65	0.00	0.00	0.00
5,000.00	9.96	242.85	4,946.95	-284.37	-554.44	-165.24	0.00	0.00	0.00
5,100.00	9.96	242.85	5,045.44	-292.27	-569.83	-169.83	0.00	0.00	0.00
5,114.78	9.96	242.85	5,060.00	-293.43	-572.11	-170.51	0.00	0.00	0.00
SHANNON									
5,200.00	9.96	242.85	5,143.93	-300.16	-585.23	-174.42	0.00	0.00	0.00
5,300.00	9.96	242.85	5,242.42	-308.06	-600.62	-179.00	0.00	0.00	0.00
5,400.00	9.96	242.85	5,340.91	-315.95	-616.02	-183.59	0.00	0.00	0.00
5,500.00	9.96	242.85	5,439.41	-323.85	-631.41	-188.18	0.00	0.00	0.00
5,600.00	9.96	242.85	5,537.90	-331.74	-646.81	-192.77	0.00	0.00	0.00
5,700.00	9.96	242.85	5,636.39	-339.64	-662.20	-197.36	0.00	0.00	0.00
5,800.00	9.96	242.85	5,734.88	-347.54	-677.60	-201.95	0.00	0.00	0.00
5,900.00	9.96	242.85	5,833.37	-355.43	-692.99	-206.53	0.00	0.00	0.00
6,000.00	9.96	242.85	5,931.87	-363.33	-708.39	-211.12	0.00	0.00	0.00
6,100.00	9.96	242.85	6,030.36	-371.22	-723.78	-215.71	0.00	0.00	0.00
6,200.00	9.96	242.85	6,128.85	-379.12	-739.17	-220.30	0.00	0.00	0.00
6,300.00	9.96	242.85	6,227.34	-387.02	-754.57	-224.89	0.00	0.00	0.00
6,400.00	9.96	242.85	6,325.83	-394.91	-769.96	-229.47	0.00	0.00	0.00
6,500.00	9.96	242.85	6,424.33	-402.81	-785.36	-234.06	0.00	0.00	0.00
6,600.00	9.96	242.85	6,522.82	-410.70	-800.75	-238.65	0.00	0.00	0.00
6,700.00	9.96	242.85	6,621.31	-418.60	-816.15	-243.24	0.00	0.00	0.00
6,718.82	9.96	242.85	6,639.85	-420.08	-819.04	-244.10	0.00	0.00	0.00
Start DLS 8.00 TFO 117.13									
6,800.00	9.06	282.58	6,719.99	-421.90	-831.54	-243.33	8.00	-1.11	48.94
6,900.00	13.27	318.95	6,818.19	-411.51	-846.79	-230.05	8.00	4.20	36.37
7,000.00	19.92	334.86	6,914.02	-387.40	-861.58	-203.42	8.00	6.65	15.91
7,100.00	27.29	342.75	7,005.62	-350.03	-875.64	-163.97	8.00	7.37	7.89
7,200.00	34.92	347.43	7,091.19	-300.12	-888.69	-112.45	8.00	7.63	4.68
7,300.00	42.67	350.60	7,169.08	-238.65	-900.47	-49.87	8.00	7.75	3.17
7,400.00	50.49	352.95	7,237.77	-166.82	-910.77	22.55	8.00	7.82	2.35
7,442.77	53.84	353.79	7,264.00	-133.27	-914.66	56.19	8.00	7.85	1.98
SHARON SPRINGS									
7,500.00	58.34	354.82	7,295.92	-86.02	-919.36	103.41	8.00	7.86	1.79
7,589.28	65.37	356.23	7,338.00	-7.59	-925.47	181.44	8.00	7.88	1.59
NIOBRARA A CHALK									
7,600.00	66.22	356.39	7,342.40	2.17	-926.10	191.12	8.00	7.89	1.48
7,688.28	73.19	357.63	7,373.00	84.81	-930.39	272.89	8.00	7.89	1.40
NIOBRARA B UPPER MARL									
7,700.00	74.11	357.79	7,376.30	96.04	-930.84	283.98	8.00	7.90	1.34
7,768.96	79.56	358.68	7,392.00	163.13	-932.90	350.08	8.00	7.90	1.30
NIOBRARA B CHALK TARGET									
7,800.00	82.01	359.08	7,396.97	193.77	-933.50	380.19	8.00	7.90	1.26
7,900.00	89.92	0.32	7,404.00	293.43	-934.02	477.87	8.00	7.90	1.24
7,903.57	90.20	0.36	7,404.00	297.00	-934.00	481.36	7.99	7.89	1.23
Start DLS 0.01 TFO 61.29 - 7"									
8,000.00	90.20	0.37	7,403.66	393.43	-933.39	575.63	0.01	0.00	0.01
8,100.00	90.21	0.38	7,403.31	493.43	-932.73	673.39	0.01	0.00	0.01

Database:	edm5000p	Local Co-ordinate Reference:	Well PARADIZE 4-15HZ
Company:	US ROCKIES REGION PLANNING	TVD Reference:	(17' RKB + 4997' GL) @ 5014.00ft
Project:	COLORADO NORTHERN ZONE - 83	MD Reference:	(17' RKB + 4997' GL) @ 5014.00ft
Site:	WELD_PARADIZE 4-15HZ	North Reference:	True
Well:	PARADIZE 4-15HZ	Survey Calculation Method:	Minimum Curvature
Wellbore:	PARADIZE 4-15HZ		
Design:	PARADIZE 4-15HZ (wp02)		

Planned Survey

Measured Depth (ft)	Inclination (°)	Azimuth (°)	Vertical Depth (ft)	+N/-S (ft)	+E/-W (ft)	Vertical Section (ft)	Dogleg Rate (°/100ft)	Build Rate (°/100ft)	Turn Rate (°/100ft)
8,200.00	90.21	0.39	7,402.94	593.43	-932.07	771.15	0.01	0.00	0.01
8,217.18	90.21	0.39	7,402.88	610.61	-931.95	787.94	0.01	0.00	0.01
Start 3738.67 hold at 8217.18 MD									
8,300.00	90.21	0.39	7,402.57	693.42	-931.39	868.90	0.00	0.00	0.00
8,400.00	90.21	0.39	7,402.20	793.42	-930.71	966.66	0.00	0.00	0.00
8,500.00	90.21	0.39	7,401.83	893.42	-930.03	1,064.41	0.00	0.00	0.00
8,600.00	90.21	0.39	7,401.46	993.41	-929.36	1,162.16	0.00	0.00	0.00
8,700.00	90.21	0.39	7,401.09	1,093.41	-928.68	1,259.92	0.00	0.00	0.00
8,800.00	90.21	0.39	7,400.71	1,193.41	-928.00	1,357.67	0.00	0.00	0.00
8,900.00	90.21	0.39	7,400.34	1,293.41	-927.32	1,455.43	0.00	0.00	0.00
9,000.00	90.21	0.39	7,399.97	1,393.40	-926.65	1,553.18	0.00	0.00	0.00
9,100.00	90.21	0.39	7,399.60	1,493.40	-925.97	1,650.94	0.00	0.00	0.00
9,200.00	90.21	0.39	7,399.23	1,593.40	-925.29	1,748.69	0.00	0.00	0.00
9,300.00	90.21	0.39	7,398.86	1,693.39	-924.61	1,846.44	0.00	0.00	0.00
9,400.00	90.21	0.39	7,398.49	1,793.39	-923.94	1,944.20	0.00	0.00	0.00
9,500.00	90.21	0.39	7,398.12	1,893.39	-923.26	2,041.95	0.00	0.00	0.00
9,600.00	90.21	0.39	7,397.74	1,993.38	-922.58	2,139.71	0.00	0.00	0.00
9,700.00	90.21	0.39	7,397.37	2,093.38	-921.90	2,237.46	0.00	0.00	0.00
9,800.00	90.21	0.39	7,397.00	2,193.38	-921.23	2,335.22	0.00	0.00	0.00
9,900.00	90.21	0.39	7,396.63	2,293.38	-920.55	2,432.97	0.00	0.00	0.00
10,000.00	90.21	0.39	7,396.26	2,393.37	-919.87	2,530.73	0.00	0.00	0.00
10,100.00	90.21	0.39	7,395.89	2,493.37	-919.19	2,628.48	0.00	0.00	0.00
10,200.00	90.21	0.39	7,395.52	2,593.37	-918.51	2,726.23	0.00	0.00	0.00
10,300.00	90.21	0.39	7,395.15	2,693.36	-917.84	2,823.99	0.00	0.00	0.00
10,400.00	90.21	0.39	7,394.78	2,793.36	-917.16	2,921.74	0.00	0.00	0.00
10,500.00	90.21	0.39	7,394.40	2,893.36	-916.48	3,019.50	0.00	0.00	0.00
10,600.00	90.21	0.39	7,394.03	2,993.35	-915.80	3,117.25	0.00	0.00	0.00
10,700.00	90.21	0.39	7,393.66	3,093.35	-915.13	3,215.01	0.00	0.00	0.00
10,800.00	90.21	0.39	7,393.29	3,193.35	-914.45	3,312.76	0.00	0.00	0.00
10,900.00	90.21	0.39	7,392.92	3,293.35	-913.77	3,410.52	0.00	0.00	0.00
11,000.00	90.21	0.39	7,392.55	3,393.34	-913.09	3,508.27	0.00	0.00	0.00
11,100.00	90.21	0.39	7,392.18	3,493.34	-912.42	3,606.02	0.00	0.00	0.00
11,200.00	90.21	0.39	7,391.81	3,593.34	-911.74	3,703.78	0.00	0.00	0.00
11,300.00	90.21	0.39	7,391.43	3,693.33	-911.06	3,801.53	0.00	0.00	0.00
11,400.00	90.21	0.39	7,391.06	3,793.33	-910.38	3,899.29	0.00	0.00	0.00
11,500.00	90.21	0.39	7,390.69	3,893.33	-909.71	3,997.04	0.00	0.00	0.00
11,600.00	90.21	0.39	7,390.32	3,993.33	-909.03	4,094.80	0.00	0.00	0.00
11,700.00	90.21	0.39	7,389.95	4,093.32	-908.35	4,192.55	0.00	0.00	0.00
11,800.00	90.21	0.39	7,389.58	4,193.32	-907.67	4,290.31	0.00	0.00	0.00
11,900.00	90.21	0.39	7,389.21	4,293.32	-907.00	4,388.06	0.00	0.00	0.00
11,955.85	90.21	0.39	7,389.00	4,349.16	-906.62	4,442.65	0.00	0.00	0.00
TD at 11955.85 - PARADIZE 4-15HZ Toe									

Design Targets

Target Name	Dip Angle (°)	Dip Dir. (°)	TVD (ft)	+N/-S (ft)	+E/-W (ft)	Northing (ft)	Easting (ft)	Latitude	Longitude
PARADIZE 4-15HZ Tc - hit/miss target - Shape - plan hits target center - Point	0.00	0.00	7,389.00	4,349.16	-906.62	1,295,975.50	3,172,835.38	40.144193	-104.881757

Database:	edm5000p	Local Co-ordinate Reference:	Well PARADIZE 4-15HZ
Company:	US ROCKIES REGION PLANNING	TVD Reference:	(17' RKB + 4997' GL) @ 5014.00ft
Project:	COLORADO NORTHERN ZONE - 83	MD Reference:	(17' RKB + 4997' GL) @ 5014.00ft
Site:	WELD_PARADIZE 4-15HZ	North Reference:	True
Well:	PARADIZE 4-15HZ	Survey Calculation Method:	Minimum Curvature
Wellbore:	PARADIZE 4-15HZ		
Design:	PARADIZE 4-15HZ (wp02)		

Casing Points					
Measured Depth (ft)	Vertical Depth (ft)	Name	Casing Diameter (")	Hole Diameter (")	
1,000.00	1,000.00	9 5/8"	9-5/8	12-1/4	
7,903.57	7,404.00	7"	7	8-3/4	

Formations					
Measured Depth (ft)	Vertical Depth (ft)	Name	Lithology	Dip (°)	Dip Direction (°)
349.00	-4,665.00	FOX HILLS		0.00	
3,202.95	-1,837.00	PARKMAN		0.00	
4,546.21	-514.00	SUSSEX		0.00	
5,114.78	46.00	SHANNON		0.00	
7,442.77	2,250.00	SHARON SPRINGS		0.00	
7,589.28	2,324.00	NIOBRARA A CHALK		0.00	
7,688.28	2,359.00	NIOBRARA B UPPER MARL		0.00	
7,768.96	2,378.00	NIOBRARA B CHALK TARGET		0.00	

Plan Annotations				
Measured Depth (ft)	Vertical Depth (ft)	Local Coordinates		Comment
		+N/-S (ft)	+E/-W (ft)	
1,150.00	1,150.00	0.00	0.00	Start Build 2.00
1,648.15	1,645.64	-19.72	-38.44	Start 5070.67 hold at 1648.15 MD
6,718.82	6,639.85	-420.08	-819.04	Start DLS 8.00 TFO 117.13
7,903.57	7,404.00	297.00	-934.00	Start DLS 0.01 TFO 61.29
8,217.18	7,402.88	610.61	-931.95	Start 3738.67 hold at 8217.18 MD
11,955.85	7,389.00	4,349.16	-906.62	TD at 11955.85