

**CHEVRON U.S.A., INC.**  
**FEE #160X & #161X**  
**LOCATED IN RIO BLANCO COUNTY, COLORADO**  
**SECTION 28, T2N, R102W, 6th P.M.**

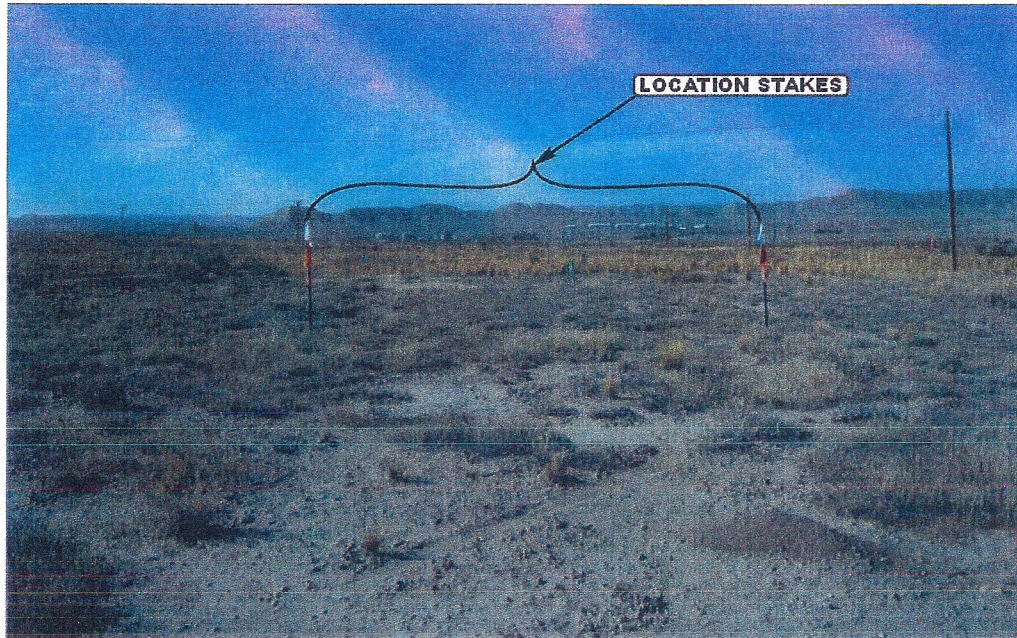

**PHOTO: VIEW OF LOCATION STAKES**

**CAMERA ANGLE: SOUTHWESTERLY**



**PHOTO: VIEW OF EXISTING ACCESS**

**CAMERA ANGLE: NORTHERLY**

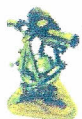

- Since 1964 -

**UELS**

Uintah Engineering & Land Surveying  
85 South 200 East Vernal, Utah 84078  
(435) 789-1017 \* FAX (435) 789-1813

**LOCATION PHOTOS**

**12 02 10**  
MONTH DAY YEAR

**PHOTO**

**P1**

TAKEN BY: J.F.

DRAWN BY: Z.L.

REVISED: 00-00-00



# CHEVRON U.S.A., INC.

**FEE #160X & #161X**

LOCATED IN RIO BLAN COCOUNTY, COLORADO  
SECTION 28, T2N, R102W, 6th P.M.



PHOTO: VIEW OF LOCATION STAKES

CAMERA ANGLE: NORTHERLY



PHOTO: VIEW OF LOCATION STAKES

CAMERA ANGLE: EASTERLY

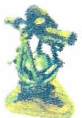

- Since 1964 -

**UELS**

Uintah Engineering & Land Surveying

85 South 200 East Vernal, Utah 84078  
(435) 789-1017 \* FAX (435) 789-1813

LOCATION PHOTOS

12 02 10  
MONTH DAY YEAR

PHOTO  
P2

TAKEN BY: J.F.

DRAWN BY: Z.L.

REVISED: 00-00-00



**CHEVRON U.S.A., INC.**  
**FEE #160X & #161X**  
**LOCATED IN RIO BLAN COCOUNTY, COLORADO**  
**SECTION 28, T2N, R102W, 6th P.M.**

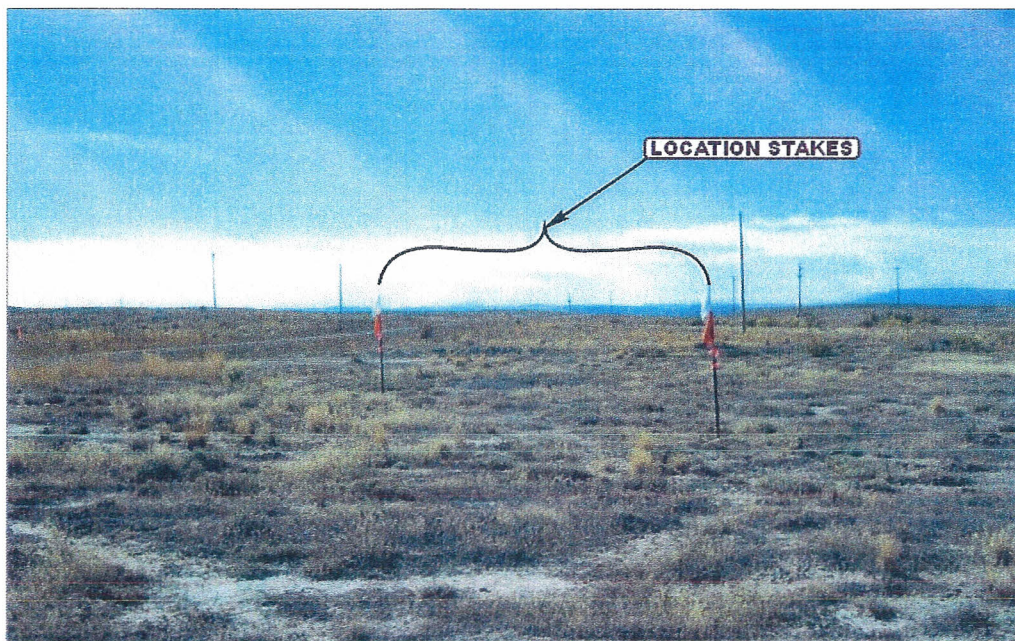

**PHOTO: VIEW OF LOCATION STAKES**

**CAMERA ANGLE: SOUTHERLY**

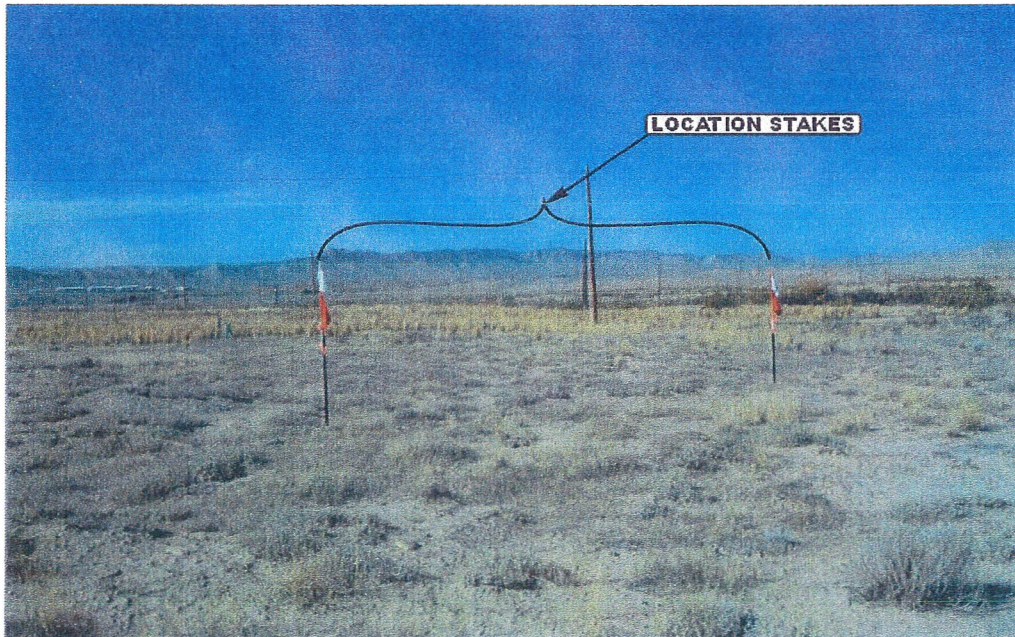

**PHOTO: VIEW OF LOCATION STAKES**

**CAMERA ANGLE: WESTERLY**

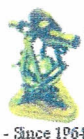

**UELS**

Uintah Engineering & Land Surveying  
85 South 200 East Vernal, Utah 84078  
(435) 789-1017 \* FAX (435) 789-1813

**LOCATION PHOTOS**

**12** **02** **10**  
MONTH DAY YEAR

TAKEN BY: J.F.

DRAWN BY: Z.L.

REVISED: 00-00-00

**PHOTO**  
**P3**