

## Anadarko, Adams County CO

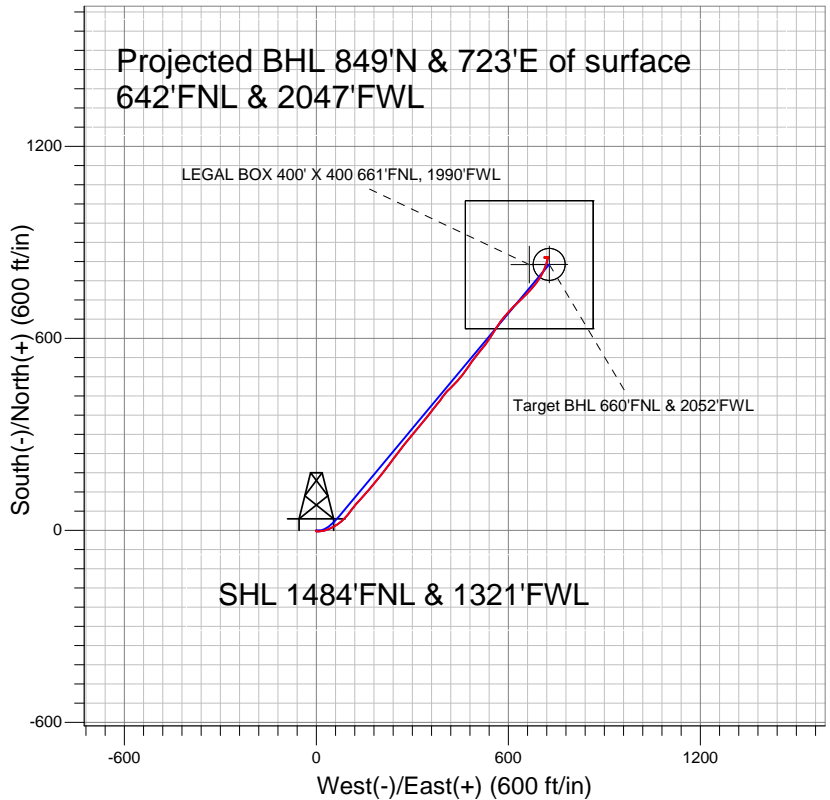

### LEGEND

- ✕ Talon View 3-9, Wellbore #1, Plan #1 (9-15-10) V0
- Wellbore #1
- Survey #1

## Final Survey Plot

Projected Final Survey -  
 8667'MD & 8525'TVD @ 1115' VS  
 1.2 deg Inc 258.3 deg AZ

Project: SEC.9-T1S-R67W  
 Site: Talon View 18-9 Pad Sec.9-T1S-R67W  
 Well: Talon View 3-9  
 Plan: Wellbore #1



## **Directional**

### **Anadarko, Adams County CO**

**SEC.9-T1S-R67W**

**Talon View 18-9 Pad Sec.9-T1S-R67W**

**Talon View 3-9**

**Wellbore #1**

**Survey: Survey #1**

### **Standard Survey Report**

**06 October, 2010**

<b>Company:</b>	Anadarko, Adams County CO	<b>Local Co-ordinate Reference:</b>	Well Talon View 3-9
<b>Project:</b>	SEC.9-T1S-R67W	<b>TVD Reference:</b>	WELL @ 5172.0ft (Original Well Elev)
<b>Site:</b>	Talon View 18-9 Pad Sec.9-T1S-R67W	<b>MD Reference:</b>	WELL @ 5172.0ft (Original Well Elev)
<b>Well:</b>	Talon View 3-9	<b>North Reference:</b>	True
<b>Wellbore:</b>	Wellbore #1	<b>Survey Calculation Method:</b>	Minimum Curvature
<b>Design:</b>	Wellbore #1	<b>Database:</b>	Landmark

<b>Project</b>	SEC.9-T1S-R67W, Adams County, Colorado		
<b>Map System:</b>	US State Plane 1983	<b>System Datum:</b>	Mean Sea Level
<b>Geo Datum:</b>	North American Datum 1983		Using Well Reference Point
<b>Map Zone:</b>	Colorado Northern Zone		Using geodetic scale factor

Site		Talon View 18-9 Pad Sec.9-T1S-R67W			
Site Position:		Northing:		1,236,908.77 ft	
From:	Lat/Long	Easting:		Longitude:	
		3,168,530.03 ft		39° 58' 55.668 N	
Position Uncertainty:		Slot Radius:		104° 53' 54.924 W	
0.0 ft		"		Grid Convergence:	
				0.39 °	

Well	Talon View 3-9					
Well Position	+N-S	0.0 ft	Northing:	1,236,981.60 ft	Latitude:	39° 58' 56.388 N
	+E-W	0.0 ft	Easting:	3,168,529.53 ft	Longitude:	104° 53' 54.924 W
Position Uncertainty		0.0 ft	Wellhead Elevation:	ft	Ground Level:	5,157.0 ft

Wellbore	Wellbore #1				
Magnetics	Model Name	Sample Date	Declination (°)	Dip Angle (°)	Field Strength (nT)
	IGRF2010	9/30/2010	8.99	66.71	52,968

Design	Wellbore #1				
Audit Notes:					
Version:	1.0	Phase:	ACTUAL	Tie On Depth:	0.0
Vertical Section:	Depth From (TVD) (ft)	+N/-S (ft)	+E/-W (ft)	Direction (°)	
	0.0	0.0	0.0	40.39	

Survey Program		Date	10/6/2010	
From (ft)	To (ft)	Survey (Wellbore)	Tool Name	Description
177.0	8,667.0	Survey #1 (Wellbore #1)		

Survey	Survey Data									
	Measured Depth (ft)	Inclination (°)	Azimuth (°)	Vertical Depth (ft)	+N/-S (ft)	+E/-W (ft)	Vertical Section (ft)	Dogleg Rate (°/100ft)	Build Rate (°/100ft)	Turn Rate (°/100ft)
	0.0	0.00	0.00	0.0	0.0	0.0	0.0	0.00	0.00	0.00
	177.0	0.60	233.70	177.0	-0.5	-0.7	-0.9	0.34	0.34	0.00
	270.0	0.60	197.40	270.0	-1.3	-1.3	-1.8	0.40	0.00	-39.03
	365.0	1.10	154.50	365.0	-2.6	-1.0	-2.7	0.82	0.53	-45.16
	455.0	1.80	96.90	455.0	-3.5	0.7	-2.2	1.70	0.78	-64.00
	545.0	3.70	85.90	544.8	-3.5	5.0	0.6	2.18	2.11	-12.22
	634.0	5.10	87.50	633.6	-3.1	11.9	5.3	1.58	1.57	1.80
	721.0	6.10	76.90	720.2	-1.9	20.2	11.6	1.65	1.15	-12.18
	812.0	7.40	73.90	810.5	0.8	30.6	20.4	1.48	1.43	-3.30
	902.0	8.80	63.30	899.6	5.5	42.3	31.6	2.27	1.56	-11.78
	993.0	10.60	62.10	989.3	12.6	55.9	45.8	1.99	1.98	-1.32
	1,081.0	11.70	54.90	1,075.7	21.5	70.3	61.9	2.01	1.25	-8.18
	1,170.0	12.40	44.40	1,162.7	33.5	84.4	80.2	2.58	0.79	-11.80

<b>Company:</b>	Anadarko, Adams County CO	<b>Local Co-ordinate Reference:</b>	Well Talon View 3-9
<b>Project:</b>	SEC.9-T1S-R67W	<b>TVD Reference:</b>	WELL @ 5172.0ft (Original Well Elev)
<b>Site:</b>	Talon View 18-9 Pad Sec.9-T1S-R67W	<b>MD Reference:</b>	WELL @ 5172.0ft (Original Well Elev)
<b>Well:</b>	Talon View 3-9	<b>North Reference:</b>	True
<b>Wellbore:</b>	Wellbore #1	<b>Survey Calculation Method:</b>	Minimum Curvature
<b>Design:</b>	Wellbore #1	<b>Database:</b>	Landmark

Survey										
Measured Depth (ft)	Inclination (°)	Azimuth (°)	Vertical Depth (ft)	+N/-S (ft)	+E/-W (ft)	Vertical Section (ft)	Dogleg Rate (°/100ft)	Build Rate (°/100ft)	Turn Rate (°/100ft)	
1,261.0	13.00	39.40	1,251.5	48.4	97.8	100.2	1.38	0.66	-5.49	
1,364.0	11.70	37.00	1,352.1	65.7	111.4	122.2	1.36	-1.26	-2.33	
1,455.0	12.80	39.80	1,441.0	80.8	123.4	141.5	1.37	1.21	3.08	
1,544.0	13.70	42.40	1,527.7	96.1	136.8	161.9	1.21	1.01	2.92	
1,632.0	13.80	42.10	1,613.2	111.6	150.9	182.8	0.14	0.11	-0.34	
1,723.0	15.80	42.30	1,701.1	128.8	166.5	206.0	2.20	2.20	0.22	
1,811.0	16.60	38.20	1,785.6	147.6	182.3	230.6	1.59	0.91	-4.66	
1,902.0	16.70	37.80	1,872.8	168.1	198.4	256.6	0.17	0.11	-0.44	
1,991.0	16.30	38.20	1,958.2	188.0	213.9	281.9	0.47	-0.45	0.45	
2,079.0	15.70	37.60	2,042.8	207.2	228.8	306.1	0.71	-0.68	-0.68	
2,170.0	16.00	36.10	2,130.3	227.1	243.7	330.9	0.56	0.33	-1.65	
2,260.0	14.40	37.30	2,217.1	246.0	257.8	354.4	1.81	-1.78	1.33	
2,351.0	14.50	38.00	2,305.3	264.0	271.7	377.1	0.22	0.11	0.77	
2,440.0	15.90	40.00	2,391.1	282.1	286.4	400.5	1.68	1.57	2.25	
2,529.0	15.60	38.60	2,476.8	300.8	301.7	424.6	0.54	-0.34	-1.57	
2,619.0	16.70	40.70	2,563.3	320.1	317.7	449.6	1.38	1.22	2.33	
2,708.0	15.50	39.20	2,648.8	339.0	333.5	474.3	1.43	-1.35	-1.69	
2,796.0	15.80	39.60	2,733.5	357.3	348.6	498.0	0.36	0.34	0.45	
2,885.0	16.10	37.70	2,819.1	376.4	363.9	522.5	0.68	0.34	-2.13	
2,975.0	16.30	38.00	2,905.5	396.2	379.3	547.6	0.24	0.22	0.33	
3,066.0	15.30	35.90	2,993.1	416.0	394.2	572.3	1.27	-1.10	-2.31	
3,155.0	14.10	42.20	3,079.2	433.6	408.4	594.8	2.24	-1.35	7.08	
3,245.0	15.10	45.90	3,166.2	449.8	424.1	617.5	1.52	1.11	4.11	
3,334.0	16.30	43.80	3,251.9	466.9	441.1	641.5	1.49	1.35	-2.36	
3,423.0	17.00	35.40	3,337.2	486.6	457.3	666.9	2.81	0.79	-9.44	
3,512.0	15.50	34.70	3,422.6	506.9	471.6	691.7	1.70	-1.69	-0.79	
3,601.0	16.10	36.70	3,508.3	526.6	485.8	715.9	0.91	0.67	2.25	
3,691.0	15.90	38.50	3,594.8	546.3	500.9	740.6	0.59	-0.22	2.00	
3,782.0	17.10	38.70	3,682.1	566.5	517.0	766.5	1.32	1.32	0.22	
3,872.0	16.00	36.40	3,768.3	586.8	532.6	792.1	1.42	-1.22	-2.56	
3,962.0	16.20	32.90	3,854.8	607.3	546.8	816.9	1.10	0.22	-3.89	
4,053.0	15.40	30.60	3,942.4	628.4	559.9	841.4	1.12	-0.88	-2.53	
4,141.0	14.20	35.00	4,027.4	647.3	572.0	863.6	1.87	-1.36	5.00	
4,232.0	14.80	41.80	4,115.5	665.1	586.2	886.4	1.98	0.66	7.47	
4,322.0	14.30	40.50	4,202.7	682.1	601.0	909.0	0.66	-0.56	-1.44	
4,413.0	13.40	44.10	4,291.0	698.2	615.7	930.7	1.37	-0.99	3.96	
4,501.0	10.90	47.70	4,377.0	711.1	628.9	949.2	2.97	-2.84	4.09	
4,590.0	12.70	47.40	4,464.2	723.4	642.4	967.2	2.02	2.02	-0.34	
4,679.0	15.20	42.90	4,550.5	738.6	657.5	988.6	3.06	2.81	-5.06	
4,768.0	15.60	40.70	4,636.3	756.2	673.3	1,012.2	0.80	0.45	-2.47	
4,855.0	14.20	38.10	4,720.4	773.5	687.5	1,034.6	1.78	-1.61	-2.99	
4,945.0	12.70	32.80	4,807.9	790.5	699.6	1,055.4	2.16	-1.67	-5.89	
5,033.0	10.00	25.30	4,894.2	805.5	708.1	1,072.4	3.49	-3.07	-8.52	
5,123.0	8.30	21.10	4,983.1	818.6	713.8	1,086.1	2.03	-1.89	-4.67	
5,214.0	7.10	17.30	5,073.2	830.1	717.9	1,097.4	1.43	-1.32	-4.18	
5,300.0	5.30	13.40	5,158.7	839.1	720.4	1,105.9	2.15	-2.09	-4.53	
5,391.0	3.00	12.40	5,249.5	845.5	721.8	1,111.7	2.53	-2.53	-1.10	
5,482.0	1.00	357.30	5,340.4	848.6	722.3	1,114.4	2.25	-2.20	-16.59	
5,568.0	0.60	2.30	5,426.4	849.8	722.3	1,115.3	0.47	-0.47	5.81	
5,659.0	0.70	2.10	5,517.4	850.8	722.3	1,116.1	0.11	0.11	-0.22	
5,748.0	0.80	31.60	5,606.4	851.9	722.7	1,117.2	0.44	0.11	33.15	
5,838.0	0.70	21.10	5,696.4	853.0	723.2	1,118.3	0.19	-0.11	-11.67	
5,927.0	0.30	60.70	5,785.4	853.6	723.6	1,119.0	0.57	-0.45	44.49	
5,941.6	0.30	63.91	5,800.0	853.6	723.7	1,119.1	0.12	-0.02	22.00	

<b>Company:</b>	Anadarko, Adams County CO	<b>Local Co-ordinate Reference:</b>	Well Talon View 3-9
<b>Project:</b>	SEC.9-T1S-R67W	<b>TVD Reference:</b>	WELL @ 5172.0ft (Original Well Elev)
<b>Site:</b>	Talon View 18-9 Pad Sec.9-T1S-R67W	<b>MD Reference:</b>	WELL @ 5172.0ft (Original Well Elev)
<b>Well:</b>	Talon View 3-9	<b>North Reference:</b>	True
<b>Wellbore:</b>	Wellbore #1	<b>Survey Calculation Method:</b>	Minimum Curvature
<b>Design:</b>	Wellbore #1	<b>Database:</b>	Landmark

Survey									
Measured Depth (ft)	Inclination (°)	Azimuth (°)	Vertical Depth (ft)	+N/-S (ft)	+E/-W (ft)	Vertical Section (ft)	Dogleg Rate (°/100ft)	Build Rate (°/100ft)	Turn Rate (°/100ft)
<b>Target BHL 660'FNL &amp; 2052'FWL</b>									
6,016.0	0.30	80.50	5,874.4	853.7	724.0	1,119.4	0.12	0.00	22.30
6,107.0	0.20	99.00	5,965.4	853.8	724.4	1,119.7	0.14	-0.11	20.33
6,195.0	0.10	259.70	6,053.4	853.7	724.5	1,119.7	0.34	-0.11	182.61
6,285.0	0.60	254.70	6,143.4	853.6	724.0	1,119.3	0.56	0.56	-5.56
6,374.0	0.70	215.80	6,232.4	853.0	723.2	1,118.3	0.50	0.11	-43.71
6,463.0	0.60	209.60	6,321.4	852.2	722.7	1,117.3	0.14	-0.11	-6.97
6,551.0	0.40	211.20	6,409.4	851.5	722.3	1,116.6	0.23	-0.23	1.82
6,641.0	0.40	233.60	6,499.4	851.1	721.9	1,116.0	0.17	0.00	24.89
6,730.0	0.40	279.00	6,588.4	850.9	721.3	1,115.5	0.35	0.00	51.01
6,819.0	0.40	293.70	6,677.4	851.1	720.7	1,115.2	0.11	0.00	16.52
6,910.0	1.10	292.20	6,768.4	851.5	719.6	1,114.9	0.77	0.77	-1.65
6,998.0	1.00	290.80	6,856.4	852.1	718.1	1,114.4	0.12	-0.11	-1.59
7,089.0	1.40	303.10	6,947.3	853.0	716.4	1,114.0	0.52	0.44	13.52
7,179.0	1.10	245.40	7,037.3	853.3	714.7	1,113.0	1.37	-0.33	-64.11
7,269.0	0.90	153.60	7,127.3	852.3	714.3	1,112.0	1.60	-0.22	-102.00
7,360.0	0.70	191.70	7,218.3	851.1	714.5	1,111.2	0.61	-0.22	41.87
7,450.0	0.40	260.10	7,308.3	850.5	714.1	1,110.5	0.74	-0.33	76.00
7,541.0	0.30	288.50	7,399.3	850.5	713.5	1,110.1	0.22	-0.11	31.21
7,615.8	0.46	326.03	7,474.1	850.8	713.2	1,110.2	0.38	0.21	50.15
<b>LEGAL BOX 400' X 400 661'FNL, 1990'FWL</b>									
7,630.0	0.50	330.00	7,488.3	850.9	713.1	1,110.2	0.38	0.30	28.01
7,718.0	0.40	2.10	7,576.3	851.6	712.9	1,110.6	0.30	-0.11	36.48
7,808.0	0.70	17.60	7,666.3	852.4	713.1	1,111.3	0.37	0.33	17.22
7,943.0	0.70	15.20	7,801.3	854.0	713.6	1,112.8	0.02	0.00	-1.78
8,033.0	1.10	126.50	7,891.3	854.0	714.4	1,113.4	1.67	0.44	123.67
8,124.0	1.30	89.30	7,982.2	853.5	716.1	1,114.1	0.87	0.22	-40.88
8,259.0	1.20	111.30	8,117.2	853.0	719.0	1,115.6	0.36	-0.07	16.30
8,350.0	1.10	108.60	8,208.2	852.4	720.7	1,116.2	0.12	-0.11	-2.97
8,485.0	0.40	143.10	8,343.2	851.6	722.2	1,116.6	0.59	-0.52	25.56
8,618.0	1.20	158.30	8,476.2	849.9	723.0	1,115.8	0.62	0.60	11.43
8,667.0	1.20	258.30	8,525.2	849.3	722.7	1,115.2	3.75	0.00	204.08

Checked By: _____	Approved By: _____	Date: _____
-------------------	--------------------	-------------