

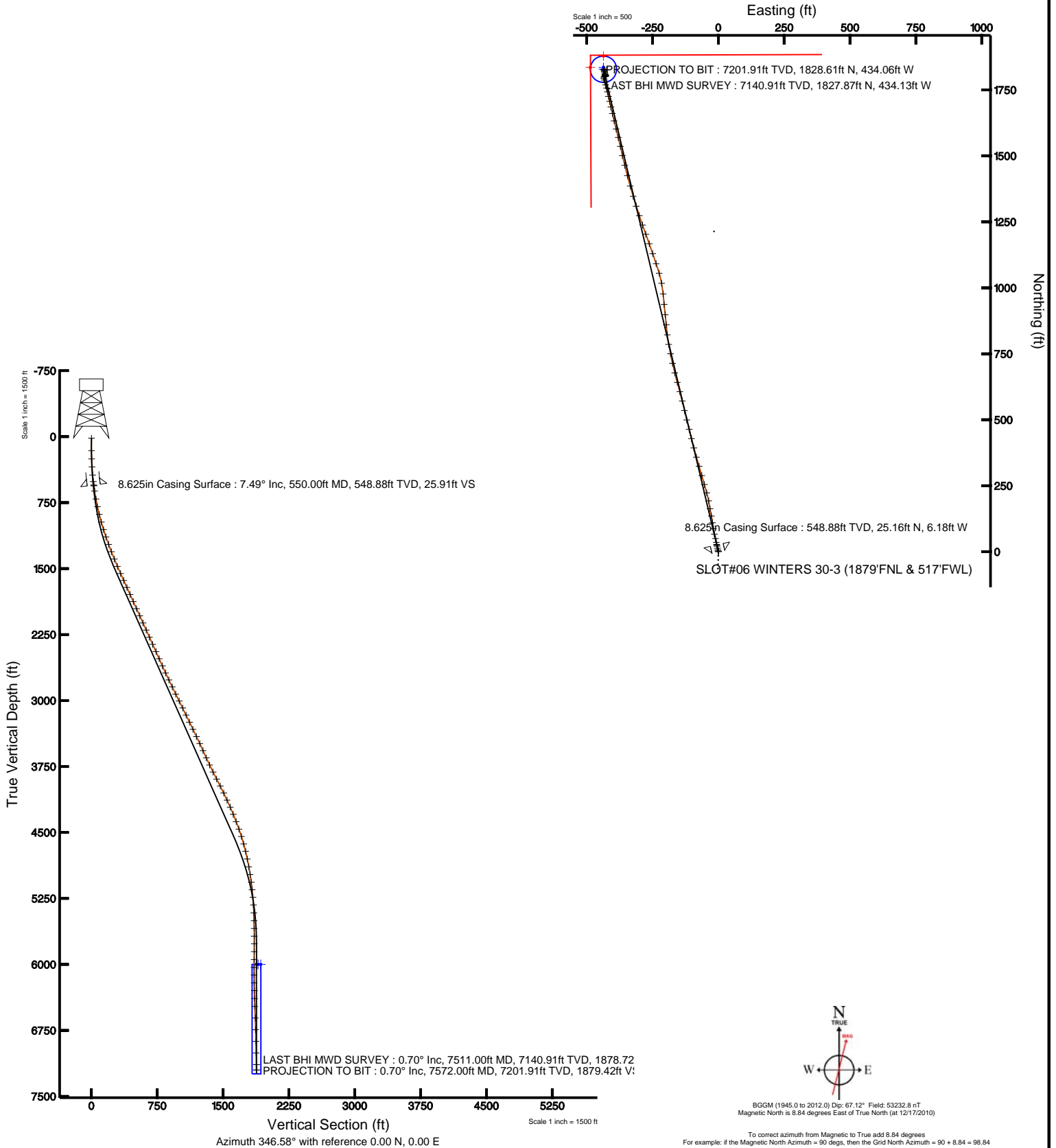

KERR MCGEE OIL & GAS ONSHORE LP

Location: COLORADO Slot: SLOT#06 WINTERS 30-3 (1879'FNL & 517'FWL)
Field: WELD COUNTY (KERR MCGEE) Well: WINTERS 30-3
Facility: SEC.03-T5N-R65W Wellbore: WINTERS 30-3 PWB

Plot reference wellpath is WINTERS 30-3 (REV.8.0) PWB	
True vertical depths are referenced to XTREME 6 (RKB)	Grid System: NAD83 / Lambert Colorado State Planes, Northern Zone (501), US feet
Measured depths are referenced to XTREME 6 (RKB)	North Reference: True north
XTREME 6 (RKB) to Mean Sea Level: 4674 feet	Scale: True distance
Mean Sea Level to Mud line (Facility: SEC.03-T5N-R65W): 0 feet	Depths are in feet
Coordinates are in feet referenced to Slot	Created by: cookdamm on 2/3/2011





Actual Wellpath Report

WINTERS 30-3 AWP

Page 1 of 5



INTEQ

REFERENCE WELLPATH IDENTIFICATION

Operator	KERR MCGEE OIL & GAS ONSHORE LP	Slot	SLOT#06 WINTERS 30-3 (1879'FNL & 517'FWL)
Area	COLORADO	Well	WINTERS 30-3
Field	WELD COUNTY (KERR MCGEE)	Wellbore	WINTERS 30-3 AWB
Facility	SEC.03-T5N-R65W		

REPORT SETUP INFORMATION

Projection System	NAD83 / Lambert Colorado State Planes, Northern Zone (501), US feet	Software System	WellArchitect® 2.0
North Reference	True	User	Cookdanm
Scale	0.999962	Report Generated	2/3/2011 at 12:36:31 PM
Convergence at slot	0.54° East	Database/Source file	Denver Server/WINTERS_30-3_AWB.xml

WELLPATH LOCATION

	Local coordinates		Grid coordinates		Geographic coordinates	
	North[ft]	East[ft]	Easting[USft]	Northing[USft]	Latitude	Longitude
Slot Location	80.15	1.95	3234694.90	1400662.57	40°25'48.569"N	104°39'24.959"W
Facility Reference Pt			3234693.72	1400582.41	40°25'47.777"N	104°39'24.984"W
Field Reference Pt			3197771.84	1268891.29	40°04'09.600"N	104°47'36.000"W

WELLPATH DATUM

Calculation method	Minimum curvature	XTREME 6 (RKB) to Facility Vertical Datum	4674.00ft
Horizontal Reference Pt	Slot	XTREME 6 (RKB) to Mean Sea Level	4674.00ft
Vertical Reference Pt	XTREME 6 (RKB)	Facility Vertical Datum to Mud Line (Facility)	0.00ft
MD Reference Pt	XTREME 6 (RKB)	Section Origin	N 0.00, E 0.00 ft
Field Vertical Reference	Mean Sea Level	Section Azimuth	346.58°



Actual Wellpath Report

WINTERS 30-3 AWP

Page 2 of 5



INTEQ

REFERENCE WELLPATH IDENTIFICATION

Operator	KERR MCGEE OIL & GAS ONSHORE LP	Slot	SLOT#06 WINTERS 30-3 (1879'FNL & 517'FWL)
Area	COLORADO	Well	WINTERS 30-3
Field	WELD COUNTY (KERR MCGEE)	Wellbore	WINTERS 30-3 AWB
Facility	SEC.03-T5N-R65W		

WELLPATH DATA (85 stations) † = interpolated/extrapolated station

MD [ft]	Inclination [°]	Azimuth [°]	TVD [ft]	Vert Sect [ft]	North [ft]	East [ft]	DLS [°/100ft]	Comments
0.00†	0.000	349.900	0.00	0.00	0.00	0.00	0.00	
16.00	0.000	349.900	16.00	0.00	0.00	0.00	0.00	
158.00	0.300	349.900	158.00	0.37	0.37	-0.07	0.21	
252.00	1.700	340.400	251.98	2.00	1.92	-0.58	1.49	
343.00	3.400	350.200	342.89	6.04	5.85	-1.49	1.92	
436.00	5.200	344.600	435.62	13.00	12.63	-3.08	1.99	
510.00	7.000	346.400	509.20	20.86	20.25	-5.03	2.45	
559.00	7.600	347.400	557.81	27.09	26.31	-6.44	1.25	
620.00	8.800	352.000	618.18	35.77	34.87	-7.97	2.24	
711.00	10.200	346.400	707.93	50.76	49.60	-10.83	1.84	
800.00	12.300	346.400	795.22	68.12	66.47	-14.91	2.36	
890.00	14.000	350.200	882.86	88.57	86.52	-19.02	2.12	
980.00	16.200	353.400	969.74	111.91	109.72	-22.32	2.61	
1069.00	17.400	348.100	1054.95	137.54	135.08	-26.49	2.19	
1158.00	19.200	350.200	1139.45	165.45	162.52	-31.72	2.15	
1248.00	20.300	350.200	1224.15	195.80	192.49	-36.90	1.22	
1337.00	20.700	343.200	1307.53	226.91	222.77	-44.07	2.79	
1427.00	22.000	344.200	1391.35	259.64	254.22	-53.26	1.50	
1517.00	24.300	344.200	1474.10	294.99	288.26	-62.90	2.56	
1606.00	24.400	343.200	1555.18	331.64	323.48	-73.20	0.48	
1693.00	24.400	344.000	1634.41	367.53	357.96	-83.34	0.38	
1781.00	24.700	344.900	1714.45	404.06	393.18	-93.14	0.54	
1869.00	24.400	346.400	1794.50	440.62	428.60	-102.21	0.79	
1956.00	24.500	346.000	1873.70	476.63	463.57	-110.80	0.22	
2045.00	24.200	345.000	1954.78	513.31	499.10	-119.98	0.57	
2134.00	24.500	347.100	2035.87	550.00	534.70	-128.82	1.03	
2224.00	24.500	346.700	2117.76	587.32	571.06	-137.28	0.18	
2313.00	24.200	344.600	2198.85	624.01	606.60	-146.37	1.03	
2402.00	24.100	344.200	2280.06	660.40	641.67	-156.16	0.22	
2491.00	24.900	346.000	2361.04	697.29	677.34	-165.64	1.23	
2581.00	24.700	347.800	2442.75	735.03	714.10	-174.20	0.87	
2671.00	23.800	348.800	2524.80	771.98	750.30	-181.70	1.10	
2760.00	24.000	348.800	2606.17	808.01	785.67	-188.71	0.22	
2848.00	25.300	354.400	2686.16	844.53	821.94	-194.02	3.04	
2936.00	26.200	353.700	2765.42	882.43	859.97	-197.98	1.08	
3024.00	25.500	354.100	2844.62	920.49	898.12	-202.06	0.82	
3115.00	25.900	354.800	2926.62	959.58	937.40	-205.88	0.55	
3203.00	27.900	353.700	3005.09	999.04	977.00	-209.88	2.34	
3292.00	26.500	350.200	3084.25	1039.52	1017.27	-215.55	2.39	
3382.00	25.100	342.500	3165.30	1078.61	1055.28	-224.71	4.03	
3471.00	25.800	341.400	3245.66	1116.73	1091.64	-236.56	0.95	
3562.00	26.300	341.400	3327.42	1156.53	1129.51	-249.31	0.55	
3653.00	25.900	340.000	3409.14	1196.35	1167.30	-262.53	0.81	
3742.00	25.000	340.400	3489.50	1234.36	1203.28	-275.49	1.03	
3830.00	24.500	340.400	3569.42	1270.99	1237.99	-287.85	0.57	



Actual Wellpath Report

WINTERS 30-3 AWP

Page 3 of 5



INTEQ

REFERENCE WELLPATH IDENTIFICATION

Operator	KERR MCGEE OIL & GAS ONSHORE LP	Slot	SLOT#06 WINTERS 30-3 (1879'FNL & 517'FWL)
Area	COLORADO	Well	WINTERS 30-3
Field	WELD COUNTY (KERR MCGEE)	Wellbore	WINTERS 30-3 AWP
Facility	SEC.03-T5N-R65W		

WELLPATH DATA (85 stations)

MD [ft]	Inclination [°]	Azimuth [°]	TVD [ft]	Vert Sect [ft]	North [ft]	East [ft]	DLS [°/100ft]	Comments
3921.00	24.500	341.100	3652.23	1308.53	1273.61	-300.29	0.32	
4010.00	25.800	342.500	3732.79	1346.22	1309.54	-312.09	1.61	
4099.00	26.500	343.000	3812.68	1385.36	1347.00	-323.72	0.82	
4189.00	27.500	345.000	3892.87	1426.17	1386.28	-334.97	1.50	
4278.00	27.300	345.300	3971.88	1467.11	1425.87	-345.47	0.27	
4367.00	26.000	345.300	4051.43	1507.02	1464.48	-355.60	1.46	
4457.00	24.200	347.800	4132.93	1545.19	1501.60	-364.50	2.32	
4544.00	24.000	347.100	4212.34	1580.71	1536.27	-372.22	0.40	
4633.00	22.000	346.000	4294.27	1615.48	1570.09	-380.30	2.30	
4722.00	21.500	346.000	4376.93	1648.46	1602.09	-388.28	0.56	
4813.00	19.700	346.400	4462.11	1680.48	1633.18	-395.92	1.98	
4901.00	17.800	347.000	4545.43	1708.76	1660.71	-402.43	2.17	
4990.00	15.600	347.400	4630.67	1734.33	1685.64	-408.10	2.48	
5077.00	13.800	347.400	4714.82	1756.41	1707.19	-412.92	2.07	
5166.00	11.300	346.000	4801.69	1775.74	1726.01	-417.34	2.83	
5257.00	10.400	348.100	4891.06	1792.87	1742.70	-421.19	1.08	
5346.00	9.200	346.000	4978.76	1808.01	1757.46	-424.57	1.41	
5433.00	7.500	341.800	5064.84	1820.63	1769.61	-428.03	2.07	
5520.00	6.200	347.000	5151.22	1830.98	1779.58	-430.86	1.65	
5607.00	5.000	341.000	5237.80	1839.46	1787.74	-433.15	1.53	
5694.00	3.200	345.000	5324.57	1845.66	1793.67	-435.01	2.09	
5784.00	3.100	18.700	5414.45	1850.23	1798.40	-434.88	2.03	
5873.00	2.000	48.200	5503.36	1853.01	1801.72	-432.95	1.89	
5962.00	1.400	55.300	5592.32	1854.14	1803.37	-430.90	0.71	
6049.00	0.800	45.800	5679.30	1854.84	1804.40	-429.59	0.72	
6136.00	0.300	49.300	5766.30	1855.25	1804.97	-428.98	0.58	
6225.00	0.400	194.100	5855.30	1855.08	1804.82	-428.88	0.75	
6315.00	0.900	176.200	5945.29	1854.11	1803.81	-428.91	0.59	
6404.00	0.600	197.300	6034.29	1853.02	1802.67	-429.01	0.45	
6491.00	0.600	82.000	6121.28	1852.58	1802.30	-428.69	1.17	
6580.00	1.900	351.300	6210.27	1854.01	1803.82	-428.45	2.25	
6668.00	1.600	342.500	6298.22	1856.69	1806.44	-429.04	0.46	
6759.00	1.400	331.600	6389.19	1859.03	1808.63	-429.95	0.38	
6848.00	2.200	347.100	6478.15	1861.79	1811.25	-430.85	1.04	
6980.00	1.900	345.700	6610.06	1866.51	1815.84	-431.96	0.23	
7113.00	1.600	345.700	6743.00	1870.57	1819.77	-432.96	0.23	
7246.00	1.400	352.000	6875.96	1874.04	1823.18	-433.65	0.19	
7378.00	1.000	351.300	7007.93	1876.80	1825.92	-434.04	0.30	
7511.00	0.700	6.000	7140.91	1878.72	1827.87	-434.13	0.28	LAST BHI MWD SURVEY
7572.00	0.700	6.000	7201.91	1879.42	1828.61	-434.06	0.00	PROJECTION TO BIT



Actual Wellpath Report

WINTERS 30-3 AWP

Page 4 of 5



INTEQ

REFERENCE WELLPATH IDENTIFICATION			
Operator	KERR MCGEE OIL & GAS ONSHORE LP	Slot	SLOT#06 WINTERS 30-3 (1879'FNL & 517'FWL)
Area	COLORADO	Well	WINTERS 30-3
Field	WELD COUNTY (KERR MCGEE)	Wellbore	WINTERS 30-3 AWB
Facility	SEC.03-T5N-R65W		

HOLE & CASING SECTIONS Ref Wellbore: WINTERS 30-3 AWB Ref Wellpath: WINTERS 30-3 AWP									
String/Diameter	Start MD [ft]	End MD [ft]	Interval [ft]	Start TVD [ft]	End TVD [ft]	Start N/S [ft]	Start E/W [ft]	End N/S [ft]	End E/W [ft]
12.25in Open Hole	16.00	565.00	549.00	16.00	563.75	0.00	0.00	27.10	-6.61
8.625in Casing Surface	16.00	550.00	534.00	16.00	548.88	0.00	0.00	25.16	-6.18
7.875in Open Hole	550.00	7472.00	6922.00	548.88	7101.92	25.16	-6.18	1827.37	-434.16

TARGETS									
Name	MD [ft]	TVD [ft]	North [ft]	East [ft]	Grid East [srv ft]	Grid North [srv ft]	Latitude	Longitude	Shape
WINTERS 30-3 BHL ON PLAT (43'FNL & 50'FWL, REV-1)		6000.00	1835.78	-436.50	3234240.99	1402494.05	40°26'06.709"N	104°39'30.604"W	point
WINTERS 30-3 GEO TARGET 50' RADIUS (50'FNL & 50'FWL, REV-1)		6000.00	1828.78	-436.50	3234241.06	1402487.04	40°26'06.640"N	104°39'30.604"W	circle
WINTERS 30-3 HARDLINE 50'N OF GEO TARGET		6000.00	1878.78	-436.50	3234240.58	1402537.04	40°26'07.134"N	104°39'30.604"W	point
WINTERS 30-3 HARDLINE 50'W OF GEO TARGET		6000.00	1835.78	-486.50	3234190.99	1402493.57	40°26'06.709"N	104°39'31.250"W	point

WELLPATH COMPOSITION Ref Wellbore: WINTERS 30-3 AWB Ref Wellpath: WINTERS 30-3 AWP				
Start MD [ft]	End MD [ft]	Positional Uncertainty Model	Log Name/Comment	Wellbore
16.00	559.00	NaviTrak (Standard)	BHI MWD SURVEYS 12.25 HOLE <158-559>	WINTERS 30-3 AWB
559.00	7511.00	NaviTrak (Standard)	BHI MWD SURVEY 7.875 HOLE <620-7511>	WINTERS 30-3 AWB
7511.00	7572.00	Blind Drilling (std)	Projection to bit	WINTERS 30-3 AWB



Actual Wellpath Report

WINTERS 30-3 AWP

Page 5 of 5



INTEQ

REFERENCE WELLPATH IDENTIFICATION

Operator	KERR MCGEE OIL & GAS ONSHORE LP	Slot	SLOT#06 WINTERS 30-3 (1879'FNL & 517'FWL)
Area	COLORADO	Well	WINTERS 30-3
Field	WELD COUNTY (KERR MCGEE)	Wellbore	WINTERS 30-3 AWB
Facility	SEC.03-T5N-R65W		

WELLPATH COMMENTS

MD [ft]	Inclination [°]	Azimuth [°]	TVD [ft]	Comment
7511.00	0.700	6.000	7140.91	LAST BHI MWD SURVEY
7572.00	0.700	6.000	7201.91	PROJECTION TO BIT