

KERR MCGEE OIL & GAS ONSHORE LP

Location: COLORADO Slot: SLOT#02 RIVERBEND 7-13 (2045'FNL & 1795'FEL)
 Field: WELD COUNTY (KERR MCGEE) Well: RIVERBEND 7-13
 Facility: SEC.13-T1N-R67W Wellbore: RIVERBEND 7-13 PWB

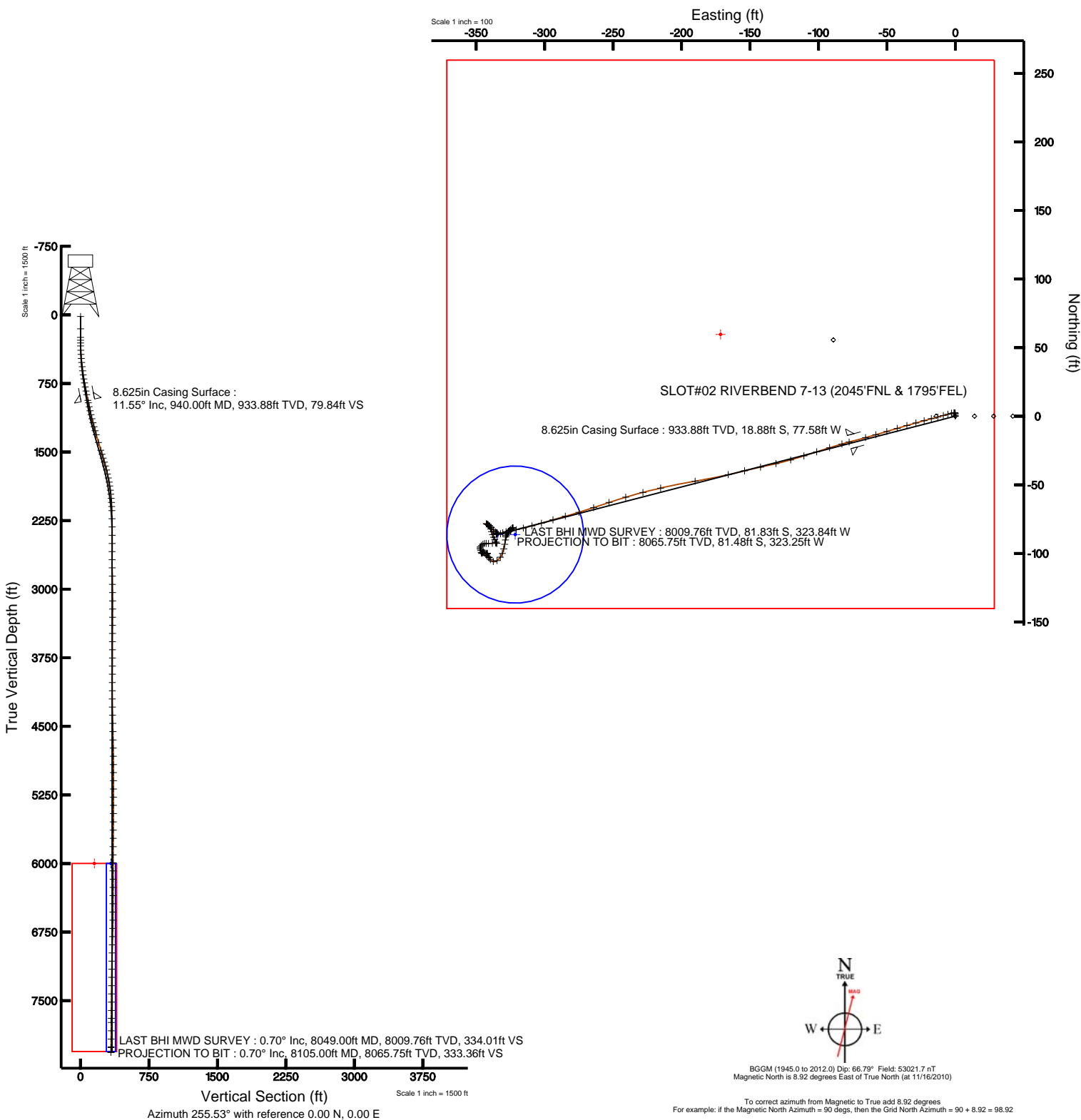

Plot reference wellpath is RIVERBEND 7-13 (REV-8.0) PWB	
True vertical depths are referenced to XTREME 7 (RKB)	Grid System: NAD83 / Lambert Colorado State Planes, Northern Zone (501), US feet
Measured depths are referenced to XTREME 7 (RKB)	North Reference: True north
XTREME 7 (RKB) to Mean Sea Level: 4934 feet	Scale: True distance
Mean Sea Level to Mud line (Facility: SEC.13-T1N-R67W): 0 feet	Depths are in feet
Coordinates are in feet referenced to Slot	
Created by: cookdamm on 1/26/2011	





Actual Wellpath Report

RIVERBEND 7-13 AWP

Page 1 of 6



INTEQ

REFERENCE WELLPATH IDENTIFICATION

Operator	KERR MCGEE OIL & GAS ONSHORE LP	Slot	SLOT#02 RIVERBEND 7-13 (2045'FNL & 1795'FEL)
Area	COLORADO	Well	RIVERBEND 7-13
Field	WELD COUNTY (KERR MCGEE)	Wellbore	RIVERBEND 7-13 AWP
Facility	SEC.13-T1N-R67W		

REPORT SETUP INFORMATION

Projection System	NAD83 / Lambert Colorado State Planes, Northern Zone (501), US feet	Software System	WellArchitect® 2.0
North Reference	True	User	Cookdanm
Scale	0.999963	Report Generated	1/26/2011 at 2:08:27 PM
Convergence at slot	0.43° East	Database/Source file	Denver Server/RIVERBEND_7-13_AWP.xml

WELLPATH LOCATION

	Local coordinates		Grid coordinates		Geographic coordinates	
	North[ft]	East[ft]	Easting[USft]	Northing[USft]	Latitude	Longitude
Slot Location	0.36	8.11	3185838.38	1262745.22	40°03'09.774"N	104°50'10.090"W
Facility Reference Pt			3185830.27	1262744.80	40°03'09.770"N	104°50'10.194"W
Field Reference Pt			3197771.84	1268891.29	40°04'09.600"N	104°47'36.000"W

WELLPATH DATUM

Calculation method	Minimum curvature	XTREME 7 (RKB) to Facility Vertical Datum	4934.00ft
Horizontal Reference Pt	Slot	XTREME 7 (RKB) to Mean Sea Level	4934.00ft
Vertical Reference Pt	XTREME 7 (RKB)	Facility Vertical Datum to Mud Line (Facility)	0.00ft
MD Reference Pt	XTREME 7 (RKB)	Section Origin	N 0.00, E 0.00 ft
Field Vertical Reference	Mean Sea Level	Section Azimuth	255.53°



Actual Wellpath Report

RIVERBEND 7-13 AWP

Page 2 of 6



INTEQ

REFERENCE WELLPATH IDENTIFICATION

Operator	KERR MCGEE OIL & GAS ONSHORE LP	Slot	SLOT#02 RIVERBEND 7-13 (2045'FNL & 1795'FEL)
Area	COLORADO	Well	RIVERBEND 7-13
Field	WELD COUNTY (KERR MCGEE)	Wellbore	RIVERBEND 7-13 AWP
Facility	SEC.13-T1N-R67W		

WELLPATH DATA (112 stations) † = interpolated/extrapolated station

MD [ft]	Inclination [°]	Azimuth [°]	TVD [ft]	Vert Sect [ft]	North [ft]	East [ft]	DLS [°/100ft]	Comments
0.00†	0.000	355.200	0.00	0.00	0.00	0.00	0.00	
17.00	0.000	355.200	17.00	0.00	0.00	0.00	0.00	
152.00	0.600	355.200	152.00	-0.12	0.70	-0.06	0.44	
245.00	0.800	0.100	244.99	-0.36	1.84	-0.10	0.22	
276.00	0.700	332.000	275.99	-0.37	2.22	-0.19	1.22	
307.00	0.700	292.280	306.99	-0.18	2.46	-0.45	1.53	
339.00	1.400	267.300	338.98	0.36	2.52	-1.02	2.56	
386.00	3.000	254.000	385.94	2.15	2.15	-2.78	3.55	
431.00	4.000	254.700	430.86	4.90	1.41	-5.42	2.22	
476.00	4.900	254.000	475.72	8.39	0.47	-8.79	2.00	
521.00	5.700	256.100	520.53	12.55	-0.60	-12.80	1.83	
567.00	6.500	255.000	566.27	17.43	-1.82	-17.54	1.76	
612.00	7.500	254.300	610.93	22.92	-3.27	-22.82	2.23	
657.00	8.300	255.000	655.51	29.10	-4.91	-28.79	1.79	
702.00	9.300	253.300	699.98	35.98	-6.80	-35.41	2.30	
746.00	9.900	253.300	743.36	43.31	-8.90	-42.44	1.36	
791.00	10.500	253.300	787.65	51.28	-11.19	-50.07	1.33	
836.00	10.800	254.300	831.87	59.59	-13.51	-58.06	0.78	
877.00	11.200	254.700	872.12	67.41	-15.60	-65.59	0.99	
967.00	11.700	254.700	960.33	85.28	-20.32	-82.83	0.56	
1012.00	12.500	252.600	1004.33	94.70	-22.98	-91.87	2.03	
1057.00	12.900	252.200	1048.23	104.58	-25.97	-101.30	0.91	
1101.00	12.700	252.200	1091.13	114.31	-28.95	-110.59	0.45	
1146.00	13.400	254.000	1134.97	124.46	-31.90	-120.31	1.80	
1192.00	14.500	257.800	1179.62	135.55	-34.59	-131.06	3.11	
1237.00	15.300	256.800	1223.10	147.11	-37.13	-142.35	1.87	
1282.00	15.600	256.800	1266.48	159.10	-39.87	-154.02	0.67	
1327.00	15.900	257.100	1309.79	171.31	-42.63	-165.92	0.69	
1416.00	16.300	260.600	1395.30	195.93	-47.39	-190.12	1.18	
1505.00	17.300	256.800	1480.50	221.61	-52.45	-215.33	1.67	
1550.00	17.100	255.400	1523.49	234.91	-55.65	-228.25	1.02	
1595.00	16.600	254.000	1566.56	247.95	-59.09	-240.83	1.43	
1640.00	16.300	251.200	1609.72	260.68	-62.89	-252.99	1.88	
1684.00	15.000	251.200	1652.08	272.51	-66.72	-264.22	2.95	
1729.00	14.000	254.000	1695.65	283.76	-70.10	-274.97	2.71	
1774.00	12.600	254.000	1739.44	294.11	-72.95	-284.92	3.11	
1819.00	11.500	253.600	1783.45	303.50	-75.57	-293.94	2.45	
1865.00	10.500	253.300	1828.60	312.27	-78.07	-302.35	2.18	
1908.00	8.900	255.400	1870.99	319.51	-80.03	-309.33	3.81	
1954.00	7.400	256.100	1916.52	326.03	-81.64	-315.65	3.27	
1999.00	6.000	258.200	1961.21	331.28	-82.82	-320.76	3.16	
2044.00	4.800	261.700	2006.01	335.50	-83.57	-324.93	2.76	
2089.00	3.800	256.100	2050.89	338.86	-84.20	-328.24	2.41	
2134.00	2.800	244.800	2095.81	341.44	-85.03	-330.68	2.64	
2179.00	1.500	245.200	2140.78	343.10	-85.74	-332.21	2.89	



Actual Wellpath Report

RIVERBEND 7-13 AWP

Page 3 of 6



INTEQ

REFERENCE WELLPATH IDENTIFICATION

Operator	KERR MCGEE OIL & GAS ONSHORE LP	Slot	SLOT#02 RIVERBEND 7-13 (2045'FNL & 1795'FEL)
Area	COLORADO	Well	RIVERBEND 7-13
Field	WELD COUNTY (KERR MCGEE)	Wellbore	RIVERBEND 7-13 AWB
Facility	SEC.13-T1N-R67W		

WELLPATH DATA (112 stations)

MD [ft]	Inclination [°]	Azimuth [°]	TVD [ft]	Vert Sect [ft]	North [ft]	East [ft]	DLS [°/100ft]	Comments
2268.00	1.200	292.300	2229.76	344.99	-85.88	-334.13	1.25	
2357.00	0.200	207.600	2318.75	345.84	-85.66	-335.06	1.35	
2448.00	0.100	160.800	2409.75	345.94	-85.88	-335.11	0.17	
2538.00	0.400	15.300	2499.75	345.78	-85.65	-335.00	0.54	
2627.00	0.400	328.800	2588.75	345.71	-85.08	-335.08	0.35	
2716.00	1.000	315.100	2677.74	346.19	-84.27	-335.79	0.70	
2804.00	1.600	308.800	2765.72	347.32	-82.95	-337.29	0.70	
2895.00	1.600	323.900	2856.68	348.55	-81.13	-339.03	0.46	
2985.00	0.700	307.400	2946.66	349.35	-79.78	-340.21	1.06	
3076.00	1.100	297.600	3037.65	350.34	-79.04	-341.42	0.47	
3166.00	0.400	287.400	3127.64	351.25	-78.54	-342.49	0.79	
3255.00	0.400	107.700	3216.64	351.25	-78.55	-342.49	0.90	
3345.00	0.700	126.000	3306.64	350.63	-78.96	-341.74	0.38	
3434.00	0.600	135.100	3395.63	350.05	-79.61	-340.97	0.16	
3522.00	0.900	149.900	3483.63	349.63	-80.54	-340.30	0.40	
3612.00	1.400	156.900	3573.61	349.28	-82.16	-339.52	0.58	
3701.00	1.400	165.700	3662.58	349.12	-84.22	-338.82	0.24	
3791.00	1.500	161.200	3752.55	349.03	-86.40	-338.17	0.17	
3880.00	1.200	151.300	3841.53	348.71	-88.32	-337.35	0.43	
3968.00	1.200	153.400	3929.51	348.29	-89.95	-336.49	0.05	
4059.00	1.400	154.100	4020.48	347.87	-91.80	-335.58	0.22	
4149.00	0.100	73.300	4110.48	347.58	-92.77	-335.02	1.54	
4239.00	0.200	348.900	4200.47	347.49	-92.59	-334.98	0.24	
4328.00	1.000	265.900	4289.47	348.24	-92.49	-335.78	1.12	
4417.00	2.200	264.200	4378.43	350.70	-92.72	-338.26	1.35	
4507.00	1.400	272.200	4468.39	353.46	-92.85	-341.08	0.93	
4596.00	0.700	274.400	4557.37	355.01	-92.77	-342.70	0.79	
4687.00	0.900	255.400	4648.36	356.25	-92.91	-343.95	0.36	
4776.00	0.800	245.200	4737.35	357.56	-93.34	-345.19	0.20	
4866.00	1.000	216.000	4827.34	358.79	-94.24	-346.22	0.55	
4957.00	0.600	222.700	4918.34	359.80	-95.24	-347.01	0.45	
5045.00	0.700	171.700	5006.33	360.25	-96.11	-347.25	0.64	
5134.00	0.500	158.000	5095.33	360.25	-97.00	-347.02	0.28	
5224.00	0.800	162.200	5185.32	360.17	-97.97	-346.68	0.34	
5313.00	1.000	171.300	5274.31	360.21	-99.33	-346.38	0.28	
5403.00	0.200	91.200	5364.30	360.14	-100.11	-346.10	1.10	
5493.00	0.600	46.200	5454.30	359.57	-99.78	-345.60	0.53	
5584.00	0.300	68.300	5545.30	358.92	-99.36	-345.04	0.37	
5674.00	0.400	100.300	5635.30	358.40	-99.33	-344.51	0.24	
5764.00	0.600	132.700	5725.29	357.86	-99.71	-343.85	0.38	
5855.00	0.700	79.200	5816.29	357.05	-99.93	-342.96	0.65	
5945.00	0.600	135.500	5906.28	356.26	-100.16	-342.09	0.69	
6031.00	0.400	329.600	5992.28	356.12	-100.22	-341.92	1.15	
6120.00	0.100	302.100	6081.28	356.26	-99.91	-342.15	0.35	
6211.00	0.900	204.700	6172.28	356.77	-100.52	-342.51	1.01	



Actual Wellpath Report

RIVERBEND 7-13 AWP

Page 4 of 6



INTEQ

REFERENCE WELLPATH IDENTIFICATION

Operator	KERR MCGEE OIL & GAS ONSHORE LP	Slot	SLOT#02 RIVERBEND 7-13 (2045'FNL & 1795'FEL)
Area	COLORADO	Well	RIVERBEND 7-13
Field	WELD COUNTY (KERR MCGEE)	Wellbore	RIVERBEND 7-13 AWP
Facility	SEC.13-T1N-R67W		

WELLPATH DATA (112 stations)

MD [ft]	Inclination [°]	Azimuth [°]	TVD [ft]	Vert Sect [ft]	North [ft]	East [ft]	DLS [°/100ft]	Comments
6301.00	1.100	132.000	6262.27	356.74	-101.74	-342.17	1.33	
6391.00	0.900	131.600	6352.25	355.86	-102.79	-341.00	0.22	
6480.00	0.300	334.100	6441.25	355.52	-103.04	-340.57	1.33	
6570.00	0.700	165.700	6531.25	355.57	-103.36	-340.54	1.11	
6659.00	1.400	134.800	6620.23	355.01	-104.66	-339.64	0.98	
6749.00	1.800	114.700	6710.20	353.36	-106.02	-337.57	0.76	
6839.00	2.500	48.300	6800.15	350.51	-105.31	-334.82	2.70	
6929.00	1.900	38.800	6890.08	347.57	-102.84	-332.42	0.78	
7018.00	2.200	19.100	6979.03	345.45	-100.08	-330.94	0.86	
7108.00	2.200	14.200	7068.96	343.66	-96.77	-329.95	0.21	
7196.00	2.200	12.400	7156.89	342.09	-93.48	-329.17	0.08	
7285.00	2.000	4.000	7245.83	340.82	-90.26	-328.70	0.41	
7376.00	0.800	17.000	7336.81	339.99	-88.07	-328.40	1.36	
7466.00	0.600	27.600	7426.80	339.35	-87.05	-328.00	0.26	
7556.00	0.800	38.800	7516.79	338.53	-86.15	-327.39	0.27	
7647.00	0.700	21.600	7607.78	337.69	-85.13	-326.78	0.27	
7734.00	0.400	17.000	7694.78	337.22	-84.35	-326.50	0.35	
7779.00	0.600	29.300	7739.78	336.97	-83.99	-326.34	0.50	
7869.00	0.600	38.800	7829.77	336.27	-83.22	-325.81	0.11	
7961.00	0.900	58.800	7921.77	335.19	-82.47	-324.89	0.43	
8049.00	0.700	59.200	8009.76	334.01	-81.83	-323.84	0.23	LAST BHI MWD SURVEY
8105.00	0.700	59.200	8065.75	333.36	-81.48	-323.25	0.00	PROJECTION TO BIT

HOLE & CASING SECTIONS Ref Wellbore: RIVERBEND 7-13 AWP Ref Wellpath: RIVERBEND 7-13 AWP

String/Diameter	Start MD [ft]	End MD [ft]	Interval [ft]	Start TVD [ft]	End TVD [ft]	Start N/S [ft]	Start E/W [ft]	End N/S [ft]	End E/W [ft]
12.25in Open Hole	0.00	940.00	940.00	0.00	933.88	0.00	0.00	-18.88	-77.58
8.625in Casing Surface	17.00	940.00	923.00	17.00	933.88	0.00	0.00	-18.88	-77.58
7.875in Open Hole	940.00	8105.00	7165.00	933.88	8065.75	-18.88	-77.58	-81.48	-323.25



Actual Wellpath Report

RIVERBEND 7-13 AWP

Page 5 of 6



INTEQ

REFERENCE WELLPATH IDENTIFICATION

Operator	KERR MCGEE OIL & GAS ONSHORE LP	Slot	SLOT#02 RIVERBEND 7-13 (2045'FNL & 1795'FEL)
Area	COLORADO	Well	RIVERBEND 7-13
Field	WELD COUNTY (KERR MCGEE)	Wellbore	RIVERBEND 7-13 AWB
Facility	SEC.13-T1N-R67W		

TARGETS

Name	MD [ft]	TVD [ft]	North [ft]	East [ft]	Grid East [srv ft]	Grid North [srv ft]	Latitude	Longitude	Shape
RIVERBEND 7-13 BHL ON PLAT (2130'FNL & 2130'FEL, REV-1)		6000.00	-86.33	-334.53	3185504.52	1262656.39	40°03'08.921"N	104°50'14.392"W	point
RIVERBEND 7-13 GEO TARGET 50' RADIUS (2130'FNL & 2117'FEL, REV-2)		6000.00	-86.33	-321.53	3185517.51	1262656.49	40°03'08.921"N	104°50'14.224"W	circle
RIVERBEND 7-13 LEGAL BOX (54'N,346'S,50'W,350'E OF GEO TARGET)		6000.00	59.67	-171.53	3185666.41	1262803.60	40°03'10.364"N	104°50'12.296"W	square

WELLPATH COMPOSITION Ref Wellbore: RIVERBEND 7-13 AWB Ref Wellpath: RIVERBEND 7-13 AWP

Start MD [ft]	End MD [ft]	Positional Uncertainty Model	Log Name/Comment	Wellbore
17.00	877.00	NaviTrak (Standard)	BHI MWD SURVEYS 12.25 HOLE <152-877>	RIVERBEND 7-13 AWB
877.00	8049.00	NaviTrak (Standard)	BHI MWD SURVEYS 7.875 HOLE <967-8049>	RIVERBEND 7-13 AWB
8049.00	8105.00	Blind Drilling (std)	Projection to bit	RIVERBEND 7-13 AWB



Actual Wellpath Report

RIVERBEND 7-13 AWP

Page 6 of 6



INTEQ

REFERENCE WELLPATH IDENTIFICATION

Operator	KERR MCGEE OIL & GAS ONSHORE LP	Slot	SLOT#02 RIVERBEND 7-13 (2045'FNL & 1795'FEL)
Area	COLORADO	Well	RIVERBEND 7-13
Field	WELD COUNTY (KERR MCGEE)	Wellbore	RIVERBEND 7-13 AWB
Facility	SEC.13-T1N-R67W		

WELLPATH COMMENTS

MD [ft]	Inclination [°]	Azimuth [°]	TVD [ft]	Comment
8049.00	0.700	59.200	8009.76	LAST BHI MWD SURVEY
8105.00	0.700	59.200	8065.75	PROJECTION TO BIT