

BLUE CHIP OIL - Weld County CO

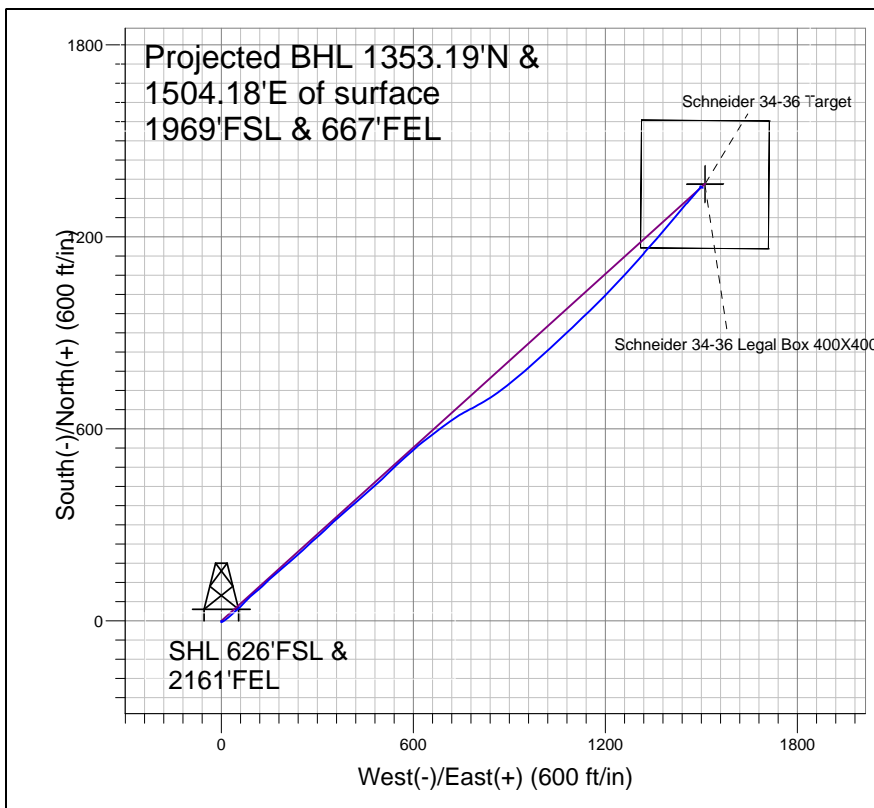

LEGEND

- Schneider 34-36, Wellbore #1 Schneider 34-36, Design #1 V0
- Wellbore #1 Schneider 34-36

Final Survey Plot

Projected Final Survey -
 7897'MD & 7482.01'TVD
 @ 2023.28' VS
 0.8 deg Inc 132.10 deg AZ

Project: SEC.36-T7N-R67W
 Site: Schneider Pad SEC.36-T7N-R67W
 Well: Schneider 34-36
 Plan: Wellbore #1 Schneider 34-36



BLUE CHIP OIL - Weld County CO

SEC.36-T7N-R67W

Schneider Pad SEC.36-T7N-R67W

Schneider 34-36

Wellbore #1 Schneider 34-36

Design: Wellbore #1 Schneider 34-36

Standard Survey Report

03 July, 2008

Company:	BLUE CHIP OIL - Weld County CO	Local Co-ordinate Reference:	Well Schneider 34-36
Project:	SEC.36-T7N-R67W	TVD Reference:	WELL @ 4890.0ft (Original Well Elev)
Site:	Schneider Pad SEC.36-T7N-R67W	MD Reference:	WELL @ 4890.0ft (Original Well Elev)
Well:	Schneider 34-36	North Reference:	True
Wellbore:	Wellbore #1 Schneider 34-36	Survey Calculation Method:	Minimum Curvature
Design:	Wellbore #1 Schneider 34-36	Database:	Landmark

Project	SEC.36-T7N-R67W, WELD COUNTY COLORADO		
Map System:	US State Plane 1983	System Datum:	Mean Sea Level
Geo Datum:	North American Datum 1983		Using Well Reference Point
Map Zone:	Colorado Northern Zone		Using geodetic scale factor

Site		Schneider Pad SEC.36-T7N-R67W			
Site Position:		Northing:	1,434,784.67 ft	Latitude:	40° 31' 30.036 N
From:	Lat/Long	Easting:	3,183,484.52 ft	Longitude:	104° 50' 23.892 W
Position Uncertainty:	0.0 ft	Slot Radius:	"	Grid Convergence:	0.43 °

Well	Schneider 34-36					
Well Position	+N/-S	0.0 ft	Northing:	1,434,835.67 ft	Latitude:	40° 31' 30.540 N
	+E/-W	0.0 ft	Easting:	3,183,484.14 ft	Longitude:	104° 50' 23.892 W
Position Uncertainty		0.0 ft	Wellhead Elevation:	ft	Ground Level:	4,876.0 ft

Wellbore		Wellbore #1 Schneider 34-36			
Magnetics	Model Name	Sample Date	Declination (°)	Dip Angle (°)	Field Strength (nT)
	IGRF200510	10/16/2007	9.38	67.27	53,590
	IGRF200510	6/4/2008	9.29	67.25	53,524

Design		Wellbore #1 Schneider 34-36			
Audit Notes:					
Version:	1.0	Phase:	ACTUAL	Tie On Depth:	0.0
Vertical Section:	Depth From (TVD) (ft)	+N/-S (ft)	+E/-W (ft)	Direction (°)	
	0.0	0.0	0.0	48.02	

Survey Program		Date	7/3/2008		
From (ft)	To (ft)	Survey (Wellbore)	Tool Name	Description	
457.0	7,897.0	Survey #1 (Wellbore #1 Schneider 34-36)	MWD	MWD - Standard	

Survey	Wellbore Data									
	Measured Depth (ft)	Inclination (°)	Azimuth (°)	Vertical Depth (ft)	+N/-S (ft)	+E/-W (ft)	Vertical Section (ft)	Dogleg Rate (°/100ft)	Build Rate (°/100ft)	Turn Rate (°/100ft)
Main Survey	0.0	0.00	0.00	0.0	0.0	0.0	0.0	0.00	0.00	0.00
	40.0	0.04	183.60	40.0	0.0	0.0	0.0	0.09	0.09	0.00
	80.0	0.07	183.60	80.0	0.0	0.0	0.0	0.09	0.09	0.00
	120.0	0.11	183.60	120.0	-0.1	0.0	-0.1	0.09	0.09	0.00
	160.0	0.14	183.60	160.0	-0.2	0.0	-0.1	0.09	0.09	0.00
	200.0	0.18	183.60	200.0	-0.3	0.0	-0.2	0.09	0.09	0.00
	240.0	0.21	183.60	240.0	-0.4	0.0	-0.3	0.09	0.09	0.00
	280.0	0.25	183.60	280.0	-0.6	0.0	-0.4	0.09	0.09	0.00
	320.0	0.28	183.60	320.0	-0.8	0.0	-0.6	0.09	0.09	0.00
	360.0	0.32	183.60	360.0	-1.0	-0.1	-0.7	0.09	0.09	0.00
	400.0	0.35	183.60	400.0	-1.2	-0.1	-0.9	0.09	0.09	0.00
	440.0	0.39	183.60	440.0	-1.5	-0.1	-1.1	0.09	0.09	0.00

Company:	BLUE CHIP OIL - Weld County CO	Local Co-ordinate Reference:	Well Schneider 34-36
Project:	SEC.36-T7N-R67W	TVD Reference:	WELL @ 4890.0ft (Original Well Elev)
Site:	Schneider Pad SEC.36-T7N-R67W	MD Reference:	WELL @ 4890.0ft (Original Well Elev)
Well:	Schneider 34-36	North Reference:	True
Wellbore:	Wellbore #1 Schneider 34-36	Survey Calculation Method:	Minimum Curvature
Design:	Wellbore #1 Schneider 34-36	Database:	Landmark

Survey									
Measured Depth (ft)	Inclination (°)	Azimuth (°)	Vertical Depth (ft)	+N/-S (ft)	+E/-W (ft)	Vertical Section (ft)	Dogleg Rate (°/100ft)	Build Rate (°/100ft)	Turn Rate (°/100ft)
480.0	0.40	186.61	480.0	-1.8	-0.1	-1.3	0.06	0.03	7.52
520.0	0.40	191.87	520.0	-2.0	-0.2	-1.5	0.09	0.00	13.16
560.0	0.40	195.54	560.0	-2.3	-0.2	-1.7	0.06	0.00	9.18
600.0	0.40	194.52	600.0	-2.6	-0.3	-1.9	0.02	0.00	-2.55
640.0	0.40	193.50	640.0	-2.8	-0.4	-2.2	0.02	0.00	-2.55
680.0	0.36	200.19	680.0	-3.1	-0.4	-2.4	0.16	-0.11	16.72
720.0	0.32	209.79	720.0	-3.3	-0.5	-2.6	0.17	-0.10	24.00
760.0	0.24	135.20	760.0	-3.5	-0.6	-2.8	0.86	-0.18	-186.48
800.0	0.80	93.00	800.0	-3.5	-0.3	-2.6	1.60	1.39	-105.48
840.0	1.44	82.96	840.0	-3.5	0.5	-2.0	1.68	1.61	-25.12
880.0	2.23	70.52	880.0	-3.2	1.8	-0.8	2.20	1.97	-31.09
920.0	3.07	64.71	919.9	-2.5	3.5	0.9	2.20	2.10	-14.53
960.0	3.77	60.07	959.8	-1.4	5.6	3.2	1.89	1.75	-11.60
1,000.0	4.47	56.67	999.7	0.1	8.0	6.1	1.84	1.73	-8.50
1,040.0	5.20	54.58	1,039.6	2.1	10.8	9.4	1.89	1.84	-5.23
1,080.0	5.97	53.32	1,079.4	4.4	13.9	13.3	1.94	1.91	-3.15
1,120.0	6.72	52.05	1,119.2	7.0	17.5	17.7	1.91	1.88	-3.18
1,160.0	7.39	49.73	1,158.9	10.1	21.3	22.6	1.83	1.69	-5.79
1,200.0	8.08	47.80	1,198.5	13.7	25.3	28.0	1.83	1.71	-4.82
1,240.0	9.01	48.41	1,238.1	17.7	29.7	33.9	2.35	2.34	1.51
1,280.0	10.00	49.31	1,277.5	22.0	34.7	40.5	2.50	2.47	2.26
1,320.0	10.97	48.99	1,316.8	26.7	40.2	47.8	2.41	2.40	-0.81
1,360.0	11.90	47.73	1,356.0	32.0	46.2	55.7	2.42	2.34	-3.15
1,400.0	12.80	46.56	1,395.1	37.8	52.4	64.3	2.32	2.24	-2.91
1,440.0	13.44	45.08	1,434.1	44.2	58.9	73.4	1.81	1.60	-3.72
1,480.0	14.09	43.72	1,472.9	51.0	65.6	82.8	1.81	1.62	-3.38
1,520.0	14.83	44.45	1,511.7	58.1	72.5	92.8	1.91	1.86	1.80
1,560.0	15.60	45.49	1,550.3	65.6	79.9	103.3	2.04	1.92	2.61
1,600.0	16.38	46.78	1,588.7	73.2	87.9	114.3	2.16	1.97	3.22
1,640.0	17.20	48.31	1,627.0	81.0	96.4	125.8	2.32	2.04	3.82
1,680.0	17.99	49.34	1,665.1	89.0	105.5	137.9	2.12	1.97	2.59
1,720.0	18.58	48.33	1,703.1	97.2	115.0	150.5	1.68	1.48	-2.53
1,760.0	19.18	47.38	1,741.0	105.9	124.6	163.4	1.68	1.50	-2.37
1,800.0	19.88	47.31	1,778.7	115.0	134.4	176.8	1.75	1.75	-0.19
1,840.0	20.60	47.43	1,816.2	124.3	144.6	190.6	1.81	1.81	0.32
1,880.0	21.13	47.81	1,853.5	134.0	155.1	204.9	1.37	1.33	0.95
1,920.0	21.43	48.50	1,890.8	143.7	165.9	219.4	0.97	0.74	1.71
1,960.0	21.66	49.12	1,928.0	153.3	177.0	234.1	0.81	0.57	1.55
2,000.0	21.23	49.33	1,965.2	162.9	188.1	248.8	1.08	-1.06	0.52
2,040.0	20.81	49.54	2,002.6	172.2	199.0	263.1	1.08	-1.06	0.54
2,080.0	21.08	49.17	2,040.0	181.5	209.8	277.3	0.77	0.69	-0.94
2,120.0	21.59	48.62	2,077.2	191.1	220.8	291.9	1.37	1.28	-1.38
2,160.0	22.19	48.25	2,114.3	201.0	231.9	306.8	1.53	1.49	-0.93
2,200.0	22.91	48.12	2,151.3	211.2	243.3	322.1	1.81	1.81	-0.32
2,240.0	23.60	47.97	2,188.0	221.7	255.1	337.9	1.73	1.73	-0.36
2,280.0	23.69	47.46	2,224.7	232.5	266.9	354.0	0.56	0.21	-1.30
2,320.0	23.78	46.94	2,261.3	243.5	278.8	370.1	0.56	0.22	-1.29
2,360.0	23.61	47.41	2,297.9	254.5	290.5	386.2	0.62	-0.41	1.16
2,400.0	23.36	48.26	2,334.6	265.2	302.4	402.1	1.06	-0.64	2.13
2,440.0	23.31	48.31	2,371.3	275.6	314.2	417.9	0.13	-0.12	0.13
2,480.0	23.60	47.02	2,408.0	286.3	326.0	433.8	1.48	0.74	-3.21
2,520.0	23.90	45.83	2,444.6	297.4	337.6	449.9	1.41	0.74	-2.98
2,560.0	23.89	47.06	2,481.2	308.6	349.4	466.1	1.25	-0.02	3.09
2,600.0	23.90	48.30	2,517.8	319.5	361.3	482.3	1.25	0.01	3.09

Company:	BLUE CHIP OIL - Weld County CO	Local Co-ordinate Reference:	Well Schneider 34-36
Project:	SEC.36-T7N-R67W	TVD Reference:	WELL @ 4890.0ft (Original Well Elev)
Site:	Schneider Pad SEC.36-T7N-R67W	MD Reference:	WELL @ 4890.0ft (Original Well Elev)
Well:	Schneider 34-36	North Reference:	True
Wellbore:	Wellbore #1 Schneider 34-36	Survey Calculation Method:	Minimum Curvature
Design:	Wellbore #1 Schneider 34-36	Database:	Landmark

Survey										
Measured Depth (ft)	Inclination (°)	Azimuth (°)	Vertical Depth (ft)	+N/-S (ft)	+E/-W (ft)	Vertical Section (ft)	Dogleg Rate (°/100ft)	Build Rate (°/100ft)	Turn Rate (°/100ft)	
2,640.0	24.39	48.94	2,554.3	330.3	373.6	498.6	1.40	1.24	1.61	
2,680.0	25.12	49.29	2,590.6	341.2	386.3	515.4	1.86	1.83	0.86	
2,720.0	25.72	49.41	2,626.8	352.4	399.3	532.6	1.49	1.49	0.30	
2,760.0	26.06	49.15	2,662.7	363.8	412.6	550.1	0.90	0.85	-0.64	
2,800.0	26.40	48.90	2,698.6	375.4	425.9	567.7	0.90	0.85	-0.63	
2,840.0	26.61	48.69	2,734.4	387.2	439.3	585.6	0.58	0.53	-0.54	
2,880.0	26.83	48.47	2,770.1	399.1	452.8	603.6	0.58	0.53	-0.53	
2,920.0	26.26	48.30	2,805.9	411.0	466.3	621.5	1.42	-1.40	-0.44	
2,960.0	25.28	48.13	2,841.9	422.6	479.2	638.9	2.45	-2.45	-0.42	
3,000.0	24.52	47.72	2,878.2	433.8	491.7	655.7	1.96	-1.91	-1.01	
3,040.0	24.26	46.78	2,914.6	445.0	503.8	672.2	1.17	-0.65	-2.35	
3,080.0	24.01	45.82	2,951.1	456.3	515.7	688.6	1.17	-0.64	-2.40	
3,120.0	24.33	46.14	2,987.6	467.7	527.4	704.9	0.87	0.81	0.78	
3,160.0	24.67	46.48	3,024.0	479.2	539.4	721.5	0.92	0.85	0.84	
3,200.0	24.88	47.08	3,060.3	490.7	551.6	738.3	0.82	0.51	1.52	
3,240.0	25.01	47.85	3,096.6	502.1	564.1	755.2	0.87	0.32	1.92	
3,280.0	24.88	48.34	3,132.9	513.4	576.7	772.1	0.62	-0.32	1.24	
3,320.0	24.06	48.14	3,169.3	524.4	589.1	788.6	2.05	-2.04	-0.52	
3,360.0	23.24	47.91	3,205.9	535.1	601.0	804.7	2.05	-2.04	-0.56	
3,400.0	23.03	49.42	3,242.7	545.5	612.8	820.4	1.58	-0.53	3.77	
3,440.0	22.86	51.04	3,279.5	555.5	624.7	836.0	1.64	-0.41	4.06	
3,480.0	22.88	52.01	3,316.4	565.1	636.9	851.5	0.94	0.04	2.41	
3,520.0	23.00	52.52	3,353.2	574.7	649.3	867.0	0.59	0.32	1.28	
3,560.0	23.01	52.92	3,390.0	584.1	661.7	882.6	0.39	0.03	1.00	
3,600.0	22.67	53.01	3,426.9	593.5	674.1	898.1	0.86	-0.86	0.21	
3,640.0	22.33	53.09	3,463.9	602.7	686.4	913.3	0.86	-0.86	0.22	
3,680.0	22.14	53.57	3,500.9	611.7	698.5	928.4	0.64	-0.46	1.19	
3,720.0	21.97	54.08	3,538.0	620.6	710.6	943.4	0.64	-0.42	1.28	
3,760.0	21.67	55.33	3,575.1	629.2	722.7	958.1	1.39	-0.76	3.13	
3,800.0	21.28	57.18	3,612.3	637.4	734.9	972.6	1.95	-0.97	4.61	
3,840.0	21.36	59.09	3,649.6	645.0	747.2	986.8	1.75	0.21	4.78	
3,880.0	22.82	60.89	3,686.7	652.5	760.2	1,001.6	4.01	3.64	4.51	
3,920.0	24.29	62.49	3,723.3	660.1	774.3	1,017.1	4.01	3.68	3.99	
3,960.0	25.81	61.79	3,759.6	668.0	789.2	1,033.5	3.88	3.81	-1.74	
4,000.0	27.35	61.01	3,795.3	676.5	805.0	1,050.9	3.93	3.83	-1.96	
4,040.0	28.60	59.44	3,830.7	685.8	821.3	1,069.3	3.64	3.14	-3.92	
4,080.0	29.68	57.37	3,865.6	696.0	837.9	1,088.4	3.68	2.68	-5.19	
4,120.0	30.60	55.46	3,900.2	707.2	854.6	1,108.3	3.33	2.32	-4.77	
4,160.0	31.02	53.72	3,934.5	719.1	871.3	1,128.7	2.46	1.05	-4.35	
4,200.0	31.47	52.03	3,968.7	731.6	887.9	1,149.4	2.46	1.11	-4.24	
4,240.0	31.18	51.32	4,002.9	744.5	904.2	1,170.1	1.16	-0.71	-1.77	
4,280.0	30.84	50.68	4,037.2	757.5	920.2	1,190.7	1.18	-0.85	-1.60	
4,320.0	30.40	49.77	4,071.6	770.5	935.9	1,211.1	1.60	-1.11	-2.26	
4,360.0	29.88	48.66	4,106.2	783.6	951.1	1,231.2	1.91	-1.29	-2.79	
4,400.0	29.42	47.91	4,140.9	796.8	965.8	1,250.9	1.47	-1.14	-1.88	
4,440.0	29.12	48.33	4,175.8	809.9	980.4	1,270.5	0.92	-0.75	1.07	
4,480.0	28.82	48.77	4,210.8	822.7	994.9	1,289.9	0.92	-0.75	1.09	
4,520.0	28.95	47.81	4,245.8	835.5	1,009.3	1,309.2	1.20	0.32	-2.40	
4,560.0	29.12	46.75	4,280.8	848.7	1,023.6	1,328.6	1.36	0.43	-2.65	
4,600.0	28.91	46.75	4,315.8	862.1	1,037.7	1,348.0	0.54	-0.54	0.00	
4,640.0	28.40	47.54	4,350.9	875.1	1,051.8	1,367.2	1.58	-1.26	1.99	
4,680.0	28.06	47.98	4,386.1	887.8	1,065.8	1,386.1	0.99	-0.84	1.09	
4,720.0	28.39	46.88	4,421.4	900.6	1,079.7	1,405.0	1.53	0.82	-2.74	
4,760.0	28.73	45.81	4,456.5	913.8	1,093.6	1,424.1	1.53	0.84	-2.68	

Company:	BLUE CHIP OIL - Weld County CO	Local Co-ordinate Reference:	Well Schneider 34-36
Project:	SEC.36-T7N-R67W	TVD Reference:	WELL @ 4890.0ft (Original Well Elev)
Site:	Schneider Pad SEC.36-T7N-R67W	MD Reference:	WELL @ 4890.0ft (Original Well Elev)
Well:	Schneider 34-36	North Reference:	True
Wellbore:	Wellbore #1 Schneider 34-36	Survey Calculation Method:	Minimum Curvature
Design:	Wellbore #1 Schneider 34-36	Database:	Landmark

Survey									
Measured Depth (ft)	Inclination (°)	Azimuth (°)	Vertical Depth (ft)	+N-S (ft)	+E-W (ft)	Vertical Section (ft)	Dogleg Rate (°/100ft)	Build Rate (°/100ft)	Turn Rate (°/100ft)
4,800.0	28.63	45.67	4,491.6	927.2	1,107.3	1,443.3	0.31	-0.26	-0.36
4,840.0	28.41	45.75	4,526.7	940.6	1,121.0	1,462.4	0.55	-0.54	0.22
4,880.0	27.59	46.09	4,562.0	953.7	1,134.5	1,481.3	2.09	-2.05	0.85
4,920.0	26.10	46.76	4,597.7	966.2	1,147.6	1,499.4	3.80	-3.73	1.66
4,960.0	24.74	47.24	4,633.8	977.8	1,160.2	1,516.5	3.44	-3.40	1.20
5,000.0	24.27	45.90	4,670.2	989.2	1,172.2	1,533.1	1.82	-1.19	-3.34
5,040.0	23.80	44.52	4,706.8	1,000.7	1,183.8	1,549.3	1.82	-1.16	-3.46
5,080.0	23.63	43.90	4,743.4	1,012.2	1,195.0	1,565.4	0.75	-0.42	-1.54
5,120.0	23.55	43.51	4,780.0	1,023.8	1,206.0	1,581.3	0.44	-0.21	-0.97
5,160.0	23.88	43.32	4,816.7	1,035.5	1,217.0	1,597.3	0.86	0.84	-0.48
5,200.0	24.73	43.36	4,853.2	1,047.4	1,228.3	1,613.7	2.13	2.13	0.11
5,240.0	25.49	43.37	4,889.4	1,059.8	1,240.0	1,630.6	1.89	1.89	0.03
5,280.0	25.41	43.12	4,925.5	1,072.3	1,251.8	1,647.8	0.35	-0.21	-0.64
5,320.0	25.32	42.86	4,961.6	1,084.8	1,263.5	1,664.8	0.35	-0.21	-0.64
5,360.0	25.24	42.54	4,997.8	1,097.4	1,275.0	1,681.9	0.40	-0.22	-0.80
5,400.0	25.15	42.20	5,034.0	1,110.0	1,286.5	1,698.8	0.42	-0.21	-0.86
5,440.0	24.55	41.53	5,070.2	1,122.5	1,297.8	1,715.6	1.65	-1.49	-1.68
5,480.0	23.27	40.33	5,106.8	1,134.8	1,308.4	1,731.7	3.42	-3.20	-3.00
5,520.0	22.00	39.18	5,143.7	1,146.6	1,318.3	1,746.9	3.37	-3.19	-2.86
5,560.0	20.68	40.37	5,181.0	1,157.8	1,327.6	1,761.3	3.48	-3.31	2.96
5,600.0	19.36	41.70	5,218.6	1,168.2	1,336.6	1,774.9	3.48	-3.29	3.34
5,640.0	19.44	42.07	5,256.3	1,177.9	1,345.4	1,788.0	0.36	0.19	0.91
5,680.0	20.04	42.02	5,294.0	1,188.0	1,354.4	1,801.4	1.51	1.51	-0.11
5,720.0	20.47	41.69	5,331.5	1,198.3	1,363.7	1,815.2	1.11	1.07	-0.84
5,760.0	20.64	40.92	5,369.0	1,208.8	1,373.0	1,829.2	0.80	0.42	-1.92
5,800.0	20.76	40.21	5,406.4	1,219.6	1,382.2	1,843.2	0.70	0.31	-1.78
5,840.0	19.95	40.37	5,443.9	1,230.2	1,391.2	1,857.0	2.03	-2.02	0.40
5,880.0	19.14	40.54	5,481.6	1,240.4	1,399.9	1,870.3	2.03	-2.02	0.44
5,920.0	18.39	40.01	5,519.4	1,250.2	1,408.2	1,883.0	1.94	-1.89	-1.34
5,960.0	17.65	39.10	5,557.5	1,259.7	1,416.1	1,895.3	1.96	-1.83	-2.26
6,000.0	16.77	38.85	5,595.7	1,269.0	1,423.5	1,907.0	2.23	-2.22	-0.64
6,040.0	15.62	39.86	5,634.1	1,277.6	1,430.6	1,918.0	2.96	-2.88	2.54
6,080.0	14.48	41.01	5,672.7	1,285.5	1,437.3	1,928.3	2.93	-2.84	2.87
6,120.0	13.76	41.45	5,711.5	1,292.8	1,443.7	1,938.0	1.83	-1.81	1.09
6,160.0	13.03	41.93	5,750.4	1,299.8	1,449.9	1,947.2	1.83	-1.81	1.21
6,200.0	12.13	41.72	5,789.5	1,306.3	1,455.7	1,955.9	2.26	-2.26	-0.52
6,240.0	11.14	41.08	5,828.6	1,312.3	1,461.1	1,963.9	2.49	-2.47	-1.60
6,280.0	10.11	40.31	5,867.9	1,317.9	1,465.9	1,971.2	2.60	-2.58	-1.93
6,320.0	9.00	39.34	5,907.4	1,323.0	1,470.1	1,977.8	2.80	-2.77	-2.42
6,360.0	7.90	38.10	5,947.0	1,327.6	1,473.8	1,983.6	2.80	-2.76	-3.10
6,400.0	7.34	39.76	5,986.6	1,331.7	1,477.2	1,988.8	1.51	-1.41	4.16
6,440.0	6.78	41.70	6,026.3	1,335.4	1,480.4	1,993.7	1.51	-1.39	4.84
6,480.0	6.31	42.86	6,066.0	1,338.8	1,483.4	1,998.2	1.21	-1.17	2.90
6,520.0	5.89	43.62	6,105.8	1,341.9	1,486.3	2,002.5	1.08	-1.06	1.90
6,560.0	5.43	43.97	6,145.6	1,344.7	1,489.1	2,006.4	1.14	-1.14	0.88
6,600.0	4.92	43.18	6,185.5	1,347.4	1,491.6	2,010.0	1.30	-1.29	-1.98
6,640.0	4.40	42.20	6,225.3	1,349.7	1,493.8	2,013.2	1.30	-1.29	-2.45
6,680.0	3.67	39.20	6,265.2	1,351.9	1,495.6	2,016.0	1.91	-1.84	-7.49
6,720.0	2.95	34.73	6,305.2	1,353.7	1,497.0	2,018.3	1.91	-1.80	-11.19
6,760.0	2.13	27.82	6,345.1	1,355.2	1,497.9	2,020.0	2.16	-2.03	-17.27
6,800.0	1.33	12.68	6,385.1	1,356.3	1,498.4	2,021.1	2.31	-2.02	-37.84
6,840.0	0.90	341.30	6,425.1	1,357.0	1,498.4	2,021.5	1.82	-1.07	-78.47
6,880.0	0.96	323.13	6,465.1	1,357.6	1,498.1	2,021.7	0.75	0.14	-45.41
6,914.8	1.07	310.00	6,499.9	1,358.0	1,497.6	2,021.7	0.75	0.34	-37.69

Company:	BLUE CHIP OIL - Weld County CO	Local Co-ordinate Reference:	Well Schneider 34-36
Project:	SEC.36-T7N-R67W	TVD Reference:	WELL @ 4890.0ft (Original Well Elev)
Site:	Schneider Pad SEC.36-T7N-R67W	MD Reference:	WELL @ 4890.0ft (Original Well Elev)
Well:	Schneider 34-36	North Reference:	True
Wellbore:	Wellbore #1 Schneider 34-36	Survey Calculation Method:	Minimum Curvature
Design:	Wellbore #1 Schneider 34-36	Database:	Landmark

Survey									
Measured Depth (ft)	Inclination (°)	Azimuth (°)	Vertical Depth (ft)	+N/-S (ft)	+E/-W (ft)	Vertical Section (ft)	Dogleg Rate (°/100ft)	Build Rate (°/100ft)	Turn Rate (°/100ft)
Schneider 34-36 Target									
6,920.0	1.10	308.32	6,505.1	1,358.1	1,497.6	2,021.7	0.75	0.42	-32.62
6,960.0	0.54	281.40	6,545.1	1,358.4	1,497.1	2,021.5	1.65	-1.39	-67.30
7,000.0	0.51	200.87	6,585.1	1,358.3	1,496.8	2,021.2	1.70	-0.07	-201.32
7,040.0	0.74	163.10	6,625.1	1,357.8	1,496.8	2,020.9	1.14	0.57	-94.41
7,080.0	0.97	138.29	6,665.1	1,357.3	1,497.1	2,020.8	1.07	0.57	-62.03
7,120.0	1.09	125.48	6,705.1	1,356.8	1,497.7	2,020.9	0.65	0.30	-32.04
7,160.0	0.69	112.66	6,745.1	1,356.5	1,498.2	2,021.1	1.10	-0.98	-32.05
7,200.0	0.41	76.34	6,785.1	1,356.4	1,498.6	2,021.3	1.10	-0.72	-90.79
7,240.0	0.32	74.87	6,825.0	1,356.5	1,498.8	2,021.5	0.22	-0.22	-3.69
7,280.0	0.23	77.51	6,865.0	1,356.5	1,499.0	2,021.7	0.21	-0.21	6.61
7,315.0	0.19	99.24	6,900.0	1,356.6	1,499.2	2,021.8	0.26	-0.13	62.07
Schneider 34-36 Legal Box 400X400									
7,320.0	0.18	103.11	6,905.0	1,356.6	1,499.2	2,021.8	0.26	-0.08	77.34
7,360.0	0.23	139.37	6,945.0	1,356.5	1,499.3	2,021.8	0.34	0.11	90.66
7,400.0	0.32	153.58	6,985.0	1,356.3	1,499.4	2,021.8	0.29	0.23	35.53
7,440.0	0.41	149.09	7,025.0	1,356.1	1,499.5	2,021.7	0.22	0.21	-11.22
7,480.0	0.49	146.18	7,065.0	1,355.8	1,499.7	2,021.7	0.22	0.22	-7.29

Checked By: _____	Approved By: _____	Date: _____
-------------------	--------------------	-------------