

Anadarko, Adams County CO

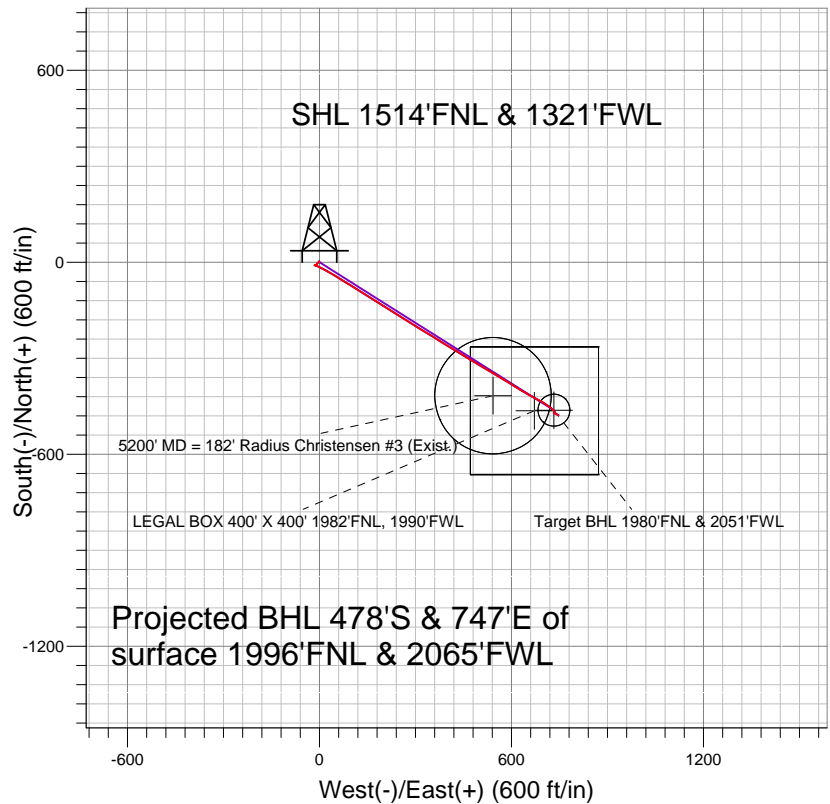

LEGEND

- ✕ Talon View 6-9, Wellbore #1, Plan #2 (9-21-10) V0
- Wellbore #1
- Survey #1

Final Survey Plot

Projected Final Survey -
8585'MD & 8495'TVD @ 887' VS
1.1 deg Inc 136.0 deg AZ

Project: SEC.9-T1S-R67W
Site: Talon View 18-9 Pad Sec.9-T1S-R67W
Well: Talon View 6-9
Plan: Wellbore #1



Directional

Anadarko, Adams County CO

SEC.9-T1S-R67W

Talon View 18-9 Pad Sec.9-T1S-R67W

Talon View 6-9

Wellbore #1

Survey: Survey #1

Standard Survey Report

14 October, 2010

Company:	Anadarko, Adams County CO	Local Co-ordinate Reference:	Well Talon View 6-9
Project:	SEC.9-T1S-R67W	TVD Reference:	WELL @ 5171.0ft (Original Well Elev)
Site:	Talon View 18-9 Pad Sec.9-T1S-R67W	MD Reference:	WELL @ 5171.0ft (Original Well Elev)
Well:	Talon View 6-9	North Reference:	True
Wellbore:	Wellbore #1	Survey Calculation Method:	Minimum Curvature
Design:	Wellbore #1	Database:	Landmark

Project	SEC.9-T1S-R67W, Adams County, Colorado		
Map System:	US State Plane 1983	System Datum:	Mean Sea Level
Geo Datum:	North American Datum 1983		Using Well Reference Point
Map Zone:	Colorado Northern Zone		Using geodetic scale factor

Site	Talon View 18-9 Pad Sec.9-T1S-R67W		
Site Position:		Northing:	1,236,908.77 ft
From:	Lat/Long	Easting:	3,168,530.03 ft
Position Uncertainty:	0.0 ft	Slot Radius:	"
		Latitude:	39° 58' 55.668 N
		Longitude:	104° 53' 54.924 W
		Grid Convergence:	0.39 °

Well	Talon View 6-9		
Well Position	+N-S	0.0 ft	Northing:
	+E-W	0.0 ft	Easting:
Position Uncertainty		0.0 ft	Wellhead Elevation:
			Latitude:
			Longitude:
			Ground Level:

Wellbore	Wellbore #1				
Magnetics	Model Name	Sample Date	Declination (°)	Dip Angle (°)	Field Strength (nT)
	IGRF2010	10/7/2010	8.99	66.71	52,966

Design	Wellbore #1				
Audit Notes:					
Version:	1.0	Phase:	ACTUAL	Tie On Depth:	0.0
Vertical Section:	Depth From (TVD) (ft)	+N-S (ft)	+E-W (ft)	Direction (°)	
	0.0	0.0	0.0	122.64	

Survey Program	Date	10/14/2010			
From (ft)	To (ft)	Survey (Wellbore)	Tool Name	Description	
115.0	8,585.0	Survey #1 (Wellbore #1)			

Survey										
Measured Depth (ft)	Inclination (°)	Azimuth (°)	Vertical Depth (ft)	+N-S (ft)	+E-W (ft)	Vertical Section (ft)	Dogleg Rate (°/100ft)	Build Rate (°/100ft)	Turn Rate (°/100ft)	
0.0	0.00	0.00	0.0	0.0	0.0	0.0	0.00	0.00	0.00	
115.0	0.10	243.80	115.0	0.0	-0.1	-0.1	0.09	0.09	0.00	
208.0	0.10	246.10	208.0	-0.1	-0.2	-0.1	0.00	0.00	2.47	
270.0	0.10	350.80	270.0	-0.1	-0.3	-0.2	0.26	0.00	168.87	
365.0	0.90	324.70	365.0	0.6	-0.7	-1.0	0.85	0.84	-27.47	
545.0	0.30	339.50	545.0	2.2	-1.7	-2.6	0.34	-0.33	8.22	
634.0	0.40	99.02	634.0	2.4	-1.5	-2.5	0.68	0.11	134.29	
721.0	0.30	339.50	721.0	2.5	-1.3	-2.4	0.70	-0.11	-137.38	
812.0	0.05	279.00	812.0	2.8	-1.4	-2.7	0.31	-0.27	-66.48	
902.0	0.20	207.50	902.0	2.6	-1.5	-2.7	0.21	0.17	-79.44	
993.0	0.60	197.40	993.0	2.0	-1.7	-2.6	0.44	0.44	-11.10	
1,081.0	0.70	223.50	1,081.0	1.2	-2.2	-2.5	0.35	0.11	29.66	
1,170.0	0.90	226.40	1,170.0	0.3	-3.1	-2.8	0.23	0.22	3.26	

Company:	Anadarko, Adams County CO	Local Co-ordinate Reference:	Well Talon View 6-9
Project:	SEC.9-T1S-R67W	TVD Reference:	WELL @ 5171.0ft (Original Well Elev)
Site:	Talon View 18-9 Pad Sec.9-T1S-R67W	MD Reference:	WELL @ 5171.0ft (Original Well Elev)
Well:	Talon View 6-9	North Reference:	True
Wellbore:	Wellbore #1	Survey Calculation Method:	Minimum Curvature
Design:	Wellbore #1	Database:	Landmark

Survey										
Measured Depth (ft)	Inclination (°)	Azimuth (°)	Vertical Depth (ft)	+N/-S (ft)	+E/-W (ft)	Vertical Section (ft)	Dogleg Rate (°/100ft)	Build Rate (°/100ft)	Turn Rate (°/100ft)	
1,261.0	0.80	227.50	1,261.0	-0.6	-4.1	-3.1	0.11	-0.11	1.21	
1,312.0	0.90	230.20	1,312.0	-1.1	-4.7	-3.3	0.21	0.20	5.29	
1,375.0	0.80	236.80	1,374.9	-1.6	-5.4	-3.7	0.22	-0.16	10.48	
1,448.0	0.90	217.30	1,447.9	-2.4	-6.2	-3.9	0.42	0.14	-26.71	
1,537.0	1.00	220.30	1,536.9	-3.5	-7.1	-4.1	0.13	0.11	3.37	
1,627.0	1.70	201.40	1,626.9	-5.4	-8.1	-3.9	0.91	0.78	-21.00	
1,716.0	1.10	208.60	1,715.9	-7.3	-9.0	-3.6	0.70	-0.67	8.09	
1,806.0	1.30	206.30	1,805.9	-9.0	-9.9	-3.4	0.23	0.22	-2.56	
1,895.0	0.20	238.50	1,894.8	-10.0	-10.4	-3.4	1.28	-1.24	36.18	
1,986.0	0.40	246.10	1,985.8	-10.2	-10.9	-3.6	0.22	0.22	8.35	
2,074.0	0.50	268.70	2,073.8	-10.4	-11.5	-4.1	0.23	0.11	25.68	
2,255.0	1.10	299.70	2,254.8	-9.5	-13.8	-6.5	0.40	0.33	17.13	
2,344.0	0.50	312.30	2,343.8	-8.8	-14.9	-7.8	0.70	-0.67	14.16	
2,433.0	0.30	162.40	2,432.8	-8.8	-15.1	-8.0	0.87	-0.22	-168.43	
2,530.0	1.50	120.30	2,529.8	-9.7	-13.9	-6.5	1.33	1.24	-43.40	
2,620.0	2.30	109.80	2,619.7	-10.9	-11.2	-3.6	0.97	0.89	-11.67	
2,710.0	3.30	107.40	2,709.6	-12.3	-7.0	0.7	1.12	1.11	-2.67	
2,800.0	5.20	116.90	2,799.4	-14.9	-0.9	7.3	2.24	2.11	10.56	
2,890.0	6.60	118.80	2,888.9	-19.2	7.3	16.5	1.57	1.56	2.11	
2,970.0	7.70	117.50	2,968.3	-23.9	16.0	26.4	1.39	1.38	-1.63	
3,059.0	9.30	118.40	3,056.3	-30.1	27.7	39.5	1.80	1.80	1.01	
3,149.0	9.80	121.60	3,145.1	-37.6	40.6	54.4	0.81	0.56	3.56	
3,238.0	10.70	120.60	3,232.6	-45.7	54.1	70.3	1.03	1.01	-1.12	
3,327.0	11.10	123.30	3,320.0	-54.6	68.4	87.1	0.73	0.45	3.03	
3,416.0	10.90	121.40	3,407.4	-63.7	82.8	104.1	0.47	-0.22	-2.13	
3,505.0	11.40	120.70	3,494.7	-72.6	97.5	121.3	0.58	0.56	-0.79	
3,595.0	11.60	122.70	3,582.9	-82.0	112.8	139.2	0.50	0.22	2.22	
3,686.0	12.10	122.60	3,672.0	-92.1	128.5	157.9	0.55	0.55	-0.11	
3,776.0	11.90	118.90	3,760.0	-101.7	144.6	176.6	0.88	-0.22	-4.11	
3,867.0	11.80	122.80	3,849.1	-111.3	160.6	195.2	0.89	-0.11	4.29	
3,957.0	11.60	121.60	3,937.2	-121.0	176.0	213.5	0.35	-0.22	-1.33	
4,046.0	11.80	125.00	4,024.4	-130.9	191.1	231.5	0.81	0.22	3.82	
4,136.0	12.40	122.60	4,112.4	-141.4	206.8	250.4	0.87	0.67	-2.67	
4,227.0	12.30	121.40	4,201.2	-151.7	223.3	269.9	0.30	-0.11	-1.32	
4,318.0	12.40	122.80	4,290.1	-162.0	239.8	289.3	0.35	0.11	1.54	
4,405.0	13.10	122.90	4,375.0	-172.4	255.9	308.5	0.80	0.80	0.11	
4,494.0	12.30	120.70	4,461.8	-182.8	272.5	328.1	1.05	-0.90	-2.47	
4,583.0	12.20	120.10	4,548.8	-192.3	288.8	346.9	0.18	-0.11	-0.67	
4,672.0	12.50	123.40	4,635.7	-202.3	305.0	366.0	0.86	0.34	3.71	
4,729.0	12.80	121.90	4,691.3	-209.1	315.5	378.4	0.78	0.53	-2.63	
4,846.0	12.70	119.60	4,805.5	-222.3	337.7	404.3	0.44	-0.09	-1.97	
4,934.0	12.30	122.70	4,891.4	-232.1	354.0	423.3	0.89	-0.45	3.52	
5,024.0	11.60	123.90	4,979.4	-242.3	369.6	441.9	0.83	-0.78	1.33	
5,115.0	12.70	119.00	5,068.4	-252.3	385.9	461.0	1.66	1.21	-5.38	
5,205.0	13.50	120.30	5,156.0	-262.4	403.6	481.4	0.95	0.89	1.44	
5,293.0	12.90	122.40	5,241.7	-272.8	420.8	501.5	0.87	-0.68	2.39	
5,382.0	12.10	121.90	5,328.6	-283.1	437.1	520.8	0.91	-0.90	-0.56	
5,472.0	12.60	124.70	5,416.5	-293.7	453.2	540.0	0.87	0.56	3.11	
5,560.0	13.00	120.20	5,502.3	-304.1	469.6	559.5	1.22	0.45	-5.11	
5,649.0	13.00	121.10	5,589.1	-314.3	486.9	579.5	0.23	0.00	1.01	
5,738.0	13.50	119.90	5,675.7	-324.7	504.4	599.9	0.64	0.56	-1.35	
5,827.0	12.70	120.50	5,762.4	-334.8	521.9	620.0	0.91	-0.90	0.67	
5,917.0	13.00	119.30	5,850.1	-344.8	539.2	640.0	0.45	0.33	-1.33	
6,006.0	13.20	120.60	5,936.8	-354.8	556.7	660.2	0.40	0.22	1.46	

Company:	Anadarko, Adams County CO	Local Co-ordinate Reference:	Well Talon View 6-9
Project:	SEC.9-T1S-R67W	TVD Reference:	WELL @ 5171.0ft (Original Well Elev)
Site:	Talon View 18-9 Pad Sec.9-T1S-R67W	MD Reference:	WELL @ 5171.0ft (Original Well Elev)
Well:	Talon View 6-9	North Reference:	True
Wellbore:	Wellbore #1	Survey Calculation Method:	Minimum Curvature
Design:	Wellbore #1	Database:	Landmark

Survey										
Measured Depth (ft)	Inclination (°)	Azimuth (°)	Vertical Depth (ft)	+N/-S (ft)	+E/-W (ft)	Vertical Section (ft)	Dogleg Rate (°/100ft)	Build Rate (°/100ft)	Turn Rate (°/100ft)	
6,097.0	13.80	124.00	6,025.3	-366.2	574.6	681.4	1.09	0.66	3.74	
6,185.0	13.70	121.10	6,110.8	-377.5	592.3	702.3	0.79	-0.11	-3.30	
6,276.0	13.80	121.50	6,199.2	-388.7	610.7	723.9	0.15	0.11	0.44	
6,369.0	14.00	120.30	6,289.4	-400.2	629.9	746.3	0.38	0.22	-1.29	
6,457.0	13.20	119.10	6,375.0	-410.4	647.9	766.9	0.96	-0.91	-1.36	
6,547.0	12.40	119.20	6,462.7	-420.1	665.3	786.8	0.89	-0.89	0.11	
6,636.0	11.10	120.00	6,549.9	-429.1	681.1	804.9	1.47	-1.46	0.90	
6,727.0	9.20	118.10	6,639.4	-436.9	695.1	820.9	2.12	-2.09	-2.09	
6,816.0	8.10	124.10	6,727.4	-443.8	706.5	834.3	1.60	-1.24	6.74	
6,905.0	6.60	124.20	6,815.7	-450.1	716.0	845.7	1.69	-1.69	0.11	
6,995.0	5.20	127.00	6,905.2	-455.5	723.5	854.9	1.59	-1.56	3.11	
7,083.0	3.70	140.80	6,993.0	-460.1	728.5	861.6	2.08	-1.70	15.68	
7,174.0	2.70	140.00	7,083.8	-464.0	731.7	866.4	1.10	-1.10	-0.88	
7,264.0	1.30	162.00	7,173.8	-466.6	733.4	869.2	1.75	-1.56	24.44	
7,355.0	0.90	157.00	7,264.7	-468.3	734.0	870.6	0.45	-0.44	-5.49	
7,445.0	0.80	233.60	7,354.7	-469.3	733.8	871.0	1.17	-0.11	85.11	
7,535.0	0.70	225.00	7,444.7	-470.0	732.9	870.6	0.17	-0.11	-9.56	
7,715.0	0.10	261.30	7,624.7	-470.8	731.9	870.3	0.35	-0.33	20.17	
7,805.0	0.30	138.30	7,714.7	-471.0	732.0	870.5	0.40	0.22	-136.67	
7,896.0	0.70	102.10	7,805.7	-471.3	732.7	871.2	0.54	0.44	-39.78	
7,986.0	1.60	109.80	7,895.7	-471.9	734.4	873.0	1.01	1.00	8.56	
8,076.0	1.70	124.80	7,985.7	-473.1	736.7	875.5	0.49	0.11	16.67	
8,167.0	1.40	119.30	8,076.6	-474.4	738.8	878.0	0.37	-0.33	-6.04	
8,257.0	1.10	111.50	8,166.6	-475.2	740.5	879.9	0.38	-0.33	-8.67	
8,347.0	1.00	120.50	8,256.6	-475.9	742.0	881.5	0.21	-0.11	10.00	
8,437.0	1.70	101.30	8,346.6	-476.6	744.0	883.6	0.92	0.78	-21.33	
8,526.0	1.10	136.00	8,435.5	-477.5	745.9	885.6	1.14	-0.67	38.99	
8,585.0	1.10	136.00	8,494.5	-478.3	746.7	886.7	0.00	0.00	0.00	

Checked By: _____

Approved By: _____

Date: _____