



01697277

RECEIVED

DEC 19 2008

COGCC

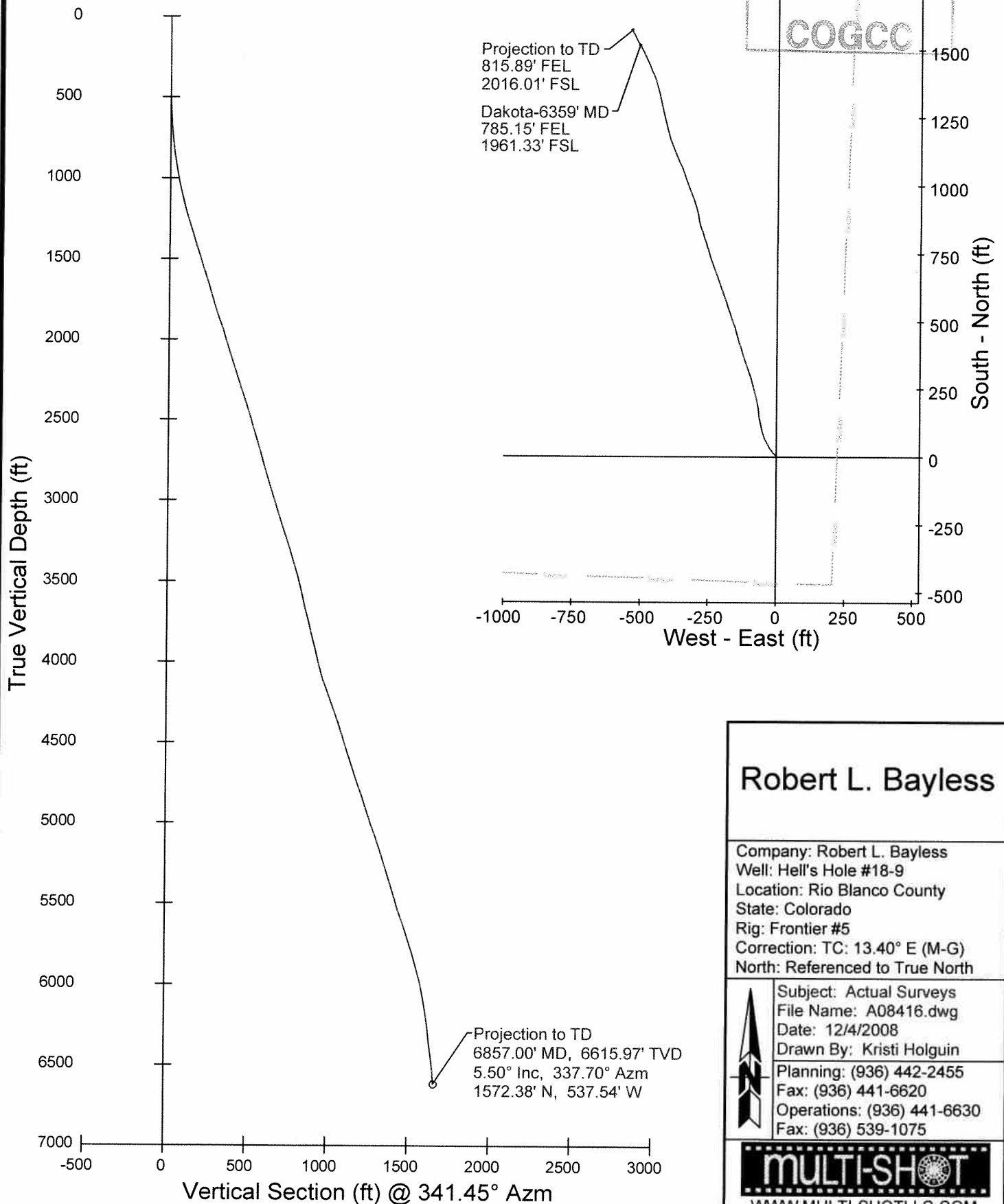

Robert L. Bayless

Company: Robert L. Bayless
Well: Hell's Hole #18-9
Location: Rio Blanco County
State: Colorado
Rig: Frontier #5
Correction: TC: 13.40° E (M-G)
North: Referenced to True North

Subject: Actual Surveys
File Name: A08416.dwg
Date: 12/4/2008
Drawn By: Kristi Holguin
Planning: (936) 442-2455
Fax: (936) 441-6620
Operations: (936) 441-6630
Fax: (936) 539-1075

MULTI-SHOT
WWW.MULTI-SHOTLLC.COM

The customer should only rely on this document after independently verifying all paths, targets, coordinates, lease and hard lines represented. Any decisions made or wells drilled utilizing this or any other information supplied by Multi-Shot, LLC are at the sole risk and responsibility of the customer. Multi-Shot, LLC is not responsible for the accuracy of this schematic or the information contained herein.

RECEIVED

DEC 19 2008



Job Number: P08-416

Company: Robert L. Bayless

Lease/Well: Hell's Hole #18-9

Location: Rio Blanco County

Rig Name: Frontier #5

RKB: 14'

G.L. or M.S.L.: 6570'

State/Country: Colorado

Declination: TC: 13.40° E (M-G)

Grid: Referenced to True North

File name: F:\WELLPL~1\2008\08410\SIP08416\08416.SVY

Date/Time: 03-Dec-08 / 11:53

Curve Name: SDTRK #00

WINSERVE SURVEY CALCULATIONS
 Minimum Curvature Method
 Vertical Section Plane 341.45
 Vertical Section Referenced to Wellhead
 Rectangular Coordinates Referenced to Wellhead

Measured Depth FT	Incl Angle Deg	Drift Direction Deg	True Vertical Depth	N-S FT	E-W FT	Vertical Section FT	C L O S U R E		Dogleg Severity Deg/100
Distance FT	Direction Deg								
.00	.00	.00	.00	.00	.00	.00	.00	.00	.00
482.00	.20	22.10	482.00	.78	.32	.64	.84	22.10	.04
574.00	1.80	334.50	573.98	2.23	-.25	2.19	2.25	353.73	1.82
665.00	4.60	311.30	664.83	5.93	-3.60	6.77	6.94	328.73	3.33
757.00	6.40	321.50	756.41	12.38	-9.57	14.78	15.65	322.30	2.22
849.00	8.10	323.80	847.67	21.62	-16.59	25.78	27.25	322.51	1.87
941.00	9.50	327.30	938.59	33.24	-24.52	39.32	41.31	323.59	1.63
1032.00	12.20	328.90	1027.95	47.80	-33.54	55.99	58.39	324.94	2.99
1129.00	14.20	337.50	1122.39	67.57	-43.39	77.86	80.30	327.29	2.88
1224.00	15.70	343.20	1214.18	90.64	-51.57	102.34	104.29	330.36	2.21
1318.00	16.60	347.50	1304.47	115.93	-58.15	128.41	129.70	333.36	1.59
1413.00	18.50	351.10	1395.05	144.07	-63.42	156.76	157.41	336.24	2.30
1507.00	18.70	351.90	1484.14	173.72	-67.85	186.28	186.50	338.67	.34
1602.00	18.00	349.20	1574.31	203.22	-72.75	215.81	215.85	340.30	1.16
1696.00	16.70	347.40	1664.03	230.67	-78.41	243.63	243.63	341.23	1.50
1791.00	17.70	344.20	1754.78	257.89	-85.32	271.63	271.64	341.69	1.45
1887.00	18.20	343.20	1846.11	286.28	-93.63	301.20	301.20	341.89	.61
1981.00	18.20	341.30	1935.41	314.24	-102.58	330.55	330.56	341.92	.63
2074.00	17.70	340.90	2023.88	341.36	-111.86	359.21	359.22	341.86	.55
2170.00	17.10	340.80	2115.49	368.48	-121.28	387.92	387.92	341.78	.63
2262.00	17.90	342.20	2203.23	394.71	-130.05	415.58	415.58	341.76	.98
2356.00	18.20	342.70	2292.60	422.48	-138.83	444.70	444.71	341.81	.36
2450.00	17.90	343.40	2381.98	450.34	-147.32	473.81	473.83	341.89	.39

RECEIVED

DEC 19 2008

COGCC

Measured Depth FT	Incl Angle Deg	Drift Direction Deg	True Vertical Depth	N-S FT	E-W FT	Vertical Section FT	CLOSURE Distance FT	Direction Deg	Dogleg Severity Deg/100
2545.00	16.90	343.00	2472.63	477.54	-155.53	502.21	502.23	341.96	1.06
2639.00	16.50	340.30	2562.67	503.17	-164.03	529.21	529.23	341.94	.93
2732.00	15.60	341.10	2652.04	527.44	-172.53	554.92	554.94	341.89	1.00
2827.00	16.30	341.10	2743.38	552.13	-180.99	581.03	581.04	341.85	.74
2922.00	16.40	341.10	2834.54	577.44	-189.65	607.77	607.78	341.82	.11
3016.00	17.70	340.10	2924.41	603.43	-198.81	635.33	635.34	341.76	1.42
3111.00	17.30	340.00	3015.01	630.28	-208.56	663.88	663.89	341.69	.42
3207.00	17.50	340.90	3106.62	657.33	-218.16	692.59	692.59	341.64	.35
3302.00	18.50	339.60	3196.97	684.96	-228.09	721.93	721.94	341.58	1.13
3396.00	17.50	340.30	3286.37	712.24	-238.05	750.97	750.97	341.52	1.09
3490.00	15.70	342.70	3376.45	737.69	-246.60	777.82	777.82	341.52	2.05
3583.00	14.70	343.10	3466.19	761.00	-253.77	802.19	802.20	341.56	1.08
3678.00	13.90	339.70	3558.25	783.23	-261.24	825.65	825.65	341.55	1.22
3773.00	14.10	342.00	3650.43	804.94	-268.77	848.63	848.63	341.54	.62
3866.00	13.90	342.40	3740.67	826.36	-275.65	871.12	871.12	341.55	.24
3960.00	13.90	338.50	3831.91	847.63	-283.20	893.69	893.69	341.53	1.00
4053.00	13.00	349.00	3922.38	868.30	-289.29	915.22	915.22	341.57	2.79
4147.00	14.70	351.60	4013.64	890.47	-293.05	937.44	937.46	341.78	1.93
4242.00	19.20	345.60	4104.50	917.55	-298.70	964.90	964.94	341.97	5.08
4336.00	19.30	338.30	4193.26	946.95	-308.29	995.83	995.87	341.97	2.56
4430.00	19.60	338.80	4281.89	976.09	-319.73	1027.09	1027.12	341.86	.37
4524.00	19.10	340.80	4370.58	1005.31	-330.49	1058.22	1058.24	341.80	.88
4619.00	18.10	340.60	4460.62	1033.91	-340.51	1088.52	1088.54	341.77	1.05
4714.00	17.20	337.50	4551.15	1060.81	-350.79	1117.29	1117.30	341.70	1.37
4809.00	18.20	334.60	4641.65	1087.19	-362.52	1146.03	1146.04	341.56	1.40
4904.00	18.10	338.40	4731.93	1114.31	-374.32	1175.50	1175.50	341.43	1.25
4999.00	17.90	337.20	4822.28	1141.49	-385.41	1204.80	1204.80	341.34	.44
5092.00	18.60	341.90	4910.60	1168.76	-395.56	1233.88	1233.89	341.30	1.75
5188.00	18.90	346.00	5001.51	1198.40	-404.08	1264.69	1264.69	341.37	1.41
5278.00	19.50	347.40	5086.51	1227.21	-410.88	1294.16	1294.16	341.49	.84
5372.00	17.70	345.50	5175.59	1256.36	-417.88	1324.02	1324.03	341.60	2.02
5467.00	16.70	346.70	5266.35	1283.62	-424.64	1352.02	1352.04	341.70	1.12
5560.00	17.30	348.40	5355.28	1310.17	-430.49	1379.06	1379.08	341.81	.84
5656.00	17.80	346.60	5446.81	1338.43	-436.76	1407.84	1407.89	341.93	.77
5751.00	17.10	344.50	5537.44	1366.01	-443.86	1436.25	1436.32	342.00	.99
5845.00	19.30	339.50	5626.74	1393.89	-452.99	1465.58	1465.65	342.00	2.87
5940.00	18.00	336.90	5716.75	1422.09	-464.25	1495.90	1495.95	341.92	1.62
6034.00	17.20	336.60	5806.35	1448.21	-475.47	1524.23	1524.26	341.82	.86
6129.00	15.10	333.70	5897.60	1472.20	-486.53	1550.49	1550.51	341.71	2.37
6222.00	13.40	334.20	5987.73	1492.76	-496.59	1573.19	1573.19	341.60	1.83
6316.00	10.40	332.40	6079.70	1510.09	-505.26	1592.37	1592.37	341.50	3.22
6410.00	8.70	329.80	6172.40	1523.75	-512.77	1607.72	1607.72	341.40	1.87

RECEIVED

DEC 19 2008

Measured Depth FT	Incl Angle Deg	Drift Direction Deg	True Vertical Depth	N-S FT	E-W FT	Vertical Section FT	CLOSURE Distance FT	Direction Deg	Dogleg Severity Deg/100
6505.00	7.50	329.60	6266.45	1535.31	-519.52	1620.82	1620.83	341.31	1.26
6600.00	8.10	333.30	6360.57	1546.64	-525.67	1633.52	1633.53	341.23	.82
6695.00	6.50	332.20	6454.80	1557.37	-531.18	1645.45	1645.47	341.17	1.69
6788.00	5.50	341.10	6547.29	1566.25	-535.08	1655.10	1655.13	341.14	1.47
6807.00	5.50	337.70	6566.20	1567.95	-535.72	1656.92	1656.95	341.14	1.71

Projection to TD

6857.00	5.50	337.70	6615.97	1572.38	-537.54	1661.70	1661.73	341.13	.00
---------	------	--------	---------	---------	---------	---------	---------	--------	-----