

PETROLEUM DEVELOPMENT CORP Weld County CO

Well Name: **Wilson 24-30H**

Surface Location: Wilson 24-30H Pad Sec.30-T7N-63W
North American Datum 1983 , US State Plane 1983 , Colorado Northern Zone

Ground Elevation: 4772.0

+N/-S	+E/-W	Northing	Easting	Latitude	Longitude	Slot
0.0	0.0	1440377.93	3282287.89	40° 32' 16.080 N	104° 29' 3.660 W	
RKB (Ensign 32 - 14') WELL @ 4786.0ft (RKB (Ensign 32 - 14'))						

WELLBORE TARGET DETAILS

Name	TVD	+N/-S	+E/-W	Shape
HARDLINE 460'FNL	1.0	4648.7	-313.9	Polygon
HARDLINE 460'FSL	1.0	310.0	-200.0	Polygon
TARGET BHL 500'FNL, 1320'FWL	6786.0	4608.7	-113.9	Point

Wilson 24-30H Pad Sec.30-T7N-63W
Wilson 24-30H
Plan #1 (1-17-11)
16:43, January 21 2011

ANNOTATIONS

TVD	MD	Annotation
6062.3	6062.3	KOP
6826.2	7270.3	End of Build

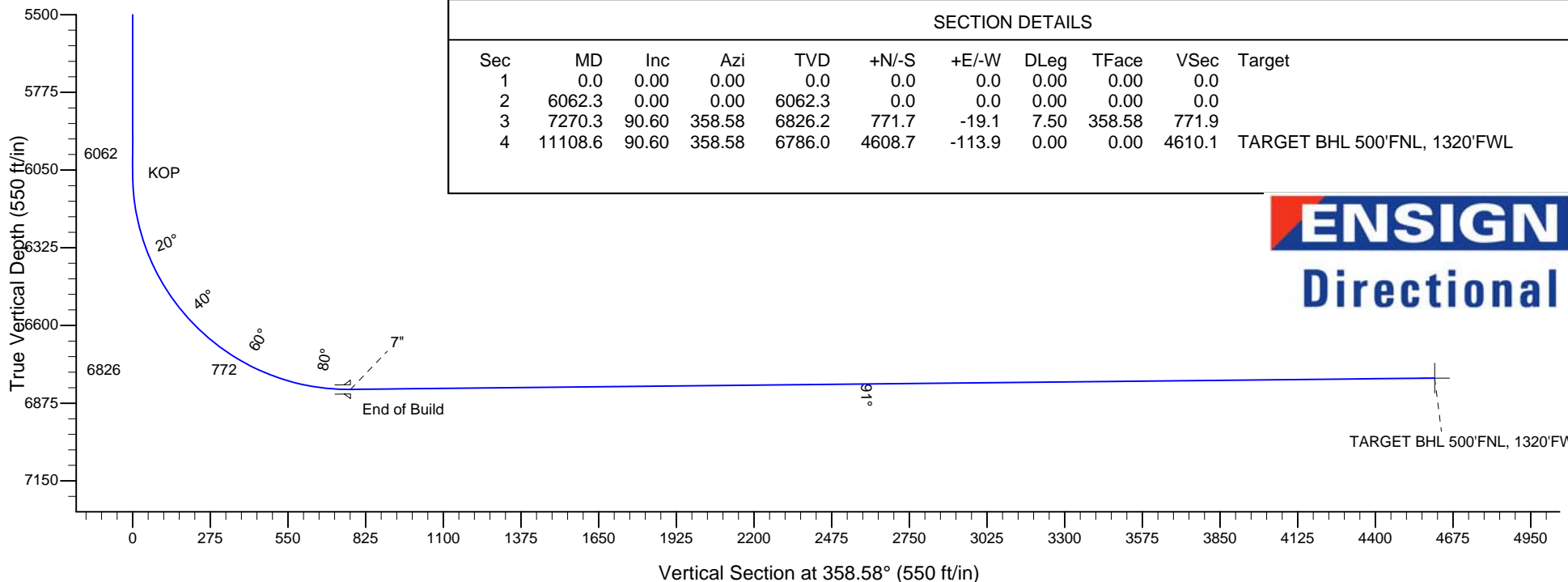
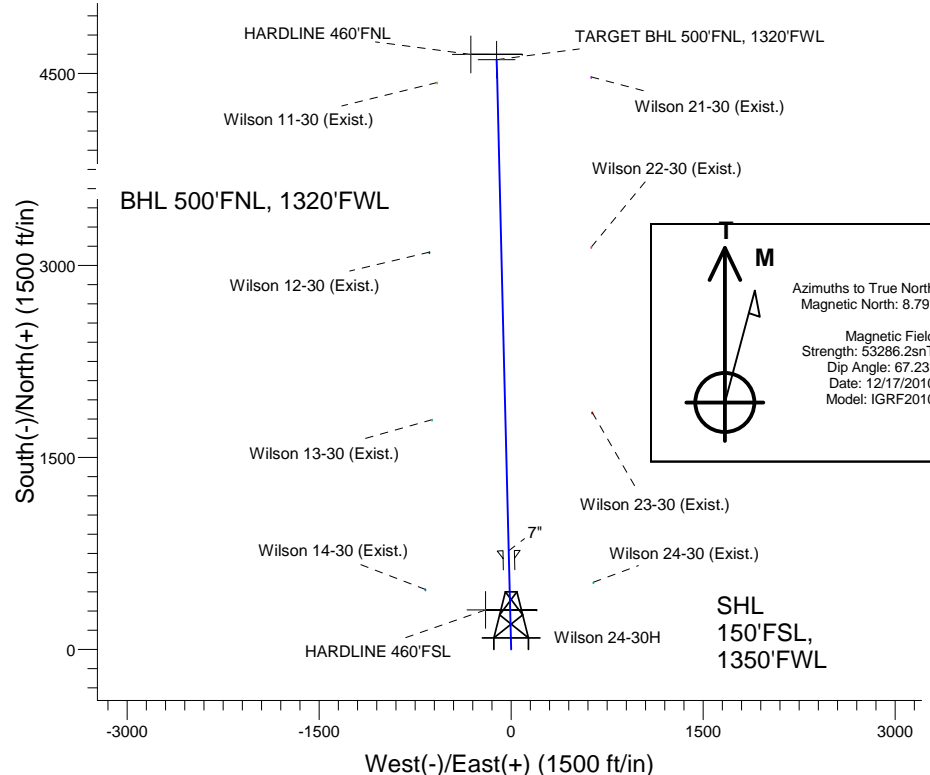

ENSIGN
Directional