

EOG RESOURCES, INC.
CRITTER CREEK #12-08H
SECTION 8, T11N, R63W, 6th P.M.

PROCEED IN A WESTERLY DIRECTION FROM HEREFORD, COLORADO ON COUNTY ROAD 136 APPROXIMATELY 1.5 MILES TO THE JUNCTION OF COUNTY ROAD 136 AND COUNTY ROAD 77 TO THE SOUTH; TURN LEFT AND PROCEED IN A SOUTHERLY DIRECTION APPROXIMATELY 2.0 MILES TO THE JUNCTION OF COUNTY ROAD 77 AND COUNTY ROAD 132 TO THE WEST; TURN RIGHT AND PROCEED IN A WESTERLY DIRECTION APPROXIMATELY 5.0 MILES TO THE JUNCTION OF COUNTY ROAD 132 AND COUNTY ROAD 67 TO THE SOUTH; TURN LEFT AND PROCEED IN A SOUTHERLY DIRECTION APPROXIMATELY 2.0 MILES TO THE JUNCTION COUNTY ROAD 67 AND COUNTY ROAD 128 TO THE WEST; TURN RIGHT AND PROCEED IN A WESTERLY DIRECTION APPROXIMATELY 1.0 MILES TO THE JUNCTION OF THIS ROAD AND AN EXISTING ROAD TO THE NORTH; FOLLOW ROAD FLAGS IN A NORTHERLY DIRECTION APPROXIMATELY 1.1 MILES TO THE BEGINNING OF THE PROPOSED ACCESS TO THE WEST; FOLLOW ROAD FLAGS IN A WESTERLY DIRECTION APPROXIMATELY 285' TO THE PROPOSED LOCATION.

TOTAL DISTANCE FROM HEREFORD, COLORADO TO THE PROPOSED LOCATION IS APPROXIMATELY 12.7 MILES.

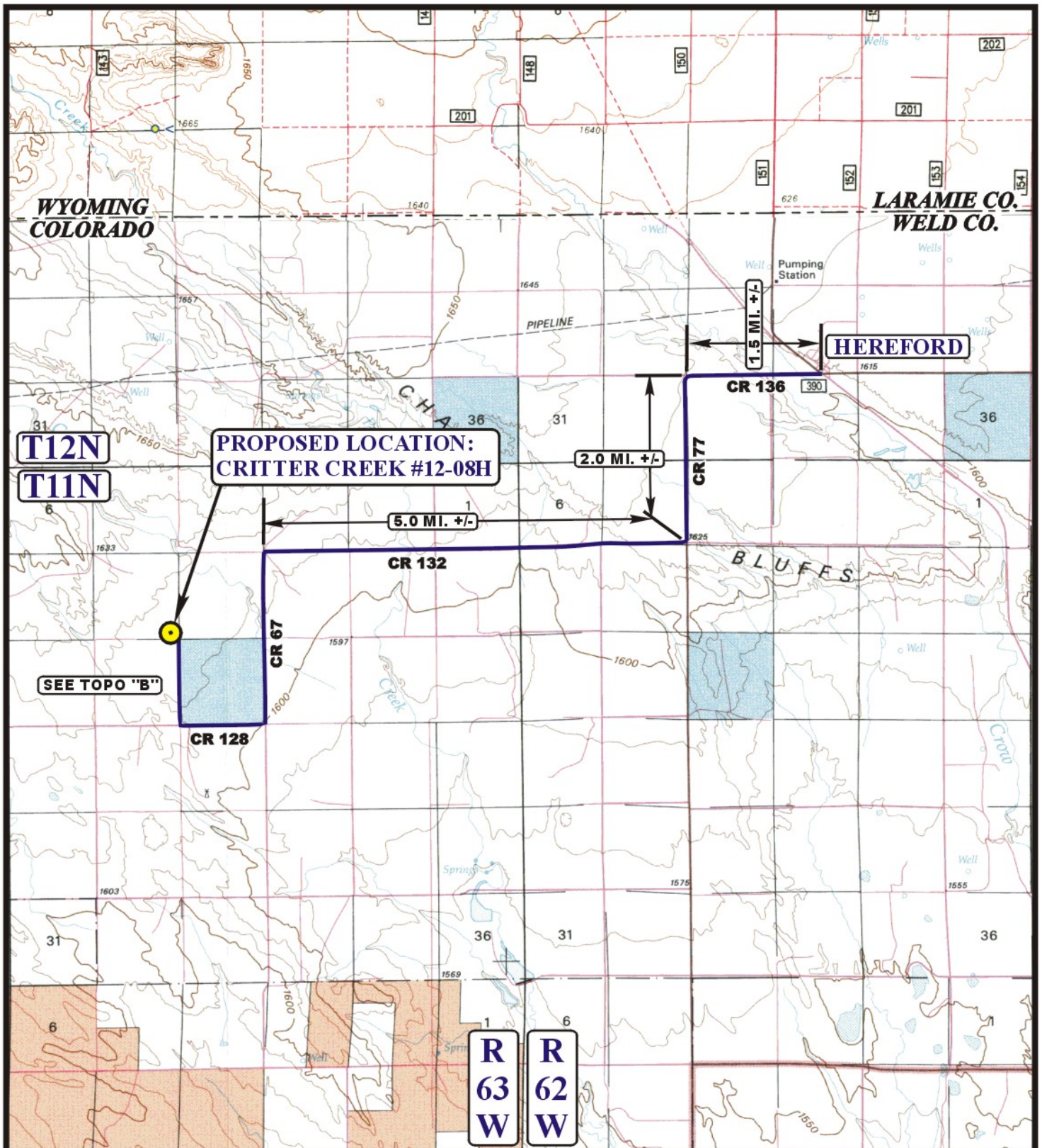

LEGEND:

 PROPOSED LOCATION

EOG RESOURCES, INC.

CRITTER CREEK #12-08H
SECTION 8, T11N, R63W, 6th P.M.
400' FSL 501' FEL



Uintah Engineering & Land Surveying
85 South 200 East Vernal, Utah 84078
(435) 789-1017 * FAX (435) 789-1813



ACCESS ROAD
MAP

02 22 10
MONTH DAY YEAR

SCALE: 1:100,000 **DRAWN BY: Z.L.** **REVISED: 01-24-11**

A
TOPO

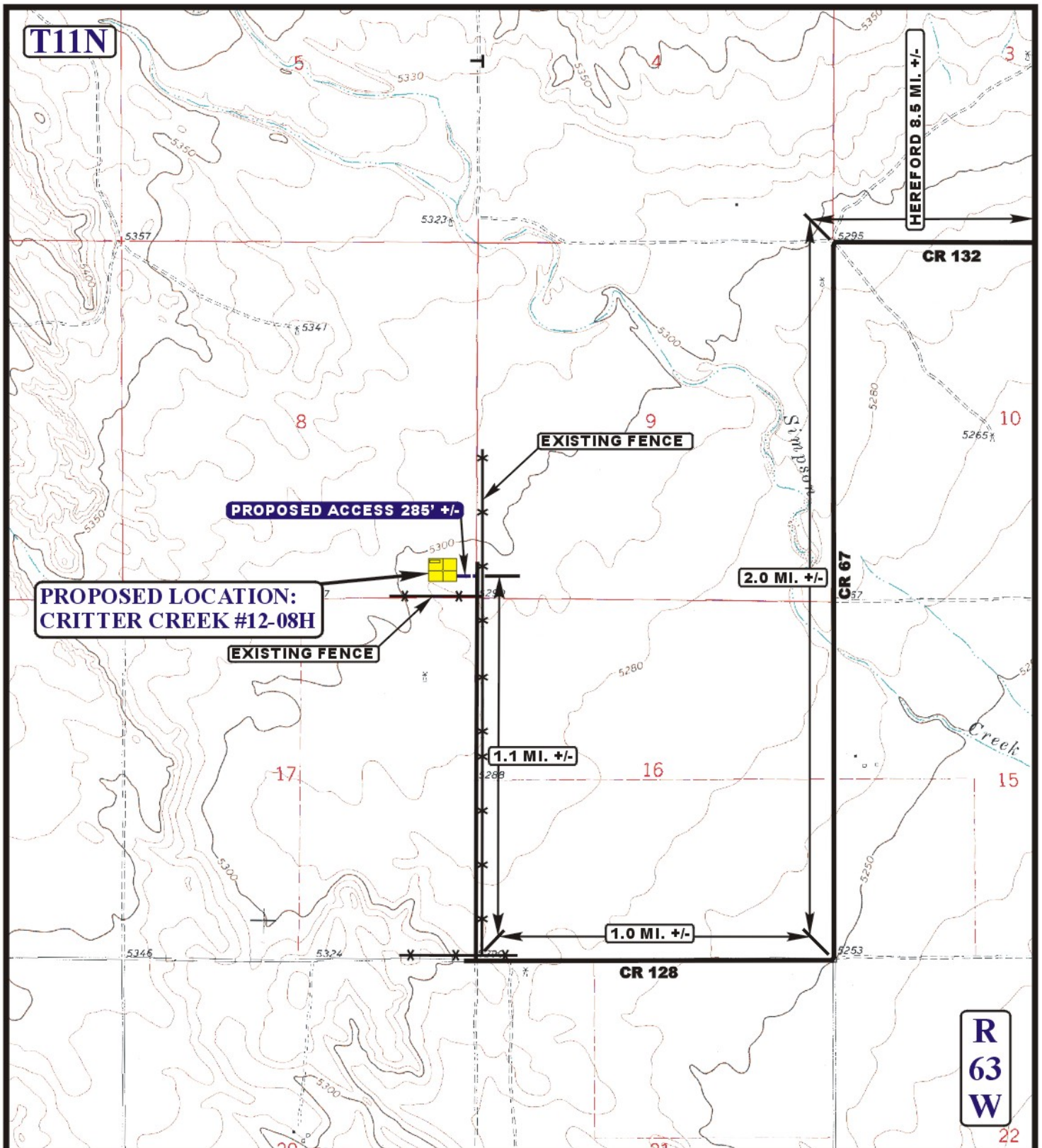

LEGEND:

- EXISTING ROAD
- - - PROPOSED ACCESS ROAD
- * * * * * EXISTING FENCE



EOG RESOURCES, INC.

CRITTER CREEK #12-08H
SECTION 8, T11N, R63W, 6th P.M.
400' FSL 501' FEL



Uintah Engineering & Land Surveying
85 South 200 East Vernal, Utah 84078
(435) 789-1017 * FAX (435) 789-1813

ACCESS ROAD
MAP

02 22 10
MONTH DAY YEAR

SCALE: 1" = 2000' **DRAWN BY: Z.L.** **REVISED: 01-24-11**

B
TOPO