

KERR MCGEE OIL & GAS ONSHORE LP

Location: COLORADO Slot: SLOT#08 WIEDEMAN 6-5 (1179'FNL& 1390'FWL)
 Field: WELD COUNTY (KERR MCGEE) Well: WIEDEMAN 6-5
 Facility: SEC.05-T5N-R66W Wellbore: WIEDEMAN 6-5 PWB

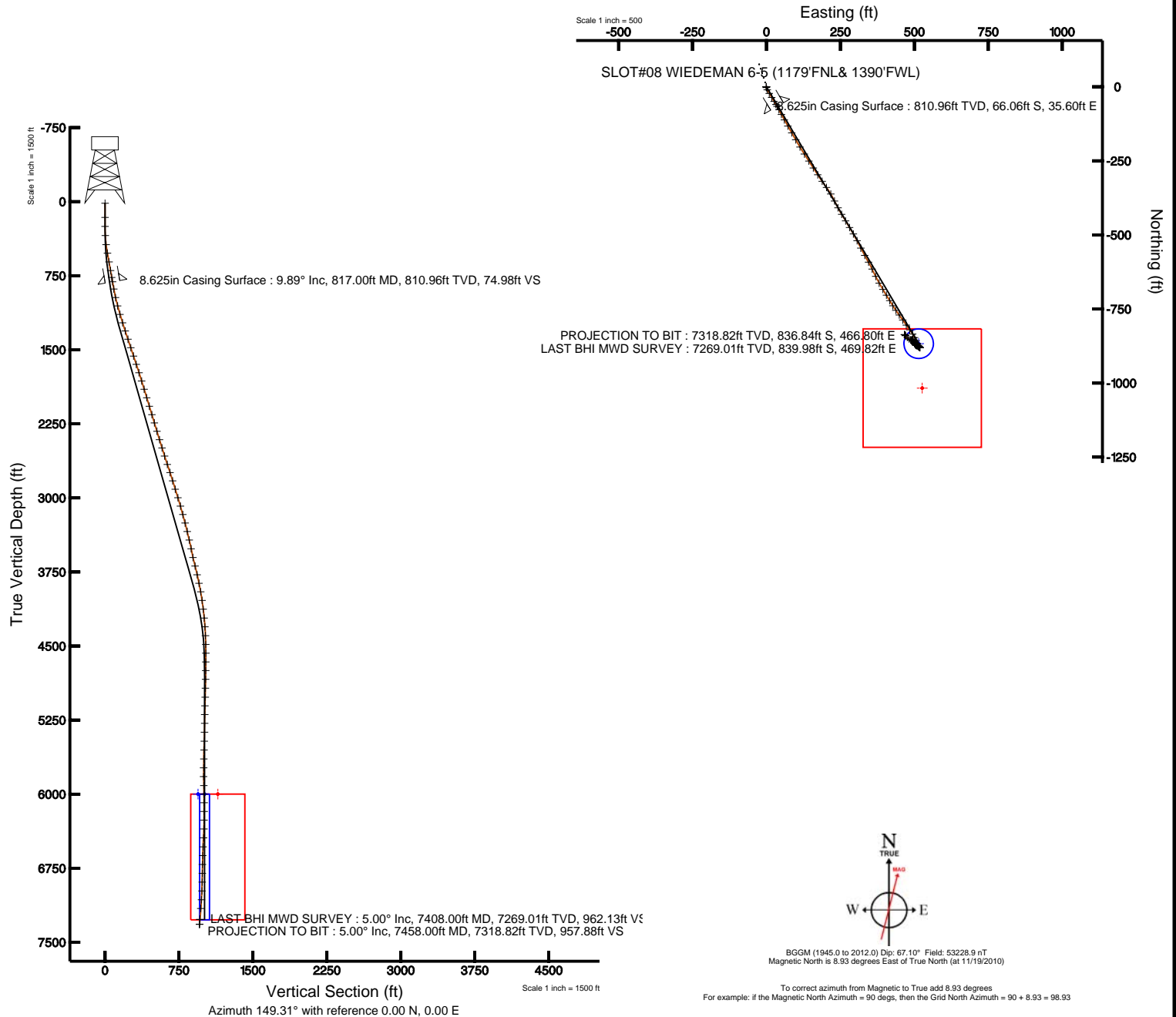

Plot reference wellpath is WIEDEMAN 6-5 (REV-A.0) PWP	
True vertical depths are referenced to XTREME 6 (RKB)	Grid System: NAD83 / Lambert Colorado State Planes, Northern Zone (501), US feet
Measured depths are referenced to XTREME 6 (RKB)	North Reference: True north
XTREME 6 (RKB) to Mean Sea Level: 4769 feet	Scale: True distance
Mean Sea Level to Mud line (Facility: SEC.05-T5N-R66W): 0 feet	Depths are in feet
Coordinates are in feet referenced to Slot	Created by: cookdarn on 1/14/2011





Actual Wellpath Report

WIEDEMAN 6-5 AWP

Page 1 of 5



INTEQ

REFERENCE WELLPATH IDENTIFICATION

Operator	KERR MCGEE OIL & GAS ONSHORE LP	Slot	SLOT#08 WIEDEMAN 6-5 (1179'FNL& 1390'FWL)
Area	COLORADO	Well	WIEDEMAN 6-5
Field	WELD COUNTY (KERR MCGEE)	Wellbore	WIEDEMAN 6-5 AWB
Facility	SEC.05-T5N-R66W		

REPORT SETUP INFORMATION

Projection System	NAD83 / Lambert Colorado State Planes, Northern Zone (501), US feet	Software System	WellArchitect® 2.0
North Reference	True	User	Cookdanm
Scale	0.999962	Report Generated	1/14/2011 at 11:58:53 AM
Convergence at slot	0.45° East	Database/Source file	Denver Server/WIEDEMAN_6-5_AWB.xml

WELLPATH LOCATION

	Local coordinates		Grid coordinates		Geographic coordinates	
	North[ft]	East[ft]	Easting[USft]	Northing[USft]	Latitude	Longitude
Slot Location	-106.74	34.24	3192946.32	1401651.81	40°26'01.918"N	104°48'24.721"W
Facility Reference Pt			3192911.25	1401758.28	40°26'02.972"N	104°48'25.164"W
Field Reference Pt			3197771.84	1268891.29	40°04'09.600"N	104°47'36.000"W

WELLPATH DATUM

Calculation method	Minimum curvature	XTREME 6 (RKB) to Facility Vertical Datum	4769.00ft
Horizontal Reference Pt	Slot	XTREME 6 (RKB) to Mean Sea Level	4769.00ft
Vertical Reference Pt	XTREME 6 (RKB)	Facility Vertical Datum to Mud Line (Facility)	0.00ft
MD Reference Pt	XTREME 6 (RKB)	Section Origin	N 0.00, E 0.00 ft
Field Vertical Reference	Mean Sea Level	Section Azimuth	149.31°



Actual Wellpath Report

WIEDEMAN 6-5 AWP

Page 2 of 5



INTEQ

REFERENCE WELLPATH IDENTIFICATION

Operator	KERR MCGEE OIL & GAS ONSHORE LP	Slot	SLOT#08 WIEDEMAN 6-5 (1179'FNL& 1390'FWL)
Area	COLORADO	Well	WIEDEMAN 6-5
Field	WELD COUNTY (KERR MCGEE)	Wellbore	WIEDEMAN 6-5 AWB
Facility	SEC.05-T5N-R66W		

WELLPATH DATA (85 stations) † = interpolated/extrapolated station

MD [ft]	Inclination [°]	Azimuth [°]	TVD [ft]	Vert Sect [ft]	North [ft]	East [ft]	DLS [°/100ft]	Comments
0.00†	0.000	310.600	0.00	0.00	0.00	0.00	0.00	
16.00	0.000	310.600	16.00	0.00	0.00	0.00	0.00	
159.00	0.500	310.600	159.00	-0.59	0.41	-0.47	0.35	
250.00	0.800	187.200	250.00	-0.47	0.03	-0.85	1.27	
343.00	2.600	171.000	342.95	2.01	-2.69	-0.61	1.98	
435.00	7.400	151.700	434.58	9.87	-9.98	2.53	5.46	
523.00	10.600	149.600	521.48	23.63	-21.95	9.32	3.65	
613.00	10.200	149.200	610.01	39.88	-35.93	17.58	0.45	
702.00	9.900	148.500	697.64	55.41	-49.23	25.62	0.36	
772.00	9.700	149.600	766.62	67.32	-59.44	31.75	0.39	
891.00	10.200	150.300	883.83	87.88	-77.24	42.04	0.43	
980.00	13.100	153.400	970.99	105.82	-93.11	50.46	3.33	
1067.00	14.700	150.600	1055.44	126.70	-111.54	60.30	1.99	
1156.00	16.700	149.900	1141.11	150.77	-132.45	72.25	2.26	
1245.00	17.800	150.300	1226.11	177.16	-155.33	85.41	1.24	
1332.00	18.500	149.900	1308.78	204.26	-178.82	98.92	0.82	
1421.00	18.500	148.900	1393.18	232.50	-203.13	113.29	0.36	
1511.00	18.000	147.500	1478.65	260.68	-227.08	128.14	0.74	
1600.00	18.500	147.100	1563.18	288.53	-250.53	143.20	0.58	
1689.00	17.900	147.500	1647.72	316.31	-273.93	158.22	0.69	
1778.00	18.200	146.200	1732.34	343.86	-297.01	173.30	0.56	
1866.00	17.100	145.000	1816.20	370.49	-319.03	188.36	1.32	
1953.00	16.800	144.300	1899.42	395.77	-339.72	203.04	0.42	
2043.00	17.500	149.900	1985.42	422.26	-361.99	217.41	1.99	
2133.00	17.000	153.400	2071.38	448.91	-385.46	230.09	1.28	
2222.00	16.800	152.400	2156.53	474.73	-408.49	241.88	0.40	
2309.00	17.000	148.900	2239.78	500.00	-430.53	254.27	1.19	
2398.00	16.900	148.900	2324.91	525.95	-452.74	267.67	0.11	
2487.00	17.100	149.900	2410.02	551.97	-475.14	280.92	0.40	
2574.00	16.700	148.500	2493.27	577.26	-496.86	293.86	0.66	
2661.00	18.000	153.400	2576.31	603.17	-519.54	306.42	2.25	
2750.00	18.900	153.100	2660.74	631.27	-544.70	319.09	1.02	
2837.00	18.400	150.600	2743.17	659.06	-569.22	332.21	1.08	
2925.00	16.300	149.900	2827.16	685.29	-592.01	345.22	2.40	
3014.00	18.000	154.800	2912.20	711.47	-615.26	357.34	2.51	
3104.00	17.600	153.800	2997.90	738.88	-640.05	369.27	0.56	
3193.00	16.200	151.000	3083.05	764.71	-662.99	381.23	1.82	
3282.00	15.600	148.200	3168.65	789.08	-684.02	393.56	1.09	
3371.00	14.200	148.200	3254.65	811.96	-703.46	405.62	1.57	
3459.00	14.100	148.900	3339.98	833.47	-721.82	416.84	0.23	
3548.00	12.500	148.900	3426.59	853.95	-739.35	427.42	1.80	
3638.00	11.300	144.600	3514.66	872.47	-754.88	437.56	1.66	
3729.00	13.200	143.200	3603.58	891.69	-770.46	448.94	2.11	
3818.00	13.800	146.400	3690.12	912.40	-787.44	460.91	1.08	
3909.00	13.200	144.300	3778.61	933.59	-804.92	472.98	0.85	



Actual Wellpath Report

WIEDEMAN 6-5 AWP

Page 3 of 5



INTEQ

REFERENCE WELLPATH IDENTIFICATION

Operator	KERR MCGEE OIL & GAS ONSHORE LP	Slot	SLOT#08 WIEDEMAN 6-5 (1179'FNL& 1390'FWL)
Area	COLORADO	Well	WIEDEMAN 6-5
Field	WELD COUNTY (KERR MCGEE)	Wellbore	WIEDEMAN 6-5 AWB
Facility	SEC.05-T5N-R66W		

WELLPATH DATA (85 stations)

MD [ft]	Inclination [°]	Azimuth [°]	TVD [ft]	Vert Sect [ft]	North [ft]	East [ft]	DLS [°/100ft]	Comments
3997.00	12.600	142.900	3864.39	953.13	-820.73	484.63	0.77	
4085.00	9.900	149.200	3950.69	970.24	-834.89	494.29	3.37	
4174.00	8.000	152.400	4038.61	984.08	-846.95	501.08	2.21	
4263.00	6.900	156.200	4126.85	995.57	-857.33	506.11	1.35	
4353.00	5.900	148.500	4216.29	1005.56	-866.22	510.71	1.46	
4443.00	3.700	150.300	4305.97	1013.09	-872.69	514.56	2.45	
4532.00	2.900	149.200	4394.82	1018.22	-877.12	517.14	0.90	
4621.00	1.400	156.200	4483.76	1021.55	-880.05	518.73	1.71	
4710.00	0.300	353.800	4572.75	1022.41	-880.81	519.14	1.90	
4799.00	0.500	300.400	4661.75	1021.86	-880.38	518.78	0.45	
4886.00	0.800	294.100	4748.74	1021.03	-879.94	517.90	0.35	
4975.00	1.100	304.900	4837.73	1019.75	-879.20	516.63	0.39	
5065.00	1.200	310.600	4927.71	1018.07	-878.09	515.21	0.17	
5156.00	1.900	309.200	5018.68	1015.75	-876.52	513.32	0.77	
5243.00	1.900	309.500	5105.63	1013.04	-874.69	511.09	0.01	
5332.00	1.200	279.300	5194.60	1011.05	-873.60	509.03	1.18	
5421.00	1.200	262.400	5283.58	1010.09	-873.57	507.19	0.40	
5511.00	1.400	306.000	5373.56	1008.71	-873.05	505.36	1.09	
5602.00	1.400	330.300	5464.53	1006.57	-871.43	503.91	0.65	
5690.00	1.600	352.400	5552.50	1004.37	-869.28	503.22	0.69	
5781.00	1.700	334.800	5643.47	1001.86	-866.80	502.47	0.57	
5871.00	1.100	305.700	5733.44	999.74	-865.09	501.20	1.01	
5960.00	0.600	167.800	5822.44	999.40	-865.05	500.61	1.79	
6051.00	2.000	143.600	5913.41	1001.43	-866.79	501.65	1.62	
6138.00	1.000	144.600	6000.38	1003.70	-868.63	502.99	1.15	
6225.00	0.100	85.600	6087.38	1004.49	-869.24	503.51	1.09	
6314.00	0.200	96.500	6176.38	1004.61	-869.26	503.74	0.12	
6401.00	0.700	306.700	6263.37	1004.22	-868.96	503.46	1.01	
6491.00	1.800	320.800	6353.35	1002.31	-867.53	502.13	1.26	
6581.00	2.600	318.300	6443.28	998.91	-864.91	499.88	0.90	
6672.00	3.200	317.600	6534.17	994.39	-861.49	496.79	0.66	
6761.00	2.500	344.300	6623.06	990.09	-857.79	494.59	1.66	
6851.00	1.000	346.800	6713.02	987.44	-855.14	493.88	1.67	
6941.00	1.000	248.000	6803.01	986.57	-854.67	492.97	1.69	
7029.00	1.900	272.300	6890.98	985.66	-854.90	490.80	1.22	
7119.00	2.800	291.900	6980.90	983.11	-854.02	487.27	1.33	
7208.00	5.200	304.600	7069.68	977.71	-850.91	481.94	2.86	
7297.00	4.300	313.400	7158.38	970.84	-846.33	476.19	1.30	
7408.00	5.000	316.200	7269.01	962.13	-839.98	469.82	0.66	LAST BHI MWD SURVEY
7458.00	5.000	316.200	7318.82	957.88	-836.84	466.80	0.00	PROJECTION TO BIT



Actual Wellpath Report

WIEDEMAN 6-5 AWP

Page 4 of 5



INTEQ

REFERENCE WELLPATH IDENTIFICATION			
Operator	KERR MCGEE OIL & GAS ONSHORE LP	Slot	SLOT#08 WIEDEMAN 6-5 (1179'FNL& 1390'FWL)
Area	COLORADO	Well	WIEDEMAN 6-5
Field	WELD COUNTY (KERR MCGEE)	Wellbore	WIEDEMAN 6-5 AWB
Facility	SEC.05-T5N-R66W		

HOLE & CASING SECTIONS Ref Wellbore: WIEDEMAN 6-5 AWB Ref Wellpath: WIEDEMAN 6-5 AWP									
String/Diameter	Start MD [ft]	End MD [ft]	Interval [ft]	Start TVD [ft]	End TVD [ft]	Start N/S [ft]	Start E/W [ft]	End N/S [ft]	End E/W [ft]
12.25in Open Hole	16.00	827.00	811.00	16.00	820.81	0.00	0.00	-67.54	36.47
8.625in Casing Surface	16.00	817.00	801.00	16.00	810.96	0.00	0.00	-66.06	35.60
7.875in Open Hole	817.00	7458.00	6641.00	810.96	7318.82	-66.06	35.60	-836.84	466.80

TARGETS									
Name	MD [ft]	TVD [ft]	North [ft]	East [ft]	Grid East [srv ft]	Grid North [srv ft]	Latitude	Longitude	Shape
WIEDEMAN 18-5 PAD QUARTER SECTION LINES		1.00	106.74	-34.24	3192911.25	1401758.28	40°26'02.972"N	104°48'25.164"W	polygon
WIEDEMAN 18-5 PAD SECTION LINES		1.00	106.74	-34.24	3192911.25	1401758.28	40°26'02.972"N	104°48'25.164"W	polygon
WIEDEMAN 6-5 BHL ON PLAT (1980'FNL & 1980'FWL, REV-1)		6000.00	-791.28	514.75	3193467.21	1400864.60	40°25'54.098"N	104°48'18.065"W	point
WIEDEMAN 6-5 GEO TARGET 50' RADIUS (2056'FNL & 1980'FWL, REV-2)		6000.00	-867.28	514.75	3193467.81	1400788.61	40°25'53.347"N	104°48'18.065"W	circle
WIEDEMAN 6-5 LEGAL BOX (50'N,350'S,188'W,212'E OF GEO TARGET)		6000.00	-1017.28	526.75	3193480.98	1400638.72	40°25'51.865"N	104°48'17.910"W	square

WELLPATH COMPOSITION Ref Wellbore: WIEDEMAN 6-5 AWB Ref Wellpath: WIEDEMAN 6-5 AWP				
Start MD [ft]	End MD [ft]	Positional Uncertainty Model	Log Name/Comment	Wellbore
16.00	772.00	NaviTrak (Standard)	BHI MWD SURVEYS 12.25 HOLE <159-772>	WIEDEMAN 6-5 AWB
772.00	7408.00	NaviTrak (Standard)	BHI MWD SURVEYS 7.875 HOLE <891-7408>	WIEDEMAN 6-5 AWB
7408.00	7458.00	Blind Drilling (std)	Projection to bit	WIEDEMAN 6-5 AWB



Actual Wellpath Report

WIEDEMAN 6-5 AWP

Page 5 of 5



INTEQ

REFERENCE WELLPATH IDENTIFICATION

Operator	KERR MCGEE OIL & GAS ONSHORE LP	Slot	SLOT#08 WIEDEMAN 6-5 (1179'FNL& 1390'FWL)
Area	COLORADO	Well	WIEDEMAN 6-5
Field	WELD COUNTY (KERR MCGEE)	Wellbore	WIEDEMAN 6-5 AWB
Facility	SEC.05-T5N-R66W		

WELLPATH COMMENTS

MD [ft]	Inclination [°]	Azimuth [°]	TVD [ft]	Comment
7408.00	5.000	316.200	7269.01	LAST BHI MWD SURVEY
7458.00	5.000	316.200	7318.82	PROJECTION TO BIT