

Wilson 34-34H  
SE/4 Sec. 34, T7N-R63W

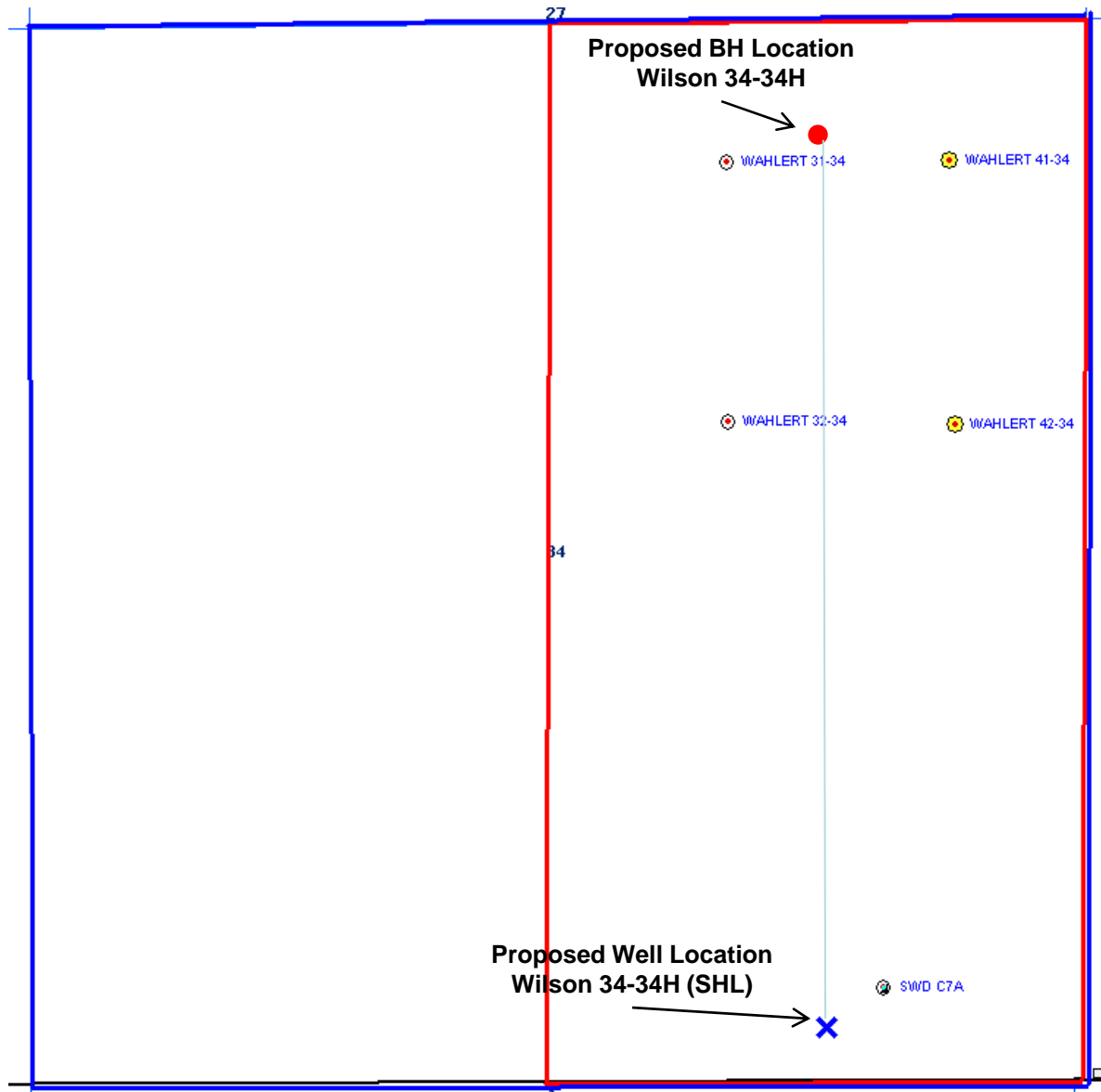

Legend



Proposed 320 acre Spacing Unit, E2 of Sec 34



Sec. 34, T7N, R63W

The SE $\frac{1}{4}$  and NE  $\frac{1}{4}$  of Section 34 will have no more than 8 bottom-hole wells in each 160 acre governmental unit producing from the Niobrara-Codell formation.