

LEGEND:

PROPOSED LOCATION



Uintah Engineering & Land Surveying
85 South 200 East Vernal, Utah 84078
(435) 789-1017 * FAX (435) 789-1813



WEXPRO COMPANY

**POWDERWASH GOVERNMENT #5 & #10
& B.W. MUSSER #43 & #44
SECTION 8, T11N, R97W, 6th P.M.
NE 1/4 SE 1/4**

**TOPOGRAPHIC
MAP**

08 18 10
MONTH DAY YEAR

SCALE: 1" = 2000'

DRAWN BY: J.J.

REVISED: 00-00-00

**A
TOPO**

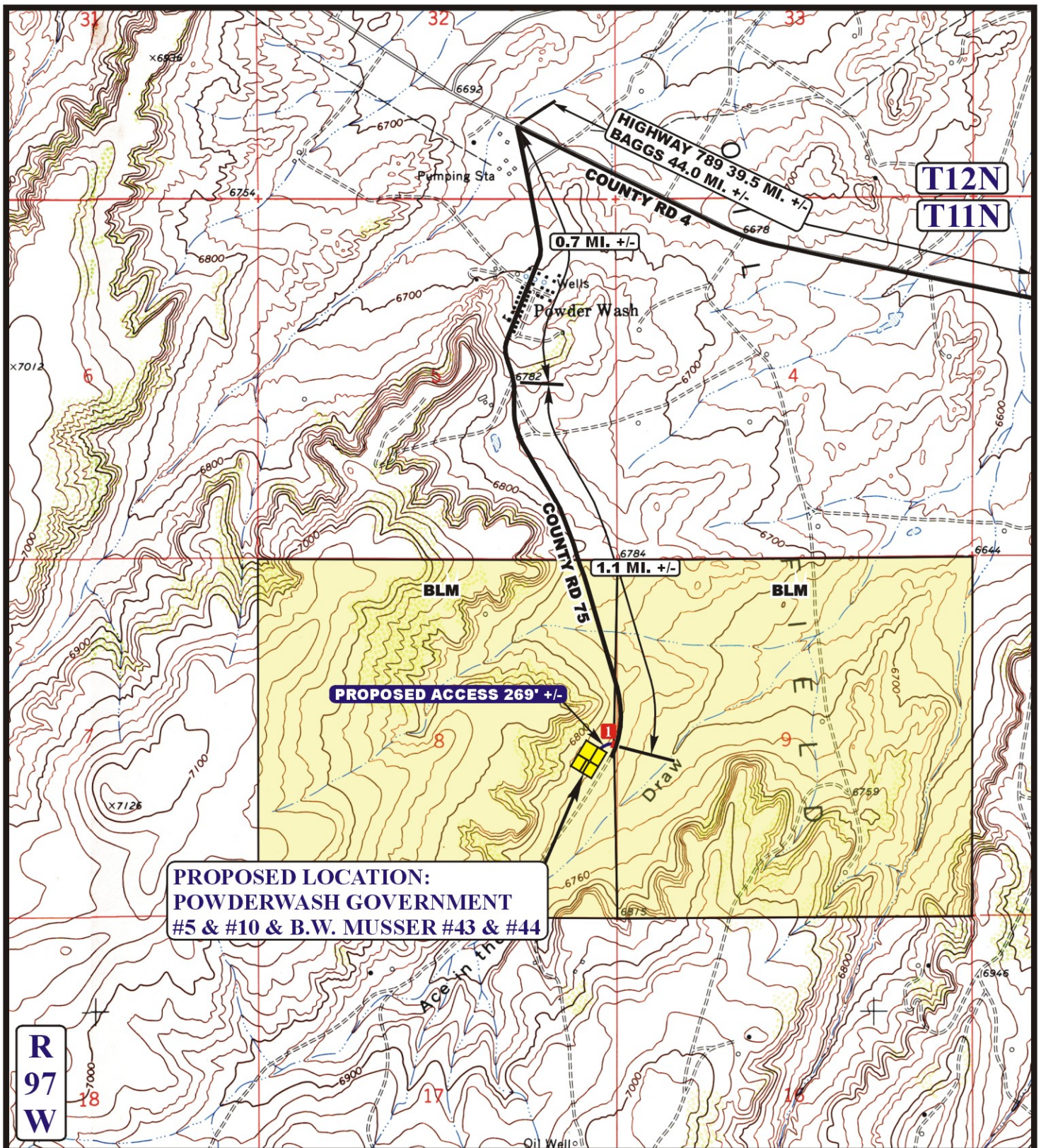

**PROPOSED LOCATION:
POWDERWASH GOVERNMENT
#5 & #10 & B.W. MUSSER #43 & #44**

**R
97
W**

LEGEND:

- EXISTING ROAD
- PROPOSED ACCESS ROAD
- 18" CMP REQUIRED



Utah Engineering & Land Surveying
85 South 200 East Vernal, Utah 84078
(435) 789-1017 * FAX (435) 789-1813



WEXPRO COMPANY

**POWDERWASH GOVERNMENT #5 & #10
& B.W. MUSSER #43 & #44
SECTION 8, T11N, R97W, 6th P.M.
NE 1/4 SE 1/4**

**TOPOGRAPHIC
MAP**

05 21 10
MONTH DAY YEAR



SCALE: 1" = 2000' DRAWN BY: Z.L. REV: 08-18-10 J.J.