

**EOG RESOURCES, INC.**  
**CHAULK BLUFFS #02-19H**  
LOCATED IN WELD COUNTY, COLORADO  
SECTION 19, T11N, R65W, 6th P.M.

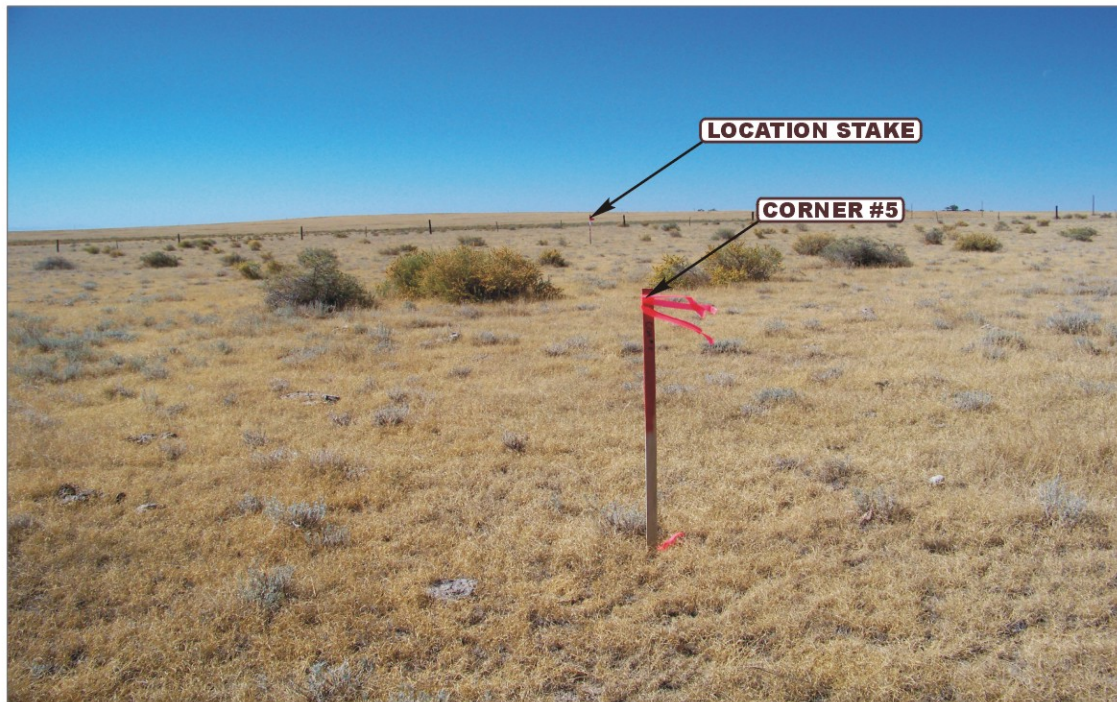

PHOTO: VIEW FROM CORNER #5 TO LOCATION STAKE

CAMERA ANGLE: WESTERLY



PHOTO: VIEW FROM BEGINNING OF PROPOSED ACCESS

CAMERA ANGLE: SOUTHERLY



- Since 1964 -

**UELS**

Uintah Engineering & Land Surveying  
85 South 200 East Vernal, Utah 84078  
(435) 789-1017 \* FAX (435) 789-1813

**LOCATION PHOTOS**

**11** **09** **10**  
MONTH DAY YEAR

TAKEN BY: R.P.

DRAWN BY: J.J.

REVISED: 00-00-00

PHOTO  
**P1**



**EOG RESOURCES, INC.**  
**CHAULK BLUFFS #02-19H**  
LOCATED IN WELD COUNTY, COLORADO  
SECTION 19, T11N, R65W, 6th P.M.



PHOTO: VIEW OF LOCATION STAKE

CAMERA ANGLE: NORTHERLY



PHOTO: VIEW OF LOCATION STAKE

CAMERA ANGLE: EASTERLY



- Since 1964 -

**U E L S** Uintah Engineering & Land Surveying  
85 South 200 East Vernal, Utah 84078  
(435) 789-1017 \* FAX (435) 789-1813

**LOCATION PHOTOS**

**11** **09** **10**  
MONTH DAY YEAR

TAKEN BY: R.P.

DRAWN BY: J.J.

REVISED: 00-00-00

PHOTO

**P2**



**EOG RESOURCES, INC.**  
**CHAULK BLUFFS #02-19H**  
LOCATED IN WELD COUNTY, COLORADO  
SECTION 19, T11N, R65W, 6th P.M.



PHOTO: VIEW OF LOCATION STAKE

CAMERA ANGLE: SOUTHERLY



PHOTO: VIEW OF LOCATION STAKE

CAMERA ANGLE: WESTERLY



**UELS** Uintah Engineering & Land Surveying  
85 South 200 East Vernal, Utah 84078  
(435) 789-1017 \* FAX (435) 789-1813

LOCATION PHOTOS

11 09 10  
MONTH DAY YEAR

TAKEN BY: R.P.

DRAWN BY: J.J.

REVISED: 00-00-00

PHOTO  
**P3**