

EOG RESOURCES, INC.
TREE CREEK #10-22H
SECTION 22, T10N, R65W, 6th P.M.

PROCEED IN A SOUTHERLY DIRECTION FROM CHEYENNE, WYOMING ALONG HIGHWAY 85 APPROXIMATELY 23.5 MILES TO THE JUNCTION OF THIS ROAD AND CR 114 TO THE EAST; TURN LEFT AND PROCEED IN AN EASTERLY DIRECTION APPROXIMATELY 8.0 MILES TO THE JUNCTION OF THIS ROAD AND CR 45 TO THE NORTH; TURN LEFT AND PROCEED IN A NORTHERLY DIRECTION APPROXIMATELY 1.0 MILES TO THE BEGINNING OF THE PROPOSED ACCESS ROAD TO THE WEST; FOLLOW ROAD FLAGS IN A WESTERLY DIRECTION APPROXIMATELY 2,527' TO THE PROPOSED LOCATION.

TOTAL DISTANCE FROM CHEYENNE, WYOMING TO THE PROPOSED LOCATION IS APPROXIMATELY 33.0 MILES.

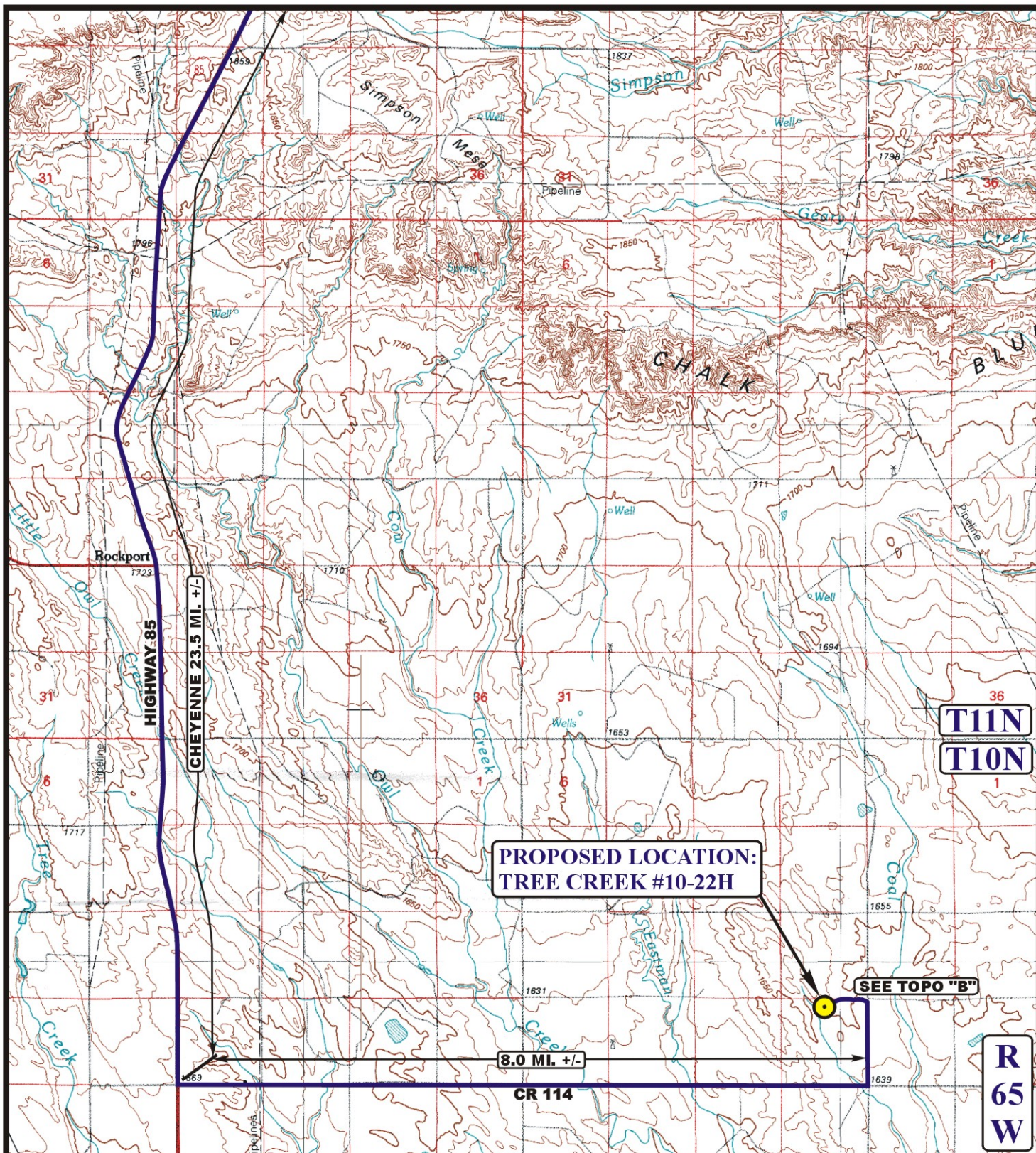

LEGEND:

PROPOSED LOCATION

EOG RESOURCES, INC.

TREE CREEK #10-22H
SECTION 22, T10N, R65W, 6th P.M.
501' FNL 2640' FEL



Uintah Engineering & Land Surveying
85 South 200 East Vernal, Utah 84078
(435) 789-1017 * FAX (435) 789-1813



ACCESS ROAD
MAP

10 22 10
MONTH DAY YEAR

SCALE: 1:100,000 **DRAWN BY: J.J.** **REVISED: 00-00-00**

A
TOPO

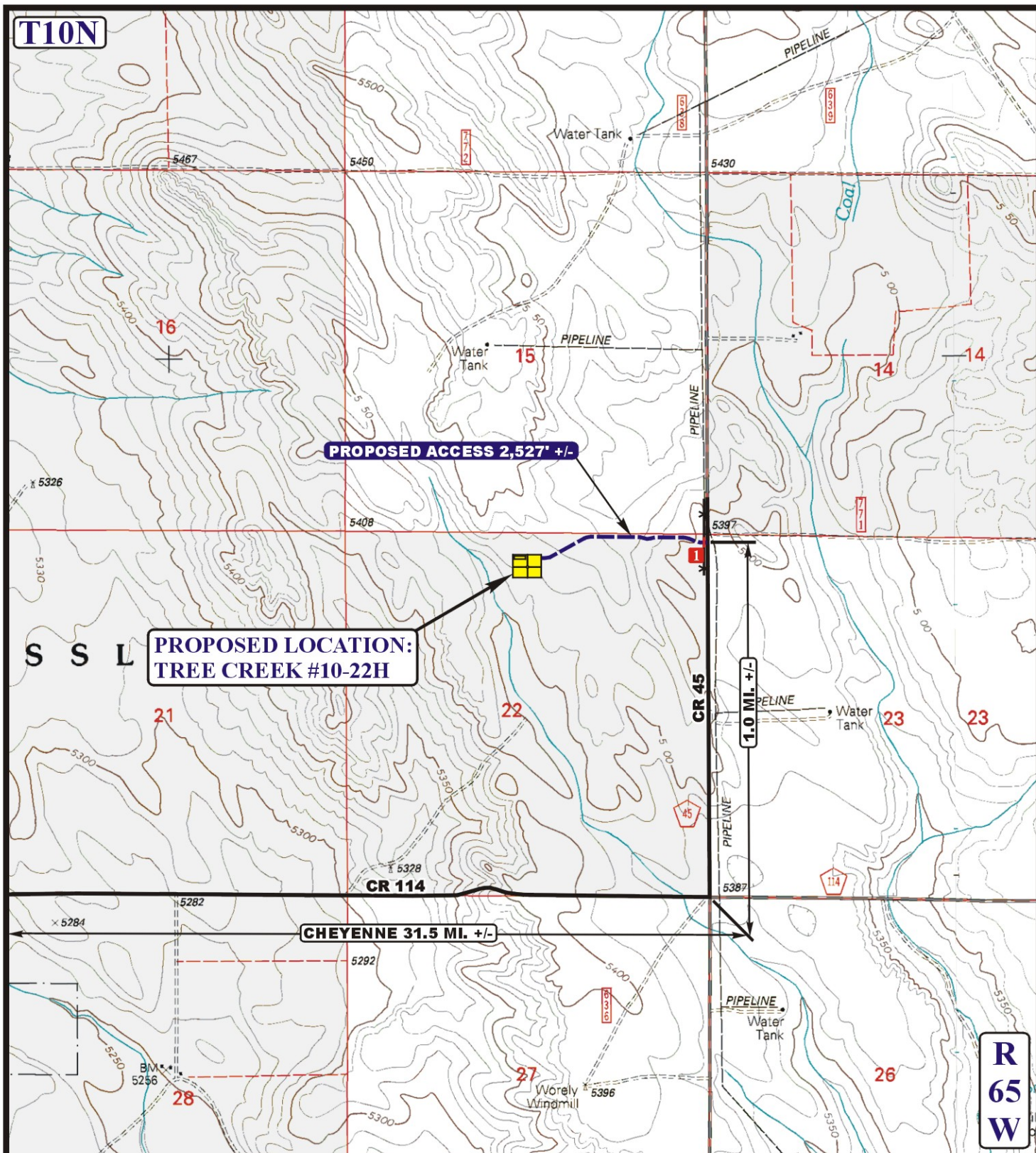

LEGEND:

- EXISTING ROAD
- PROPOSED ACCESS ROAD
- EXISTING FENCE
- INSTALL CATTLEGUARD



Utah Engineering & Land Surveying
 85 South 200 East Vernal, Utah 84078
 (435) 789-1017 * FAX (435) 789-1813



EOG RESOURCES, INC.

TREE CREEK #10-22H
SECTION 22, T10N, R65W, 6th P.M.
501' FNL 2640' FEL

ACCESS ROAD
MAP

10 22 10
 MONTH DAY YEAR

SCALE: 1" = 2000' DRAWN BY: J.J. REVISED: 00-00-00

B
TOPO