

**EOG RESOURCES, INC.**  
**EASTMAN CREEK #03-29H**  
LOCATED IN WELD COUNTY, COLORADO  
SECTION 29, T11N, R66W, 6th P.M.

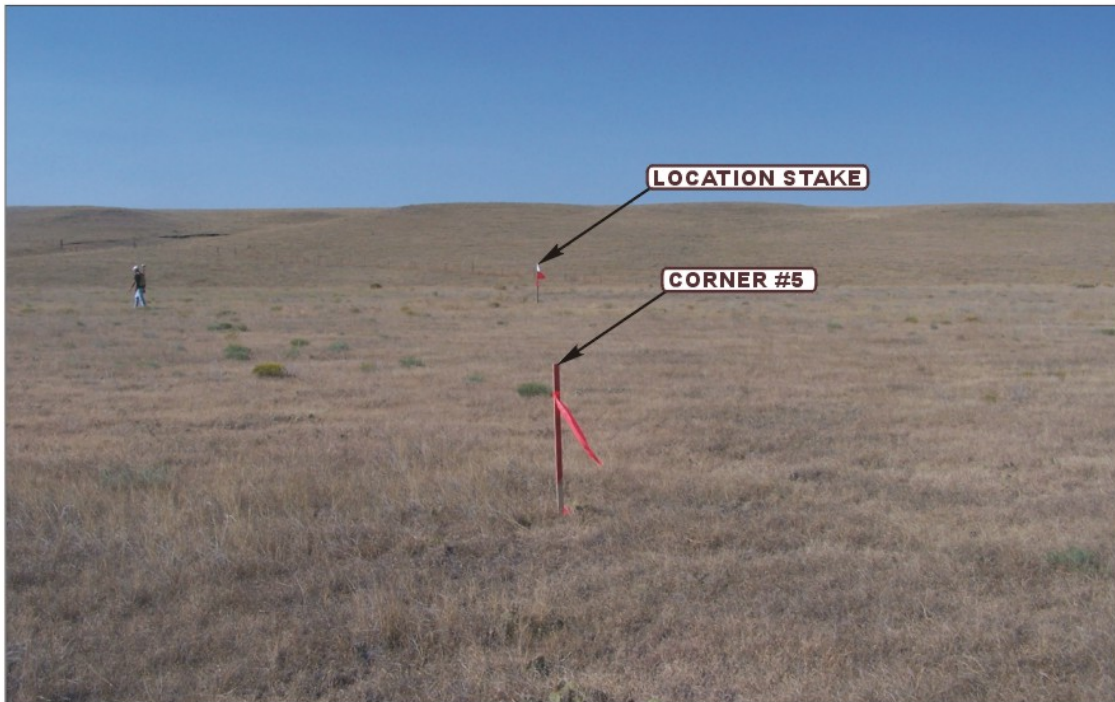

PHOTO: VIEW FROM CORNER #5 TO LOCATION STAKE

CAMERA ANGLE: SOUTHWESTERLY



PHOTO: VIEW FROM BEGINNING OF PROPOSED ACCESS

CAMERA ANGLE: SOUTHERLY



**UELS** Uintah Engineering & Land Surveying  
85 South 200 East Vernal, Utah 84078  
(435) 789-1017 \* FAX (435) 789-1813

**LOCATION PHOTOS**

**10** **12** **10**  
MONTH DAY YEAR

TAKEN BY: T.A.

DRAWN BY: Z.L.

REVISED: 00-00-00

PHOTO  
**P 1**

**EOG RESOURCES, INC.**  
**EASTMAN CREEK #03-29H**  
LOCATED IN WELD COUNTY, COLORADO  
SECTION 29, T11N, R66W, 6th P.M.



PHOTO: VIEW OF LOCATION STAKE

CAMERA ANGLE: NORTHERLY



PHOTO: VIEW OF LOCATION STAKE

CAMERA ANGLE: EASTERLY



Uintah Engineering & Land Surveying  
85 South 200 East Vernal, Utah 84078  
435-789-1017 FAX (435) 789-1813

LOCATION PHOTOS

10 12 10  
MONTH DAY YEAR

PHOTO  
P 2

TAKEN BY: T.A.

DRAWN BY: Z.L.

REVISED: 00-00-00



**EOG RESOURCES, INC.**  
**EASTMAN CREEK #03-29H**  
LOCATED IN WELD COUNTY, COLORADO  
SECTION 29, T11N, R66W, 6th P.M.

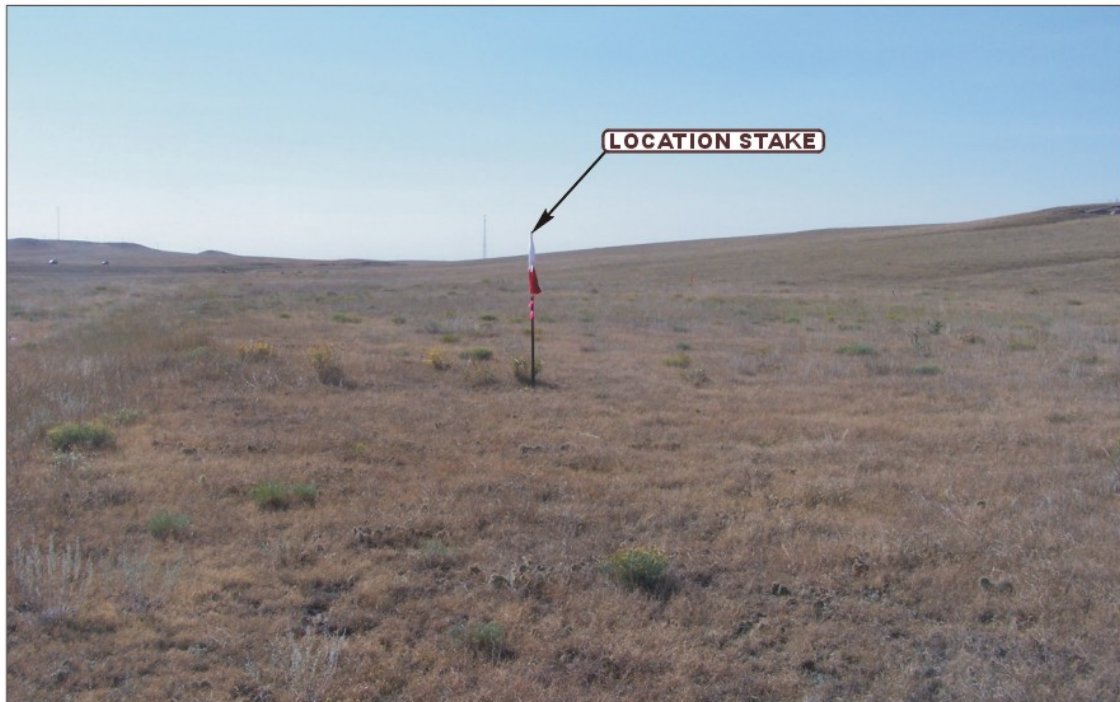

PHOTO: VIEW OF LOCATION STAKE

CAMERA ANGLE: SOUTHERLY



PHOTO: VIEW OF LOCATION STAKE

CAMERA ANGLE: WESTERLY



**UELS**

Uintah Engineering & Land Surveying  
85 South 200 East Vernal, Utah 84078  
435-789-1017 FAX (435) 789-1813

- Since 1964 -

**LOCATION PHOTOS**

**10** **12** **10**  
MONTH DAY YEAR

TAKEN BY: T.A.

DRAWN BY: Z.L.

REVISED: 00-00-00

PHOTO  
**P 3**