

EOG RESOURCES, INC.
EASTMAN CREEK #03-29H
SECTION 29, T11N, R66W, 6th P.M.

PROCEED IN A SOUTHERLY DIRECTION FROM CHEYENNE, WYOMING ALONG HIGHWAY 85 APPROXIMATELY 17.0 MILES TO THE JUNCTION OF THIS ROAD AND COUNTY ROAD 126 TO THE WEST; TURN RIGHT AND PROCEED IN A WESTERLY DIRECTION APPROXIMATELY 0.1 MILES TO THE BEGINNING OF THE PROPOSED ACCESS ROAD TO THE SOUTH; FOLLOW ROAD FLAGS IN A SOUTHERLY, THEN SOUTHWESTERLY DIRECTION APPROXIMATELY 1362' TO THE PROPOSED LOCATION.

TOTAL DISTANCE FROM CHEYENNE, WYOMING TO THE PROPOSED LOCATION IS APPROXIMATELY 17.4 MILES.

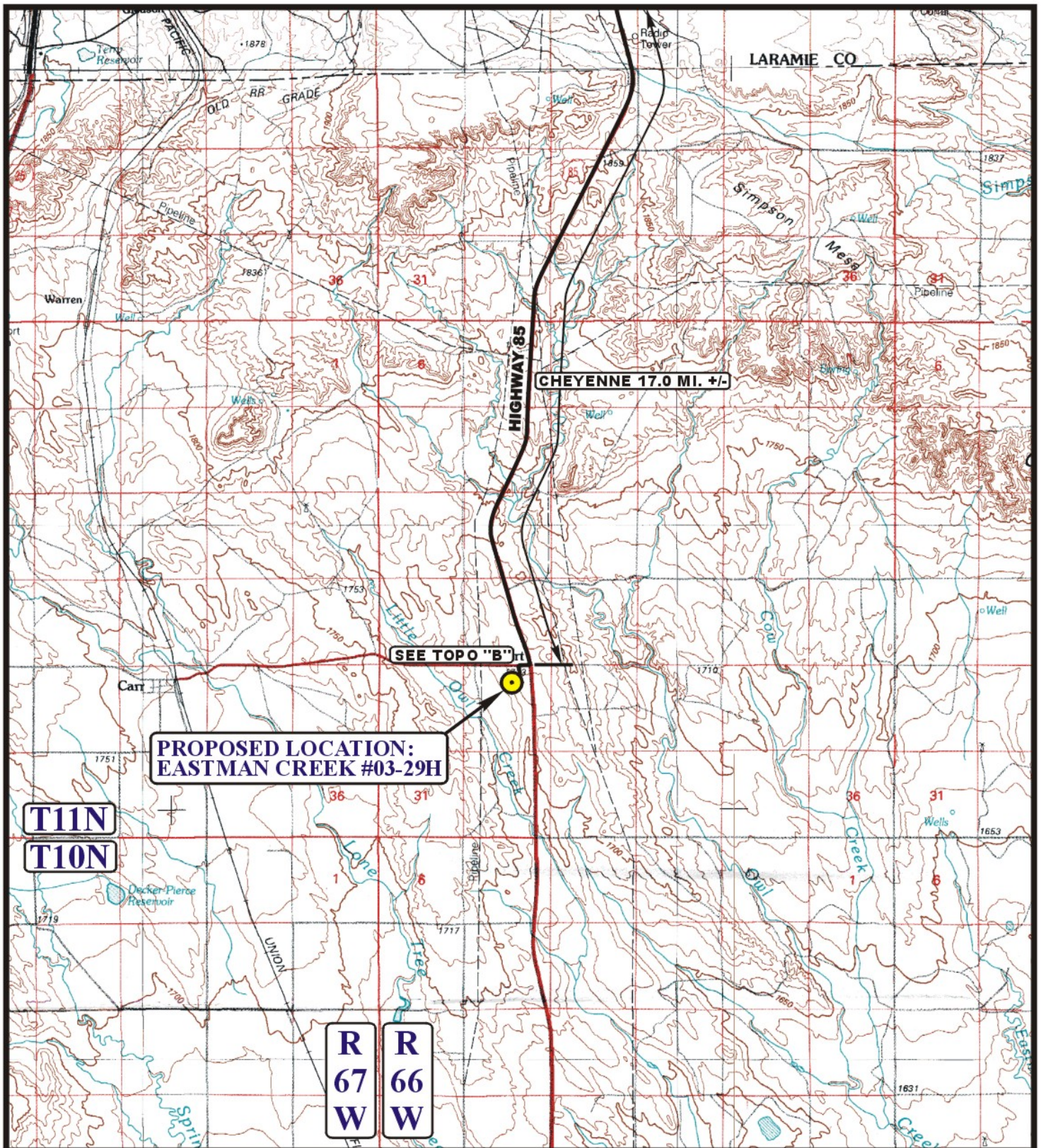

LEGEND:

 PROPOSED LOCATION

EOG RESOURCES, INC.

EASTMAN CREEK #03-29H
SECTION 29, T11N, R66W, 6th P.M.
1043' FNL 2350' FEL



Uintah Engineering & Land Surveying
85 South 200 East Vernal, Utah 84078
(435) 789-1017 * FAX (435) 789-1813



ACCESS ROAD
MAP

10 **12** **10**
MONTH DAY YEAR

SCALE: 1:100,000 DRAWN BY: Z.L. REVISED: 00-00-00



