

EOG RESOURCES, INC.
CHAULK BLUFFS #07-30H
SECTION 30, T11N, R65W, 6th P.M.

PROCEED IN A SOUTHERLY DIRECTION FROM CHEYENNE, WYOMING ALONG HIGHWAY 85 APPROXIMATELY 19.5 MILES TO THE JUNCTION OF THIS ROAD AND CR 122 TO THE EAST; TURN LEFT AND PROCEED IN AN EASTERLY DIRECTION APPROXIMATELY 4.2 MILES TO THE JUNCTION OF THIS ROAD AND CR 37 TO THE NORTH; TURN LEFT AND PROCEED IN A NORTHERLY DIRECTION APPROXIMATELY 2.1 MILES TO THE BEGINNING OF THE PROPOSED ACCESS TO THE EAST; FOLLOW ROAD FLAGS IN AN EASTERLY, THEN SOUTHERLY DIRECTION APPROXIMATELY 683' TO THE PROPOSED LOCATION.

TOTAL DISTANCE FROM CHEYENNE, WYOMING TO THE PROPOSED LOCATION IS APPROXIMATELY 25.9 MILES.

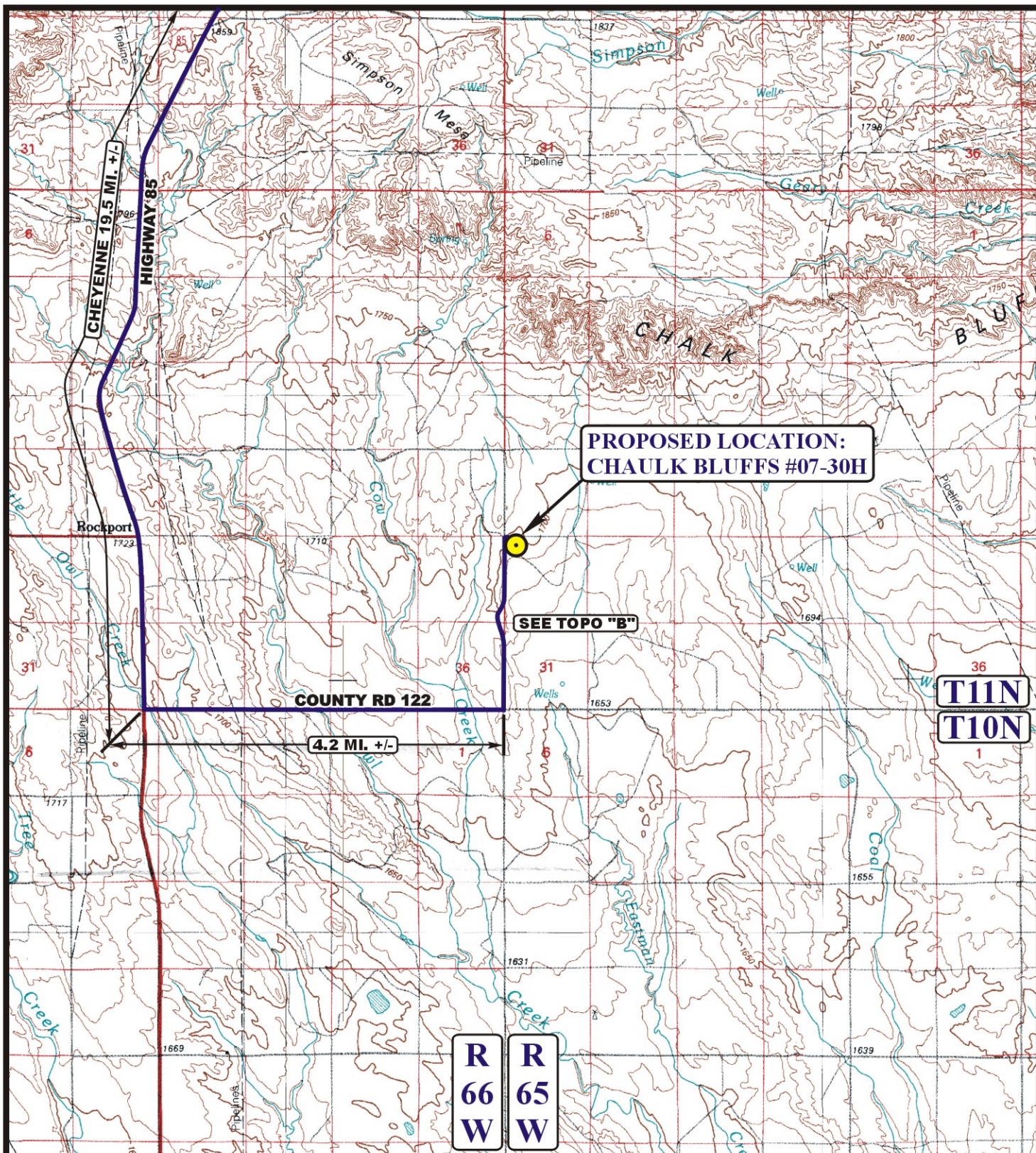

LEGEND:

 PROPOSED LOCATION

EOG RESOURCES, INC.

CHALK BLUFFS #07-30H
SECTION 30, T11N, R65W, 6th P.M.
501' FNL 700' FWL



Uintah Engineering & Land Surveying
 85 South 200 East Vernal, Utah 84078
 (435) 789-1017 * FAX (435) 789-1813



ACCESS ROAD
MAP

11 09 10
 MONTH DAY YEAR

SCALE: 1:100,000

DRAWN BY: J.J.

REVISED: 00-00-00

A
TOPO

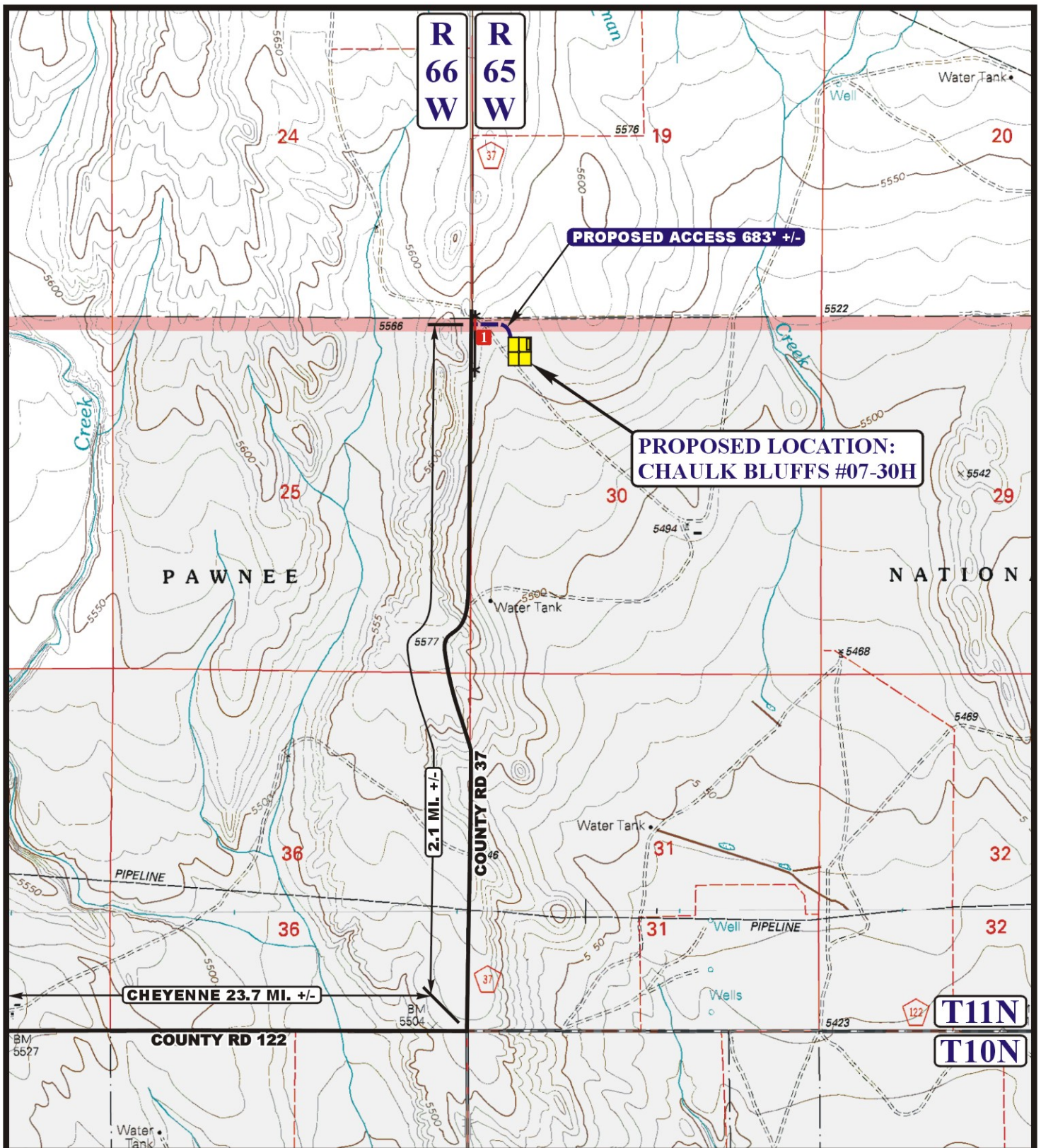

LEGEND:

- EXISTING ROAD
- PROPOSED ACCESS ROAD
- EXISTING FENCE
- INSTALL CATTLEGUARD



Uintah Engineering & Land Surveying
 85 South 200 East Vernal, Utah 84078
 (435) 789-1017 * FAX (435) 789-1813



EOG RESOURCES, INC.

CHALK BLUFFS #07-30H
SECTION 30, T11N, R65W, 6th P.M.
501' FNL 700' FWL

ACCESS ROAD
MAP

11 09 10
 MONTH DAY YEAR

SCALE: 1" = 2000' DRAWN BY: J.J. REVISED: 00-00-00

B
TOPO