

EOG RESOURCES, INC.
EASTMAN CREEK #02-30H
LOCATED IN WELD COUNTY, COLORADO
SECTION 30, T11N, R66W, 6th P.M.



PHOTO: VIEW FROM CORNER #5 TO LOCATION STAKE

CAMERA ANGLE: SOUTHERLY



PHOTO: VIEW FROM BEGINNING OF PROPOSED ACCESS

CAMERA ANGLE: SOUTHERLY



UELS Uintah Engineering & Land Surveying
85 South 200 East Vernal, Utah 84078
(435) 789-1017 * FAX (435) 789-1813

LOCATION PHOTOS

10 **12** **10**
MONTH DAY YEAR

TAKEN BY: T.A.

DRAWN BY: Z.L.

REVISED: 00-00-00

PHOTO
P 1

EOG RESOURCES, INC.
EASTMAN CREEK #02-30H
LOCATED IN WELD COUNTY, COLORADO
SECTION 30, T11N, R66W, 6th P.M.



PHOTO: VIEW OF LOCATION STAKE

CAMERA ANGLE: NORTHERLY



PHOTO: VIEW OF LOCATION STAKE

CAMERA ANGLE: EASTERLY



UELS

Uintah Engineering & Land Surveying
85 South 200 East Vernal, Utah 84078
435-789-1017 FAX (435) 789-1813

LOCATION PHOTOS

10 **12** **10**
MONTH DAY YEAR

TAKEN BY: T.A.

DRAWN BY: Z.L.

REVISED: 00-00-00

PHOTO
P 2

EOG RESOURCES, INC.
EASTMAN CREEK #02-30H
LOCATED IN WELD COUNTY, COLORADO
SECTION 30, T11N, R66W, 6th P.M.

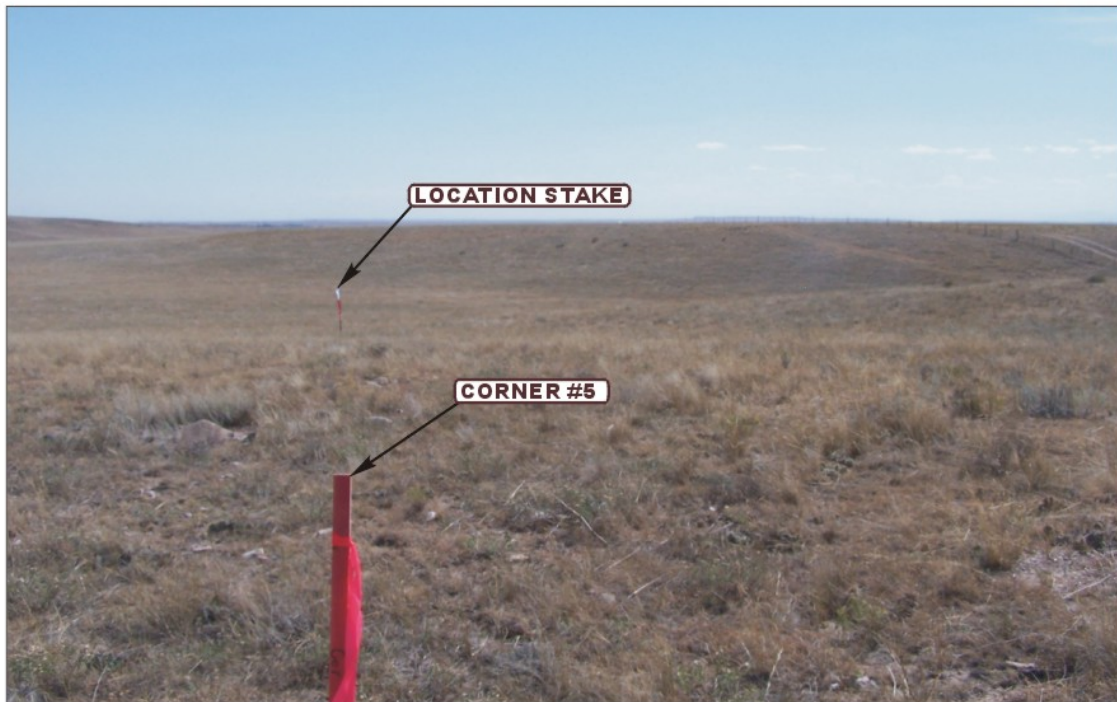

PHOTO: VIEW OF LOCATION STAKE

CAMERA ANGLE: SOUTHERLY



PHOTO: VIEW OF LOCATION STAKE

CAMERA ANGLE: WESTERLY



Uintah Engineering & Land Surveying
85 South 200 East Vernal, Utah 84078
435-789-1017 FAX (435) 789-1813

LOCATION PHOTOS

10 12 10
MONTH DAY YEAR

PHOTO
P 3

TAKEN BY: T.A.

DRAWN BY: Z.L.

REVISED: 00-00-00