

EOG RESOURCES, INC.
EASTMAN CREEK #02-30H
SECTION 30, T11N, R66W, 6th P.M.

PROCEED IN AN SOUTHERLY DIRECTION FROM CHEYENNE, WYOMING ALONG HIGHWAY 85 APPROXIMATELY 17.0 MILES TO THE JUNCTION OF THIS ROAD AND CR 126 TO THE WEST; TURN RIGHT AND PROCEED IN A WESTERLY DIRECTION APPROXIMATELY 1.7 MILES TO THE BEGINNING OF THE PROPOSED ACCESS ROAD TO THE SOUTHWEST; FOLLOW ROAD FLAGS IN A SOUTHWESTERLY DIRECTION APPROXIMATELY 723' TO THE PROPOSED LOCATION.

TOTAL DISTANCE FROM CHEYENNE, WYOMING TO THE PROPOSED LOCATION IS APPROXIMATELY 18.8 MILES.

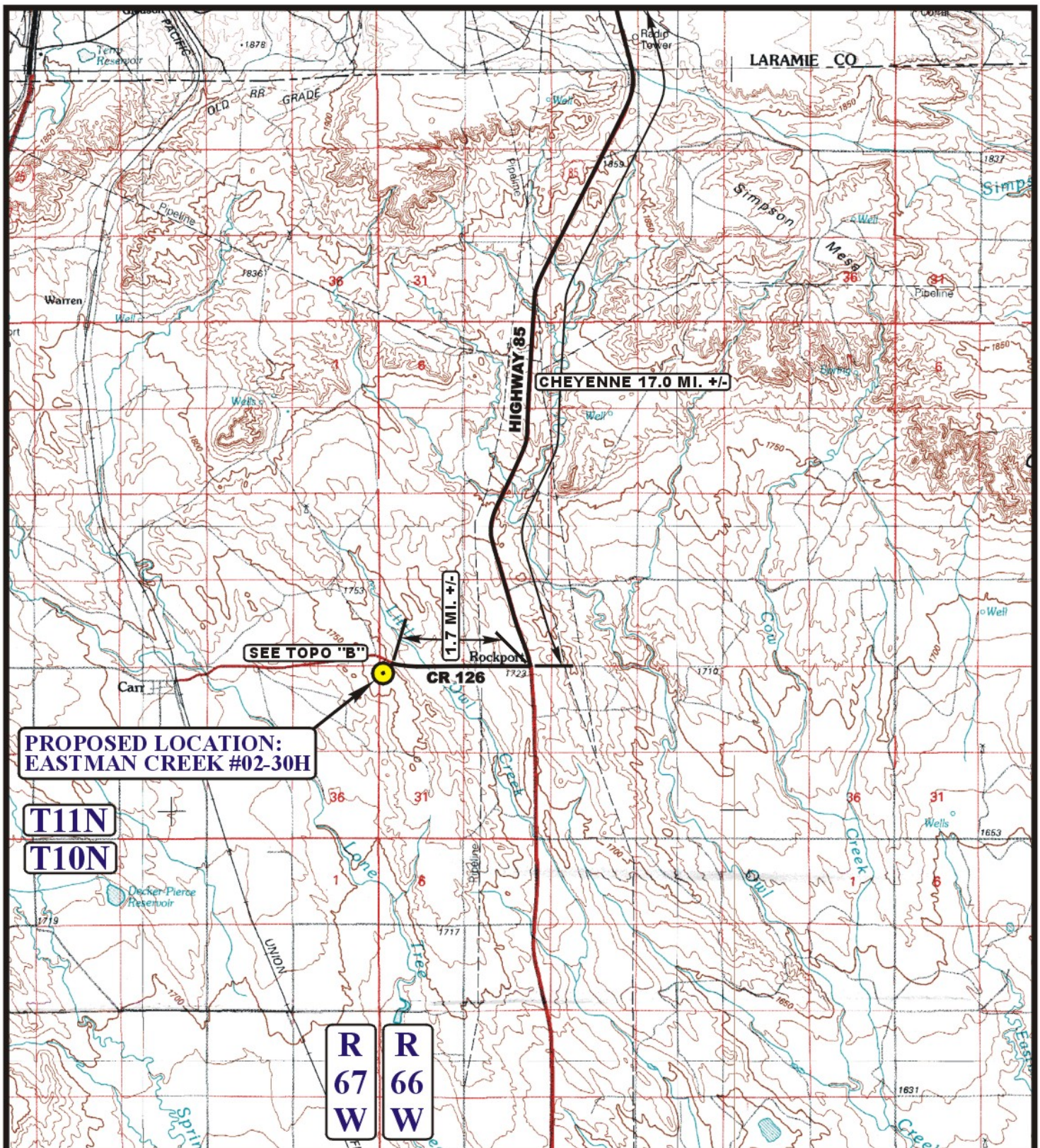

LEGEND:

- 
- PROPOSED LOCATION



Utah Engineering & Land Surveying
85 South 200 East Vernal, Utah 84078
(435) 789-1017 * FAX (435) 789-1813



EOG RESOURCES, INC.

**EASTMAN CREEK #02-30H
SECTION 30, T11N, R66W, 6th P.M.
474' FNL 227' FWL**

TOPOGRAPHIC MAP

10 12 10
MONTH DAY YEAR

SCALE: 1:100,000	DRAWN BY: Z.L.	REVISED: 00-00-00
------------------	----------------	-------------------

A
TOPO

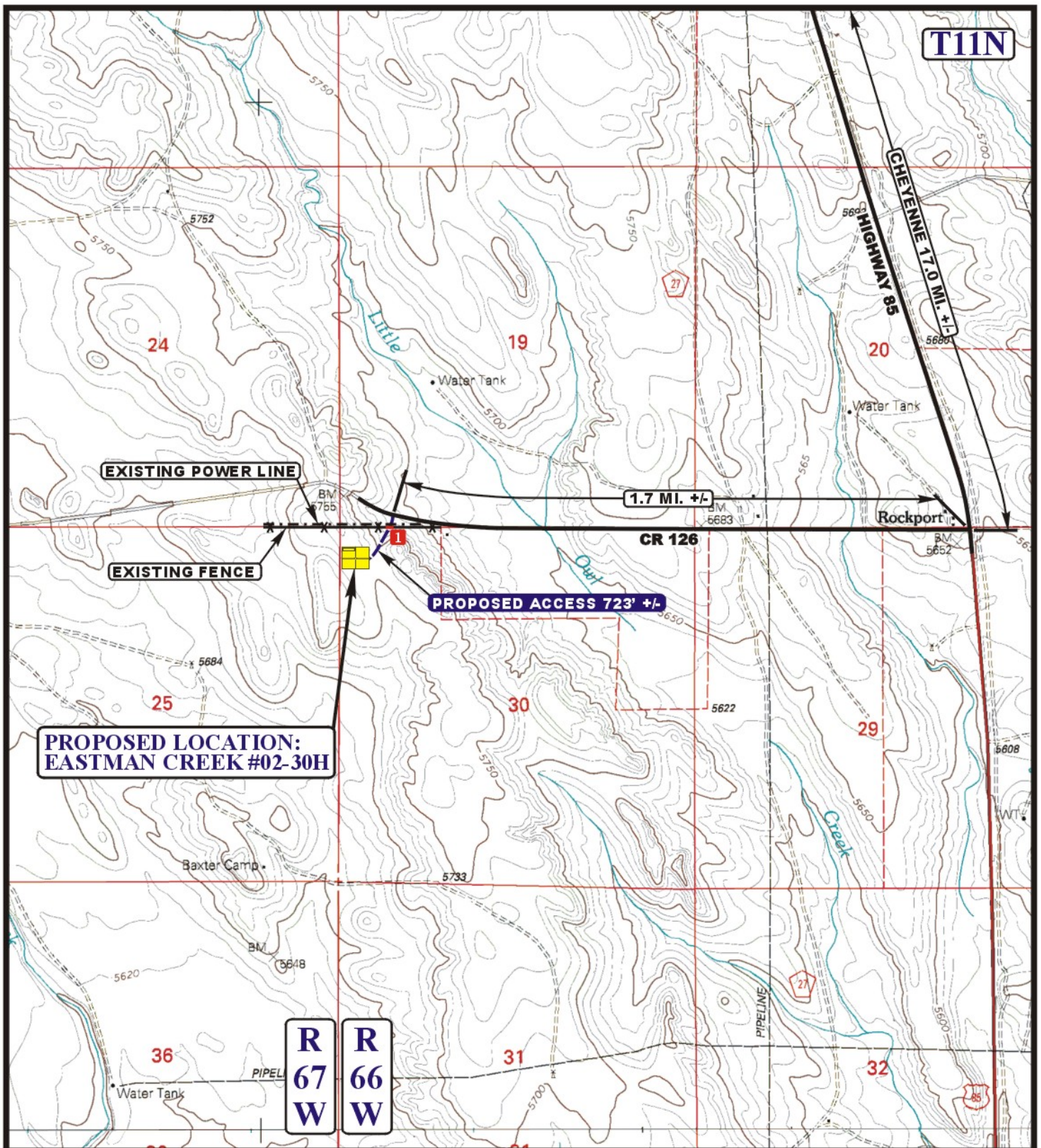

LEGEND:

- EXISTING ROAD
- PROPOSED ACCESS ROAD
- EXISTING FENCE
- INSTALL CATTLE GUARD



Utah Engineering & Land Surveying
85 South 200 East Vernal, Utah 84078
(435) 789-1017 * FAX (435) 789-1813



EOG RESOURCES, INC.

EASTMAN CREEK #02-30H
SECTION 30, T11N, R66W, 6th P.M.
474' FNL 227' FWL

TOPOGRAPHIC
MAP

10 12 10
MONTH DAY YEAR

SCALE: 1" = 2000' DRAWN BY: Z.L. REVISED: 00-00-00

B
TOPO