



# **Denver Division- Colorado**

**DJ - Hereford Ranch**

**Jackson Draw #05-11H**

**Jackson Draw #05-11H**

**Original Wellbore**

**Plan: APD Directional Plan**

## **Standard Planning Report**

**21 December, 2010**

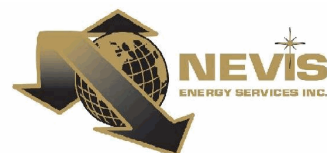

<b>Database:</b>	EDM 2003.21 Single User Db	<b>Local Co-ordinate Reference:</b>	Well Jackson Draw #05-11H
<b>Company:</b>	Denver Division- Colorado	<b>TVD Reference:</b>	Graded Elevation @ 5022.0ft
<b>Project:</b>	DJ - Hereford Ranch	<b>MD Reference:</b>	Graded Elevation @ 5022.0ft
<b>Site:</b>	Jackson Draw #05-11H	<b>North Reference:</b>	True
<b>Well:</b>	Jackson Draw #05-11H	<b>Survey Calculation Method:</b>	Minimum Curvature
<b>Wellbore:</b>	Original Wellbore		
<b>Design:</b>	APD Directional Plan		

<b>Project</b>	DJ - Hereford Ranch, Weld County		
<b>Map System:</b>	US State Plane 1927 (Exact solution)	<b>System Datum:</b>	Mean Sea Level
<b>Geo Datum:</b>	NAD 1927 (NADCON CONUS)		
<b>Map Zone:</b>	Colorado North 501		

Site		Jackson Draw #05-11H			
Site Position:		Northing:	522,202.46 ft	Latitude:	40° 45' 33.150 N
From:	Lat/Long	Easting:	2,370,020.22 ft	Longitude:	104° 9' 51.620 W
Position Uncertainty:	0.0 ft	Slot Radius:	"	Grid Convergence:	0.86 °

Well	Jackson Draw #05-11H					
Well Position	+N/-S	0.0 ft	Northing:	522,202.46 ft	Latitude:	40° 45' 33.150 N
	+E/-W	0.0 ft	Easting:	2,370,020.22 ft	Longitude:	104° 9' 51.620 W
Position Uncertainty		0.0 ft	Wellhead Elevation:	ft	Ground Level:	5,000.0 ft

<b>Wellbore</b>	Original Wellbore				
<b>Magnetics</b>	<b>Model Name</b>	<b>Sample Date</b>	<b>Declination (°)</b>	<b>Dip Angle (°)</b>	<b>Field Strength (nT)</b>
	IGRF200510	2009/12/31	8.72	67.50	53,539

<b>Design</b>	APD Directional Plan			
<b>Audit Notes:</b>				
<b>Version:</b>	<b>Phase:</b>	PROTOTYPE	<b>Tie On Depth:</b>	0.0
<b>Vertical Section:</b>	<b>Depth From (TVD)</b>	<b>+N/-S</b>	<b>+E/-W</b>	<b>Direction</b>
	(ft)	(ft)	(ft)	(°)
	0.0	0.0	0.0	330.42

<b>Plan Sections</b>										
Measured Depth (ft)	Inclination (°)	Azimuth (°)	Vertical Depth (ft)	+N/-S (ft)	+E/-W (ft)	Dogleg Rate (°/100ft)	Build Rate (°/100ft)	Turn Rate (°/100ft)	TFO (°)	Target
0.0	0.00	0.00	0.0	0.0	0.0	0.00	0.00	0.00	0.00	
6,035.5	0.00	0.00	6,035.5	0.0	0.0	0.00	0.00	0.00	0.00	
6,785.5	90.00	330.42	6,513.0	415.2	-235.7	12.00	12.00	0.00	330.42	
10,737.3	90.00	330.42	6,513.0	3,851.9	-2,186.8	0.00	0.00	0.00	0.00	Jackson Draw #05-11

<b>Database:</b>	EDM 2003.21 Single User Db	<b>Local Co-ordinate Reference:</b>	Well Jackson Draw #05-11H
<b>Company:</b>	Denver Division- Colorado	<b>TVD Reference:</b>	Graded Elevation @ 5022.0ft
<b>Project:</b>	DJ - Hereford Ranch	<b>MD Reference:</b>	Graded Elevation @ 5022.0ft
<b>Site:</b>	Jackson Draw #05-11H	<b>North Reference:</b>	True
<b>Well:</b>	Jackson Draw #05-11H	<b>Survey Calculation Method:</b>	Minimum Curvature
<b>Wellbore:</b>	Original Wellbore		
<b>Design:</b>	APD Directional Plan		

Planned Survey									
Measured Depth (ft)	Inclination (°)	Azimuth (°)	Vertical Depth (ft)	+N/-S (ft)	+E/-W (ft)	Vertical Section (ft)	Dogleg Rate (°/100ft)	Build Rate (°/100ft)	Turn Rate (°/100ft)
0.0	0.00	0.00	0.0	0.0	0.0	0.0	0.00	0.00	0.00
100.0	0.00	0.00	100.0	0.0	0.0	0.0	0.00	0.00	0.00
200.0	0.00	0.00	200.0	0.0	0.0	0.0	0.00	0.00	0.00
300.0	0.00	0.00	300.0	0.0	0.0	0.0	0.00	0.00	0.00
390.0	0.00	0.00	390.0	0.0	0.0	0.0	0.00	0.00	0.00
Fox Hills									
400.0	0.00	0.00	400.0	0.0	0.0	0.0	0.00	0.00	0.00
500.0	0.00	0.00	500.0	0.0	0.0	0.0	0.00	0.00	0.00
562.0	0.00	0.00	562.0	0.0	0.0	0.0	0.00	0.00	0.00
Pierre Shale									
600.0	0.00	0.00	600.0	0.0	0.0	0.0	0.00	0.00	0.00
700.0	0.00	0.00	700.0	0.0	0.0	0.0	0.00	0.00	0.00
800.0	0.00	0.00	800.0	0.0	0.0	0.0	0.00	0.00	0.00
9 5/8"									
900.0	0.00	0.00	900.0	0.0	0.0	0.0	0.00	0.00	0.00
1,000.0	0.00	0.00	1,000.0	0.0	0.0	0.0	0.00	0.00	0.00
1,100.0	0.00	0.00	1,100.0	0.0	0.0	0.0	0.00	0.00	0.00
1,200.0	0.00	0.00	1,200.0	0.0	0.0	0.0	0.00	0.00	0.00
1,300.0	0.00	0.00	1,300.0	0.0	0.0	0.0	0.00	0.00	0.00
1,400.0	0.00	0.00	1,400.0	0.0	0.0	0.0	0.00	0.00	0.00
1,500.0	0.00	0.00	1,500.0	0.0	0.0	0.0	0.00	0.00	0.00
1,600.0	0.00	0.00	1,600.0	0.0	0.0	0.0	0.00	0.00	0.00
1,700.0	0.00	0.00	1,700.0	0.0	0.0	0.0	0.00	0.00	0.00
1,800.0	0.00	0.00	1,800.0	0.0	0.0	0.0	0.00	0.00	0.00
1,900.0	0.00	0.00	1,900.0	0.0	0.0	0.0	0.00	0.00	0.00
2,000.0	0.00	0.00	2,000.0	0.0	0.0	0.0	0.00	0.00	0.00
2,100.0	0.00	0.00	2,100.0	0.0	0.0	0.0	0.00	0.00	0.00
2,200.0	0.00	0.00	2,200.0	0.0	0.0	0.0	0.00	0.00	0.00
2,300.0	0.00	0.00	2,300.0	0.0	0.0	0.0	0.00	0.00	0.00
2,400.0	0.00	0.00	2,400.0	0.0	0.0	0.0	0.00	0.00	0.00
2,500.0	0.00	0.00	2,500.0	0.0	0.0	0.0	0.00	0.00	0.00
2,600.0	0.00	0.00	2,600.0	0.0	0.0	0.0	0.00	0.00	0.00
2,700.0	0.00	0.00	2,700.0	0.0	0.0	0.0	0.00	0.00	0.00
2,800.0	0.00	0.00	2,800.0	0.0	0.0	0.0	0.00	0.00	0.00
2,900.0	0.00	0.00	2,900.0	0.0	0.0	0.0	0.00	0.00	0.00
3,000.0	0.00	0.00	3,000.0	0.0	0.0	0.0	0.00	0.00	0.00
3,100.0	0.00	0.00	3,100.0	0.0	0.0	0.0	0.00	0.00	0.00
3,200.0	0.00	0.00	3,200.0	0.0	0.0	0.0	0.00	0.00	0.00
3,300.0	0.00	0.00	3,300.0	0.0	0.0	0.0	0.00	0.00	0.00
3,400.0	0.00	0.00	3,400.0	0.0	0.0	0.0	0.00	0.00	0.00
3,500.0	0.00	0.00	3,500.0	0.0	0.0	0.0	0.00	0.00	0.00
3,581.0	0.00	0.00	3,581.0	0.0	0.0	0.0	0.00	0.00	0.00
Richard Sand									
3,600.0	0.00	0.00	3,600.0	0.0	0.0	0.0	0.00	0.00	0.00
3,680.0	0.00	0.00	3,680.0	0.0	0.0	0.0	0.00	0.00	0.00
Hygiene									
3,700.0	0.00	0.00	3,700.0	0.0	0.0	0.0	0.00	0.00	0.00
3,800.0	0.00	0.00	3,800.0	0.0	0.0	0.0	0.00	0.00	0.00
3,900.0	0.00	0.00	3,900.0	0.0	0.0	0.0	0.00	0.00	0.00
4,000.0	0.00	0.00	4,000.0	0.0	0.0	0.0	0.00	0.00	0.00
4,100.0	0.00	0.00	4,100.0	0.0	0.0	0.0	0.00	0.00	0.00
4,200.0	0.00	0.00	4,200.0	0.0	0.0	0.0	0.00	0.00	0.00
4,300.0	0.00	0.00	4,300.0	0.0	0.0	0.0	0.00	0.00	0.00
4,400.0	0.00	0.00	4,400.0	0.0	0.0	0.0	0.00	0.00	0.00

<b>Database:</b>	EDM 2003.21 Single User Db	<b>Local Co-ordinate Reference:</b>	Well Jackson Draw #05-11H
<b>Company:</b>	Denver Division- Colorado	<b>TVD Reference:</b>	Graded Elevation @ 5022.0ft
<b>Project:</b>	DJ - Hereford Ranch	<b>MD Reference:</b>	Graded Elevation @ 5022.0ft
<b>Site:</b>	Jackson Draw #05-11H	<b>North Reference:</b>	True
<b>Well:</b>	Jackson Draw #05-11H	<b>Survey Calculation Method:</b>	Minimum Curvature
<b>Wellbore:</b>	Original Wellbore		
<b>Design:</b>	APD Directional Plan		

Planned Survey									
Measured Depth (ft)	Inclination (°)	Azimuth (°)	Vertical Depth (ft)	+N/-S (ft)	+E/-W (ft)	Vertical Section (ft)	Dogleg Rate (°/100ft)	Build Rate (°/100ft)	Turn Rate (°/100ft)
4,500.0	0.00	0.00	4,500.0	0.0	0.0	0.0	0.00	0.00	0.00
4,600.0	0.00	0.00	4,600.0	0.0	0.0	0.0	0.00	0.00	0.00
4,700.0	0.00	0.00	4,700.0	0.0	0.0	0.0	0.00	0.00	0.00
4,800.0	0.00	0.00	4,800.0	0.0	0.0	0.0	0.00	0.00	0.00
4,900.0	0.00	0.00	4,900.0	0.0	0.0	0.0	0.00	0.00	0.00
5,000.0	0.00	0.00	5,000.0	0.0	0.0	0.0	0.00	0.00	0.00
5,100.0	0.00	0.00	5,100.0	0.0	0.0	0.0	0.00	0.00	0.00
5,200.0	0.00	0.00	5,200.0	0.0	0.0	0.0	0.00	0.00	0.00
5,300.0	0.00	0.00	5,300.0	0.0	0.0	0.0	0.00	0.00	0.00
5,400.0	0.00	0.00	5,400.0	0.0	0.0	0.0	0.00	0.00	0.00
5,500.0	0.00	0.00	5,500.0	0.0	0.0	0.0	0.00	0.00	0.00
5,600.0	0.00	0.00	5,600.0	0.0	0.0	0.0	0.00	0.00	0.00
5,700.0	0.00	0.00	5,700.0	0.0	0.0	0.0	0.00	0.00	0.00
5,800.0	0.00	0.00	5,800.0	0.0	0.0	0.0	0.00	0.00	0.00
5,900.0	0.00	0.00	5,900.0	0.0	0.0	0.0	0.00	0.00	0.00
6,000.0	0.00	0.00	6,000.0	0.0	0.0	0.0	0.00	0.00	0.00
6,035.5	0.00	0.00	6,035.5	0.0	0.0	0.0	0.00	0.00	0.00
6,050.0	1.74	330.42	6,050.0	0.2	-0.1	0.2	12.00	12.00	0.00
6,075.0	4.74	330.42	6,075.0	1.4	-0.8	1.6	12.00	12.00	0.00
6,100.0	7.74	330.42	6,099.8	3.8	-2.1	4.3	12.00	12.00	0.00
6,125.0	10.74	330.42	6,124.5	7.3	-4.1	8.4	12.00	12.00	0.00
6,150.0	13.74	330.42	6,148.9	11.9	-6.7	13.7	12.00	12.00	0.00
6,175.0	16.74	330.42	6,173.0	17.6	-10.0	20.2	12.00	12.00	0.00
6,200.0	19.74	330.42	6,196.8	24.4	-13.9	28.1	12.00	12.00	0.00
6,225.0	22.74	330.42	6,220.1	32.3	-18.3	37.1	12.00	12.00	0.00
6,250.0	25.74	330.42	6,242.9	41.2	-23.4	47.4	12.00	12.00	0.00
6,275.0	28.74	330.42	6,265.1	51.1	-29.0	58.8	12.00	12.00	0.00
6,300.0	31.74	330.42	6,286.7	62.1	-35.3	71.4	12.00	12.00	0.00
6,325.0	34.74	330.42	6,307.6	74.0	-42.0	85.1	12.00	12.00	0.00
6,344.0	37.02	330.42	6,323.0	83.7	-47.5	96.3	12.00	12.00	0.00
<b>Sharon Springs</b>									
6,350.0	37.74	330.42	6,327.7	86.9	-49.3	99.9	12.00	12.00	0.00
6,375.0	40.74	330.42	6,347.1	100.6	-57.1	115.7	12.00	12.00	0.00
6,400.0	43.74	330.42	6,365.6	115.2	-65.4	132.5	12.00	12.00	0.00
6,425.0	46.74	330.42	6,383.2	130.7	-74.2	150.3	12.00	12.00	0.00
6,432.0	47.58	330.42	6,388.0	135.1	-76.7	155.4	12.00	12.00	0.00
<b>Niobrara</b>									
6,450.0	49.74	330.42	6,399.9	146.9	-83.4	168.9	12.00	12.00	0.00
6,475.0	52.74	330.42	6,415.5	163.8	-93.0	188.4	12.00	12.00	0.00
6,500.0	55.74	330.42	6,430.1	181.5	-103.0	208.7	12.00	12.00	0.00
6,525.0	58.74	330.42	6,443.6	199.7	-113.4	229.7	12.00	12.00	0.00
6,550.0	61.74	330.42	6,456.1	218.6	-124.1	251.4	12.00	12.00	0.00
6,575.0	64.74	330.42	6,467.3	238.0	-135.1	273.7	12.00	12.00	0.00
6,596.4	67.31	330.42	6,476.0	255.0	-144.8	293.3	12.00	12.00	0.00
<b>B1 Chalk</b>									
6,600.0	67.74	330.42	6,477.4	257.9	-146.4	296.6	12.00	12.00	0.00
6,625.0	70.74	330.42	6,486.2	278.3	-158.0	320.0	12.00	12.00	0.00
6,646.9	73.37	330.42	6,493.0	296.4	-168.3	340.8	12.00	12.00	0.00
<b>B-Chalk</b>									
6,650.0	73.74	330.42	6,493.9	299.0	-169.7	343.8	12.00	12.00	0.00
6,675.0	76.74	330.42	6,500.2	320.0	-181.7	367.9	12.00	12.00	0.00
6,700.0	79.74	330.42	6,505.3	341.3	-193.7	392.4	12.00	12.00	0.00
6,725.0	82.74	330.42	6,509.1	362.7	-205.9	417.1	12.00	12.00	0.00

<b>Database:</b>	EDM 2003.21 Single User Db	<b>Local Co-ordinate Reference:</b>	Well Jackson Draw #05-11H
<b>Company:</b>	Denver Division- Colorado	<b>TVD Reference:</b>	Graded Elevation @ 5022.0ft
<b>Project:</b>	DJ - Hereford Ranch	<b>MD Reference:</b>	Graded Elevation @ 5022.0ft
<b>Site:</b>	Jackson Draw #05-11H	<b>North Reference:</b>	True
<b>Well:</b>	Jackson Draw #05-11H	<b>Survey Calculation Method:</b>	Minimum Curvature
<b>Wellbore:</b>	Original Wellbore		
<b>Design:</b>	APD Directional Plan		

Planned Survey									
Measured Depth (ft)	Inclination (°)	Azimuth (°)	Vertical Depth (ft)	+N/-S (ft)	+E/-W (ft)	Vertical Section (ft)	Dogleg Rate (°/100ft)	Build Rate (°/100ft)	Turn Rate (°/100ft)
6,750.0	85.74	330.42	6,511.6	384.4	-218.2	442.0	12.00	12.00	0.00
6,775.0	88.74	330.42	6,512.9	406.1	-230.5	467.0	12.00	12.00	0.00
6,785.5	90.00	330.42	6,513.0	415.2	-235.7	477.5	12.00	12.00	0.00
7"									
6,800.0	90.00	330.42	6,513.0	427.8	-242.9	492.0	0.00	0.00	0.00
6,900.0	90.00	330.42	6,513.0	514.8	-292.3	592.0	0.00	0.00	0.00
7,000.0	90.00	330.42	6,513.0	601.7	-341.6	692.0	0.00	0.00	0.00
7,100.0	90.00	330.42	6,513.0	688.7	-391.0	792.0	0.00	0.00	0.00
7,200.0	90.00	330.42	6,513.0	775.7	-440.4	892.0	0.00	0.00	0.00
7,300.0	90.00	330.42	6,513.0	862.6	-489.7	992.0	0.00	0.00	0.00
7,400.0	90.00	330.42	6,513.0	949.6	-539.1	1,092.0	0.00	0.00	0.00
7,500.0	90.00	330.42	6,513.0	1,036.6	-588.5	1,192.0	0.00	0.00	0.00
7,600.0	90.00	330.42	6,513.0	1,123.5	-637.8	1,292.0	0.00	0.00	0.00
7,700.0	90.00	330.42	6,513.0	1,210.5	-687.2	1,392.0	0.00	0.00	0.00
7,800.0	90.00	330.42	6,513.0	1,297.5	-736.6	1,492.0	0.00	0.00	0.00
7,900.0	90.00	330.42	6,513.0	1,384.4	-786.0	1,592.0	0.00	0.00	0.00
8,000.0	90.00	330.42	6,513.0	1,471.4	-835.3	1,692.0	0.00	0.00	0.00
8,100.0	90.00	330.42	6,513.0	1,558.3	-884.7	1,792.0	0.00	0.00	0.00
8,200.0	90.00	330.42	6,513.0	1,645.3	-934.1	1,892.0	0.00	0.00	0.00
8,300.0	90.00	330.42	6,513.0	1,732.3	-983.4	1,992.0	0.00	0.00	0.00
8,400.0	90.00	330.42	6,513.0	1,819.2	-1,032.8	2,092.0	0.00	0.00	0.00
8,500.0	90.00	330.42	6,513.0	1,906.2	-1,082.2	2,192.0	0.00	0.00	0.00
8,600.0	90.00	330.42	6,513.0	1,993.2	-1,131.5	2,292.0	0.00	0.00	0.00
8,700.0	90.00	330.42	6,513.0	2,080.1	-1,180.9	2,392.0	0.00	0.00	0.00
8,800.0	90.00	330.42	6,513.0	2,167.1	-1,230.3	2,492.0	0.00	0.00	0.00
8,900.0	90.00	330.42	6,513.0	2,254.0	-1,279.7	2,592.0	0.00	0.00	0.00
9,000.0	90.00	330.42	6,513.0	2,341.0	-1,329.0	2,692.0	0.00	0.00	0.00
9,100.0	90.00	330.42	6,513.0	2,428.0	-1,378.4	2,792.0	0.00	0.00	0.00
9,200.0	90.00	330.42	6,513.0	2,514.9	-1,427.8	2,892.0	0.00	0.00	0.00
9,300.0	90.00	330.42	6,513.0	2,601.9	-1,477.1	2,992.0	0.00	0.00	0.00
9,400.0	90.00	330.42	6,513.0	2,688.9	-1,526.5	3,092.0	0.00	0.00	0.00
9,500.0	90.00	330.42	6,513.0	2,775.8	-1,575.9	3,192.0	0.00	0.00	0.00
9,600.0	90.00	330.42	6,513.0	2,862.8	-1,625.2	3,292.0	0.00	0.00	0.00
9,700.0	90.00	330.42	6,513.0	2,949.8	-1,674.6	3,392.0	0.00	0.00	0.00
9,800.0	90.00	330.42	6,513.0	3,036.7	-1,724.0	3,492.0	0.00	0.00	0.00
9,900.0	90.00	330.42	6,513.0	3,123.7	-1,773.4	3,592.0	0.00	0.00	0.00
10,000.0	90.00	330.42	6,513.0	3,210.6	-1,822.7	3,692.0	0.00	0.00	0.00
10,100.0	90.00	330.42	6,513.0	3,297.6	-1,872.1	3,792.0	0.00	0.00	0.00
10,200.0	90.00	330.42	6,513.0	3,384.6	-1,921.5	3,892.0	0.00	0.00	0.00
10,300.0	90.00	330.42	6,513.0	3,471.5	-1,970.8	3,992.0	0.00	0.00	0.00
10,400.0	90.00	330.42	6,513.0	3,558.5	-2,020.2	4,092.0	0.00	0.00	0.00
10,500.0	90.00	330.42	6,513.0	3,645.5	-2,069.6	4,192.0	0.00	0.00	0.00
10,600.0	90.00	330.42	6,513.0	3,732.4	-2,118.9	4,292.0	0.00	0.00	0.00
10,700.0	90.00	330.42	6,513.0	3,819.4	-2,168.3	4,392.0	0.00	0.00	0.00
10,737.3	90.00	330.42	6,513.0	3,851.8	-2,186.7	4,429.3	0.00	0.00	0.00
Target Zone - 4 1/2"									

<b>Database:</b>	EDM 2003.21 Single User Db	<b>Local Co-ordinate Reference:</b>	Well Jackson Draw #05-11H
<b>Company:</b>	Denver Division- Colorado	<b>TVD Reference:</b>	Graded Elevation @ 5022.0ft
<b>Project:</b>	DJ - Hereford Ranch	<b>MD Reference:</b>	Graded Elevation @ 5022.0ft
<b>Site:</b>	Jackson Draw #05-11H	<b>North Reference:</b>	True
<b>Well:</b>	Jackson Draw #05-11H	<b>Survey Calculation Method:</b>	Minimum Curvature
<b>Wellbore:</b>	Original Wellbore		
<b>Design:</b>	APD Directional Plan		

Targets									
Target Name	Dip Angle	Dip Dir.	TVD	+N/-S	+E/-W	Northing	Easting	Latitude	Longitude
- hit/miss target	(°)	(°)	(ft)	(ft)	(ft)	(ft)	(ft)		
- Shape									
Jackson Draw #05-11H	0.00	0.00	6,513.0	3,851.9	-2,186.8	526,020.94	2,367,775.70	40° 46' 11.210 N	104° 10' 20.040 W
- plan hits target center									
- Point									

Casing Points					
Measured Depth	Vertical Depth	Name		Casing Diameter	Hole Diameter
(ft)	(ft)			(")	(")
800.0	800.0	9 5/8"		9-5/8	13-1/2
6,785.5	6,513.0	7"		7	8-3/4
10,737.3	6,513.0	4 1/2"		4-1/2	6

Formations						
Measured Depth	Vertical Depth	Name	Lithology	Dip	Dip Direction	
(ft)	(ft)			(°)	(°)	
390.0	390.0	Fox Hills		0.00		
562.0	562.0	Pierre Shale		0.00		
3,581.0	3,581.0	Richard Sand		0.00		
3,680.0	3,680.0	Hygiene		0.00		
6,344.0	6,323.0	Sharon Springs		0.00		
6,432.0	6,388.0	Niobrara		0.00		
6,596.4	6,476.0	B1 Chalk		0.00		
6,646.9	6,493.0	B-Chalk		0.00		
10,737.3	6,513.0	Target Zone		0.00		

**Jackson Draw #05-11H**  
 Section 11 T9N R61W  
 Weld County, CO



Surface Location			
NAD 1927 (NADCON CONUS)		Colorado North 501	
Ground Elevation: 5000.0		Graded Elevation @ 5022.0ft	
Northing	Easting	Latitude	Longitude
522202.46	2370020.22	40° 45' 33.150 N	104° 9' 51.620 W

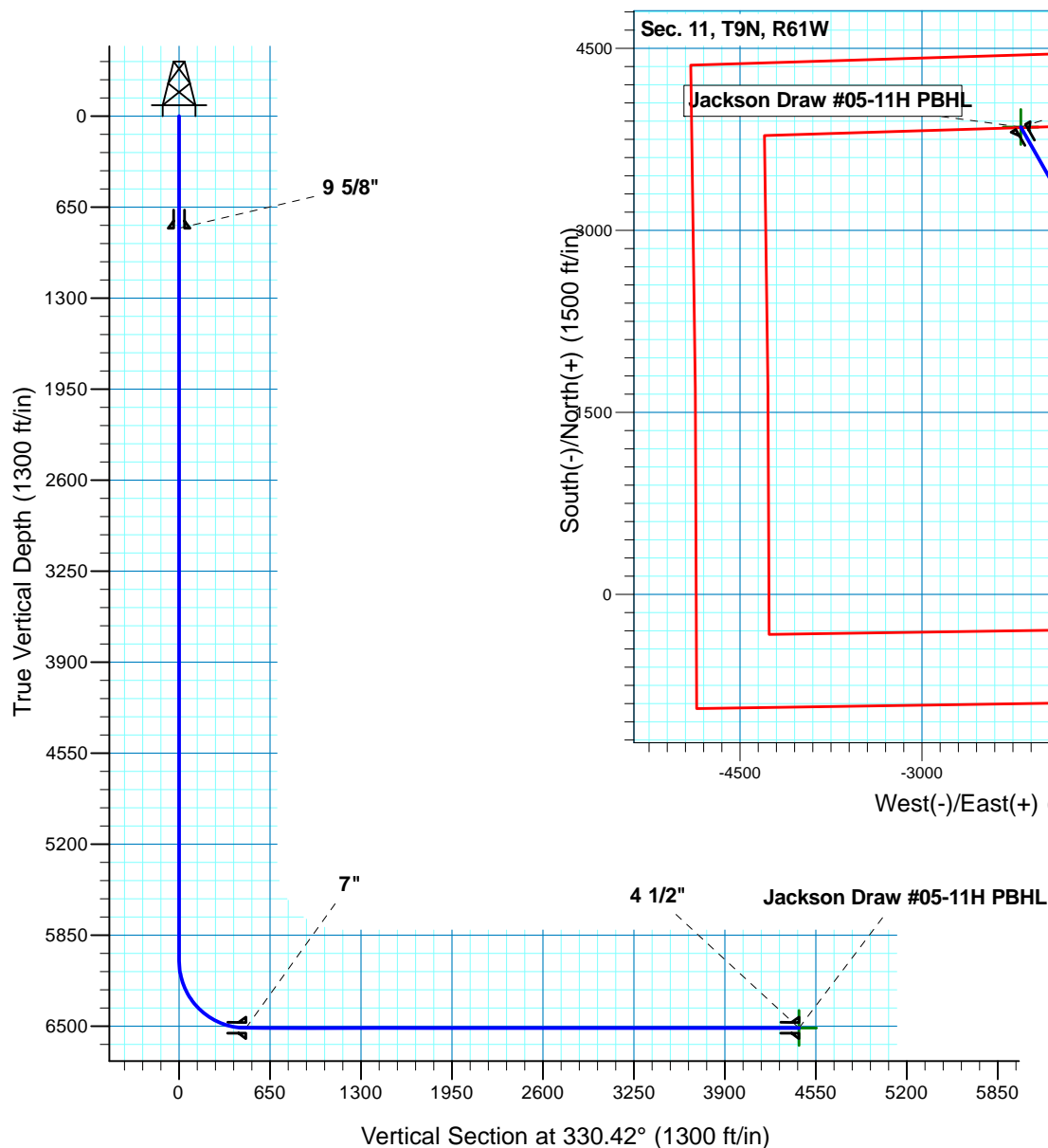

**T M**  
 Azimuths to True North  
 Magnetic North: 8.72°  
 Magnetic Field  
 Strength: 53538.7nT  
 Dip Angle: 67.50°  
 Date: 2009/12/31  
 Model: IGRF200510

Project: DJ - Hereford Ranch  
 Site: Jackson Draw #05-11H  
 Well: Jackson Draw #05-11H  
 Plan: APD Directional Plan

SECTION DETAILS										
Sec	MD	Inc	Azi	TVD	+N/-S	+E/-W	DLeg	TFace	VSec	Target
1	0.0	0.00	0.00	0.0	0.0	0.0	0.00	0.00	0.0	
2	6035.5	0.00	0.00	6035.5	0.0	0.0	0.00	0.00	0.0	
3	6785.5	90.00	330.42	6513.0	415.2	-235.7	12.00	330.42	477.5	
4	10737.3	90.00	330.42	6513.0	3851.9	-2186.8	0.00	0.00	4429.3	Jackson Draw #05-11H PBHL
TARGET DETAILS										
Name	TVD	+N/-S	+E/-W	Northing	Easting	Latitude	Longitude	Shape		
Jackson Draw #05-11H PBHL	6513.0	3851.9	-2186.8	526020.94	2367775.70	40° 46' 11.210 N	104° 10' 20.040 W	Point		