

EOG RESOURCES, INC.
SPRING #10-24H
LOCATED IN WELD COUNTY, COLORADO
SECTION 24, T10N, R67W, 6th P.M.

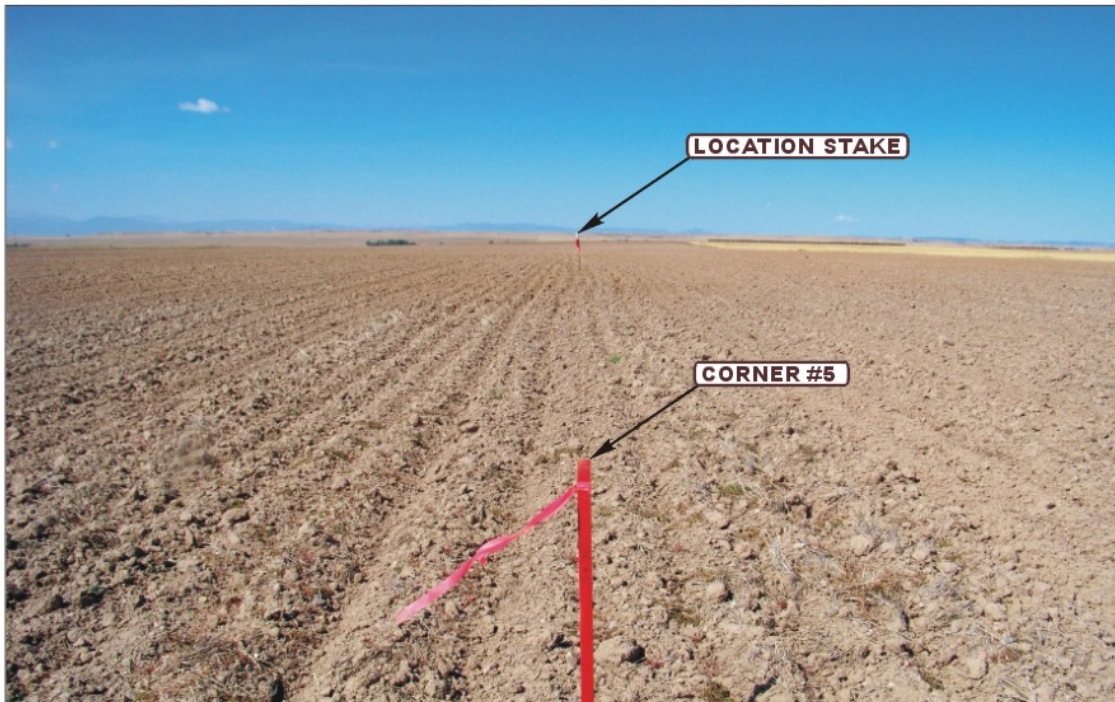

PHOTO: VIEW FROM CORNER #5 TO LOCATION STAKE

CAMERA ANGLE: WESTERLY



PHOTO: VIEW FROM BEGINNING OF PROPOSED ACCESS

CAMERA ANGLE: EASTERLY



UELS Uintah Engineering & Land Surveying
85 South 200 East Vernal, Utah 84078
(435) 789-1017 * FAX (435) 789-1813

LOCATION PHOTOS

11 **11** **10**
MONTH DAY YEAR

TAKEN BY: L.P.

DRAWN BY: Z.L.

REVISED: 00-00-00

PHOTO
P 1

EOG RESOURCES, INC.
SPRING #10-24H
LOCATED IN WELD COUNTY, COLORADO
SECTION 24, T10N, R67W, 6th P.M.

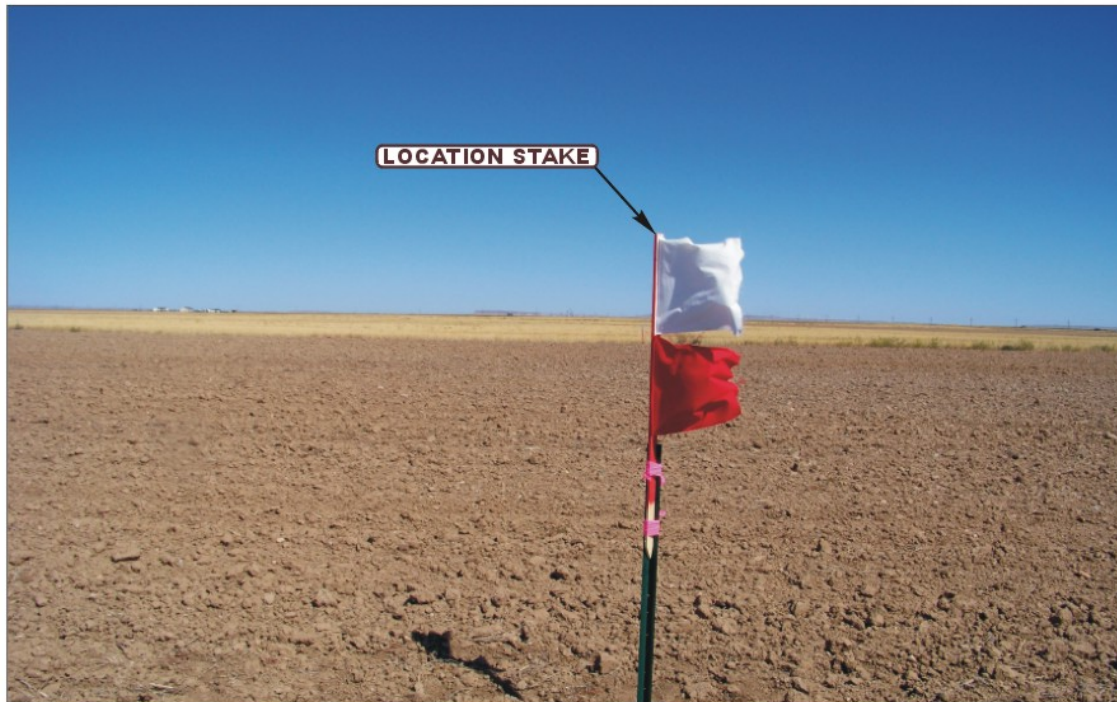

PHOTO: VIEW OF LOCATION STAKE

CAMERA ANGLE: NORTHERLY



PHOTO: VIEW OF LOCATION STAKE

CAMERA ANGLE: EASTERLY



UELS Uintah Engineering & Land Surveying
85 South 200 East Vernal, Utah 84078
435-789-1017 FAX (435) 789-1813

LOCATION PHOTOS

11 11 10
MONTH DAY YEAR

TAKEN BY: L.P.

DRAWN BY: Z.L.

REVISED: 00-00-00

PHOTO
P 2

EOG RESOURCES, INC.
SPRING #10-24H
LOCATED IN WELD COUNTY, COLORADO
SECTION 24, T10N, R67W, 6th P.M.



PHOTO: VIEW OF LOCATION STAKE

CAMERA ANGLE: SOUTHERLY



PHOTO: VIEW OF LOCATION STAKE

CAMERA ANGLE: WESTERLY



UELS

Uintah Engineering & Land Surveying
85 South 200 East Vernal, Utah 84078
435-789-1017 FAX (435) 789-1813

- Since 1964 -

LOCATION PHOTOS

11 **11** **10**
MONTH DAY YEAR

TAKEN BY: L.P.

DRAWN BY: Z.L.

REVISED: 00-00-00

PHOTO
P 3