

EOG RESOURCES, INC.

ADDENDUM TO LEGAL PLAT FOR

SPRING #10-24H

SECTION 24, T10N, R67W, 6th P.M.

501' FSL 2408' FWL



SCALE: 1" = 200'
DATE: 10-27-10
DRAWN BY: K.G.

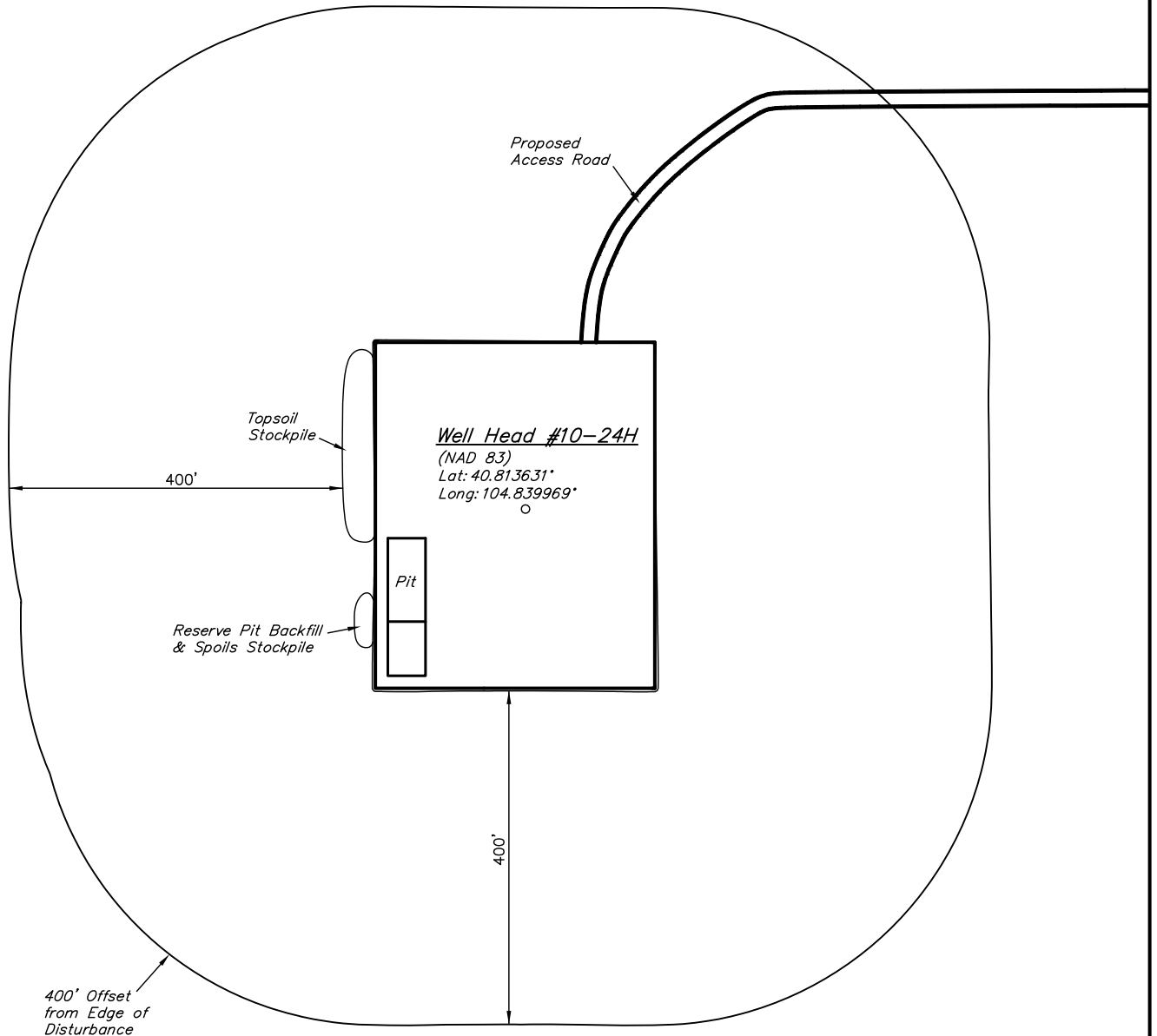

EOG RESOURCES, INC.

CONSTRUCTION LAYOUT FOR

SPRING #10-24H

SECTION 24, T10N, R67W, 6th P.M.

501' FSL 2408' FWL

FIGURE #1

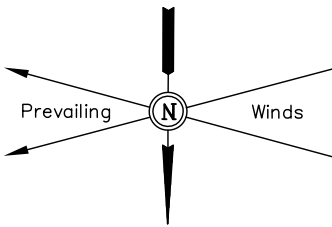

SCALE: 1" = 60'
DATE: 10-27-10
DRAWN BY: K.G.

Approx.
Toe of
Fill Slope

Proposed
Access Road

F-0.9'
El. 505.0'

6 F-2.0'
El. 503.9'

7 F-1.1'
El. 504.8'

Sta. 4+15

NOTE:
Flare Pit is to be
located a min. of 100'
from the Well Head.

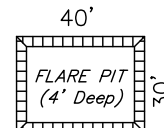

Cut/Fill
Transition Line

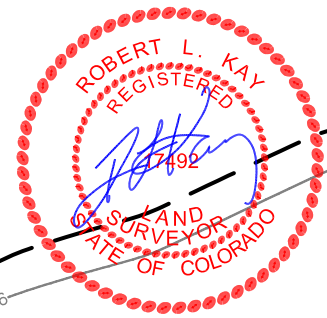

F-0.1'
El. 505.8'

C-3.4'
El. 506.3'
(Btm. Pit)

180'

155'

Sta. 2+15

C-0.4'
El. 506.3'

C-0.4'
El. 506.3'

C-0.9'
El. 506.8'

RESERVE PITS
(3' Deep)
1 1/2:1 Slope

Total Pit Capacity
= 3,380 Bbls.±
Total Pit Volume
= 700 Cu. Yds

Reserve Pit Backfill
& Spoils Stockpile

C-5.6'
El. 508.5'
(Btm. Pit)

C-2.2'
El. 508.1'

Sta. 1+00

N23°28'48"W - 4596.94'
(to Bottom Hole)

Sta. 0+00

C-2.5'
El. 508.4'

C-2.3'
El. 508.2'

C-2.8'
El. 508.7'

Approx.
Top of
Cut Slope

AREA OF MAX. DISTURBANCE

Elev. Ungraded Ground At Loc. Stake = 5506.3'
FINISHED GRADE ELEV. AT LOC. STAKE = 5505.9'

UINTAH ENGINEERING & LAND SURVEYING
85 So. 200 East * Vernal, Utah 84078 * (435) 789-1017

1" = 40'
X-Section
Scale
1" = 100'
DATE: 10-27-10
DRAWN BY: K.G.

EOG RESOURCES, INC.
CONSTRUCTION LAYOUT CROSS SECTIONS FOR
SPRING #10-24H
SECTION 24, T10N, R67W, 6th P.M.
501' FSL 2408' FWL

FIGURE #2

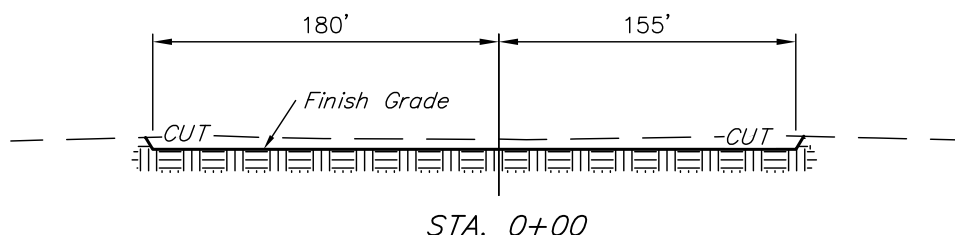
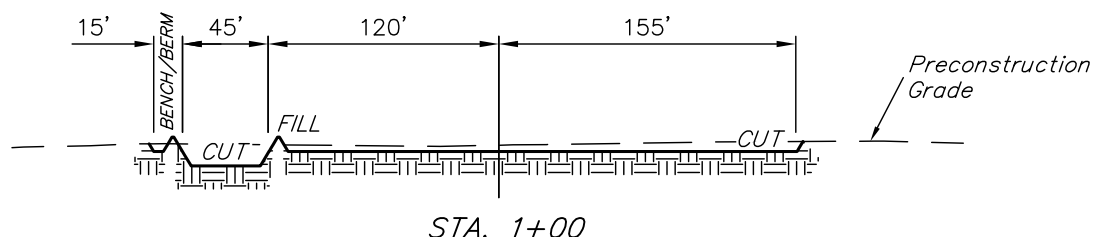
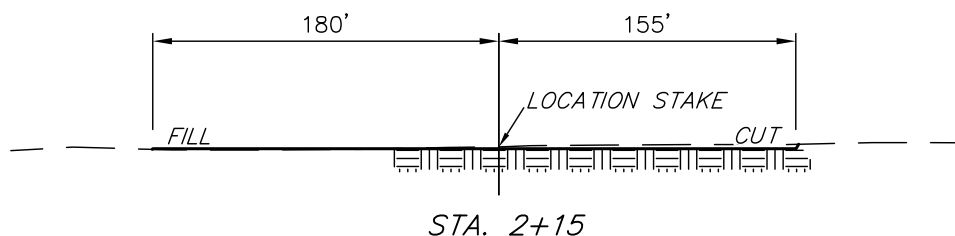
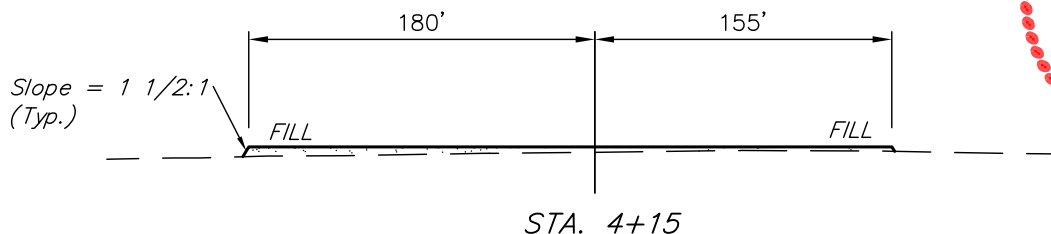

NOTE:

Topsoil should not be Stripped Below Finished Grade on Substructure Area.

APPROXIMATE ACREAGES
WELL SITE DISTURBANCE = ± 3.962 ACRES
ACCESS ROAD DISTURBANCE = ± 1.708 ACRES
TOTAL = ± 5.670 ACRES

* NOTE:
FILL QUANTITY INCLUDES 5% FOR COMPACTION

APPROXIMATE YARDAGES

(6") Topsoil Stripping = 2,680 Cu. Yds.
Remaining Location = 3,240 Cu. Yds.
TOTAL CUT = 5,920 CU.YDS.
FILL = 2,890 CU.YDS.

EXCESS MATERIAL = 3,030 Cu. Yds.
Topsoil & Pit Backfill (1/2 Pit Vol.) = 3,030 Cu. Yds.
EXCESS UNBALANCE (After Interim Rehabilitation) = 0 Cu. Yds.

UINTAH ENGINEERING & LAND SURVEYING
85 So. 200 East * Vernal, Utah 84078 * (435) 789-1017

EOG RESOURCES, INC.

TYPICAL RIG LAYOUT FOR

SPRING #10-24H

SECTION 24, T10N, R67W, 6th P.M.

501' FSL 2408' FWL

FIGURE #3



SCALE: 1" = 60'
DATE: 10-27-10
DRAWN BY: K.G.

Proposed
Access Road

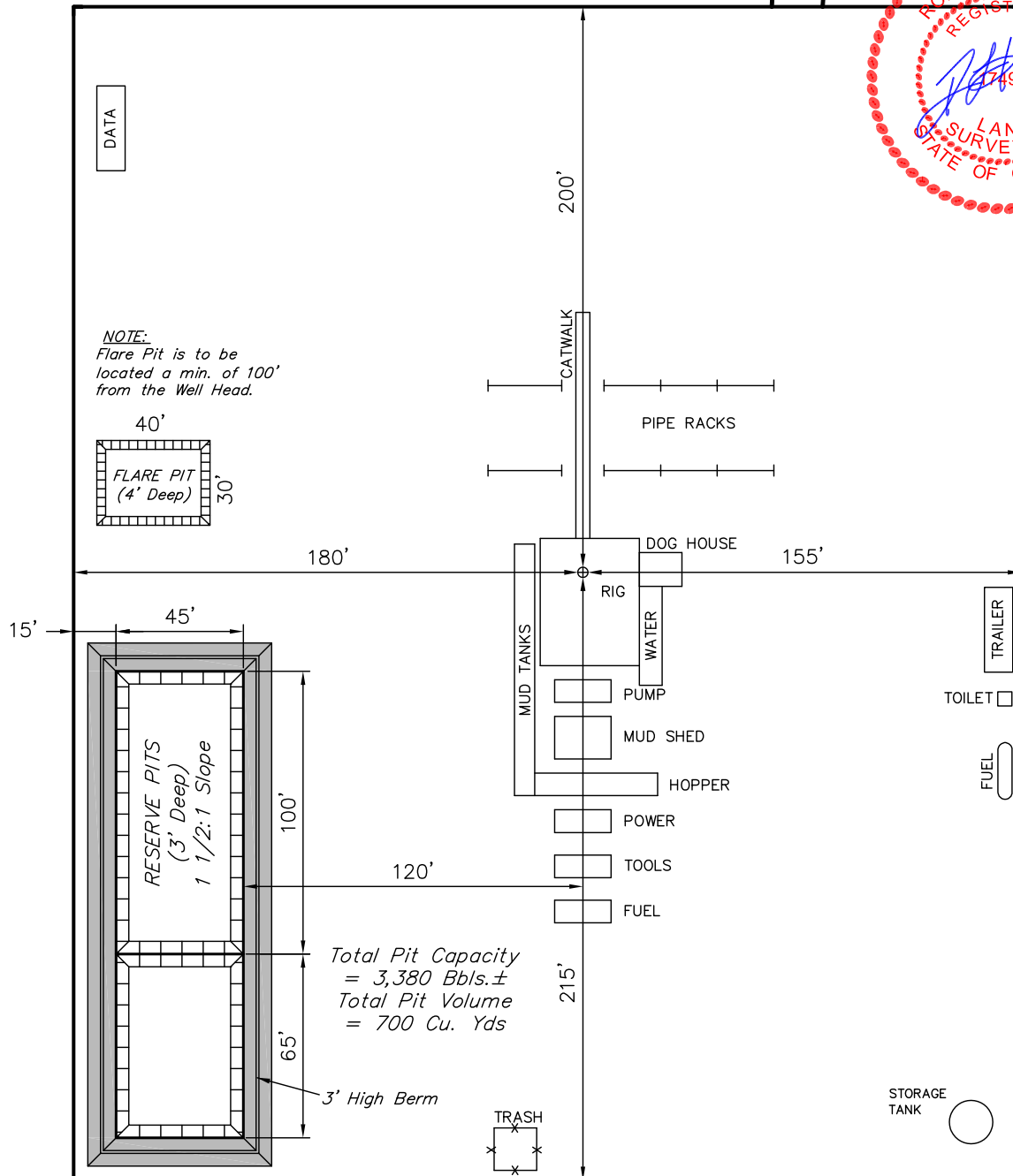
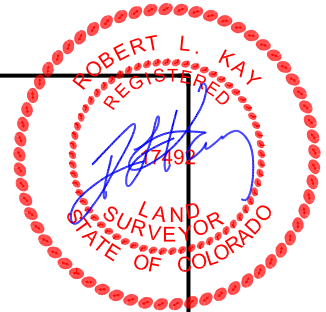



SCALE: 1" = 60'
DATE: 10-27-10
DRAWN BY: K.G.

EOG RESOURCES, INC.
RECLAMATION DIAGRAM FOR
SPRING #10-24H
SECTION 24, T10N, R67W, 6th P.M.
501' FSL 2408' FWL

FIGURE #4

Access Road

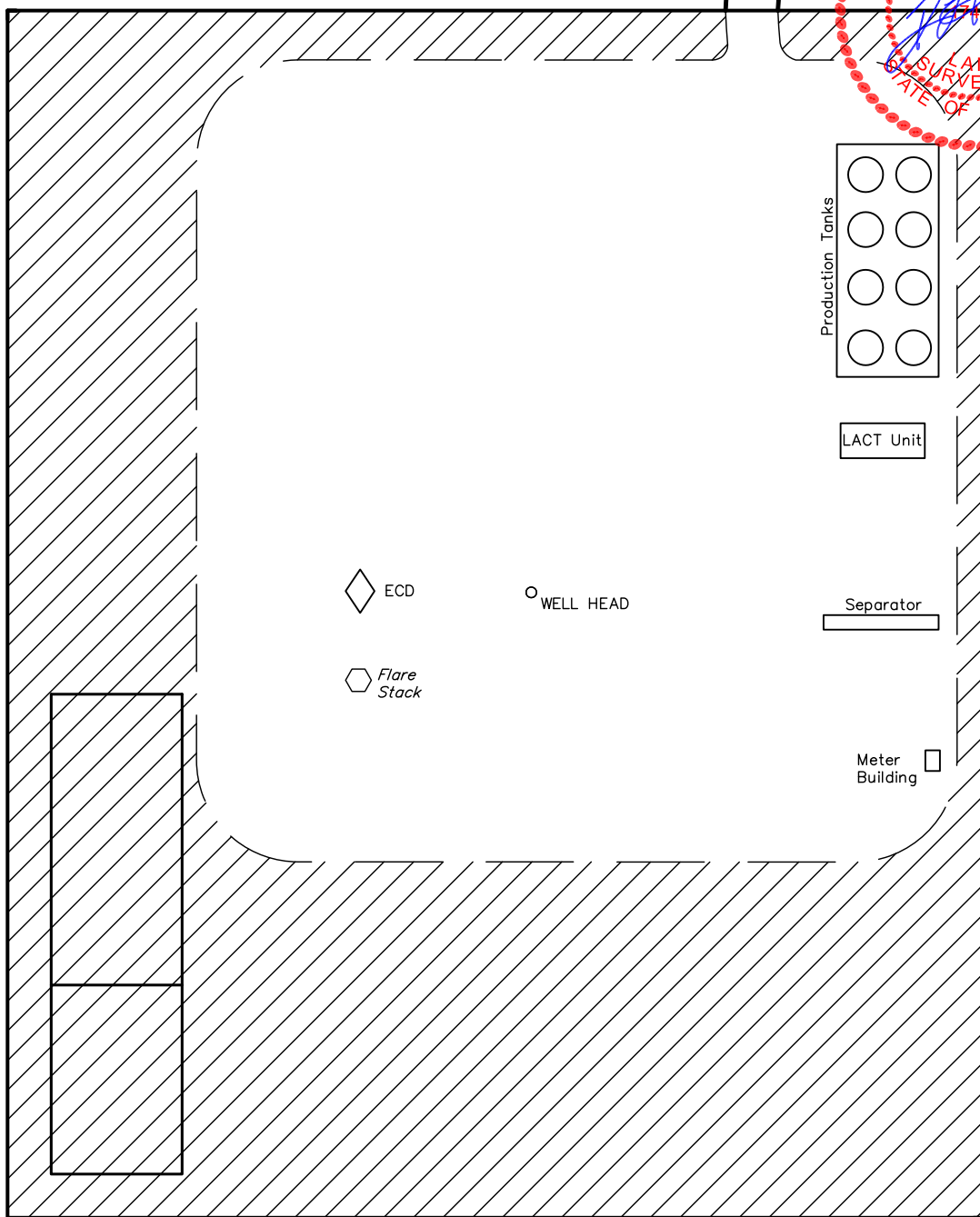
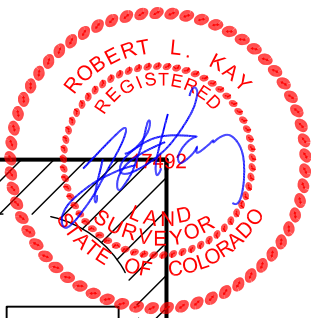

APPROXIMATE ACREAGES
UN-RECLAIMED = ± 1.638 ACRES



EOG RESOURCES, INC.

LOCATION DRAWING FOR

SPRING #10-24H
SECTION 24, T10N, R67W, 6th P.M.
501' FSL 2408' FWL

FIGURE #5

DATE: 10-28-10
DRAWN BY: K.G.

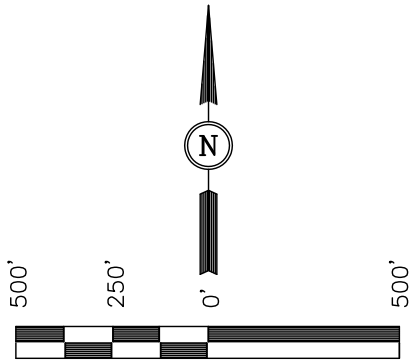

SCALE

Sec. 24

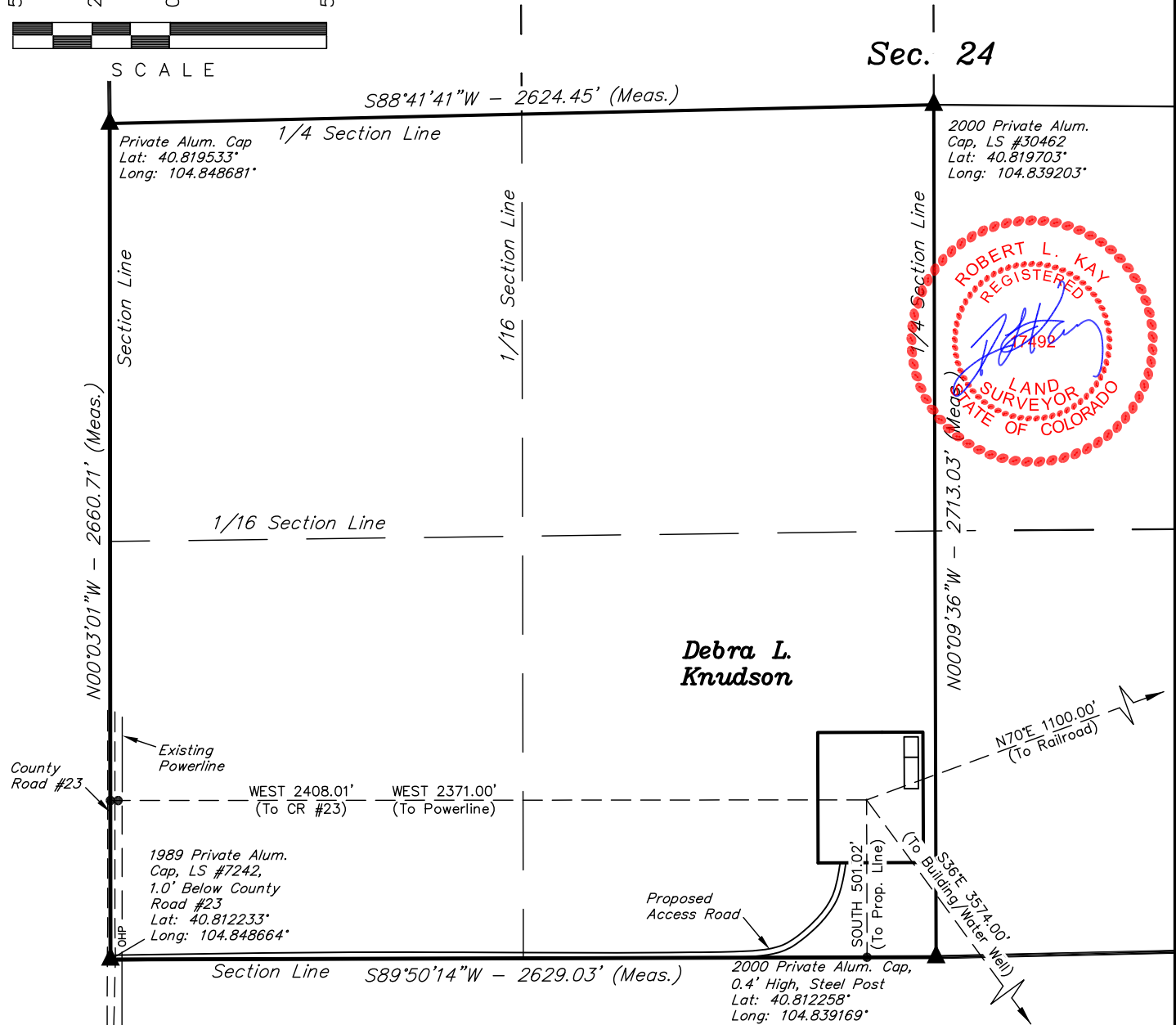

PLANT COMMUNITY

- ☐ DISTURBED GRASSLAND
- ☐ NATIVE GRASSLAND
- ☐ SHRUB LAND
- ☐ PLAINS RIPARIAN
- ☐ MOUNTAIN RIPARIAN
- ☐ FOREST LAND
- ☐ WETLANDS AQUATIC
- ☐ ALPINE
- ☐ OTHER (Describe): _____

CURRENT LAND USE

- | | | | | | |
|----------------|-------------------------------------|-------------------------------------|---|---|------------------------------|
| CROP LAND: | <input type="checkbox"/> IRRIGATED | <input type="checkbox"/> DRY LAND | <input type="checkbox"/> IMPROVED PASTURE | <input type="checkbox"/> HAY MEADOW | <input type="checkbox"/> CRP |
| NON-CROP LAND: | <input type="checkbox"/> RANGELAND | <input type="checkbox"/> TIMBER | <input type="checkbox"/> RECREATIONAL | <input type="checkbox"/> OTHER (Describe) | |
| SUBDIVIDED: | <input type="checkbox"/> INDUSTRIAL | <input type="checkbox"/> COMMERCIAL | <input type="checkbox"/> RESIDENTIAL | | |

FUTURE LAND USE

- | | | | | | |
|----------------|-------------------------------------|-------------------------------------|---|---|------------------------------|
| CROP LAND: | <input type="checkbox"/> IRRIGATED | <input type="checkbox"/> DRY LAND | <input type="checkbox"/> IMPROVED PASTURE | <input type="checkbox"/> HAY MEADOW | <input type="checkbox"/> CRP |
| NON-CROP LAND: | <input type="checkbox"/> RANGELAND | <input type="checkbox"/> TIMBER | <input type="checkbox"/> RECREATIONAL | <input type="checkbox"/> OTHER (Describe) | |
| SUBDIVIDED: | <input type="checkbox"/> INDUSTRIAL | <input type="checkbox"/> COMMERCIAL | <input type="checkbox"/> RESIDENTIAL | | |

UINTAH ENGINEERING & LAND SURVEYING
85 So. 200 East * Vernal, Utah 84078 * (435) 789-1017