

#### SURVEYORS CERTIFICATE:

This is to certify that this exhibit was prepared and location as shown was staked on the ground from actual surveys made by me or under my direct supervision.

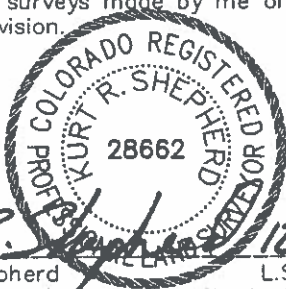

Kurt R. Shepherd  
On behalf of Del-Mont Consultants Inc.

#### LEGEND

- FOUND MONUMENT
- CALCULATED CORNER
- ◆ SURFACE WELL LOCATION
- BOTTOM HOLE LOCATION
- SHL - SURFACE HOLE LOCATION
- BHL - BOTTOM HOLE LOCATION

#### NOTES:

- 1) GPS OPERATOR A LEWIS OBSERVED A PDOP OF 1.272.
- 2) ALL GPS OBSERVATIONS ARE IN COMPLIANCE WITH COGCC RULE 215.
- 3) ALL DISTANCES ARE GRID DISTANCE IN U.S. SURVEY FEET. NAD83, COLORADO CENTRAL ZONE
- 4) THIS PLAT COMPLIES WITH COGCC RULE 303c
- 5) NO VISIBLE IMPROVEMENTS WITHIN 400' OF WELL HEAD.
- 6) VEGETATION: SCRUB OAK, ASPEN, NATIVE SHRUBS & GRASSES
- 7) BOTTOM HOLE COORDINATES SHOWN ON THIS PLAT PROVIDED BY OXY USA WTP LP

#### BASIS OF BEARINGS/DATUM

A GPS OBSERVATION FROM NGS PID AJ3463 (McCARY)

#### BASIS OF ELEVATIONS

A GPS OBSERVATION FROM NGS PID AJ3463 (McCARY). ELEVATION IS 5174.69'

#### DIMENSIONAL TIES

ALL DIMENSIONAL TIES TO SECTION LINES ARE MEASURED AT A 90° ANGLE TO THE SECTION LINE

#### ALIQUOT CALCULATIONS

THE ALIQUOT POINTS ALONG THE SOUTH LINE OF SECTION 17 REPRESENTED HEREON ARE BASED UPON PROPORTION CALCULATIONS. SEE NOTES ADJACENT TO THE POINT LOCATIONS.

DATE REVISED 2010-12-23

DEL-MONT CONSULTANTS IS PROVIDING GRADING DESIGN FOR THIS PROJECT THAT PROVIDES DIMENSIONS AND VOLUME INFORMATION FOR CONSTRUCTION.

<b>DMC</b> DEL-MONT CONSULTANTS, INC. ENGINEERING • SURVEYING • PLANNING 125 Colorado Ave. • Montrose, CO 81401 • (970) 249-2251 • (970) 249-7242 www.delmont-consultants.com • info@delmont-consultants.com	
DESIGNED BY	SCALE
MGW/SNS/KS	AS NOTED
CHECKED BY	FILE NAME
K. SHEPHERD	10080C_907-17B



**SECTION 17, T6S, R97W, 6TH PM**  
**WELL LOCATION PLAT**  
**CC 697-17-46B**  
**WELL PAD 697-17B**  
**GARFIELD COUNTY**  
**OXY USA WTP LP**

DMC JOB NO	10080
DATE ISSUED	2010-11-23
DATE SURVEYED	2008-11-06
PLAT	1 of 9