

EOG RESOURCES, INC.  
TREE CREEK #13-34H  
SECTION 34, T10N, R65W, 6<sup>th</sup> P.M.

PROCEED IN A SOUTHERLY DIRECTION FROM CHEYENNE, WYOMING ALONG HIGHWAY 85 APPROXIMATELY 26.6 MILES TO THE JUNCTION OF THIS ROAD AND CR 108 TO THE EAST; TURN LEFT AND PROCEED IN AN EASTERLY DIRECTION APPROXIMATELY 8.0 MILES TO THE JUNCTION OF THIS ROAD AND CR 45 TO THE NORTH; TURN LEFT AND PROCEED IN A NORTHERLY DIRECTION APPROXIMATELY 1.1 MILES TO THE BEGINNING OF THE PROPOSED ACCESS ROAD TO THE WEST; FOLLOW ROAD FLAGS IN A WESTERLY DIRECTION APPROXIMATELY 270' TO THE PROPOSED LOCATION.

TOTAL DISTANCE FROM CHEYENNE, WYOMING TO THE PROPOSED LOCATION IS APPROXIMATELY 35.8 MILES.

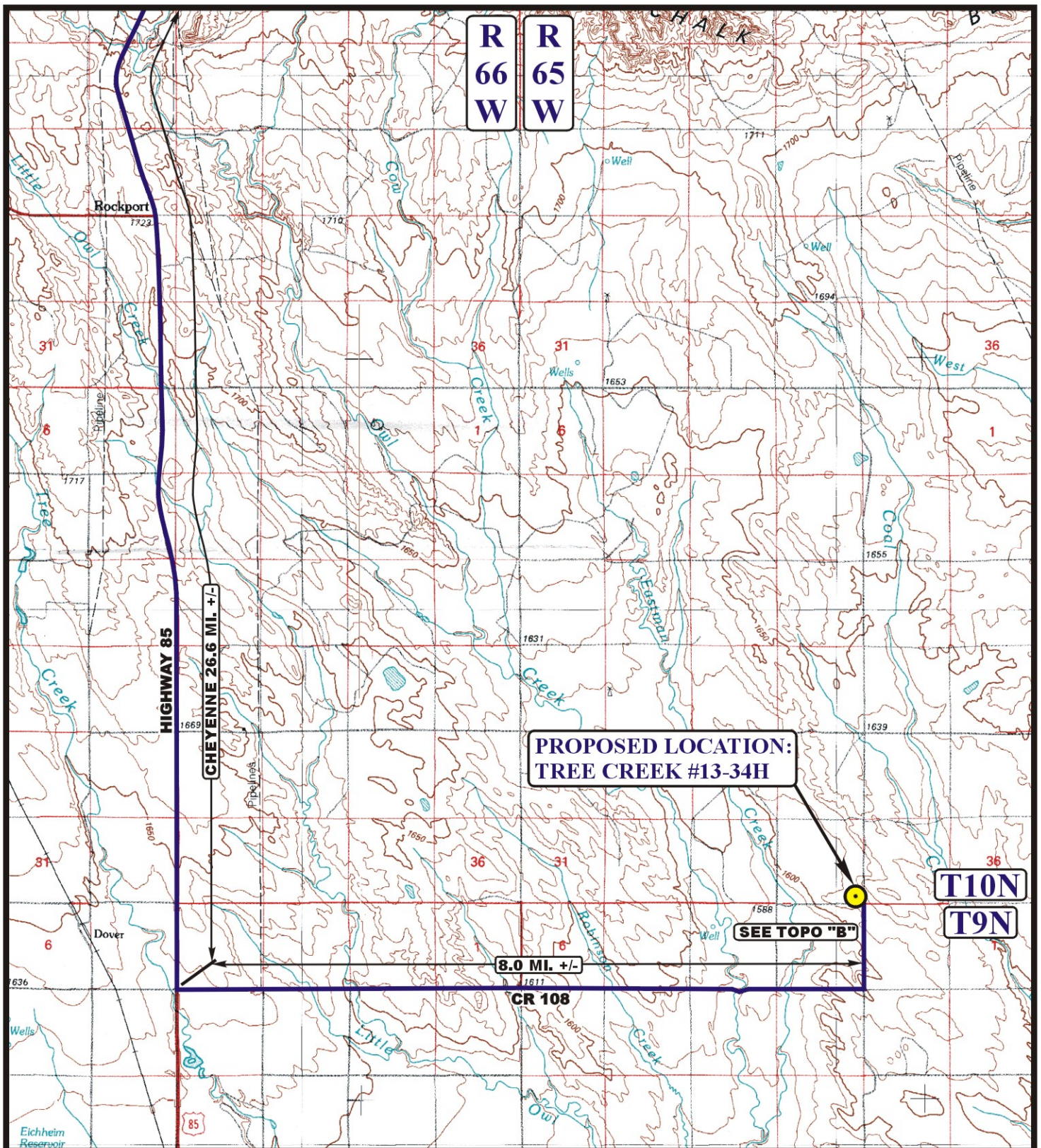

# **LEGEND:**

 PROPOSED LOCATION

**EOG RESOURCES, INC.**

**TREE CREEK #13-34H**  
**SECTION 34, T10N, R65W, 6th P.M.**  
**501' FSL 501' FEL**



**Uintah Engineering & Land Surveying**  
 85 South 200 East Vernal, Utah 84078  
 (435) 789-1017 \* FAX (435) 789-1813



**ACCESS ROAD**  
**MAP**

**11 10 10**  
 MONTH DAY YEAR

SCALE: 1:100,000 DRAWN BY: J.J. REVISED: 00-00-00

**A**  
**TOPO**



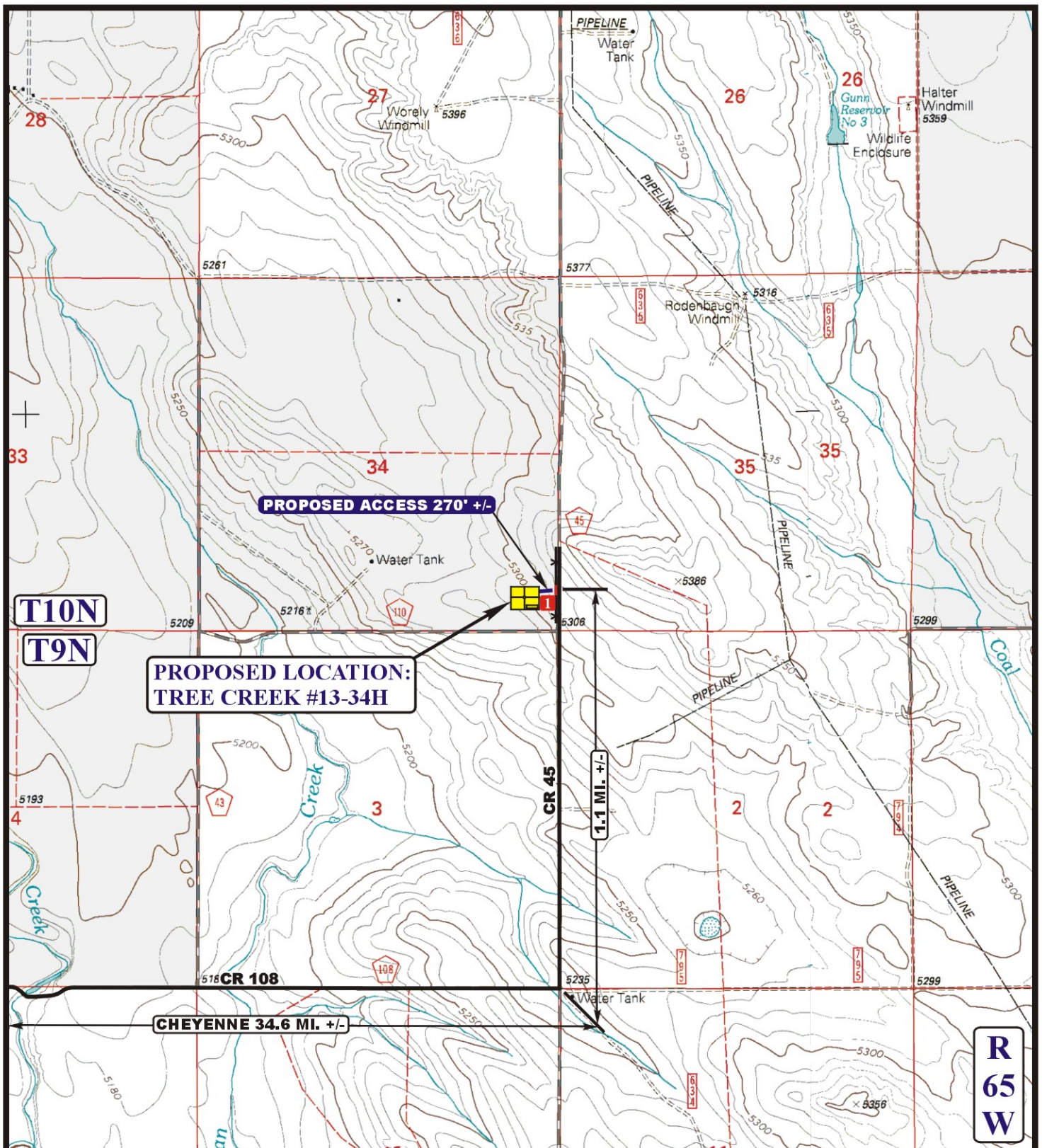

# LEGEND:

- EXISTING ROAD
- PROPOSED ACCESS ROAD
- EXISTING FENCE
- INSTALL CATTLEGUARD



**Uintah Engineering & Land Surveying**  
 85 South 200 East Vernal, Utah 84078  
 (435) 789-1017 \* FAX (435) 789-1813



# EOG RESOURCES, INC.

**TREE CREEK #13-34H**  
**SECTION 34, T10N, R65W, 6th P.M.**  
**501' FSL 501' FEL**

**ACCESS ROAD**  
**MAP**

**11** **10** **10**  
 MONTH DAY YEAR

SCALE: 1" = 2000' DRAWN BY: J.J. REVISED: 00-00-00

**B**  
**TOPO**