

EOG RESOURCES, INC.
TREE CREEK #13-34H
LOCATED IN WELD COUNTY, COLORADO
SECTION 34, T10N, R65W, 6th P.M.

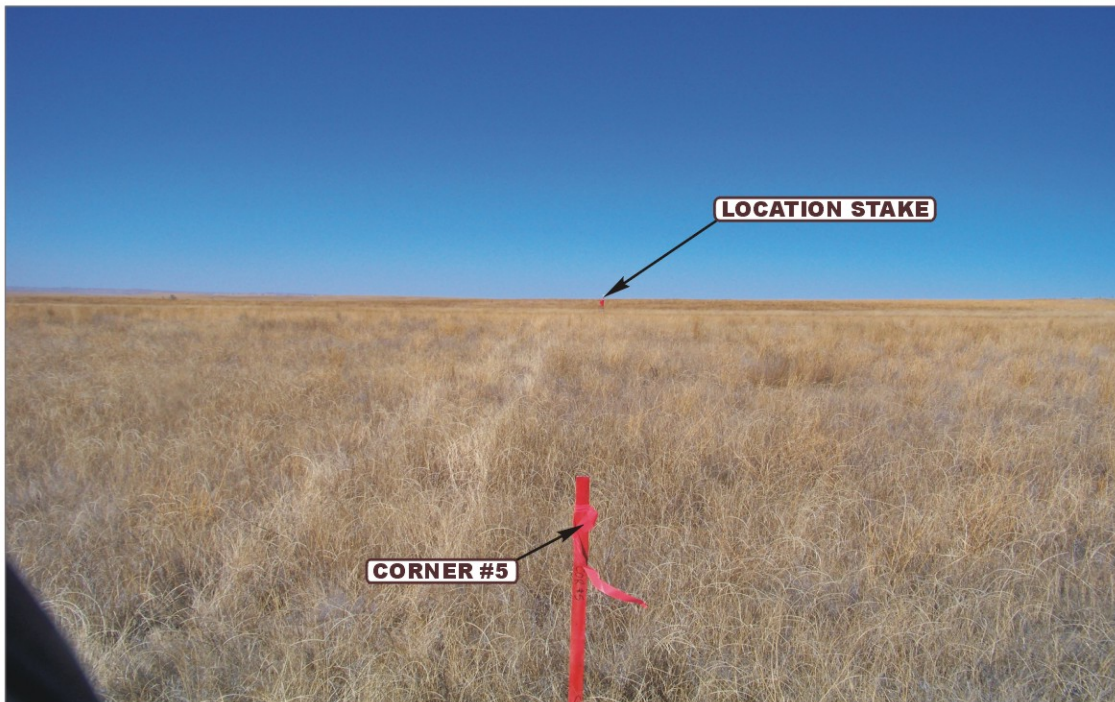

PHOTO: VIEW FROM CORNER #5 TO LOCATION STAKE

CAMERA ANGLE: NORTHERLY



PHOTO: VIEW FROM BEGINNING OF PROPOSED ACCESS

CAMERA ANGLE: WESTERLY



U E L S Uintah Engineering & Land Surveying
85 South 200 East Vernal, Utah 84078
(435) 789-1017 * FAX (435) 789-1813

LOCATION PHOTOS

11 10 10
MONTH DAY YEAR

TAKEN BY: L.P.

DRAWN BY: J.J.

REVISED: 00-00-00

PHOTO
P1

EOG RESOURCES, INC.
TREE CREEK #13-34H
LOCATED IN WELD COUNTY, COLORADO
SECTION 34, T10N, R65W, 6th P.M.

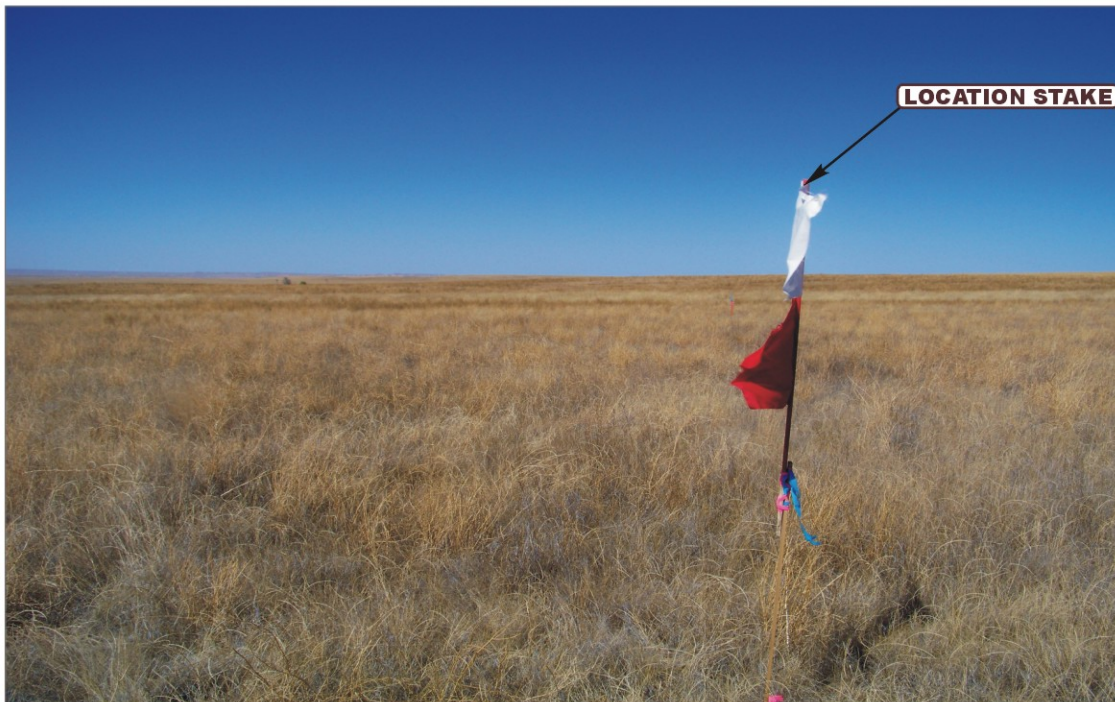

PHOTO: VIEW OF LOCATION STAKE

CAMERA ANGLE: NORTHERLY



PHOTO: VIEW OF LOCATION STAKE

CAMERA ANGLE: EASTERLY



- Since 1964 -

UELS

Uintah Engineering & Land Surveying
85 South 200 East Vernal, Utah 84078
(435) 789-1017 * FAX (435) 789-1813

LOCATION PHOTOS

11
MONTH

10
DAY

10
YEAR

TAKEN BY: L.P.

DRAWN BY: J.J.

REVISED: 00-00-00

PHOTO
P2

EOG RESOURCES, INC.
TREE CREEK #13-34H
LOCATED IN WELD COUNTY, COLORADO
SECTION 34, T10N, R65W, 6th P.M.

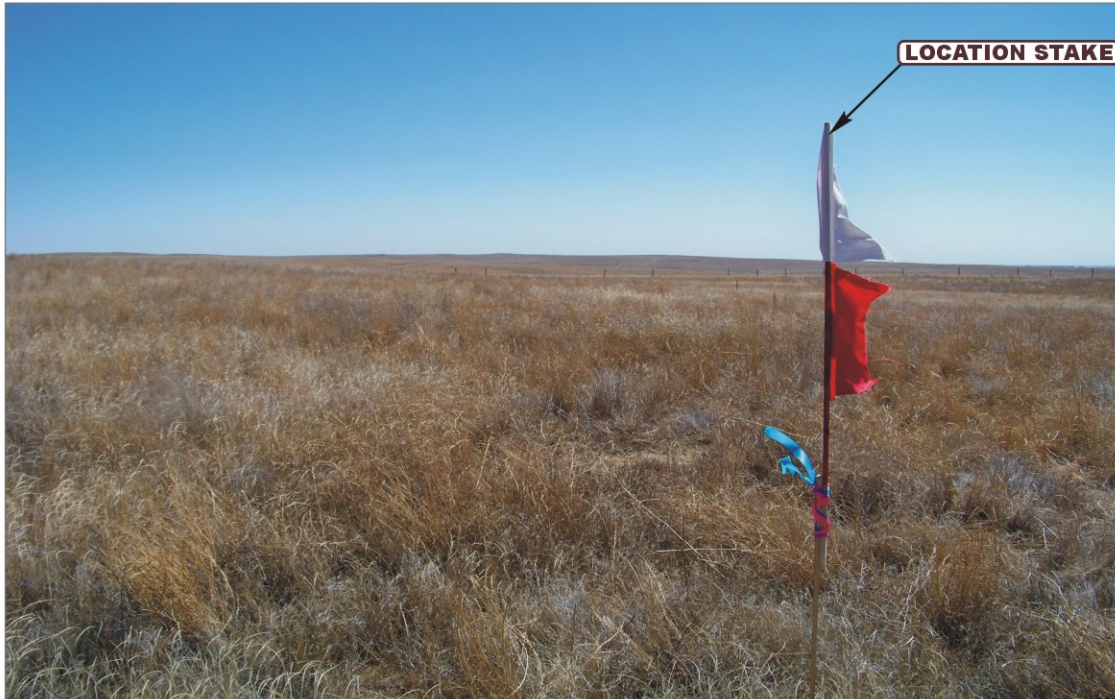

PHOTO: VIEW OF LOCATION STAKE

CAMERA ANGLE: SOUTHERLY



PHOTO: VIEW OF LOCATION STAKE

CAMERA ANGLE: WESTERLY



- Since 1964 -

UELS

Uintah Engineering & Land Surveying
85 South 200 East Vernal, Utah 84078
(435) 789-1017 * FAX (435) 789-1813

LOCATION PHOTOS

11
MONTH

10
DAY

10
YEAR

TAKEN BY: L.P.

DRAWN BY: J.J.

REVISED: 00-00-00

PHOTO
P3