

EOG RESOURCES, INC.
HEBRON #03-12H & MARR #04-12H
SECTION 12, T7N, R81W, 6th P.M.

PROCEED IN A WESTERLY DIRECTION FROM WALDEN, COLORADO ALONG HIGHWAY 125 APPROXIMATELY 1.2 MILES TO THE JUNCTION OF THIS ROAD AND STATE ROAD 14 TO THE WEST; TURN RIGHT AND PROCEED IN A WESTERLY, THEN SOUTHWESTERLY, THEN SOUTHERLY DIRECTION APPROXIMATELY 11.9 MILES TO THE JUNCTION OF THIS ROAD AND COUNTY ROAD 24 TO THE SOUTHWEST; TURN RIGHT AND PROCEED IN A SOUTHWESTERLY DIRECTION APPROXIMATELY 1.1 MILES TO THE BEGINNING OF THE PROPOSED ACCESS ROAD TO THE NORTHWEST; FOLLOW ROAD FLAGS IN A NORTHWESTERLY DIRECTION APPROXIMATELY 0.6 MILES TO THE PROPOSED LOCATION.

TOTAL DISTANCE FROM WALDEN, COLORADO TO THE PROPOSED WELL LOCATION IS APPROXIMATELY 14.8 MILES.

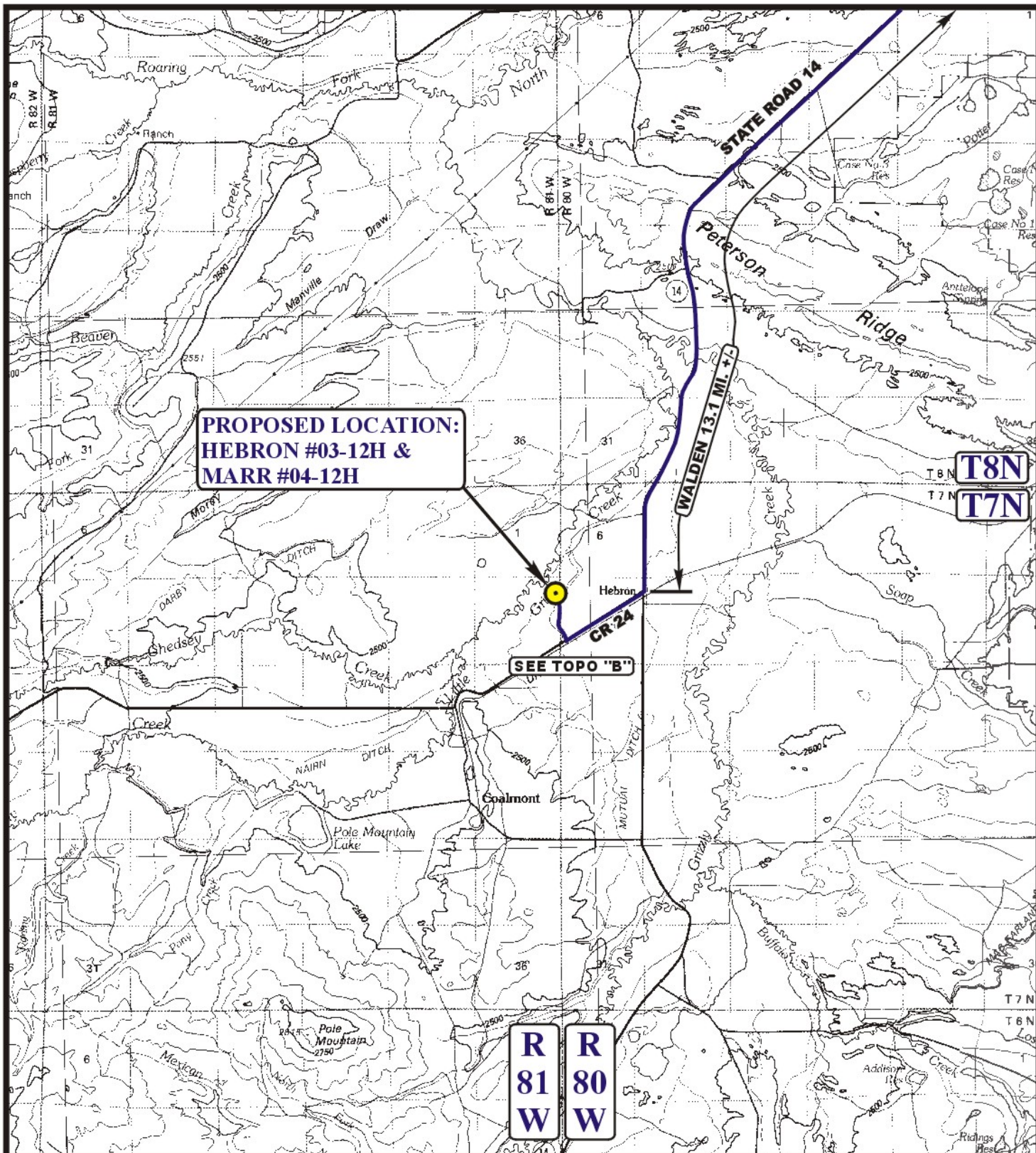

LEGEND:

 PROPOSED LOCATION

EOG RESOURCES, INC.

HEBRON #03-12H & MARR #04-12H
SECTION 12, T7N, R81W, 6th P.M.
NE 1/4 NE 1/4



Uintah Engineering & Land Surveying
85 South 200 East Vernal, Utah 84078
(435) 789-1017 * FAX (435) 789-1813



ACCESS ROAD
MAP

12 01 08
MONTH DAY YEAR

SCALE: 1:100,000 DRAWN BY: Z.L. REV: 01-08-09 C.C.

A
TOPO

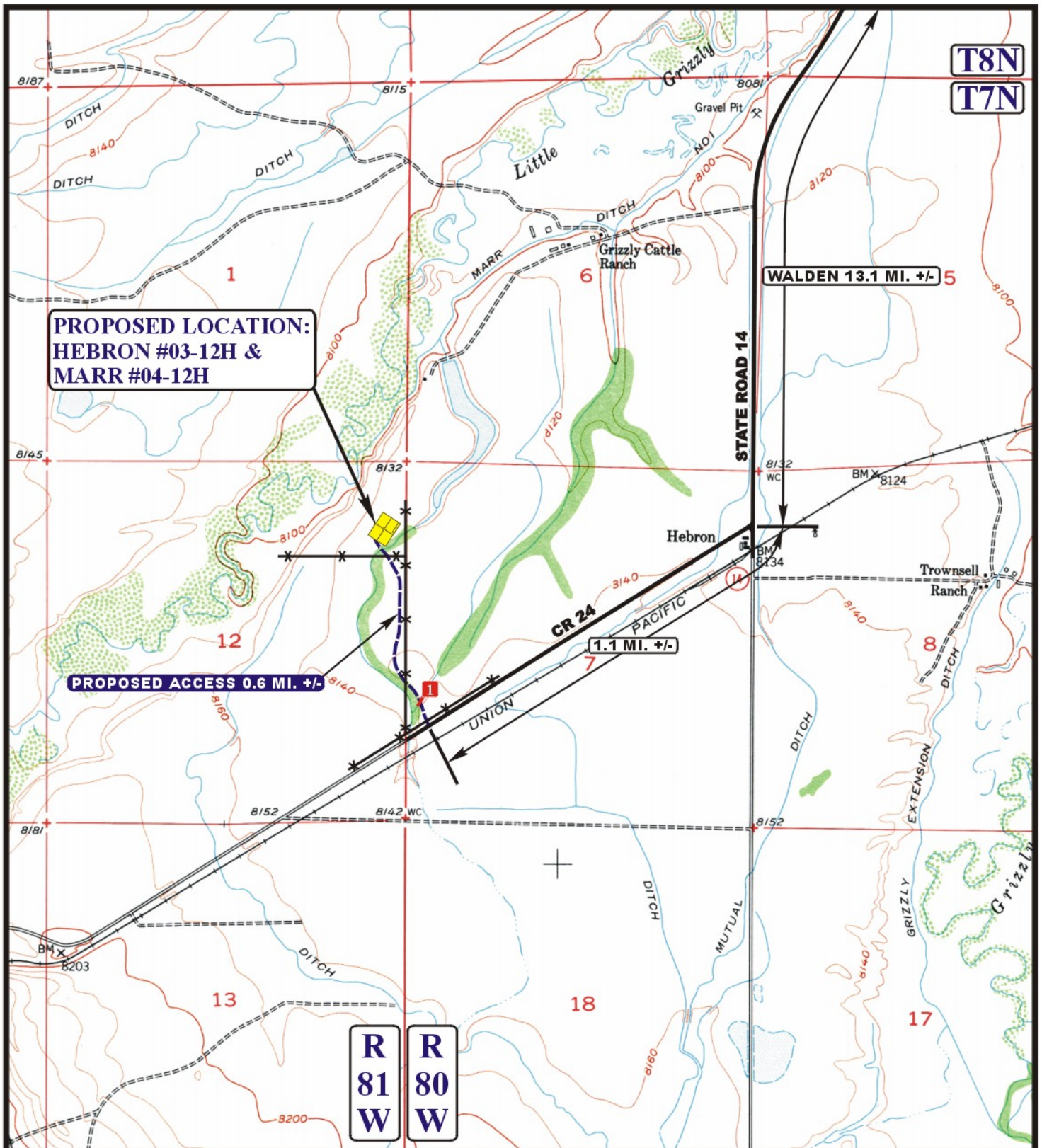

LEGEND:

| | |
|--|------------------------------|
| | EXISTING ROAD |
| | PROPOSED ACCESS ROAD |
| | RE-HABED ROAD NEEDS UPGRADED |
| | EXISTING FENCE |
| | 36" CMP REQUIRED |



Utah Engineering & Land Surveying
85 South 200 East Vernal, Utah 84078
(435) 789-1017 * FAX (435) 789-1813



EOG RESOURCES, INC.

HEBRON #03-12H & MARR #04-12H
SECTION 12, T7N, R81W, 6th P.M.
NE 1/4 NE 1/4

ACCESS ROAD
MAP

12 01 08
MONTH DAY YEAR

SCALE: 1" = 2000' DRAWN BY: Z.L. REV: 01-08-09 C.C.

B
TOPO