

SECTION A-A'

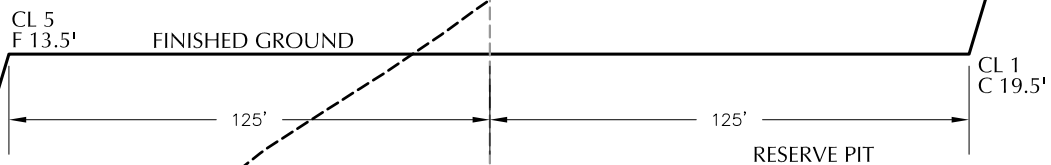

SECTION B-B'

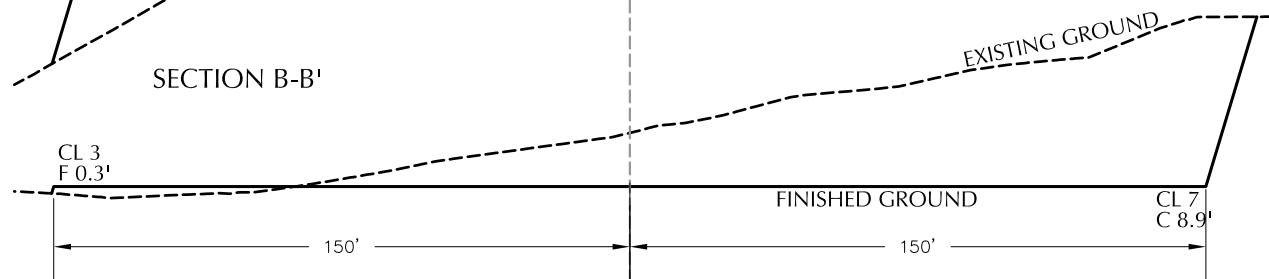

ENTEK GRB, LLC

BATTLE MOUNTAIN FEDERAL 14-10L
CROSS SECTIONS
1656' FSL, 888' FEL
NE $\frac{1}{4}$ SE $\frac{1}{4}$, SECTION 14,
T.12N., R.89W., 6th PM
MOFFAT COUNTY, COLORADO

CHOICE ENGINEERING SERVICES

404 "N" Street - Suite 201 | Rock Springs, WY 82901
Phone 307-362-6065 | Fax 307-362-6064

Scale: 1"=50' Date: 06/22/10

REVISION 3-ADD CUTTINGS PIT
DF - 8/20/10

SHEET NO:

3

BATTLE MOUNTAIN FEDERAL 14-10L

EXISTING GRADE @ CENTER OF WELL PAD = 6,6675.8'

FINISHED GRADE ELEVATION = 6,673.0'

CUT SLOPES = 1.5:1

FILL SLOPES = 1.5:1

TOTAL CUT FOR WELL PAD = 30,785 C.Y.

TOTAL FILL FOR WELL PAD = 10,689 C.Y.





TOPSOIL @ 6" DEPTH = 1,390 C.Y.

SHRINKAGE (10%) = 2,940 C.Y.

EXCESS MATERIAL = 15,766 C.Y.

TOTAL DISTURBANCE = +/- 3.6 AC. DISTURBANCE
INCLUDES ROAD, PAD, AND SOIL PILES.

WELL PAD LEGEND

-  PROPOSED WELL LOCATION
-  EXISTING CONTOURS (2' INTERVAL)
-  PROPOSED CONTOURS (2' INTERVAL)
-  ECF EROSION CONTROL FENCE
-  STORM WATER CONTROL DITCH

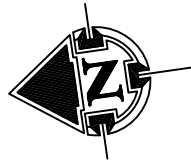

0 30 60
1" = 60'

ENTEK GRB, LLC

BATTLE MOUNTAIN FEDERAL 14-10L

PROPOSED RIG LAYOUT

1656' FSL, 888' FEL

NE $\frac{1}{4}$ SE $\frac{1}{4}$, SECTION 14,

T.12N., R.89W., 6th PM

MOFFAT COUNTY, COLORADO

CHOICE ENGINEERING SERVICES

404 "N" Street - Suite 201 | Rock Springs, WY 82901
Phone 307-362-6065 | Fax 307-362-6064

Scale: 1"=60' Date: 06/22/10

REVISION 3 - ADD CUTTINGS PIT
DF - 8/23/10

SHEET NO:

4

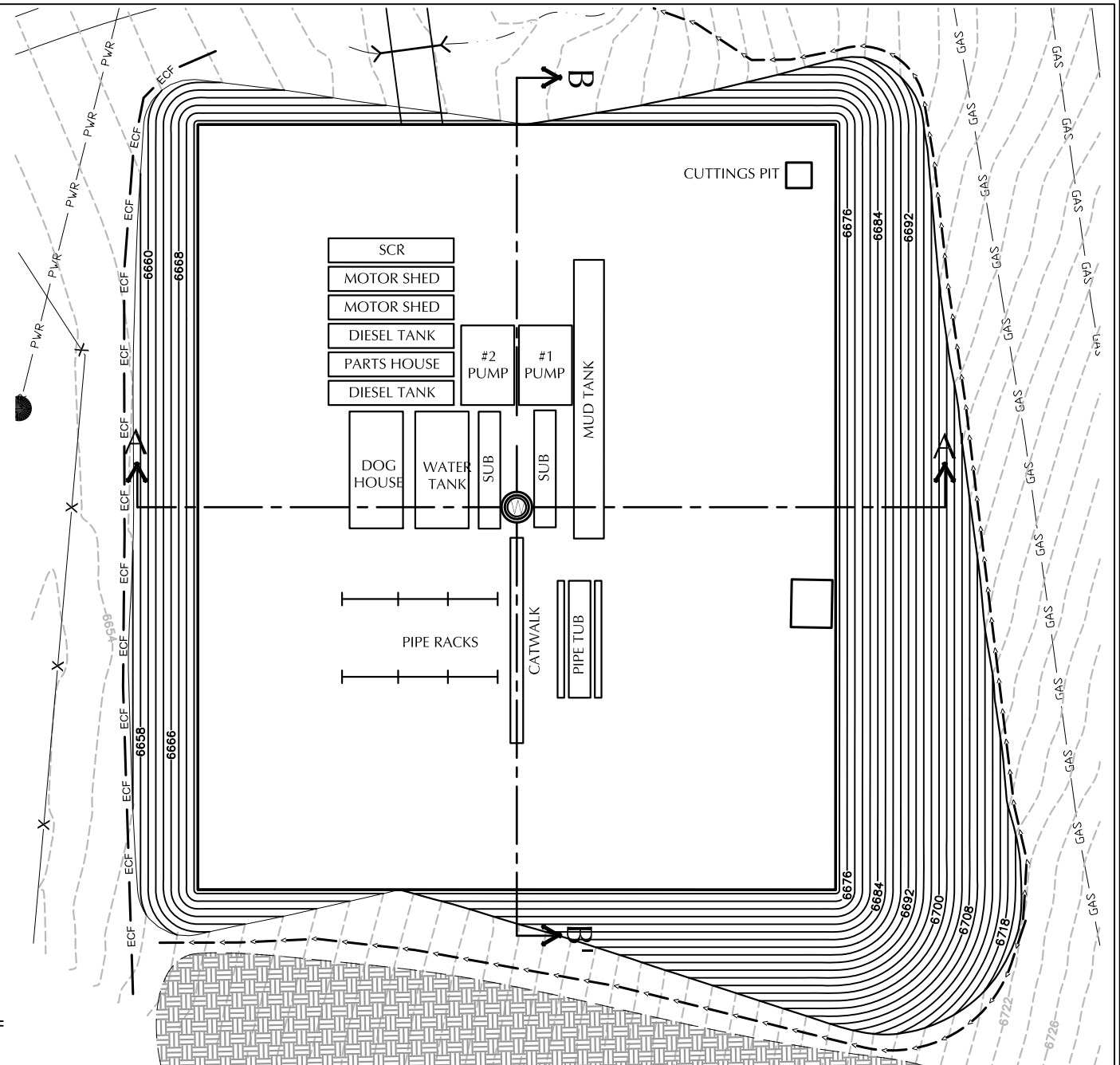

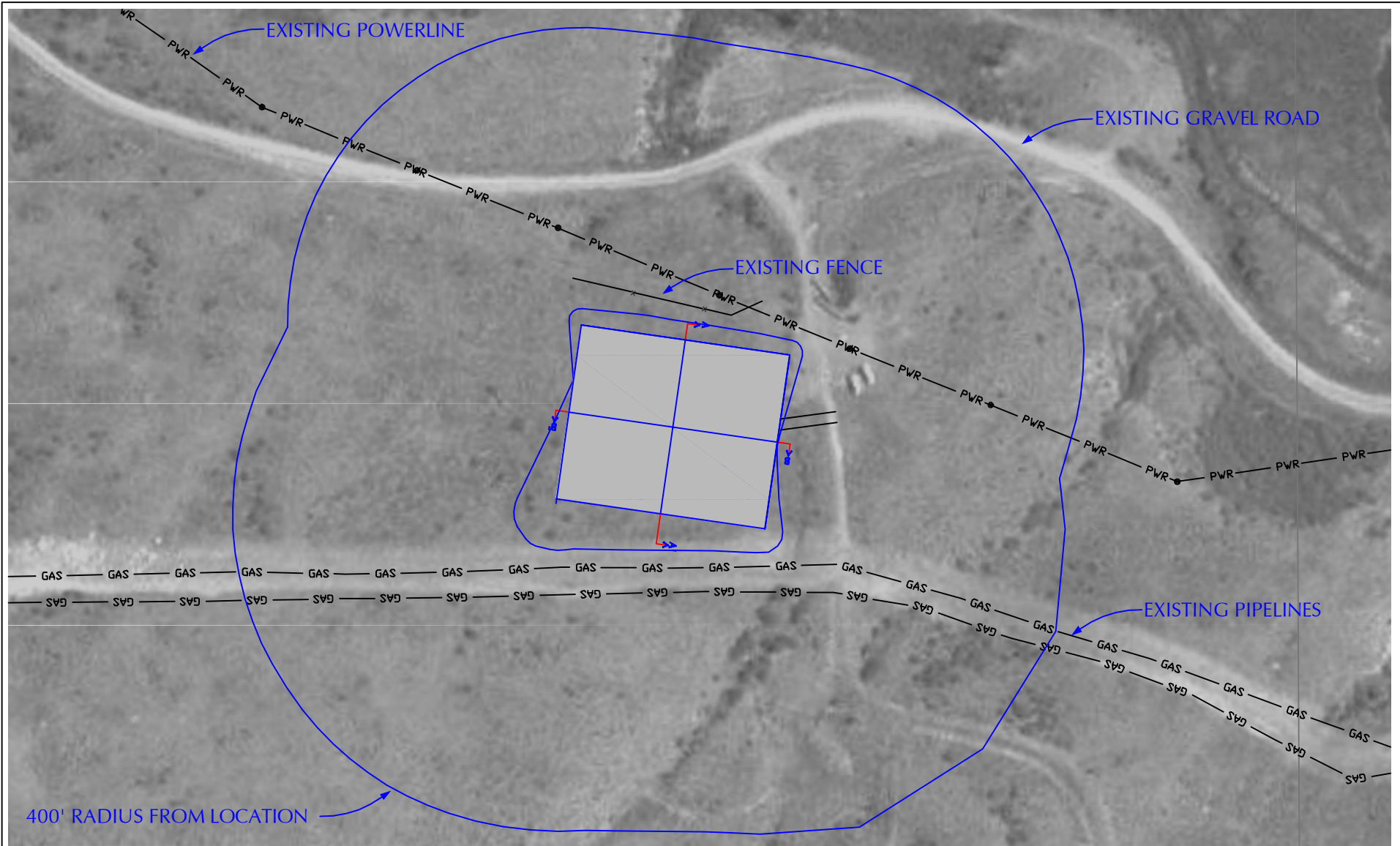

ENTEK GRB, LLC

BATTLE MOUNTAIN FEDERAL 14-10L
 400' IMPROVEMENTS MAP
 1656' FSL, 888' FEL
 NE $\frac{1}{4}$ SE $\frac{1}{4}$, SECTION 14,
 T.12N., R.89W., 6th PM
 MOFFAT COUNTY, COLORADO

CHOICE ENGINEERING SERVICES

404 "N" Street - Suite 201 | Rock Springs, WY 82901
 Phone 307-362-6065 | Fax 307-362-6064

Scale: 1"=200'

Date: 07/15/10

SHEET NO:

7

REVISION 3 - ADD CUTTINGS PIT
 DF - 8/23/10

