

EOG RESOURCES, INC.  
CHAULK BLUFFS #08-31H  
SECTION 31, T11N, R65W, 6<sup>th</sup> P.M.

PROCEED IN A SOUTHERLY DIRECTION FROM CHEYENNE, WYOMING ALONG HIGHWAY 85 APPROXIMATELY 19.5 MILES TO THE JUNCTION OF THIS ROAD AND CR 122 TO THE EAST; TURN LEFT AND PROCEED IN AN EASTERLY DIRECTION APPROXIMATELY 5.0 MILES TO THE BEGINNING OF THE PROPOSED ACCESS TO THE NORTH; FOLLOW ROAD FLAGS IN A NORTHERLY DIRECTION APPROXIMATELY 269' TO THE PROPOSED LOCATION.

TOTAL DISTANCE FROM CHEYENNE, WYOMING TO THE PROPOSED LOCATION IS APPROXIMATELY 24.5 MILES.

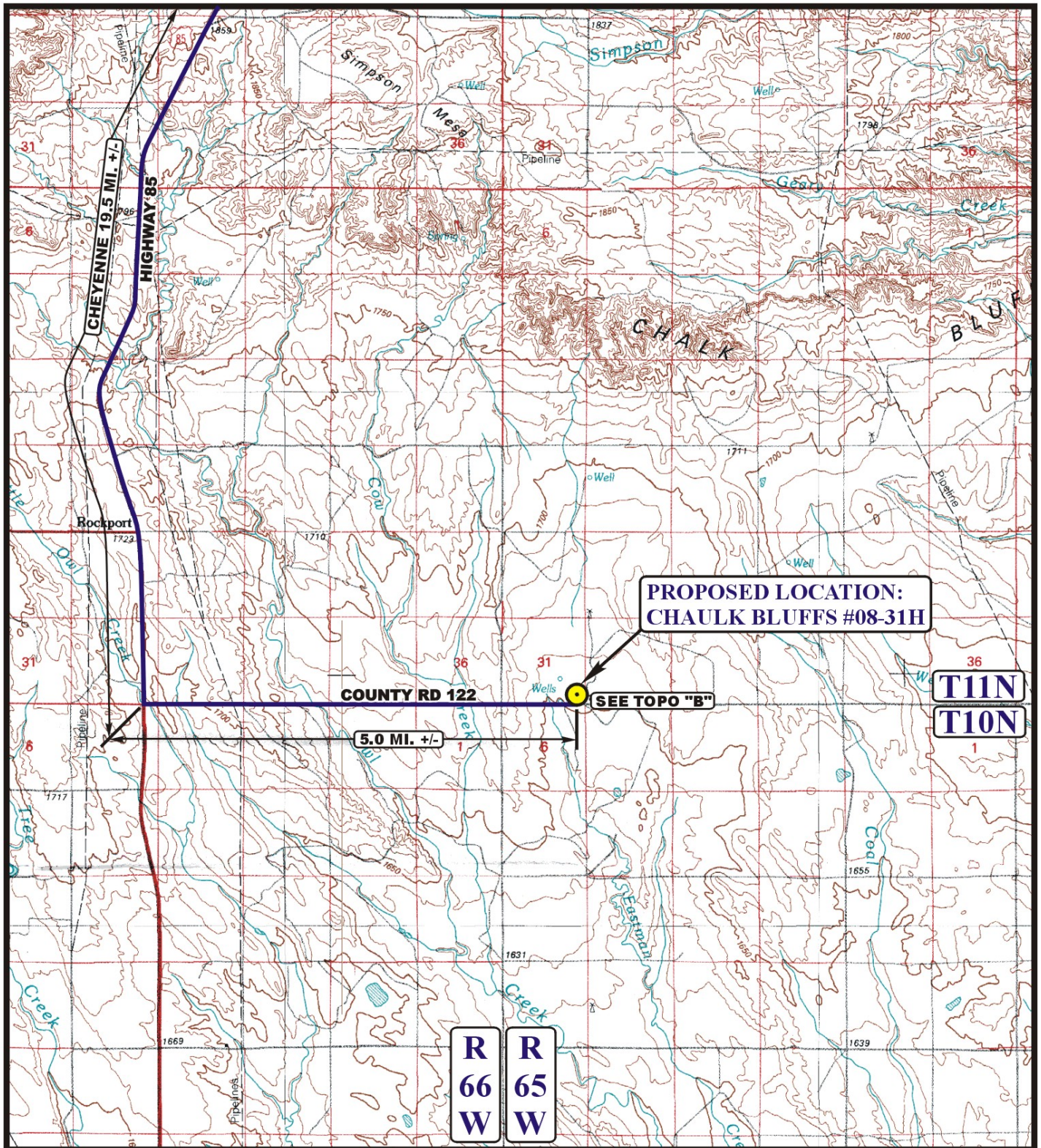



# LEGEND:

PROPOSED LOCATION

EOG RESOURCES, INC.

CHALK BLUFFS #08-31H  
 SECTION 31, T11N, R65W, 6th P.M.  
 501' FSL 501' FEL



Utah Engineering & Land Surveying  
 85 South 200 East Vernal, Utah 84078  
 (435) 789-1017 \* FAX (435) 789-1813



ACCESS ROAD  
 MAP

10 19 10  
 MONTH DAY YEAR

SCALE: 1:100,000

DRAWN BY: J.J.

REVISED: 00-00-00





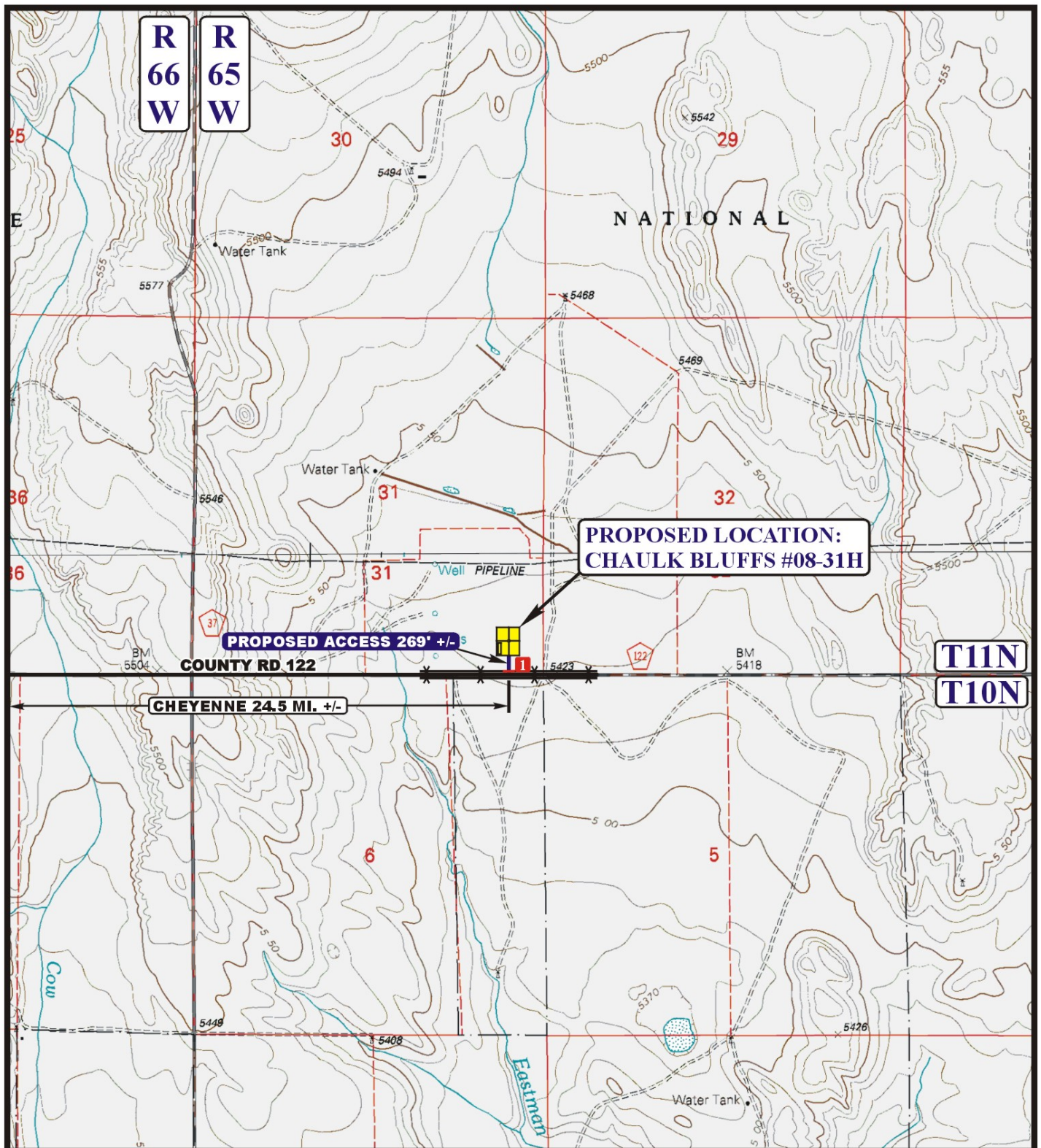

# LEGEND:

- EXISTING ROAD
- PROPOSED ACCESS ROAD
- EXISTING FENCE
- INSTALL CATTLEGUARD



**Uintah Engineering & Land Surveying**  
 85 South 200 East Vernal, Utah 84078  
 (435) 789-1017 \* FAX (435) 789-1813



# EOG RESOURCES, INC.

**CHAULK BLUFFS #08-31H**  
**SECTION 31, T11N, R65W, 6th P.M.**  
**501' FSL 501' FEL**

**ACCESS ROAD**  
**MAP**

**10** **19** **10**  
 MONTH DAY YEAR

SCALE: 1" = 2000'

DRAWN BY: J.J.

REVISED: 00-00-00

**B**  
**TOPO**