

Fiscus Mesa 01-02H
Section 2 T9N R58W
Weld County, CO

Surface Location

NAD 1927 (NADCON CONUS) Colorado North 501
 Ground Elevation: 4663.00RIG @ 4685.00ft (TBD)
 Northing Easting Latitude Longitude
 529469.10 2464473.80 40° 46' 29.089 N 103° 49' 22.681 W

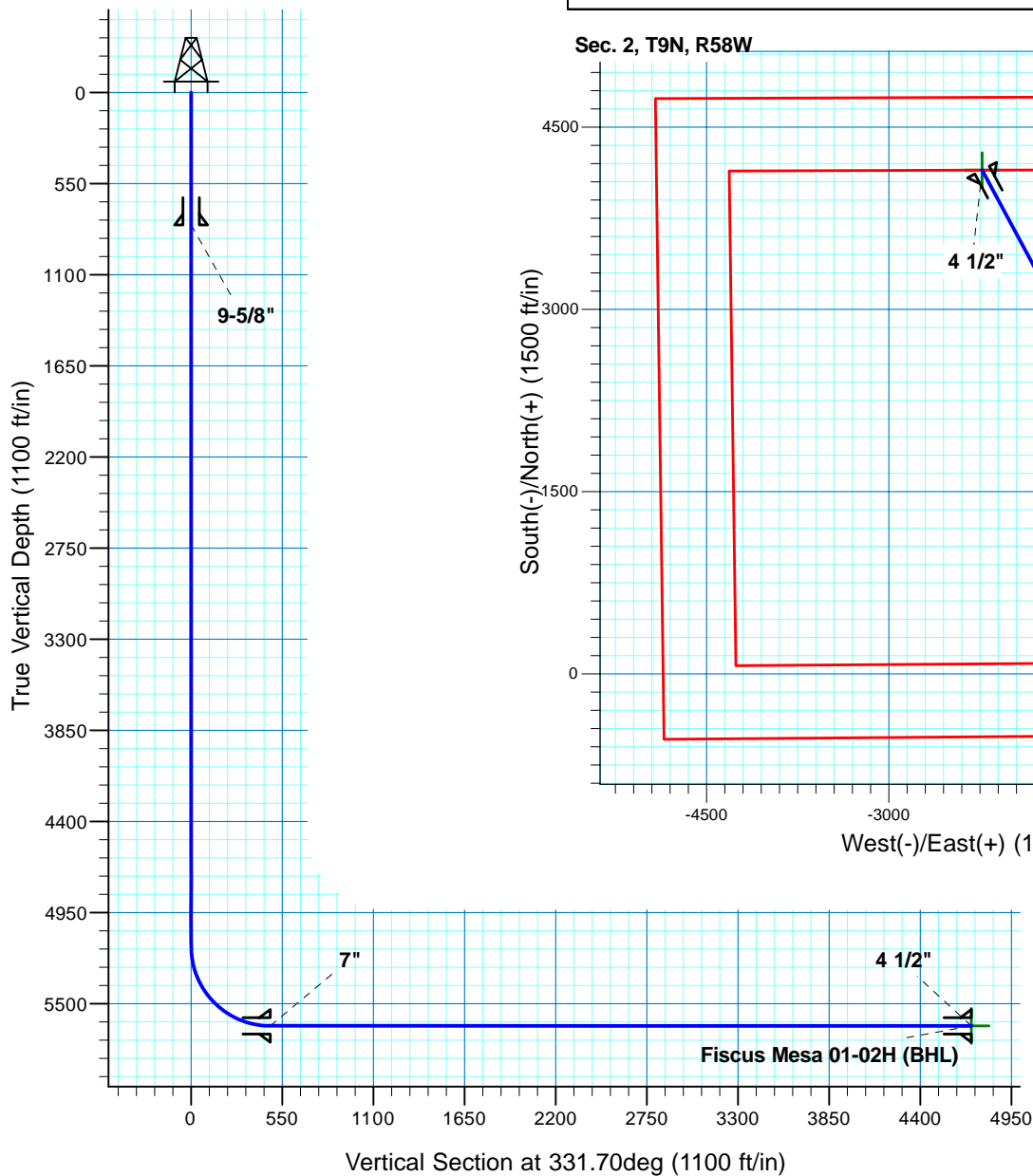

T M
 Azimuths to True North
 Magnetic North: 8.40°
 Magnetic Field
 Strength: 53498.7nT
 Dip Angle: 67.53°
 Date: 12/9/2010
 Model: IGRF200510

Project: DJ - Hereford Ranch
 Site: Fiscus Mesa 01-02H
 Well: Fiscus Mesa 01-02H
 Plan: APD Directional Plan

SECTION DETAILS

Sec	MD	Inc	Azi	TVD	+N/-S	+E/-W	DLeg	TFace	VSec	Target
1	0.00	0.00	0.00	0.00	0.00	0.00	0.00	0.00	0.00	
2	5156.53	0.00	0.00	5156.53	0.00	0.00	0.00	0.00	0.00	
3	5906.54	90.00	331.70	5634.00	420.39	-226.38	12.00	331.70	477.47	
4	10137.37	90.00	331.70	5634.00	4145.45	-2232.35	0.00	0.00	4708.30	Fiscus Mesa 01-02H (BHL)

TARGET DETAILS

Name	TVD	+N/-S	+E/-W	Northing	Easting	Latitude	Longitude	Shape Point
Fiscus Mesa 01-02H (BHL)	5634.00	4145.45	-2232.35	533571.59	2462163.47	40° 47' 10.050 N	103° 49' 51.701 W	

Denver Division- Colorado

DJ - Hereford Ranch

Fiscus Mesa 01-02H

Fiscus Mesa 01-02H

Original Wellbore

Plan: APD Directional Plan

Standard Planning Report

10 December, 2010

EOG Resources Inc

Planning Report

Database:	EDM	Local Co-ordinate Reference:	Site Fiscus Mesa 01-02H
Company:	Denver Division- Colorado	TVD Reference:	RIG @ 4685.00ft (TBD)
Project:	DJ - Hereford Ranch	MD Reference:	RIG @ 4685.00ft (TBD)
Site:	Fiscus Mesa 01-02H	North Reference:	True
Well:	Fiscus Mesa 01-02H	Survey Calculation Method:	Minimum Curvature
Wellbore:	Original Wellbore		
Design:	APD Directional Plan		

Project	DJ - Hereford Ranch, Weld County		
Map System:	US State Plane 1927 (Exact solution)	System Datum:	Mean Sea Level
Geo Datum:	NAD 1927 (NADCON CONUS)		
Map Zone:	Colorado North 501		

Site		Fiscus Mesa 01-02H			
Site Position:		Northing:	529,469.10ft	Latitude:	40° 46' 29.089 N
From:	Lat/Long	Easting:	2,464,473.80ft	Longitude:	103° 49' 22.681 W
Position Uncertainty:	0.00 ft	Slot Radius:	"	Grid Convergence:	1.08 deg

Well	Fiscus Mesa 01-02H					
Well Position	+N/-S	0.00 ft	Northing:	529,469.10 ft	Latitude:	40° 46' 29.089 N
	+E/-W	0.00 ft	Easting:	2,464,473.80 ft	Longitude:	103° 49' 22.681 W
Position Uncertainty		0.00 ft	Wellhead Elevation:	ft	Ground Level:	4,663.00 ft

Wellbore	Original Wellbore				
Magnetics	Model Name	Sample Date	Declination (deg)	Dip Angle (deg)	Field Strength (nT)
	IGRF200510	12/9/2010	8.40	67.53	53,499

Design	APD Directional Plan			
Audit Notes:				
Version:	Phase:	PROTOTYPE	Tie On Depth:	0.00
Vertical Section:	Depth From (TVD) (ft)	+N/-S (ft)	+E/-W (ft)	Direction (deg)
	0.00	0.00	0.00	331.70

Plan Sections										
Measured Depth (ft)	Inclination (deg)	Azimuth (deg)	Vertical Depth (ft)	+N/-S (ft)	+E/-W (ft)	Dogleg Rate (?/100ft)	Build Rate (?/100ft)	Turn Rate (?/100ft)	TFO (deg)	Target
0.00	0.00	0.00	0.00	0.00	0.00	0.00	0.00	0.00	0.00	
5,156.53	0.00	0.00	5,156.53	0.00	0.00	0.00	0.00	0.00	0.00	
5,906.54	90.00	331.70	5,634.00	420.39	-226.38	12.00	12.00	0.00	331.70	
10,137.37	90.00	331.70	5,634.00	4,145.45	-2,232.35	0.00	0.00	0.00	0.00	Fiscus Mesa 01-02I

EOG Resources Inc

Planning Report

Database:	EDM	Local Co-ordinate Reference:	Site Fiscus Mesa 01-02H
Company:	Denver Division- Colorado	TVD Reference:	RIG @ 4685.00ft (TBD)
Project:	DJ - Hereford Ranch	MD Reference:	RIG @ 4685.00ft (TBD)
Site:	Fiscus Mesa 01-02H	North Reference:	True
Well:	Fiscus Mesa 01-02H	Survey Calculation Method:	Minimum Curvature
Wellbore:	Original Wellbore		
Design:	APD Directional Plan		

Planned Survey

Measured Depth (ft)	Inclination (deg)	Azimuth (deg)	Vertical Depth (ft)	+N/-S (ft)	+E/-W (ft)	Vertical Section (ft)	Dogleg Rate (?/100ft)	Build Rate (?/100ft)	Turn Rate (?/100ft)
0.00	0.00	0.00	0.00	0.00	0.00	0.00	0.00	0.00	0.00
100.00	0.00	0.00	100.00	0.00	0.00	0.00	0.00	0.00	0.00
200.00	0.00	0.00	200.00	0.00	0.00	0.00	0.00	0.00	0.00
300.00	0.00	0.00	300.00	0.00	0.00	0.00	0.00	0.00	0.00
400.00	0.00	0.00	400.00	0.00	0.00	0.00	0.00	0.00	0.00
500.00	0.00	0.00	500.00	0.00	0.00	0.00	0.00	0.00	0.00
600.00	0.00	0.00	600.00	0.00	0.00	0.00	0.00	0.00	0.00
700.00	0.00	0.00	700.00	0.00	0.00	0.00	0.00	0.00	0.00
800.00	0.00	0.00	800.00	0.00	0.00	0.00	0.00	0.00	0.00
9-5/8"									
900.00	0.00	0.00	900.00	0.00	0.00	0.00	0.00	0.00	0.00
1,000.00	0.00	0.00	1,000.00	0.00	0.00	0.00	0.00	0.00	0.00
1,100.00	0.00	0.00	1,100.00	0.00	0.00	0.00	0.00	0.00	0.00
1,200.00	0.00	0.00	1,200.00	0.00	0.00	0.00	0.00	0.00	0.00
1,300.00	0.00	0.00	1,300.00	0.00	0.00	0.00	0.00	0.00	0.00
1,400.00	0.00	0.00	1,400.00	0.00	0.00	0.00	0.00	0.00	0.00
1,500.00	0.00	0.00	1,500.00	0.00	0.00	0.00	0.00	0.00	0.00
1,600.00	0.00	0.00	1,600.00	0.00	0.00	0.00	0.00	0.00	0.00
1,700.00	0.00	0.00	1,700.00	0.00	0.00	0.00	0.00	0.00	0.00
1,800.00	0.00	0.00	1,800.00	0.00	0.00	0.00	0.00	0.00	0.00
1,900.00	0.00	0.00	1,900.00	0.00	0.00	0.00	0.00	0.00	0.00
2,000.00	0.00	0.00	2,000.00	0.00	0.00	0.00	0.00	0.00	0.00
2,100.00	0.00	0.00	2,100.00	0.00	0.00	0.00	0.00	0.00	0.00
2,200.00	0.00	0.00	2,200.00	0.00	0.00	0.00	0.00	0.00	0.00
2,300.00	0.00	0.00	2,300.00	0.00	0.00	0.00	0.00	0.00	0.00
2,400.00	0.00	0.00	2,400.00	0.00	0.00	0.00	0.00	0.00	0.00
2,500.00	0.00	0.00	2,500.00	0.00	0.00	0.00	0.00	0.00	0.00
2,600.00	0.00	0.00	2,600.00	0.00	0.00	0.00	0.00	0.00	0.00
2,700.00	0.00	0.00	2,700.00	0.00	0.00	0.00	0.00	0.00	0.00
2,800.00	0.00	0.00	2,800.00	0.00	0.00	0.00	0.00	0.00	0.00
2,900.00	0.00	0.00	2,900.00	0.00	0.00	0.00	0.00	0.00	0.00
3,000.00	0.00	0.00	3,000.00	0.00	0.00	0.00	0.00	0.00	0.00
3,100.00	0.00	0.00	3,100.00	0.00	0.00	0.00	0.00	0.00	0.00
3,200.00	0.00	0.00	3,200.00	0.00	0.00	0.00	0.00	0.00	0.00
3,300.00	0.00	0.00	3,300.00	0.00	0.00	0.00	0.00	0.00	0.00
3,400.00	0.00	0.00	3,400.00	0.00	0.00	0.00	0.00	0.00	0.00
3,500.00	0.00	0.00	3,500.00	0.00	0.00	0.00	0.00	0.00	0.00
3,600.00	0.00	0.00	3,600.00	0.00	0.00	0.00	0.00	0.00	0.00
3,700.00	0.00	0.00	3,700.00	0.00	0.00	0.00	0.00	0.00	0.00
3,800.00	0.00	0.00	3,800.00	0.00	0.00	0.00	0.00	0.00	0.00
3,900.00	0.00	0.00	3,900.00	0.00	0.00	0.00	0.00	0.00	0.00
4,000.00	0.00	0.00	4,000.00	0.00	0.00	0.00	0.00	0.00	0.00
4,100.00	0.00	0.00	4,100.00	0.00	0.00	0.00	0.00	0.00	0.00
4,200.00	0.00	0.00	4,200.00	0.00	0.00	0.00	0.00	0.00	0.00
4,300.00	0.00	0.00	4,300.00	0.00	0.00	0.00	0.00	0.00	0.00
4,400.00	0.00	0.00	4,400.00	0.00	0.00	0.00	0.00	0.00	0.00
4,500.00	0.00	0.00	4,500.00	0.00	0.00	0.00	0.00	0.00	0.00
4,600.00	0.00	0.00	4,600.00	0.00	0.00	0.00	0.00	0.00	0.00
4,700.00	0.00	0.00	4,700.00	0.00	0.00	0.00	0.00	0.00	0.00
4,800.00	0.00	0.00	4,800.00	0.00	0.00	0.00	0.00	0.00	0.00
4,900.00	0.00	0.00	4,900.00	0.00	0.00	0.00	0.00	0.00	0.00
5,000.00	0.00	0.00	5,000.00	0.00	0.00	0.00	0.00	0.00	0.00
5,100.00	0.00	0.00	5,100.00	0.00	0.00	0.00	0.00	0.00	0.00

EOG Resources Inc

Planning Report

Database:	EDM	Local Co-ordinate Reference:	Site Fiscus Mesa 01-02H
Company:	Denver Division- Colorado	TVD Reference:	RIG @ 4685.00ft (TBD)
Project:	DJ - Hereford Ranch	MD Reference:	RIG @ 4685.00ft (TBD)
Site:	Fiscus Mesa 01-02H	North Reference:	True
Well:	Fiscus Mesa 01-02H	Survey Calculation Method:	Minimum Curvature
Wellbore:	Original Wellbore		
Design:	APD Directional Plan		

Planned Survey

Measured Depth (ft)	Inclination (deg)	Azimuth (deg)	Vertical Depth (ft)	+N/-S (ft)	+E/-W (ft)	Vertical Section (ft)	Dogleg Rate (?/100ft)	Build Rate (?/100ft)	Turn Rate (?/100ft)
5,156.53	0.00	0.00	5,156.53	0.00	0.00	0.00	0.00	0.00	0.00
5,200.00	5.22	331.70	5,199.94	1.74	-0.94	1.98	12.00	12.00	0.00
5,300.00	17.22	331.70	5,297.85	18.83	-10.14	21.39	12.00	12.00	0.00
5,400.00	29.22	331.70	5,389.59	53.48	-28.80	60.74	12.00	12.00	0.00
5,500.00	41.22	331.70	5,471.14	104.16	-56.09	118.30	12.00	12.00	0.00
5,600.00	53.22	331.70	5,538.93	168.66	-90.82	191.56	12.00	12.00	0.00
5,700.00	65.22	331.70	5,590.02	244.16	-131.48	277.31	12.00	12.00	0.00
5,800.00	77.22	331.70	5,622.16	327.36	-176.29	371.81	12.00	12.00	0.00
5,900.00	89.22	331.70	5,633.96	414.63	-223.28	470.93	12.00	12.00	0.00
5,906.54	90.00	331.70	5,634.00	420.39	-226.38	477.47	11.99	11.99	0.00
7"									
6,000.00	90.00	331.70	5,634.00	502.68	-270.70	570.93	0.00	0.00	0.00
6,100.00	90.00	331.70	5,634.00	590.72	-318.11	670.93	0.00	0.00	0.00
6,200.00	90.00	331.70	5,634.00	678.77	-365.52	770.93	0.00	0.00	0.00
6,300.00	90.00	331.70	5,634.00	766.81	-412.93	870.93	0.00	0.00	0.00
6,400.00	90.00	331.70	5,634.00	854.86	-460.35	970.93	0.00	0.00	0.00
6,500.00	90.00	331.70	5,634.00	942.91	-507.76	1,070.93	0.00	0.00	0.00
6,600.00	90.00	331.70	5,634.00	1,030.95	-555.17	1,170.93	0.00	0.00	0.00
6,700.00	90.00	331.70	5,634.00	1,119.00	-602.59	1,270.93	0.00	0.00	0.00
6,800.00	90.00	331.70	5,634.00	1,207.04	-650.00	1,370.93	0.00	0.00	0.00
6,900.00	90.00	331.70	5,634.00	1,295.09	-697.41	1,470.93	0.00	0.00	0.00
7,000.00	90.00	331.70	5,634.00	1,383.13	-744.83	1,570.93	0.00	0.00	0.00
7,100.00	90.00	331.70	5,634.00	1,471.18	-792.24	1,670.93	0.00	0.00	0.00
7,200.00	90.00	331.70	5,634.00	1,559.22	-839.65	1,770.93	0.00	0.00	0.00
7,300.00	90.00	331.70	5,634.00	1,647.27	-887.06	1,870.93	0.00	0.00	0.00
7,400.00	90.00	331.70	5,634.00	1,735.31	-934.48	1,970.93	0.00	0.00	0.00
7,500.00	90.00	331.70	5,634.00	1,823.36	-981.89	2,070.93	0.00	0.00	0.00
7,600.00	90.00	331.70	5,634.00	1,911.41	-1,029.30	2,170.93	0.00	0.00	0.00
7,700.00	90.00	331.70	5,634.00	1,999.45	-1,076.72	2,270.93	0.00	0.00	0.00
7,800.00	90.00	331.70	5,634.00	2,087.50	-1,124.13	2,370.93	0.00	0.00	0.00
7,900.00	90.00	331.70	5,634.00	2,175.54	-1,171.54	2,470.93	0.00	0.00	0.00
8,000.00	90.00	331.70	5,634.00	2,263.59	-1,218.96	2,570.93	0.00	0.00	0.00
8,100.00	90.00	331.70	5,634.00	2,351.63	-1,266.37	2,670.93	0.00	0.00	0.00
8,200.00	90.00	331.70	5,634.00	2,439.68	-1,313.78	2,770.93	0.00	0.00	0.00
8,300.00	90.00	331.70	5,634.00	2,527.72	-1,361.19	2,870.93	0.00	0.00	0.00
8,400.00	90.00	331.70	5,634.00	2,615.77	-1,408.61	2,970.93	0.00	0.00	0.00
8,500.00	90.00	331.70	5,634.00	2,703.82	-1,456.02	3,070.93	0.00	0.00	0.00
8,600.00	90.00	331.70	5,634.00	2,791.86	-1,503.43	3,170.93	0.00	0.00	0.00
8,700.00	90.00	331.70	5,634.00	2,879.91	-1,550.85	3,270.93	0.00	0.00	0.00
8,800.00	90.00	331.70	5,634.00	2,967.95	-1,598.26	3,370.93	0.00	0.00	0.00
8,900.00	90.00	331.70	5,634.00	3,056.00	-1,645.67	3,470.93	0.00	0.00	0.00
9,000.00	90.00	331.70	5,634.00	3,144.04	-1,693.09	3,570.93	0.00	0.00	0.00
9,100.00	90.00	331.70	5,634.00	3,232.09	-1,740.50	3,670.93	0.00	0.00	0.00
9,200.00	90.00	331.70	5,634.00	3,320.13	-1,787.91	3,770.93	0.00	0.00	0.00
9,300.00	90.00	331.70	5,634.00	3,408.18	-1,835.32	3,870.93	0.00	0.00	0.00
9,400.00	90.00	331.70	5,634.00	3,496.22	-1,882.74	3,970.93	0.00	0.00	0.00
9,500.00	90.00	331.70	5,634.00	3,584.27	-1,930.15	4,070.93	0.00	0.00	0.00
9,600.00	90.00	331.70	5,634.00	3,672.32	-1,977.56	4,170.93	0.00	0.00	0.00
9,700.00	90.00	331.70	5,634.00	3,760.36	-2,024.98	4,270.93	0.00	0.00	0.00
9,800.00	90.00	331.70	5,634.00	3,848.41	-2,072.39	4,370.93	0.00	0.00	0.00
9,900.00	90.00	331.70	5,634.00	3,936.45	-2,119.80	4,470.93	0.00	0.00	0.00
10,000.00	90.00	331.70	5,634.00	4,024.50	-2,167.22	4,570.93	0.00	0.00	0.00
10,100.00	90.00	331.70	5,634.00	4,112.54	-2,214.63	4,670.93	0.00	0.00	0.00

EOG Resources Inc

Planning Report

Database:	EDM	Local Co-ordinate Reference:	Site Fiscus Mesa 01-02H
Company:	Denver Division- Colorado	TVD Reference:	RIG @ 4685.00ft (TBD)
Project:	DJ - Hereford Ranch	MD Reference:	RIG @ 4685.00ft (TBD)
Site:	Fiscus Mesa 01-02H	North Reference:	True
Well:	Fiscus Mesa 01-02H	Survey Calculation Method:	Minimum Curvature
Wellbore:	Original Wellbore		
Design:	APD Directional Plan		

Planned Survey

Measured Depth (ft)	Inclination (deg)	Azimuth (deg)	Vertical Depth (ft)	+N/-S (ft)	+E/-W (ft)	Vertical Section (ft)	Dogleg Rate (?/100ft)	Build Rate (?/100ft)	Turn Rate (?/100ft)
10,137.37	90.00	331.70	5,634.00	4,145.45	-2,232.35	4,708.30	0.00	0.00	0.00
4 1/2" - Fiscus Mesa 01-02H (BHL)									

Targets

Target Name

- hit/miss target	Dip Angle (deg)	Dip Dir. (deg)	TVD (ft)	+N/-S (ft)	+E/-W (ft)	Northing (ft)	Easting (ft)	Latitude	Longitude
- Shape									
Fiscus Mesa 01-02H (0.00	0.00	5,634.00	4,145.45	-2,232.35	533,571.59	2,462,163.47	40° 47' 10.050 N	103° 49' 51.701 W
- plan hits target center									
- Point									

Casing Points

Measured Depth (ft)	Vertical Depth (ft)	Name	Casing Diameter (")	Hole Diameter (")
800.00	800.00	9-5/8"	9-5/8	13-1/2
5,906.54	5,634.00	7"	7	8-3/4
10,137.37	5,634.00	4 1/2"	4-1/2	6