

KERR MCGEE OIL & GAS ONSHORE LP

Location: COLORADO Slot: SLOT#09 KERR-MCGEE 19-3 (1682'FSL & 1136'FWL)
 Field: WELD COUNTY (KERR MCGEE) Well: KERR-MCGEE 19-3
 Facility: SEC.03-T1N-R68W Wellbore: KERR-MCGEE 19-3 PWB

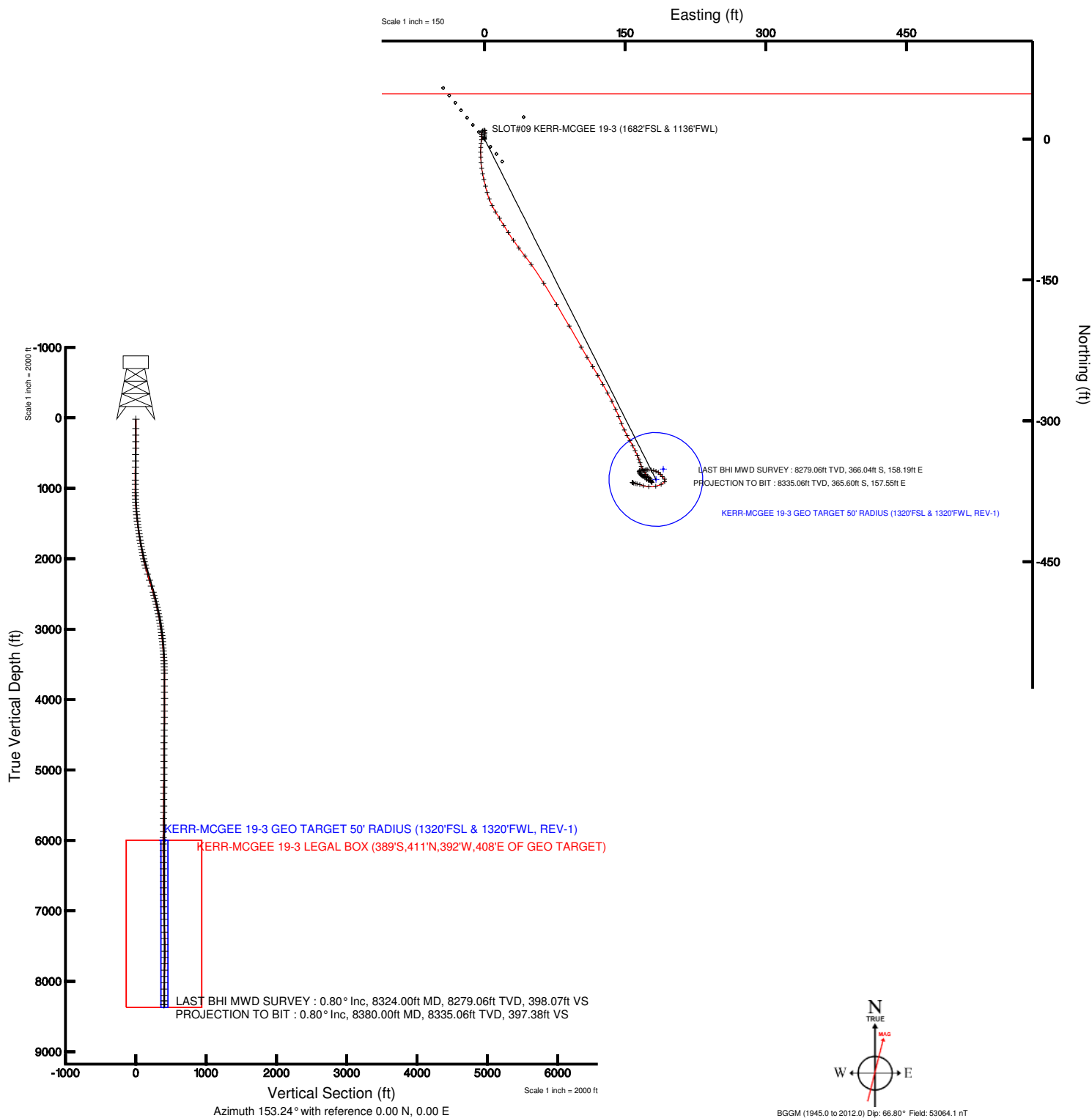

Plot reference wellpath is KERR-MCGEE 19-3 (REV-A.0) PWP	
True vertical depths are referenced to XTREME 8 (RT)	Grid System: NAD83 / Lambert Colorado State Planes, Northern Zone (501), US feet
Measured depths are referenced to XTREME 8 (RT)	North Reference: True north
XTREME 8 (RT) to Mean Sea Level: 5059 feet	Scale: True distance
Mean Sea Level to Mud line (Facility: SEC.03-T1N-R68W): 0 feet	Depths are in feet
Coordinates are in feet referenced to Slot	Created by: bensjaj on 8/5/2010





Actual Wellpath Report

KERR-MCGEE 19-3 AWP

Page 1 of 6



INTEQ

REFERENCE WELLPATH IDENTIFICATION

Operator	KERR MCGEE OIL & GAS ONSHORE LP	Slot	SLOT#09 KERR-MCGEE 19-3 (1682'FSL & 1136'FWL)
Area	COLORADO	Well	KERR-MCGEE 19-3
Field	WELD COUNTY (KERR MCGEE)	Wellbore	KERR-MCGEE 19-3 AWB
Facility	SEC.03-T1N-R68W		

REPORT SETUP INFORMATION

Projection System	NAD83 / Lambert Colorado State Planes, Northern Zone (501), US feet	Software System	WellArchitect® 2.0
North Reference	True	User	Bensjacj
Scale	0.999961	Report Generated	8/5/2010 at 1:22:31 PM
Convergence at slot	0.33° East	Database/Source file	WA_Denver/KERR-MCGEE_19-3_AWB.xml

WELLPATH LOCATION

	Local coordinates		Grid coordinates		Geographic coordinates	
	North[ft]	East[ft]	Easting[USft]	Northing[USft]	Latitude	Longitude
Slot Location	-23.68	-41.70	3141349.58	1271533.58	40°04'39.522"N	104°59'41.564"W
Facility Reference Pt			3141391.14	1271557.49	40°04'39.756"N	104°59'41.028"W
Field Reference Pt			3197771.84	1268891.29	40°04'09.600"N	104°47'36.000"W

WELLPATH DATUM

Calculation method	Minimum curvature	XTREME 8 (RT) to Facility Vertical Datum	5059.00ft
Horizontal Reference Pt	Slot	XTREME 8 (RT) to Mean Sea Level	5059.00ft
Vertical Reference Pt	XTREME 8 (RT)	Facility Vertical Datum to Mud Line (Facility)	0.00ft
MD Reference Pt	XTREME 8 (RT)	Section Origin	N 0.00, E 0.00 ft
Field Vertical Reference	Mean Sea Level	Section Azimuth	153.24°



Actual Wellpath Report

KERR-MCGEE 19-3 AWP

Page 2 of 6



INTEQ

REFERENCE WELLPATH IDENTIFICATION

Operator	KERR MCGEE OIL & GAS ONSHORE LP	Slot	SLOT#09 KERR-MCGEE 19-3 (1682'FSL & 1136'FWL)
Area	COLORADO	Well	KERR-MCGEE 19-3
Field	WELD COUNTY (KERR MCGEE)	Wellbore	KERR-MCGEE 19-3 AWP
Facility	SEC.03-T1N-R68W		

WELLPATH DATA (121 stations) † = interpolated/extrapolated station

MD [ft]	Inclination [°]	Azimuth [°]	TVD [ft]	Vert Sect [ft]	North [ft]	East [ft]	DLS [°/100ft]	Comments
0.00†	0.000	345.900	0.00	0.00	0.00	0.00	0.00	
17.00	0.000	345.900	17.00	0.00	0.00	0.00	0.00	
150.00	0.400	345.900	150.00	-0.45	0.45	-0.11	0.30	
243.00	0.500	352.900	243.00	-1.15	1.17	-0.24	0.12	
336.00	0.500	1.700	335.99	-1.89	1.98	-0.28	0.08	
429.00	0.900	12.600	428.99	-2.81	3.09	-0.11	0.45	
520.00	0.800	357.100	519.98	-3.95	4.43	0.01	0.27	
610.00	0.900	10.800	609.97	-5.08	5.75	0.12	0.25	
700.00	1.100	8.700	699.95	-6.34	7.30	0.38	0.23	
790.00	1.000	349.700	789.94	-7.80	8.92	0.37	0.40	
881.00	0.400	276.250	880.93	-8.74	9.74	-0.09	1.06	
942.00	1.000	244.600	941.93	-8.86	9.53	-0.78	1.13	
1015.00	1.100	243.200	1014.91	-8.88	8.94	-1.98	0.14	
1061.00	1.100	221.400	1060.91	-8.71	8.41	-2.67	0.90	
1106.00	2.200	194.700	1105.89	-7.91	7.25	-3.17	2.92	
1151.00	2.800	176.800	1150.84	-6.25	5.32	-3.33	2.17	
1197.00	3.800	180.000	1196.77	-3.86	2.68	-3.27	2.21	
1242.00	4.300	184.500	1241.66	-1.09	-0.50	-3.40	1.32	
1287.00	5.200	187.000	1286.50	2.05	-4.20	-3.78	2.05	
1332.00	6.200	183.000	1331.28	5.86	-8.65	-4.16	2.39	
1377.00	6.700	179.000	1375.99	10.33	-13.71	-4.24	1.49	
1422.00	6.900	178.000	1420.68	15.15	-19.03	-4.10	0.52	
1468.00	7.400	176.400	1466.32	20.38	-24.75	-3.82	1.17	
1513.00	7.600	171.000	1510.93	25.88	-30.58	-3.17	1.63	
1558.00	8.000	169.700	1555.52	31.72	-36.60	-2.14	0.97	
1603.00	8.600	165.900	1600.05	38.00	-42.95	-0.76	1.81	
1649.00	9.200	166.600	1645.49	44.94	-49.86	0.93	1.33	
1694.00	9.100	165.200	1689.92	51.92	-56.80	2.67	0.54	
1739.00	9.600	159.900	1734.32	59.13	-63.76	4.87	2.21	
1785.00	9.500	152.200	1779.69	66.73	-70.72	7.96	2.78	
1830.00	10.000	149.700	1824.04	74.35	-77.38	11.66	1.46	
1875.00	10.600	147.600	1868.31	82.36	-84.25	15.85	1.57	
1921.00	11.400	149.300	1913.47	91.11	-91.73	20.44	1.88	
1964.00	12.400	147.600	1955.54	99.94	-99.28	25.08	2.46	
2010.00	13.000	145.000	2000.42	109.98	-107.69	30.69	1.80	
2054.00	13.200	144.100	2043.27	119.84	-115.81	36.48	0.65	
2100.00	14.000	142.000	2087.98	130.48	-124.45	42.98	2.04	
2145.00	14.800	144.000	2131.57	141.49	-133.39	49.71	2.09	
2234.00	16.500	148.000	2217.27	165.30	-153.31	63.09	2.26	
2324.00	17.700	150.000	2303.29	191.69	-176.00	76.71	1.48	
2414.00	17.000	149.300	2389.19	218.47	-199.16	90.27	0.81	
2504.00	16.400	151.000	2475.40	244.29	-221.59	103.14	0.86	
2549.00	15.600	149.000	2518.65	256.68	-232.33	109.34	2.16	
2593.00	14.600	149.600	2561.13	268.11	-242.18	115.19	2.30	
2637.00	14.100	149.700	2603.76	279.00	-251.59	120.70	1.14	



Actual Wellpath Report

KERR-MCGEE 19-3 AWP

Page 3 of 6



INTEQ

REFERENCE WELLPATH IDENTIFICATION

Operator	KERR MCGEE OIL & GAS ONSHORE LP	Slot	SLOT#09 KERR-MCGEE 19-3 (1682'FSL & 1136'FWL)
Area	COLORADO	Well	KERR-MCGEE 19-3
Field	WELD COUNTY (KERR MCGEE)	Wellbore	KERR-MCGEE 19-3 AWB
Facility	SEC.03-T1N-R68W		

WELLPATH DATA (121 stations)

MD [ft]	Inclination [°]	Azimuth [°]	TVD [ft]	Vert Sect [ft]	North [ft]	East [ft]	DLS [°/100ft]	Comments
2682.00	13.600	151.100	2647.45	289.75	-260.96	126.03	1.34	
2728.00	13.100	151.400	2692.21	300.37	-270.27	131.14	1.10	
2773.00	12.500	154.000	2736.09	310.33	-279.12	135.71	1.85	
2818.00	11.700	156.000	2780.09	319.76	-287.67	139.70	2.01	
2863.00	10.500	157.400	2824.25	328.41	-295.62	143.13	2.73	
2909.00	9.600	159.000	2869.54	336.41	-303.07	146.12	2.05	
2954.00	8.800	153.200	2913.97	343.58	-309.65	149.02	2.72	
2999.00	8.500	154.600	2958.45	350.35	-315.73	151.99	0.81	
3043.00	8.200	148.600	3001.99	356.73	-321.34	155.02	2.09	
3088.00	7.700	152.500	3046.56	362.94	-326.76	158.09	1.63	
3131.00	7.100	153.900	3089.20	368.48	-331.70	160.59	1.46	
3177.00	6.500	157.000	3134.87	373.92	-336.65	162.86	1.53	
3220.00	5.900	159.900	3177.62	378.54	-340.96	164.57	1.57	
3262.00	4.900	160.900	3219.43	382.47	-344.69	165.89	2.39	
3310.00	4.700	161.300	3267.27	386.44	-348.49	167.20	0.42	
3355.00	4.300	150.700	3312.13	389.95	-351.70	168.61	2.05	
3401.00	4.300	144.400	3358.00	393.38	-354.61	170.46	1.03	
3444.00	3.700	143.700	3400.89	396.34	-357.04	172.22	1.40	
3490.00	2.600	135.200	3446.82	398.80	-358.97	173.83	2.59	
3533.00	2.600	132.500	3489.78	400.64	-360.33	175.24	0.28	
3578.00	2.400	147.200	3534.74	402.53	-361.81	176.50	1.49	
3623.00	1.700	151.100	3579.71	404.13	-363.18	177.34	1.59	
3669.00	0.500	188.400	3625.70	404.98	-363.98	177.64	2.91	
3759.00	0.400	164.100	3715.70	405.61	-364.67	177.67	0.24	
3850.00	0.300	135.300	3806.70	406.15	-365.14	177.92	0.22	
3939.00	0.400	123.300	3895.69	406.64	-365.48	178.34	0.14	
4028.00	0.100	204.500	3984.69	406.96	-365.72	178.57	0.45	
4118.00	0.400	323.000	4074.69	406.70	-365.54	178.35	0.51	
4208.00	0.500	330.000	4164.69	406.00	-364.95	177.96	0.13	
4296.00	0.700	307.200	4252.68	405.13	-364.29	177.34	0.35	
4385.00	0.900	288.900	4341.68	404.14	-363.74	176.25	0.36	
4475.00	1.400	273.100	4431.66	403.09	-363.45	174.48	0.65	
4564.00	1.000	327.600	4520.64	401.77	-362.74	172.98	1.30	
4655.00	1.600	347.600	4611.62	399.75	-360.82	172.28	0.82	
4744.00	0.200	112.400	4700.61	398.67	-359.67	172.16	1.93	
4834.00	0.100	292.400	4790.61	398.73	-359.70	172.23	0.33	
4924.00	0.400	273.100	4880.61	398.51	-359.65	171.85	0.34	
5014.00	0.500	291.400	4970.60	398.06	-359.49	171.17	0.19	
5105.00	0.400	271.300	5061.60	397.62	-359.34	170.48	0.20	
5195.00	0.400	272.400	5151.60	397.31	-359.32	169.85	0.01	
5285.00	0.500	273.800	5241.59	396.96	-359.28	169.15	0.11	
5375.00	0.400	307.500	5331.59	396.48	-359.06	168.50	0.31	
5466.00	0.400	314.900	5422.59	395.89	-358.65	168.03	0.06	
5556.00	0.600	308.900	5512.59	395.16	-358.13	167.44	0.23	
5647.00	0.600	305.400	5603.58	394.31	-357.55	166.68	0.04	



Actual Wellpath Report

KERR-MCGEE 19-3 AWP

Page 4 of 6



INTEQ

REFERENCE WELLPATH IDENTIFICATION			
Operator	KERR MCGEE OIL & GAS ONSHORE LP	Slot	SLOT#09 KERR-MCGEE 19-3 (1682'FSL & 1136'FWL)
Area	COLORADO	Well	KERR-MCGEE 19-3
Field	WELD COUNTY (KERR MCGEE)	Wellbore	KERR-MCGEE 19-3 AWB
Facility	SEC.03-T1N-R68W		

WELLPATH DATA (121 stations)								
MD [ft]	Inclination [°]	Azimuth [°]	TVD [ft]	Vert Sect [ft]	North [ft]	East [ft]	DLS [°/100ft]	Comments
5736.00	0.700	332.200	5692.58	393.35	-356.80	166.05	0.36	
5826.00	0.600	316.700	5782.57	392.35	-355.97	165.47	0.22	
5915.00	0.800	346.600	5871.56	391.30	-355.03	165.00	0.46	
6005.00	0.700	357.500	5961.56	390.19	-353.87	164.83	0.19	
6094.00	0.700	50.500	6050.55	389.57	-352.98	165.23	0.70	
6184.00	1.100	105.400	6140.54	390.03	-352.86	166.49	1.00	
6271.00	0.600	95.900	6227.53	390.84	-353.13	167.74	0.60	
6360.00	1.000	85.700	6316.52	391.39	-353.12	168.98	0.48	
6447.00	0.900	71.000	6403.51	391.77	-352.84	170.39	0.30	
6537.00	0.800	77.300	6493.50	392.02	-352.47	171.67	0.15	
6628.00	0.600	83.600	6584.49	392.34	-352.28	172.76	0.24	
6718.00	0.400	99.800	6674.49	392.69	-352.28	173.54	0.27	
6807.00	1.800	91.700	6763.47	393.54	-352.37	175.24	1.58	
6897.00	1.700	97.000	6853.43	394.95	-352.58	177.98	0.21	
6987.00	1.500	104.000	6943.39	396.46	-353.03	180.45	0.31	
7078.00	1.700	110.000	7034.36	398.22	-353.78	182.87	0.29	
7166.00	1.800	123.000	7122.32	400.37	-354.97	185.26	0.46	
7257.00	2.000	138.400	7213.27	403.14	-356.94	187.51	0.60	
7347.00	2.200	138.800	7303.21	406.33	-359.41	189.69	0.22	
7438.00	2.400	137.400	7394.14	409.85	-362.13	192.13	0.23	
7528.00	2.600	223.200	7484.08	412.37	-365.01	192.01	3.78	
7618.00	3.200	241.400	7573.96	413.15	-367.70	188.41	1.21	
7709.00	4.600	258.700	7664.75	412.26	-369.63	182.60	1.99	
7800.00	4.800	273.000	7755.45	409.40	-370.15	175.22	1.30	
7890.00	2.900	290.700	7845.24	405.85	-369.14	169.33	2.47	
7980.00	2.200	283.000	7935.16	403.07	-367.95	165.51	0.86	
8069.00	1.500	284.000	8024.11	401.21	-367.28	162.72	0.79	
8159.00	1.100	281.000	8114.09	399.92	-366.83	160.73	0.45	
8249.00	0.900	284.700	8204.07	398.92	-366.49	159.19	0.23	
8324.00	0.800	304.700	8279.06	398.07	-366.04	158.19	0.41	LAST BHI MWD SURVEY
8380.00	0.800	304.700	8335.06	397.38	-365.60	157.55	0.00	PROJECTION TO BIT

HOLE & CASING SECTIONS Ref Wellbore: KERR-MCGEE 19-3 AWB Ref Wellpath: KERR-MCGEE 19-3 AWP									
String/Diameter	Start MD [ft]	End MD [ft]	Interval [ft]	Start TVD [ft]	End TVD [ft]	Start N/S [ft]	Start E/W [ft]	End N/S [ft]	End E/W [ft]
12.25in Open Hole	17.00	1005.00	988.00	17.00	1004.92	0.00	0.00	9.03	-1.81
8.625in Open Hole	17.00	995.00	978.00	17.00	994.92	0.00	0.00	9.11	-1.64
7.875in Open Hole	995.00	8380.00	7385.00	994.92	8335.06	9.11	-1.64	-365.60	157.55



Actual Wellpath Report

KERR-MCGEE 19-3 AWP

Page 5 of 6



INTEQ

REFERENCE WELLPATH IDENTIFICATION

Operator	KERR MCGEE OIL & GAS ONSHORE LP	Slot	SLOT#09 KERR-MCGEE 19-3 (1682'FSL & 1136'FWL)
Area	COLORADO	Well	KERR-MCGEE 19-3
Field	WELD COUNTY (KERR MCGEE)	Wellbore	KERR-MCGEE 19-3 AWB
Facility	SEC.03-T1N-R68W		

TARGETS

Name	MD [ft]	TVD [ft]	North [ft]	East [ft]	Grid East [srv ft]	Grid North [srv ft]	Latitude	Longitude	Shape
KERR-MCGEE 19-3 GEO TARGET 50' RADIUS (1320'FSL & 1320'FWL, REV- 1)		6000.00	-362.47	182.74	3141534.38	1271172.17	40°04'35.940"N	104°59'39.214"W	circle
KERR-MCGEE 19-3 LEGAL BOX (389'S,411'N,392'W,408'E OF GEO TARGET)		6000.00	-351.47	190.74	3141542.31	1271183.21	40°04'36.049"N	104°59'39.111"W	square

WELLPATH COMPOSITION Ref Wellbore: KERR-MCGEE 19-3 AWB Ref Wellpath: KERR-MCGEE 19-3 AWP

Start MD [ft]	End MD [ft]	Positional Uncertainty Model	Log Name/Comment	Wellbore
17.00	942.00	NaviTrak (Standard)	BHI MWD 12.25" HOLE <150-942>	KERR-MCGEE 19-3 AWB
942.00	8324.00	NaviTrak (Standard)	BHI MWD 7.875" HOLE <1015-8324>	KERR-MCGEE 19-3 AWB
8324.00	8380.00	Blind Drilling (std)	Projection to bit	KERR-MCGEE 19-3 AWB



Actual Wellpath Report

KERR-MCGEE 19-3 AWP

Page 6 of 6



INTEQ

REFERENCE WELLPATH IDENTIFICATION

Operator	KERR MCGEE OIL & GAS ONSHORE LP	Slot	SLOT#09 KERR-MCGEE 19-3 (1682'FSL & 1136'FWL)
Area	COLORADO	Well	KERR-MCGEE 19-3
Field	WELD COUNTY (KERR MCGEE)	Wellbore	KERR-MCGEE 19-3 AWB
Facility	SEC.03-T1N-R68W		

WELLPATH COMMENTS

MD [ft]	Inclination [°]	Azimuth [°]	TVD [ft]	Comment
8324.00	0.800	304.700	8279.06	LAST BHI MWD SURVEY
8380.00	0.800	304.700	8335.06	PROJECTION TO BIT