

Stell Surveying Services, LLC

1102 West 19th Street P.O. BOX 2073

Cheyenne, Wyoming 82009

LOCATION DRAWING

DATE: 09/20/2010

THIS MAP DOES NOT REPRESENT A BOUNDARY SURVEY

SECTION 16  
TOWNSHIP 3 NORTH  
RANGE 64 WEST

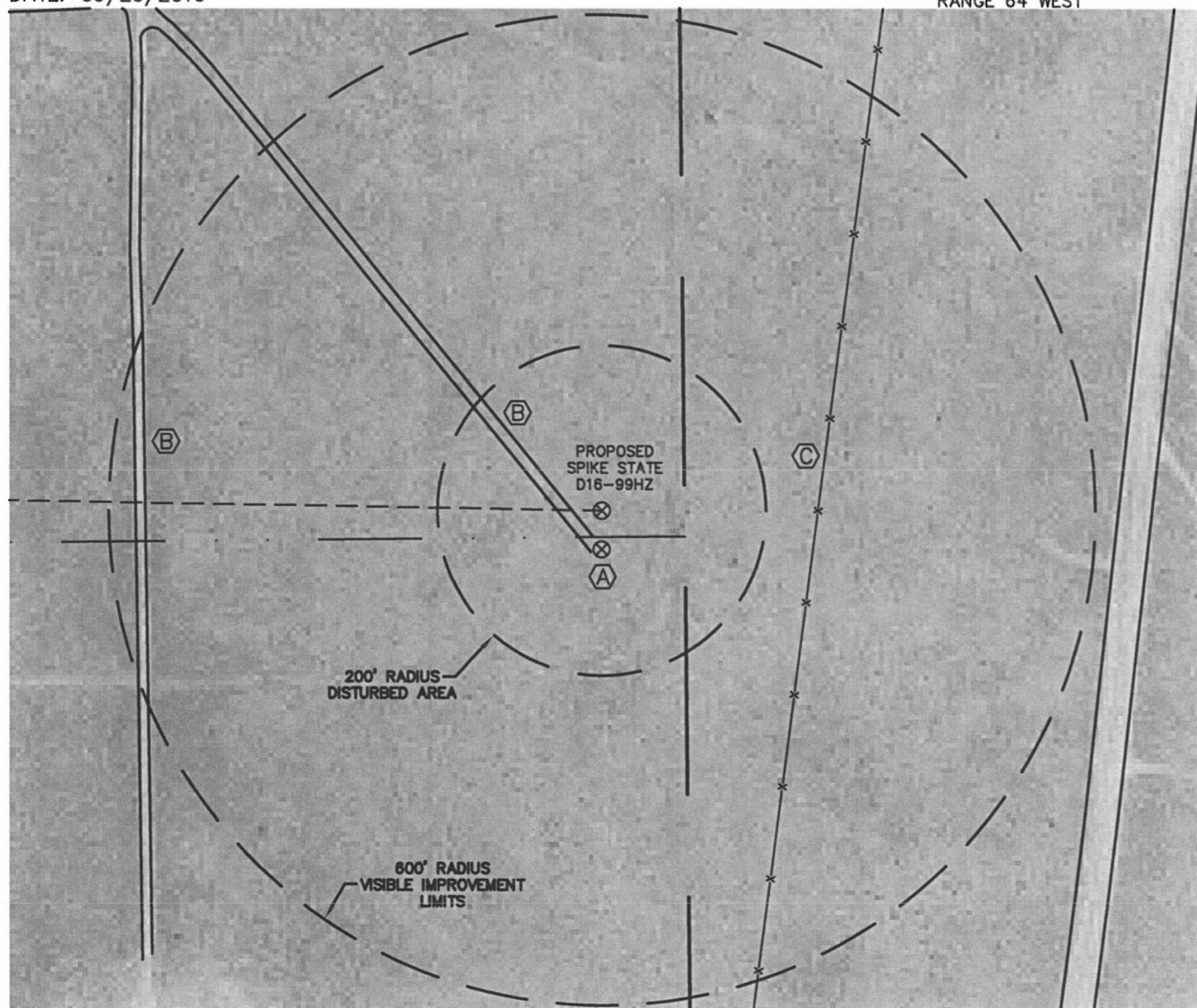

IMPROVEMENTS:

- (A) EXISTING GUTTERSEN STATE D15-33 WELL - 47' SOUTH
- (B) DIRT ROADS - 36' SOUTHWEST & 566' WEST
- (C) FENCE LINE - 261' SOUTHEAST

THE NEAREST OVERHEAD POWER LINE IS MORE THAN ONE MILE AWAY.

NEW WELL DATA

ELEV = 4782', PDOP: 2.1  
NE $\frac{1}{4}$ SE $\frac{1}{4}$ , 1361' FSL, 101' FEL  
LAT: N 40.22183  
LONG: W 104.54707  
NEAREST BUILDING: MORE THAN ONE MILE  
NEAREST PROP LINE: 101' EAST  
NEAREST RAILROAD: MORE THAN ONE MILE

NOTICE: According to Colorado law you MUST commence any legal action based upon any defect in this W.L.C. within three years after you first discover such defect. In no event may any action based upon any defect in this W.L.C. be commenced more than ten years from this sold date of the certification shown hereon.

