

Location:	COLORADO	Slot:	SLOT#22 ENCORE 3-12 (500'FNL & 2410'FWL)
Field:	LARIMER COUNTY	Well:	ENCORE 3-12
Facility:	SEC.12-T5N-R68W	Wellbore:	ENCORE 3-12 PWB

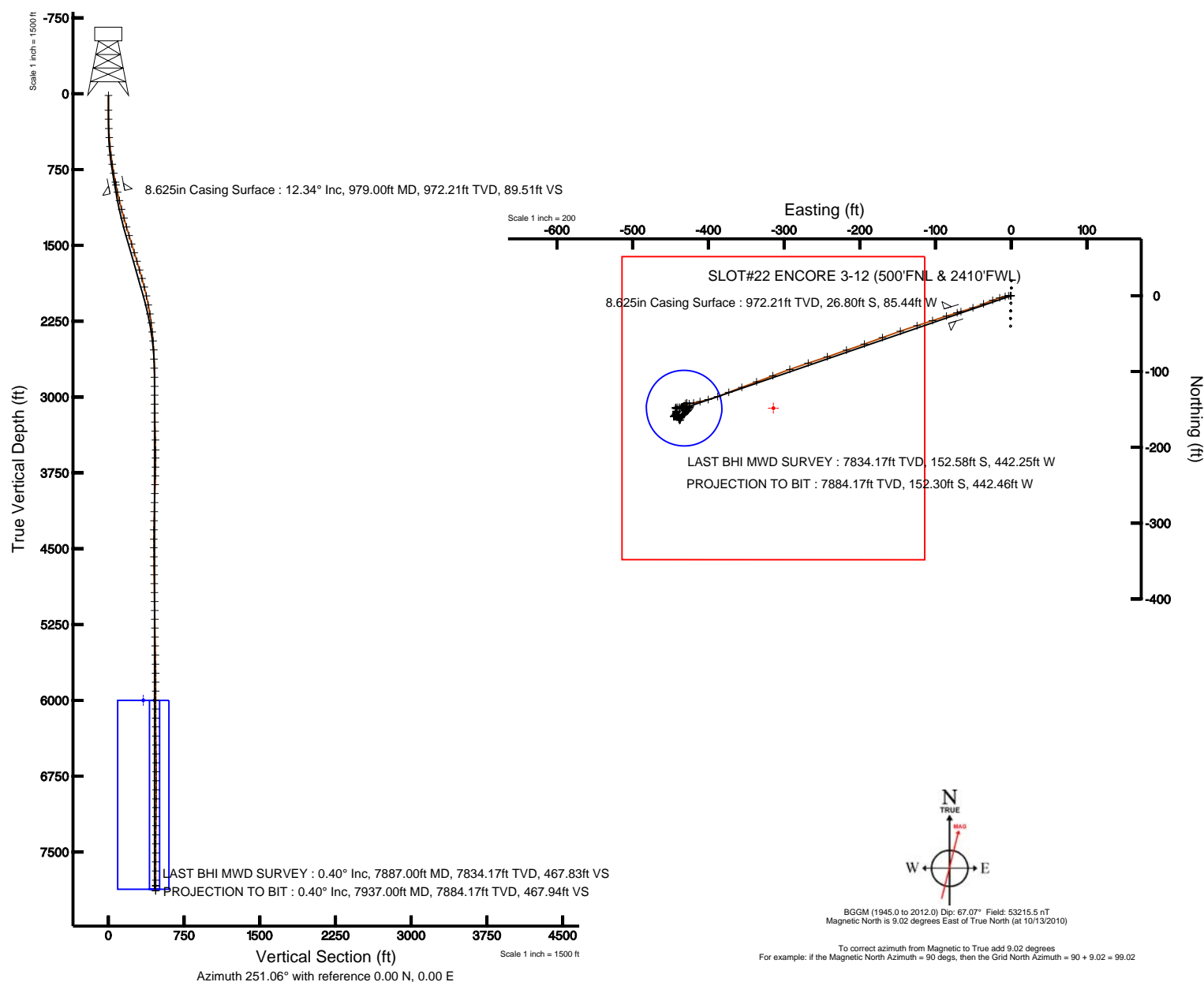

Plot reference wellpath is ENCORE 3-12 (REV-A.0) PWP	
True vertical depths are referenced to XTREME 6 (RKB)	Grid System: NAD83 / Lambert Colorado State Planes, Northern Zone (501), US feet
Measured depths are referenced to XTREME 6 (RKB)	North Reference: True north
XTREME 6 (RKB) to Mean Sea Level: 4995 feet	Scale: True distance
Mean Sea Level to Mud line (Facility: SEC.12-T5N-R68W): 0 feet	Depths are in feet
Coordinates are in feet referenced to Slot	Created by: cookdanm on 12/6/2010





# Actual Wellpath Report

ENCORE 3-12 AWP

Page 1 of 5



INTEQ

## REFERENCE WELLPATH IDENTIFICATION

Operator	KERR MCGEE OIL & GAS ONSHORE LP	Slot	SLOT#22 ENCORE 3-12 (500'FNL & 2410'FWL)
Area	COLORADO	Well	ENCORE 3-12
Field	LARIMER COUNTY	Wellbore	ENCORE 3-12 AWB
Facility	SEC.12-T5N-R68W		

## REPORT SETUP INFORMATION

Projection System	NAD83 / Lambert Colorado State Planes, Northern Zone (501), US feet	Software System	WellArchitect® 2.0
North Reference	True	User	Cookdanm
Scale	0.999961	Report Generated	12/6/2010 at 10:58:01 PM
Convergence at slot	0.35° East	Database/Source file	Denver Server/ENCORE_3-12_AWB.xml

## WELLPATH LOCATION

	Local coordinates		Grid coordinates		Geographic coordinates	
	North[ft]	East[ft]	Easting[USft]	Northing[USft]	Latitude	Longitude
Slot Location	2328.12	-2786.34	3151619.80	1396374.20	40°25'12.616"N	104°57'19.580"W
Facility Reference Pt			3154420.53	1394063.64	40°24'49.612"N	104°56'43.555"W
Field Reference Pt			3154420.53	1394063.64	40°24'49.612"N	104°56'43.555"W

## WELLPATH DATUM

Calculation method	Minimum curvature	XTREME 6 (RKB) to Facility Vertical Datum	4995.00ft
Horizontal Reference Pt	Slot	XTREME 6 (RKB) to Mean Sea Level	4995.00ft
Vertical Reference Pt	XTREME 6 (RKB)	Facility Vertical Datum to Mud Line (Facility)	0.00ft
MD Reference Pt	XTREME 6 (RKB)	Section Origin	N 0.00, E 0.00 ft
Field Vertical Reference	Mean Sea Level	Section Azimuth	251.06°



# Actual Wellpath Report

ENCORE 3-12 AWP

Page 2 of 5



INTEQ

## REFERENCE WELLPATH IDENTIFICATION

Operator	KERR MCGEE OIL & GAS ONSHORE LP	Slot	SLOT#22 ENCORE 3-12 (500'FNL & 2410'FWL)
Area	COLORADO	Well	ENCORE 3-12
Field	LARIMER COUNTY	Wellbore	ENCORE 3-12 AWB
Facility	SEC.12-T5N-R68W		

## WELLPATH DATA (91 stations) † = interpolated/extrapolated station

MD [ft]	Inclination [°]	Azimuth [°]	TVD [ft]	Vert Sect [ft]	North [ft]	East [ft]	DLS [°/100ft]	Comments
0.00†	0.000	280.400	0.00	0.00	0.00	0.00	0.00	
16.00	0.000	280.400	16.00	0.00	0.00	0.00	0.00	
162.00	0.400	280.400	162.00	0.44	0.09	-0.50	0.27	
251.00	0.700	279.400	250.99	1.19	0.24	-1.34	0.34	
344.00	1.900	260.000	343.97	3.22	0.06	-3.42	1.36	
433.00	4.100	257.600	432.84	7.84	-0.88	-7.98	2.48	
521.00	5.500	254.100	520.53	15.17	-2.71	-15.11	1.62	
608.00	7.500	248.300	606.97	25.01	-5.95	-24.40	2.42	
699.00	8.800	248.400	697.05	37.89	-10.71	-36.39	1.43	
789.00	10.300	251.300	785.80	52.82	-15.82	-50.41	1.75	
879.00	11.000	253.000	874.25	69.45	-20.91	-66.24	0.85	
907.00	11.200	253.200	901.72	74.83	-22.48	-71.40	0.73	
1065.00	13.700	252.000	1056.00	108.88	-32.70	-103.89	1.59	
1154.00	14.300	251.300	1142.35	130.41	-39.48	-124.33	0.70	
1244.00	15.600	252.000	1229.30	153.63	-46.78	-146.36	1.46	
1335.00	16.400	249.500	1316.78	178.70	-55.06	-170.04	1.16	
1424.00	16.900	250.500	1402.05	204.20	-63.78	-194.00	0.65	
1511.00	16.400	252.000	1485.40	229.12	-71.80	-217.60	0.76	
1602.00	17.800	250.200	1572.38	255.88	-80.48	-242.91	1.64	
1691.00	17.100	253.000	1657.28	282.56	-88.91	-268.22	1.23	
1780.00	16.400	249.500	1742.51	308.19	-97.14	-292.50	1.38	
1867.00	15.500	249.100	1826.16	332.09	-105.59	-314.87	1.04	
1956.00	14.300	250.200	1912.16	354.97	-113.55	-336.32	1.39	
2046.00	12.600	249.100	1999.69	375.89	-120.82	-355.95	1.91	
2137.00	10.700	249.500	2088.81	394.26	-127.32	-373.13	2.09	
2227.00	9.400	248.400	2177.43	409.95	-132.95	-387.79	1.46	
2316.00	7.600	257.200	2265.45	423.07	-136.93	-400.29	2.49	
2407.00	6.400	255.100	2355.77	434.11	-139.57	-411.06	1.35	
2496.00	5.000	258.900	2444.33	442.90	-141.59	-419.66	1.63	
2585.00	2.600	268.500	2533.13	448.67	-142.39	-425.49	2.78	
2676.00	1.800	318.000	2624.07	451.20	-141.38	-428.51	2.18	
2767.00	2.300	204.500	2715.04	453.01	-141.98	-430.22	3.78	
2856.00	2.400	209.400	2803.96	455.63	-145.23	-431.88	0.25	
2946.00	0.300	227.700	2893.93	457.26	-147.03	-432.98	2.35	
3034.00	0.400	227.300	2981.93	457.75	-147.40	-433.37	0.11	
3122.00	0.700	257.600	3069.93	458.57	-147.72	-434.12	0.46	
3211.00	0.700	266.400	3158.92	459.63	-147.87	-435.20	0.12	
3300.00	1.300	249.800	3247.91	461.16	-148.25	-436.69	0.74	
3389.00	1.600	259.000	3336.88	463.40	-148.84	-438.85	0.43	
3477.00	1.900	258.200	3424.84	466.07	-149.37	-441.49	0.34	
3576.00	1.000	336.700	3523.81	467.76	-148.91	-443.44	1.98	
3656.00	0.600	29.100	3603.80	467.50	-147.91	-443.51	0.99	
3745.00	0.200	30.800	3692.80	467.04	-147.37	-443.20	0.45	
3832.00	2.100	84.250	3779.78	465.37	-147.08	-441.54	2.28	
3919.00	1.900	87.800	3866.73	462.44	-146.86	-438.51	0.27	



# Actual Wellpath Report

ENCORE 3-12 AWP

Page 3 of 5



## REFERENCE WELLPATH IDENTIFICATION

Operator	KERR MCGEE OIL & GAS ONSHORE LP	Slot	SLOT#22 ENCORE 3-12 (500'FNL & 2410'FWL)
Area	COLORADO	Well	ENCORE 3-12
Field	LARIMER COUNTY	Wellbore	ENCORE 3-12 AWB
Facility	SEC.12-T5N-R68W		

## WELLPATH DATA (91 stations)

MD [ft]	Inclination [°]	Azimuth [°]	TVD [ft]	Vert Sect [ft]	North [ft]	East [ft]	DLS [°/100ft]	Comments
4007.00	1.800	87.800	3954.68	459.72	-146.75	-435.67	0.11	
4096.00	2.200	88.100	4043.63	456.75	-146.64	-432.57	0.45	
4186.00	1.700	90.200	4133.58	453.83	-146.59	-429.51	0.56	
4277.00	1.300	87.100	4224.54	451.57	-146.54	-427.13	0.45	
4366.00	1.000	98.700	4313.53	449.91	-146.61	-425.35	0.43	
4457.00	0.400	167.600	4404.52	449.24	-147.04	-424.50	1.03	
4544.00	0.600	223.100	4491.52	449.68	-147.67	-424.74	0.57	
4633.00	1.100	202.400	4580.51	450.65	-148.80	-425.39	0.65	
4722.00	0.900	211.200	4669.49	451.75	-150.19	-426.08	0.28	
4811.00	1.000	220.000	4758.48	452.96	-151.38	-426.94	0.20	
4898.00	0.800	235.800	4845.47	454.19	-152.30	-427.93	0.36	
4987.00	1.100	234.400	4934.46	455.61	-153.15	-429.14	0.34	
5076.00	1.100	228.400	5023.44	457.22	-154.21	-430.47	0.13	
5164.00	1.100	221.400	5111.43	458.73	-155.41	-431.66	0.15	
5252.00	0.600	241.400	5199.42	459.92	-156.26	-432.62	0.65	
5338.00	0.700	231.200	5285.41	460.86	-156.81	-433.43	0.18	
5428.00	0.800	211.200	5375.40	461.86	-157.69	-434.18	0.31	
5515.00	1.400	212.600	5462.39	463.15	-159.10	-435.07	0.69	
5605.00	1.600	201.000	5552.36	464.82	-161.20	-436.11	0.40	
5696.00	1.700	201.300	5643.32	466.51	-163.65	-437.06	0.11	
5785.00	0.600	326.800	5732.31	467.48	-164.49	-437.79	2.37	
5874.00	0.800	286.100	5821.30	468.10	-163.92	-438.64	0.59	
5962.00	1.600	359.200	5909.28	468.22	-162.53	-439.25	1.78	
6051.00	1.100	355.000	5998.26	467.63	-160.43	-439.34	0.57	
6140.00	0.900	321.600	6087.25	467.66	-159.03	-439.85	0.68	
6229.00	0.400	305.400	6176.24	468.07	-158.31	-440.54	0.59	
6316.00	0.300	268.100	6263.24	468.46	-158.14	-441.01	0.28	
6407.00	0.700	234.400	6354.24	469.22	-158.47	-441.70	0.53	
6495.00	0.900	250.000	6442.23	470.43	-159.02	-442.79	0.33	
6584.00	0.800	260.400	6531.22	471.74	-159.36	-444.06	0.21	
6672.00	0.600	253.400	6619.21	472.81	-159.59	-445.11	0.25	
6760.00	0.300	299.400	6707.21	473.42	-159.61	-445.75	0.51	
6849.00	0.200	34.000	6796.21	473.45	-159.37	-445.87	0.42	
6938.00	0.400	41.000	6885.21	473.06	-159.01	-445.57	0.23	
7028.00	0.300	88.100	6975.20	472.56	-158.76	-445.13	0.33	
7115.00	0.400	37.900	7062.20	472.09	-158.51	-444.72	0.36	
7204.00	0.900	26.000	7151.20	471.34	-157.64	-444.22	0.58	
7293.00	0.800	26.000	7240.19	470.41	-156.45	-443.64	0.11	
7384.00	0.500	35.400	7331.18	469.63	-155.56	-443.13	0.35	
7473.00	0.400	40.000	7420.18	469.05	-155.01	-442.71	0.12	
7563.00	0.300	23.400	7510.18	468.62	-154.55	-442.41	0.16	
7651.00	0.400	16.400	7598.18	468.29	-154.04	-442.24	0.12	
7742.00	0.400	357.400	7689.17	468.02	-153.42	-442.16	0.15	
7832.00	0.300	6.600	7779.17	467.83	-152.87	-442.15	0.13	
7887.00	0.400	322.300	7834.17	467.83	-152.58	-442.25	0.51	LAST BHI MWD SURVEY



# Actual Wellpath Report

ENCORE 3-12 AWP

Page 4 of 5



INTEQ

## REFERENCE WELLPATH IDENTIFICATION

Operator	KERR MCGEE OIL & GAS ONSHORE LP	Slot	SLOT#22 ENCORE 3-12 (500'FNL & 2410'FWL)
Area	COLORADO	Well	ENCORE 3-12
Field	LARIMER COUNTY	Wellbore	ENCORE 3-12 AWB
Facility	SEC.12-T5N-R68W		

## WELLPATH DATA (91 stations)

MD [ft]	Inclination [°]	Azimuth [°]	TVD [ft]	Vert Sect [ft]	North [ft]	East [ft]	DLS [°/100ft]	Comments
7937.00	0.400	322.300	7884.17	467.94	-152.30	-442.46	0.00	PROJECTION TO BIT

## HOLE & CASING SECTIONS Ref Wellbore: ENCORE 3-12 AWB Ref Wellpath: ENCORE 3-12 AWP

String/Diameter	Start MD [ft]	End MD [ft]	Interval [ft]	Start TVD [ft]	End TVD [ft]	Start N/S [ft]	Start E/W [ft]	End N/S [ft]	End E/W [ft]
12.25in Open Hole	16.00	979.00	963.00	16.00	972.21	0.00	0.00	-26.80	-85.44
8.625in Casing Surface	16.00	979.00	963.00	16.00	972.21	0.00	0.00	-26.80	-85.44
7.875in Open Hole	979.00	7937.00	6958.00	972.21	7884.17	-26.80	-85.44	-152.30	-442.46

## TARGETS

Name	MD [ft]	TVD [ft]	North [ft]	East [ft]	Grid East [srv ft]	Grid North [srv ft]	Latitude	Longitude	Shape
ENCORE 3-12 GEO TARGET 50' RADIUS (660'FNL & 1980'FWL, REV-1)		6000.00	-148.27	-432.14	3151188.60	1396223.28	40°25'11.150"N	104°57'25.168"W	circle
ENCORE 3-12 LEGAL BOX (200'N,200'S,82'W,318'E OF GEO TARGET)		6000.00	-148.27	-314.14	3151306.59	1396224.01	40°25'11.150"N	104°57'23.642"W	square

## WELLPATH COMPOSITION Ref Wellbore: ENCORE 3-12 AWB Ref Wellpath: ENCORE 3-12 AWP

Start MD [ft]	End MD [ft]	Positional Uncertainty Model	Log Name/Comment	Wellbore
16.00	907.00	NaviTrak (Standard)	BHI MWD SURVEYS 12.25 <162-907>	ENCORE 3-12 AWB
907.00	7887.00	NaviTrak (Standard)	BHI MWD 7.875 HOLE <1065-7887>	ENCORE 3-12 AWB
7887.00	7937.00	Blind Drilling (std)	Projection to bit	ENCORE 3-12 AWB



# Actual Wellpath Report

ENCORE 3-12 AWP

Page 5 of 5



INTEQ

## REFERENCE WELLPATH IDENTIFICATION

Operator	KERR MCGEE OIL & GAS ONSHORE LP	Slot	SLOT#22 ENCORE 3-12 (500'FNL & 2410'FWL)
Area	COLORADO	Well	ENCORE 3-12
Field	LARIMER COUNTY	Wellbore	ENCORE 3-12 AWB
Facility	SEC.12-T5N-R68W		

## WELLPATH COMMENTS

MD [ft]	Inclination [°]	Azimuth [°]	TVD [ft]	Comment
7887.00	0.400	322.300	7834.17	LAST BHI MWD SURVEY
7937.00	0.400	322.300	7884.17	PROJECTION TO BIT