

# KERR MCGEE OIL & GAS ONSHORE LP

Location: COLORADO Slot: SLOT#02 DRY CREEK 5-27 (1169'FNL & 1197'FWL)  
 Field: WELD COUNTY (KERR MCGEE) Well: DRY CREEK 5-27  
 Facility: SEC.27-T1N-R67W Wellbore: DRY CREEK 5-27 PWB

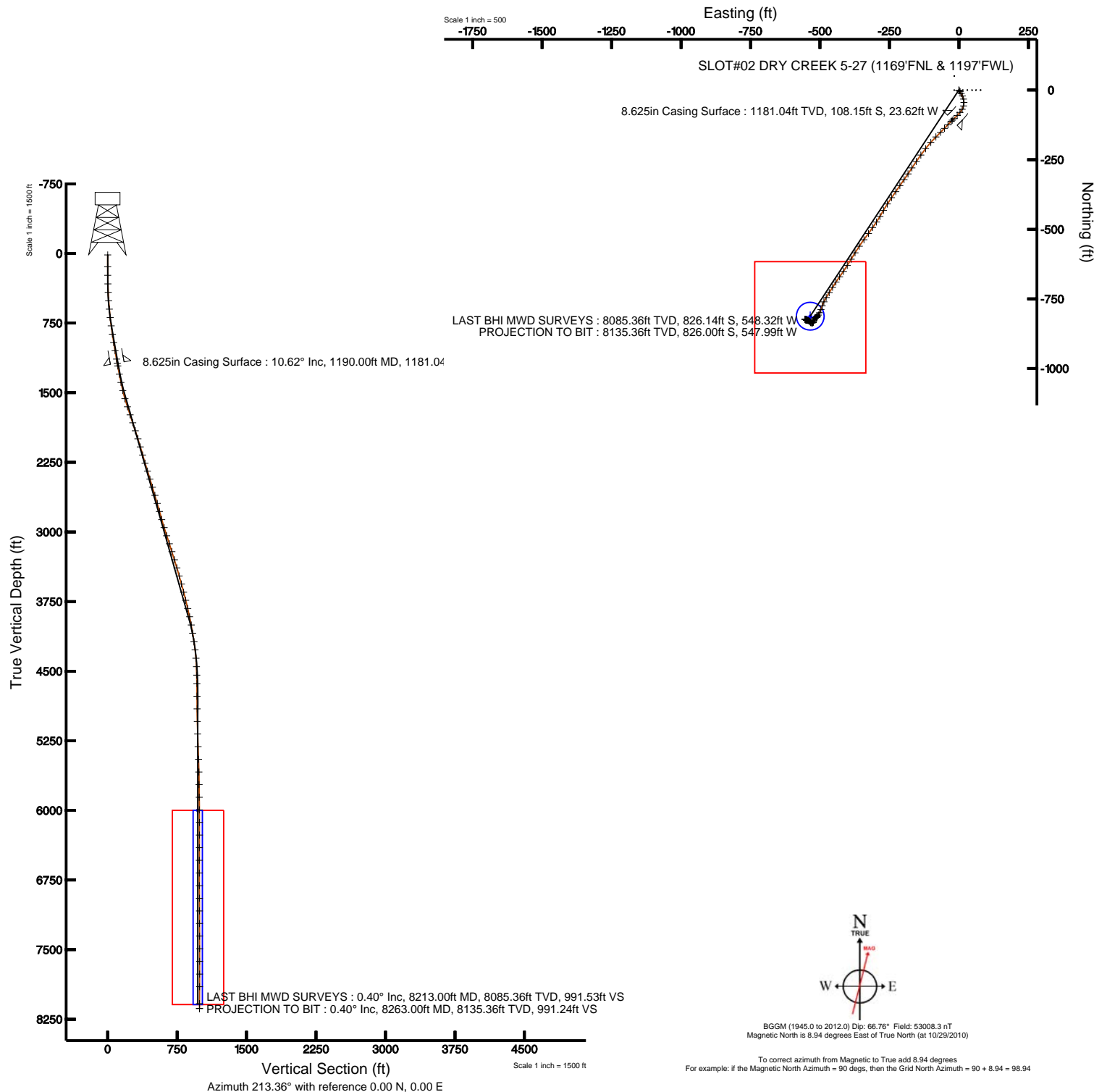

Plot reference wellpath is DRY CREEK 5-27 (REV-A.0) PWB	
True vertical depths are referenced to XTREME 12 (RT)	Grid System: NAD83 / Lambert Colorado State Planes, Northern Zone (501), US feet
Measured depths are referenced to XTREME 12 (RT)	North Reference: True north
XTREME 12 (RT) to Mean Sea Level: 5022 feet	Scale: True distance
Mean Sea Level to Mud line (Facility: SEC.27-T1N-R67W): 0 feet	Depths are in feet
Coordinates are in feet referenced to Slot	Created by: cookdawn on 11/1/2010





# Actual Wellpath Report

DRY CREEK 5-27 AWP

Page 1 of 5



INTEQ

## REFERENCE WELLPATH IDENTIFICATION

Operator	KERR MCGEE OIL & GAS ONSHORE LP	Slot	SLOT#02 DRY CREEK 5-27 (1169'FNL & 1197'FWL)
Area	COLORADO	Well	DRY CREEK 5-27
Field	WELD COUNTY (KERR MCGEE)	Wellbore	DRY CREEK 5-27 AWP
Facility	SEC.27-T1N-R67W		

## REPORT SETUP INFORMATION

Projection System	NAD83 / Lambert Colorado State Planes, Northern Zone (501), US feet	Software System	WellArchitect® 2.0
North Reference	True	User	Cookdanm
Scale	0.999964	Report Generated	11/1/2010 at 4:55:27 PM
Convergence at slot	0.40° East	Database/Source file	Denver Server/_DRY_CREEK_5-27_AWP.xml

## WELLPATH LOCATION

	Local coordinates		Grid coordinates		Geographic coordinates	
	North[ft]	East[ft]	Easting[USft]	Northing[USft]	Latitude	Longitude
Slot Location	0.00	16.80	3173114.79	1252968.73	40°01'34.068"N	104°52'54.588"W
Facility Reference Pt			3173097.99	1252968.61	40°01'34.068"N	104°52'54.804"W
Field Reference Pt			3197771.84	1268891.29	40°04'09.600"N	104°47'36.000"W

## WELLPATH DATUM

Calculation method	Minimum curvature	XTREME 12 (RT) to Facility Vertical Datum	5022.00ft
Horizontal Reference Pt	Slot	XTREME 12 (RT) to Mean Sea Level	5022.00ft
Vertical Reference Pt	XTREME 12 (RT)	Facility Vertical Datum to Mud Line (Facility)	0.00ft
MD Reference Pt	XTREME 12 (RT)	Section Origin	N 0.00, E 0.00 ft
Field Vertical Reference	Mean Sea Level	Section Azimuth	213.36°



# Actual Wellpath Report

DRY CREEK 5-27 AWP

Page 2 of 5



INTEQ

REFERENCE WELLPATH IDENTIFICATION			
Operator	KERR MCGEE OIL & GAS ONSHORE LP	Slot	SLOT#02 DRY CREEK 5-27 (1169'FNL & 1197'FWL)
Area	COLORADO	Well	DRY CREEK 5-27
Field	WELD COUNTY (KERR MCGEE)	Wellbore	DRY CREEK 5-27 AWP
Facility	SEC.27-T1N-R67W		

WELLPATH DATA (80 stations) † = interpolated/extrapolated station								
MD [ft]	Inclination [°]	Azimuth [°]	TVD [ft]	Vert Sect [ft]	North [ft]	East [ft]	DLS [°/100ft]	Comments
0.00†	0.000	120.100	0.00	0.00	0.00	0.00	0.00	
15.00	0.000	120.100	15.00	0.00	0.00	0.00	0.00	
143.00	0.500	120.100	143.00	-0.03	-0.28	0.48	0.39	
235.00	1.900	138.400	234.98	0.34	-1.62	1.84	1.56	
327.00	4.200	151.700	326.84	2.34	-5.73	4.45	2.60	
418.00	5.500	149.300	417.51	5.83	-12.41	8.26	1.45	
510.00	6.900	153.800	508.97	10.55	-21.16	12.95	1.61	
601.00	7.800	167.200	599.23	17.60	-32.09	16.73	2.12	
692.00	7.900	178.200	689.38	26.99	-44.36	18.30	1.65	
782.00	8.100	195.300	778.52	38.08	-56.66	16.82	2.64	
873.00	8.500	208.000	868.57	50.87	-68.79	11.97	2.06	
964.00	8.900	222.400	958.54	64.52	-79.92	4.06	2.43	
1054.00	10.000	222.700	1047.32	79.10	-90.81	-5.93	1.22	
1145.00	10.800	227.300	1136.82	95.18	-102.40	-17.55	1.27	
1220.00	10.500	224.500	1210.53	108.70	-112.04	-27.51	0.80	
1311.00	11.100	223.100	1299.92	125.47	-124.35	-39.31	0.72	
1402.00	11.900	224.100	1389.09	143.32	-137.48	-51.82	0.91	
1492.00	13.800	225.900	1476.83	162.92	-151.62	-65.99	2.16	
1583.00	16.200	224.500	1564.73	185.97	-168.23	-82.68	2.67	
1674.00	18.500	221.300	1651.58	212.73	-188.13	-101.11	2.74	
1765.00	18.900	217.800	1737.78	241.72	-210.62	-119.67	1.31	
1856.00	17.700	216.100	1824.18	270.24	-233.45	-136.86	1.44	
1946.00	18.800	214.600	1909.65	298.40	-256.44	-153.15	1.33	
2037.00	17.000	213.600	1996.24	326.37	-279.59	-168.84	2.01	
2128.00	15.700	212.900	2083.56	351.98	-301.01	-182.89	1.44	
2219.00	16.300	216.400	2171.04	377.05	-321.63	-197.16	1.25	
2310.00	17.300	213.900	2258.15	403.33	-343.14	-212.29	1.36	
2400.00	16.600	214.600	2344.24	429.57	-364.83	-227.05	0.81	
2491.00	17.300	215.400	2431.29	456.09	-386.55	-242.27	0.81	
2582.00	17.400	211.500	2518.15	483.21	-409.19	-257.22	1.28	
2673.00	16.900	210.800	2605.10	510.02	-432.15	-271.10	0.59	
2764.00	15.600	211.100	2692.47	535.46	-453.99	-284.19	1.43	
2854.00	14.700	212.200	2779.34	558.97	-474.01	-296.53	1.05	
2945.00	16.100	217.500	2867.07	583.10	-493.80	-310.36	2.18	
3036.00	17.300	213.200	2954.24	609.22	-515.13	-325.46	1.89	
3127.00	18.000	217.800	3040.96	636.77	-537.56	-341.48	1.71	
3218.00	19.000	214.600	3127.26	665.60	-560.87	-358.51	1.57	
3308.00	17.300	210.100	3212.78	693.61	-584.51	-373.54	2.45	
3399.00	17.400	212.500	3299.64	720.72	-607.69	-387.64	0.79	
3490.00	16.400	212.200	3386.71	747.17	-630.04	-401.80	1.10	
3581.00	15.800	213.900	3474.14	772.41	-651.19	-415.55	0.84	
3671.00	15.200	215.400	3560.87	796.45	-670.98	-429.22	0.80	
3762.00	13.800	214.300	3648.97	819.22	-689.67	-442.25	1.57	
3853.00	14.500	212.200	3737.20	841.47	-708.27	-454.44	0.95	
3944.00	14.600	211.800	3825.29	864.32	-727.66	-466.55	0.16	



# Actual Wellpath Report

DRY CREEK 5-27 AWP

Page 3 of 5



INTEQ

## REFERENCE WELLPATH IDENTIFICATION

Operator	KERR MCGEE OIL & GAS ONSHORE LP	Slot	SLOT#02 DRY CREEK 5-27 (1169'FNL & 1197'FWL)
Area	COLORADO	Well	DRY CREEK 5-27
Field	WELD COUNTY (KERR MCGEE)	Wellbore	DRY CREEK 5-27 AWP
Facility	SEC.27-T1N-R67W		

## WELLPATH DATA (80 stations)

MD [ft]	Inclination [°]	Azimuth [°]	TVD [ft]	Vert Sect [ft]	North [ft]	East [ft]	DLS [°/100ft]	Comments
4035.00	11.800	210.800	3913.87	885.09	-745.40	-477.36	3.09	
4126.00	10.300	205.900	4003.18	902.45	-760.72	-485.68	1.94	
4216.00	9.400	199.200	4091.86	917.55	-774.90	-491.61	1.62	
4307.00	8.900	200.200	4181.70	931.61	-788.52	-496.49	0.58	
4397.00	7.100	204.800	4270.82	943.89	-800.10	-501.22	2.12	
4488.00	4.800	211.500	4361.33	953.26	-808.46	-505.57	2.64	
4579.00	2.300	231.700	4452.15	958.80	-812.84	-509.00	3.03	
4670.00	1.600	195.300	4543.10	961.74	-815.19	-510.76	1.52	
4761.00	0.400	248.800	4634.09	963.21	-816.53	-511.40	1.54	
4897.00	0.600	250.500	4770.08	964.16	-816.94	-512.51	0.15	
5033.00	1.300	269.500	4906.06	965.59	-817.19	-514.72	0.56	
5169.00	1.200	234.700	5042.03	967.78	-818.03	-517.43	0.55	
5305.00	1.600	207.600	5177.99	970.99	-820.54	-519.47	0.56	
5441.00	2.600	200.900	5313.90	975.89	-825.10	-521.45	0.76	
5577.00	2.000	192.100	5449.79	981.12	-830.30	-523.05	0.51	
5714.00	1.100	188.300	5586.74	984.54	-833.94	-523.74	0.66	
5849.00	1.200	253.000	5721.71	986.80	-835.64	-525.28	0.91	
5986.00	0.900	255.800	5858.69	988.70	-836.32	-527.69	0.22	
6122.00	1.200	282.100	5994.67	990.00	-836.28	-530.12	0.41	
6258.00	1.100	284.300	6130.64	990.95	-835.66	-532.78	0.08	
6394.00	1.100	332.400	6266.62	990.74	-834.18	-534.65	0.66	
6530.00	1.500	318.700	6402.58	989.63	-831.69	-536.43	0.37	
6666.00	1.400	296.600	6538.54	989.36	-829.61	-539.09	0.41	
6803.00	1.000	293.800	6675.51	989.75	-828.38	-541.68	0.30	
6939.00	1.100	286.400	6811.49	990.33	-827.53	-544.02	0.12	
7075.00	0.900	296.200	6947.47	990.85	-826.69	-546.23	0.19	
7211.00	1.000	293.000	7083.45	991.19	-825.75	-548.28	0.08	
7347.00	0.800	280.700	7219.43	991.77	-825.11	-550.30	0.20	
7483.00	0.900	281.400	7355.42	992.54	-824.73	-552.28	0.07	
7619.00	0.500	301.800	7491.41	992.95	-824.20	-553.84	0.34	
7755.00	0.200	93.900	7627.41	992.85	-823.91	-554.10	0.50	
7892.00	0.800	110.200	7764.40	992.52	-824.25	-552.97	0.45	
8028.00	1.300	119.700	7900.38	992.20	-825.34	-550.74	0.39	
8213.00	0.400	67.300	8085.36	991.53	-826.14	-548.32	0.60	LAST BHI MWD SURVEYS
8263.00	0.400	67.300	8135.36	991.24	-826.00	-547.99	0.00	PROJECTION TO BIT



# Actual Wellpath Report

DRY CREEK 5-27 AWP

Page 4 of 5



INTEQ

REFERENCE WELLPATH IDENTIFICATION			
Operator	KERR MCGEE OIL & GAS ONSHORE LP	Slot	SLOT#02 DRY CREEK 5-27 (1169'FNL & 1197'FWL)
Area	COLORADO	Well	DRY CREEK 5-27
Field	WELD COUNTY (KERR MCGEE)	Wellbore	DRY CREEK 5-27 AWP
Facility	SEC.27-T1N-R67W		

HOLE & CASING SECTIONS Ref Wellbore: DRY CREEK 5-27 AWP Ref Wellpath: DRY CREEK 5-27 AWP									
String/Diameter	Start MD [ft]	End MD [ft]	Interval [ft]	Start TVD [ft]	End TVD [ft]	Start N/S [ft]	Start E/W [ft]	End N/S [ft]	End E/W [ft]
12.25in Open Hole	15.00	1200.00	1185.00	15.00	1190.87	0.00	0.00	-109.44	-24.93
8.625in Casing Surface	15.00	1190.00	1175.00	15.00	1181.04	0.00	0.00	-108.15	-23.62
7.875in Open Hole	1190.00	8263.00	7073.00	1181.04	8135.36	-108.15	-23.62	-826.00	-547.99

TARGETS									
Name	MD [ft]	TVD [ft]	North [ft]	East [ft]	Grid East [srv ft]	Grid North [srv ft]	Latitude	Longitude	Shape
DRY CREEK 5-27 GEO TARGET 50' RADIUS (1980'FNL & 660'FWL, REV-1)		6000.00	-812.36	-534.93	3172585.56	1252152.69	40°01'26.040"N	104°53'01.464"W	circle
DRY CREEK 5-27 LEGAL BOX (196'N,204'S,200'E,200'W OF GEO TARGET)		6000.00	-816.36	-534.93	3172585.58	1252148.69	40°01'26.000"N	104°53'01.464"W	square

WELLPATH COMPOSITION Ref Wellbore: DRY CREEK 5-27 AWP Ref Wellpath: DRY CREEK 5-27 AWP				
Start MD [ft]	End MD [ft]	Positional Uncertainty Model	Log Name/Comment	Wellbore
15.00	1145.00	NaviTrak (Standard)	BHI MWD SURVEYS 12.25 HOLE <143-1145>	DRY CREEK 5-27 AWP
1145.00	8213.00	NaviTrak (Standard)	BHI MWD SURVEYS 7.875 HOLE <1220-8213>	DRY CREEK 5-27 AWP
8213.00	8263.00	Blind Drilling (std)	Projection to bit	DRY CREEK 5-27 AWP



# Actual Wellpath Report

DRY CREEK 5-27 AWP

Page 5 of 5



INTEQ

## REFERENCE WELLPATH IDENTIFICATION

Operator	KERR MCGEE OIL & GAS ONSHORE LP	Slot	SLOT#02 DRY CREEK 5-27 (1169'FNL & 1197'FWL)
Area	COLORADO	Well	DRY CREEK 5-27
Field	WELD COUNTY (KERR MCGEE)	Wellbore	DRY CREEK 5-27 AWB
Facility	SEC.27-T1N-R67W		

## WELLPATH COMMENTS

MD [ft]	Inclination [°]	Azimuth [°]	TVD [ft]	Comment
8213.00	0.400	67.300	8085.36	LAST BHI MWD SURVEYS
8263.00	0.400	67.300	8135.36	PROJECTION TO BIT