

LEGEND

○ SITE LOCATION



0 375 750 1500
FEET

SOURCE: TOPOZONE.COM
USGS 7.5' QUADRANGLE
(NAD27)

FIGURE 1
SITE LOCATION MAP
AVERY 10B, 13, 23-10, 24-10D
SWSW 10-T6N-R65W
WELD COUNTY, CO
PETROLEUM DEVELOPMENT CORPORATION



PDC1002501-SL

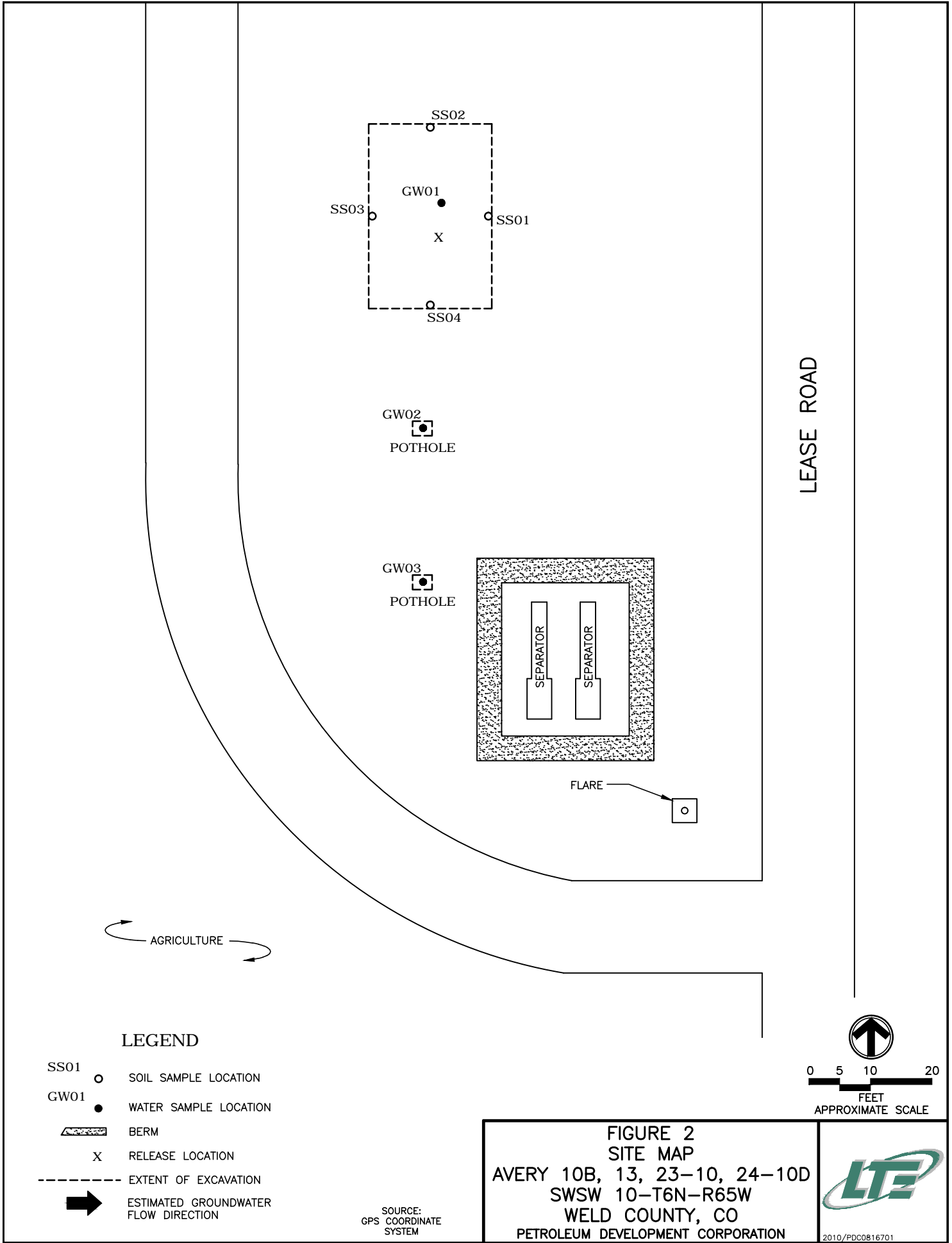

TABLE 1
SOIL SAMPLE ANALYTICAL RESULTS
AVERY 10B, 13, 23-10, 24-10D (API No. 05-123-20292)
WELD COUNTY, COLORADO
PETROLEUM DEVELOPMENT CORPORATION

Sample ID	Depth (ft bgs)	Date Sampled	Benzene (mg/kg)	Toluene (mg/kg)	Ethyl- benzene (mg/kg)	Xylenes (mg/kg)	TPH (mg/kg)
SS01	10	08/12/2010	<0.0050	<0.0050	<0.0050	<0.0050	<50.5
SS02	10	08/12/2010	<0.0050	<0.0050	<0.0050	<0.0050	<50.5
SS03	10	08/12/2010	<0.0050	<0.0050	<0.0050	<0.0050	<50.5
SS04	10	08/12/2010	<0.0050	<0.0050	<0.0050	<0.0050	<50.5
Basic Standards for Soil			0.17	85	100	175	500

Notes: < - less than stated laboratory reporting limit
TPH - Total Petroleum Hydrocarbons (C6-C28)
API - American Petroleum Institute

NA - Not Analyzed
mg/kg - milligrams per kilogram
ft bgs - feet below ground surface

Bold numbers indicate result equalled or exceeded standard.

Basic Standards for Soil are taken from 2 CCR 404-1, Table 910-1, effective April 1, 2009.



TABLE 2
GROUNDWATER ANALYTICAL RESULTS AND FIELD PARAMETERS
AVERY 10B, 13, 23-10, 24-10D (API No. 123-20292)
WELD COUNTY, COLORADO
PETROLEUM DEVELOPMENT CORPORATION

Sample ID	Date Sampled	Benzene (ug/L)	Toluene (ug/L)	Ethyl-benzene (ug/L)	Xylenes (ug/L)	Depth to Water (ft btoc)
GW01	08/12/2010	1600	2800	110	1400	NM
	08/20/2010	27	<1.0	2.3	42	NM
	09/17/2010	7.7	<1.0	1.6	10	NM
	09/23/2010	5.9	12	2.9	25	NM
	09/30/2010	11	17	6.7	81	NM
	10/14/2010	<1.0	<1.0	<1.0	<1.0	NM
GW02	08/31/2010	<1.0	<1.0	<1.0	<1.0	NM
GW03	08/31/2010	<1.0	<1.0	<1.0	<1.0	NM
Basic Standards for Groundwater:		5	560	700	1400	

Notes: < - less than ug/L - micrograms per Liter NA - Not Analyzed/Not Available
ft btoc - feet below top of casing NM - Not measured API - American Petroleum Institute
Basic Standards for Groundwater are taken from the Colorado Department of Health and Environment -
Water Quality Control Commission Regulation 41, effective 4/1/2009.
Bold numbers indicate result equaled or exceeded standard.



Summit Scientific

741 Corporate Circle – Suite I ♦ Golden, Colorado 80401

303.277.9310 - laboratory ♦ 303.277.9531 - fax

August 13, 2010

Brian Dodek

LT Environmental, Inc.

4600 West 60th Avenue

Arvada, CO 80003

RE: PDC - Avery 13, 23, 24-10 & 10B

Enclosed are the results of analyses for samples received by Summit Scientific on 08/12/10 17:00. If you have any questions concerning this report, please feel free to contact me.

Sincerely,

A handwritten signature in black ink, appearing to be 'BS' or 'Shrewsbury', written in a cursive style.

Ben Shrewsbury

President / Laboratory Director



LT Environmental, Inc.
4600 West 60th Avenue
Arvada CO, 80003

Project: PDC - Avery 13, 23, 24-10 & 10B

Project Number: PDC 08166
Project Manager: Brian Dodek

Reported:
08/13/10 08:55

ANALYTICAL REPORT FOR SAMPLES

Sample ID	Laboratory ID	Matrix	Date Sampled	Date Received
SS01@10'	R008054-01	Soil	08/12/10 12:00	08/12/10 17:00
SS02@10'	R008054-02	Soil	08/12/10 12:05	08/12/10 17:00
SS03@10'	R008054-03	Soil	08/12/10 12:10	08/12/10 17:00
SS04@10'	R008054-04	Soil	08/12/10 12:15	08/12/10 17:00
GW01@12'	R008054-05	Water	08/12/10 12:20	08/12/10 17:00

Summit Scientific

The results in this report apply to the samples analyzed in accordance with the chain of custody document. This analytical report must be reproduced in its entirety.

LT Environmental, Inc.
4600 West 60th Avenue
Arvada CO, 80003

Project: PDC - Avery 13, 23, 24-10 & 10B

Project Number: PDC 08166

Project Manager: Brian Dodek

Reported:

08/13/10 08:55

Summit Scientific 2008054

74 | Corporate Circle Suite I ♦ Golden, Colorado 80401
303-277-9310 ♦ 303-277-9531 Fax

Page 1 of 1

Client: LT Environmental, Inc.

Address: 4600 West 60th Avenue

City/State/Zip: Arvada, CO 80003

City/State/Zip. Alameda, CO 80002
Phone: (303) 433-0788

Phone: (303) 433-9700

Sampler Name: Devin Giv Fw

Project Manager:

E-Mail:

Project Name: A

Project Number:

Project number:

1

00

1

1000

Preservative						Matrix			Analyze For:							Special Instructions		
Sample Description	Date Sampled	Time Sampled	Number of Containers	HCl	HNO ₃	None	Other (Specify)	Groundwater	Soil	Air - Canister Serial #	Other (Specify)	DRO	GBTX	BTEX	Table 9.10 Full	Table 9.10 Short	pH / EC	SAR
				S501 @ 10'	8-12-10	1200	1		X				X			X		
S502 @ 10'		1205	1															
S503 @ 10'		1210	1															
S504 @ 10'		1215	1															
CW01 @ 10'		1220	3	X				X						X				
Relinquished by: _____ Date/Time: _____				Received by: _____ Date/Time: _____				Turn Around Time (Check) Same Day <input type="checkbox"/> 72 Hours <input type="checkbox"/> 24 Hours <input checked="" type="checkbox"/> Standard <input type="checkbox"/> 48 Hours <input type="checkbox"/>				Notes:						
Relinquished by: <i>Quinn Jordan 8-12-10</i>				Received by: <i>[Signature]</i> 8-12-10 1700								Sample Integrity: Temperature Upon Receipt: <i>5.0</i> Intact <input checked="" type="radio"/> Yes <input type="radio"/> No						
Relinquished by: _____ Date/Time: _____				Received in Lab by: _____ Date/Time: _____														

www.scientific.com

Summit Scientific

The results in this report apply to the samples analyzed in accordance with the chain of custody document. This analytical report must be reproduced in its entirety.



LT Environmental, Inc.
4600 West 60th Avenue
Arvada CO, 80003

Project: PDC - Avery 13, 23, 24-10 & 10B

Project Number: PDC 08166
Project Manager: Brian Dodek

Reported:
08/13/10 08:55

SS01@10'
R008054-01 (Soil)

Summit Scientific

Total Petroleum Hydrocarbons by 8015

Date Sampled: **08/12/10 12:00**

Analyte	Result	Reporting Limit	Units	Dilution	Batch	Prepared	Analyzed	Method	Notes
C10-C28 (DRO)	ND	50	mg/kg	1	0081204	08/12/10	08/12/10	8015 DRO	

Date Sampled: **08/12/10 12:00**

Analyte	Result	Reporting Limit	Units	Dilution	Batch	Prepared	Analyzed	Method	Notes
Surrogate: o-Terphenyl		119 %	88.8-124		"	"	"	"	

Volatile Organic Compounds by EPA Method 8260B

Date Sampled: **08/12/10 12:00**

Analyte	Result	Reporting Limit	Units	Dilution	Batch	Prepared	Analyzed	Method	Notes
Benzene	ND	0.0050	mg/kg	1	0081203	08/12/10	08/12/10	EPA 8260B	
Toluene	ND	0.0050	"	"	"	"	"	"	
Ethylbenzene	ND	0.0050	"	"	"	"	"	"	
Xylenes (total)	ND	0.0050	"	"	"	"	"	"	
Gasoline Range Hydrocarbons	ND	0.50	"	"	"	"	"	"	

Date Sampled: **08/12/10 12:00**

Analyte	Result	Reporting Limit	Units	Dilution	Batch	Prepared	Analyzed	Method	Notes
Surrogate: 1,2-Dichloroethane-d4		127 %	67.4-143		"	"	"	"	
Surrogate: Toluene-d8		100 %	77.3-114		"	"	"	"	
Surrogate: 4-Bromofluorobenzene		102 %	78.4-125		"	"	"	"	

Summit Scientific

The results in this report apply to the samples analyzed in accordance with the chain of custody document. This analytical report must be reproduced in its entirety.



LT Environmental, Inc.
4600 West 60th Avenue
Arvada CO, 80003

Project: PDC - Avery 13, 23, 24-10 & 10B

Project Number: PDC 08166
Project Manager: Brian Dodek

Reported:
08/13/10 08:55

SS02@10'
R008054-02 (Soil)

Summit Scientific

Total Petroleum Hydrocarbons by 8015

Date Sampled: **08/12/10 12:05**

Analyte	Result	Reporting Limit	Units	Dilution	Batch	Prepared	Analyzed	Method	Notes
C10-C28 (DRO)	ND	50	mg/kg	1	0081204	08/12/10	08/12/10	8015 DRO	

Date Sampled: **08/12/10 12:05**

Analyte	Result	Reporting Limit	Units	Dilution	Batch	Prepared	Analyzed	Method	Notes
Surrogate: o-Terphenyl		120 %	88.8-124		"	"	"	"	

Volatile Organic Compounds by EPA Method 8260B

Date Sampled: **08/12/10 12:05**

Analyte	Result	Reporting Limit	Units	Dilution	Batch	Prepared	Analyzed	Method	Notes
Benzene	ND	0.0050	mg/kg	1	0081203	08/12/10	08/12/10	EPA 8260B	
Toluene	ND	0.0050	"	"	"	"	"	"	
Ethylbenzene	ND	0.0050	"	"	"	"	"	"	
Xylenes (total)	ND	0.0050	"	"	"	"	"	"	
Gasoline Range Hydrocarbons	ND	0.50	"	"	"	"	"	"	

Date Sampled: **08/12/10 12:05**

Analyte	Result	Reporting Limit	Units	Dilution	Batch	Prepared	Analyzed	Method	Notes
Surrogate: 1,2-Dichloroethane-d4		125 %	67.4-143		"	"	"	"	
Surrogate: Toluene-d8		100 %	77.3-114		"	"	"	"	
Surrogate: 4-Bromofluorobenzene		107 %	78.4-125		"	"	"	"	

Summit Scientific

The results in this report apply to the samples analyzed in accordance with the chain of custody document. This analytical report must be reproduced in its entirety.



LT Environmental, Inc.
4600 West 60th Avenue
Arvada CO, 80003

Project: PDC - Avery 13, 23, 24-10 & 10B

Project Number: PDC 08166
Project Manager: Brian Dodek

Reported:
08/13/10 08:55

SS03@10'
R008054-03 (Soil)

Summit Scientific

Total Petroleum Hydrocarbons by 8015

Date Sampled: **08/12/10 12:10**

Analyte	Result	Reporting Limit	Units	Dilution	Batch	Prepared	Analyzed	Method	Notes
C10-C28 (DRO)	ND	50	mg/kg	1	0081204	08/12/10	08/12/10	8015 DRO	

Date Sampled: **08/12/10 12:10**

Analyte	Result	Reporting Limit	Units	Dilution	Batch	Prepared	Analyzed	Method	Notes
Surrogate: o-Terphenyl		107 %	88.8-124		"	"	"	"	

Volatile Organic Compounds by EPA Method 8260B

Date Sampled: **08/12/10 12:10**

Analyte	Result	Reporting Limit	Units	Dilution	Batch	Prepared	Analyzed	Method	Notes
Benzene	ND	0.0050	mg/kg	1	0081203	08/12/10	08/12/10	EPA 8260B	
Toluene	ND	0.0050	"	"	"	"	"	"	
Ethylbenzene	ND	0.0050	"	"	"	"	"	"	
Xylenes (total)	ND	0.0050	"	"	"	"	"	"	
Gasoline Range Hydrocarbons	ND	0.50	"	"	"	"	"	"	

Date Sampled: **08/12/10 12:10**

Analyte	Result	Reporting Limit	Units	Dilution	Batch	Prepared	Analyzed	Method	Notes
Surrogate: 1,2-Dichloroethane-d4		135 %	67.4-143		"	"	"	"	
Surrogate: Toluene-d8		103 %	77.3-114		"	"	"	"	
Surrogate: 4-Bromofluorobenzene		107 %	78.4-125		"	"	"	"	

Summit Scientific

The results in this report apply to the samples analyzed in accordance with the chain of custody document. This analytical report must be reproduced in its entirety.



LT Environmental, Inc.
4600 West 60th Avenue
Arvada CO, 80003

Project: PDC - Avery 13, 23, 24-10 & 10B

Project Number: PDC 08166
Project Manager: Brian Dodek

Reported:
08/13/10 08:55

SS04@10'
R008054-04 (Soil)

Summit Scientific

Total Petroleum Hydrocarbons by 8015

Date Sampled: **08/12/10 12:15**

Analyte	Result	Reporting Limit	Units	Dilution	Batch	Prepared	Analyzed	Method	Notes
C10-C28 (DRO)	ND	50	mg/kg	1	0081204	08/12/10	08/12/10	8015 DRO	

Date Sampled: **08/12/10 12:15**

Analyte	Result	Reporting Limit	Units	Dilution	Batch	Prepared	Analyzed	Method	Notes
Surrogate: o-Terphenyl		111 %	88.8-124		"	"	"	"	

Volatile Organic Compounds by EPA Method 8260B

Date Sampled: **08/12/10 12:15**

Analyte	Result	Reporting Limit	Units	Dilution	Batch	Prepared	Analyzed	Method	Notes
Benzene	ND	0.0050	mg/kg	1	0081203	08/12/10	08/12/10	EPA 8260B	
Toluene	ND	0.0050	"	"	"	"	"	"	
Ethylbenzene	ND	0.0050	"	"	"	"	"	"	
Xylenes (total)	ND	0.0050	"	"	"	"	"	"	
Gasoline Range Hydrocarbons	ND	0.50	"	"	"	"	"	"	

Date Sampled: **08/12/10 12:15**

Analyte	Result	Reporting Limit	Units	Dilution	Batch	Prepared	Analyzed	Method	Notes
Surrogate: 1,2-Dichloroethane-d4		133 %	67.4-143		"	"	"	"	
Surrogate: Toluene-d8		100 %	77.3-114		"	"	"	"	
Surrogate: 4-Bromofluorobenzene		109 %	78.4-125		"	"	"	"	

Summit Scientific

The results in this report apply to the samples analyzed in accordance with the chain of custody document. This analytical report must be reproduced in its entirety.



LT Environmental, Inc.
4600 West 60th Avenue
Arvada CO, 80003

Project: PDC - Avery 13, 23, 24-10 & 10B
Project Number: PDC 08166
Project Manager: Brian Dodek

Reported:
08/13/10 08:55

GW01@12'
R008054-05 (Water)

Summit Scientific

Volatile Organic Compounds by EPA Method 8260B

Date Sampled: **08/12/10 12:20**

Analyte	Result	Reporting		Units	Dilution	Batch	Prepared	Analyzed	Method	Notes
		Limit								
Benzene	1600	50		ug/l	50	0081205	08/12/10	08/12/10	EPA 8260B	
Toluene	2800	50		"	"	"	"	"	"	
Ethylbenzene	110	50		"	"	"	"	"	"	
Xylenes (total)	1400	50		"	"	"	"	"	"	

Date Sampled: **08/12/10 12:20**

Analyte	Result	Reporting		Units	Dilution	Batch	Prepared	Analyzed	Method	Notes
		Limit								
<i>Surrogate: 1,2-Dichloroethane-d4</i>		102 %		57.9-139		"	"	"	"	
<i>Surrogate: Toluene-d8</i>		110 %		83.1-115		"	"	"	"	
<i>Surrogate: 4-Bromofluorobenzene</i>		108 %		80.8-120		"	"	"	"	

Summit Scientific

The results in this report apply to the samples analyzed in accordance with the chain of custody document. This analytical report must be reproduced in its entirety.



LT Environmental, Inc.
4600 West 60th Avenue
Arvada CO, 80003

Project: PDC - Avery 13, 23, 24-10 & 10B
Project Number: PDC 08166
Project Manager: Brian Dodek

Reported:
08/13/10 08:55

Total Petroleum Hydrocarbons by 8015 - Quality Control
Summit Scientific

Analyte	Reporting			Spike	Source		%REC		RPD	
	Result	Limit	Units	Level	Result	%REC	Limits	RPD	Limit	Notes

Batch 0081204 - EPA 3550A

Blank (0081204-BLK1)

Prepared: 08/12/10 Analyzed: 08/13/10

C10-C28 (DRO) ND 50 mg/kg

Surrogate: o-Terphenyl 13.8 " 12.5 110 88.8-124

LCS (0081204-BS1)

Prepared: 08/12/10 Analyzed: 08/13/10

C10-C28 (DRO) 604 50 mg/kg 500 121 81.4-129 9.26

LCS Dup (0081204-BSD1)

Prepared: 08/12/10 Analyzed: 08/13/10

C10-C28 (DRO) 504 50 mg/kg 500 101 81.4-129 18.1 9.26

Summit Scientific

The results in this report apply to the samples analyzed in accordance with the chain of custody document. This analytical report must be reproduced in its entirety.



LT Environmental, Inc.
4600 West 60th Avenue
Arvada CO, 80003

Project: PDC - Avery 13, 23, 24-10 & 10B
Project Number: PDC 08166
Project Manager: Brian Dodek

Reported:
08/13/10 08:55

Volatile Organic Compounds by EPA Method 8260B - Quality Control
Summit Scientific

Analyte	Reporting			Spike	Source		%REC		RPD	
	Result	Limit	Units	Level	Result	%REC	Limits	RPD	Limit	Notes

Batch 0081203 - EPA 5030 Soil MS

Blank (0081203-BLK1)

Prepared: 08/12/10 Analyzed: 08/13/10

Benzene	ND	0.0050	mg/kg							
Toluene	ND	0.0050	"							
Ethylbenzene	ND	0.0050	"							
Xylenes (total)	ND	0.0050	"							
Gasoline Range Hydrocarbons	ND	0.50	"							
Surrogate: 1,2-Dichloroethane-d4	0.0440		"	0.0400		110	67.4-143			
Surrogate: Toluene-d8	0.0389		"	0.0400		97.4	77.3-114			
Surrogate: 4-Bromofluorobenzene	0.0415		"	0.0400		104	78.4-125			

LCS (0081203-BS1)

Prepared: 08/12/10 Analyzed: 08/13/10

Benzene	0.0907	0.0050	mg/kg	0.100		90.7	61-139		11.1	
Toluene	0.0801	0.0050	"	0.100		80.1	64-132		10.9	
Ethylbenzene	0.0982	0.0050	"	0.100		98.2	68.7-135		20	
m,p-Xylene	0.185	0.010	"	0.200		92.5	70.4-129		20	
o-Xylene	0.0901	0.0050	"	0.100		90.1	66.9-126		20	
Surrogate: 1,2-Dichloroethane-d4	0.0449		"	0.0400		112	67.4-143			
Surrogate: Toluene-d8	0.0406		"	0.0400		101	77.3-114			
Surrogate: 4-Bromofluorobenzene	0.0393		"	0.0400		98.2	78.4-125			

LCS Dup (0081203-BSD1)

Prepared: 08/12/10 Analyzed: 08/13/10

Benzene	0.0974	0.0050	mg/kg	0.100		97.4	61-139	7.14	11.1	
Toluene	0.0868	0.0050	"	0.100		86.8	64-132	8.01	10.9	
Ethylbenzene	0.104	0.0050	"	0.100		104	68.7-135	6.07	20	
m,p-Xylene	0.200	0.010	"	0.200		100	70.4-129	7.90	20	
o-Xylene	0.0970	0.0050	"	0.100		97.0	66.9-126	7.31	20	
Surrogate: 1,2-Dichloroethane-d4	0.0454		"	0.0400		113	67.4-143			
Surrogate: Toluene-d8	0.0409		"	0.0400		102	77.3-114			
Surrogate: 4-Bromofluorobenzene	0.0395		"	0.0400		98.8	78.4-125			

Summit Scientific

The results in this report apply to the samples analyzed in accordance with the chain of custody document. This analytical report must be reproduced in its entirety.



LT Environmental, Inc.
4600 West 60th Avenue
Arvada CO, 80003

Project: PDC - Avery 13, 23, 24-10 & 10B
Project Number: PDC 08166
Project Manager: Brian Dodek

Reported:
08/13/10 08:55

Volatile Organic Compounds by EPA Method 8260B - Quality Control
Summit Scientific

Analyte	Reporting			Spike	Source		%REC		RPD	
	Result	Limit	Units	Level	Result	%REC	Limits	RPD	Limit	Notes

Batch 0081203 - EPA 5030 Soil MS

Matrix Spike (0081203-MS1)		Source: R008046-01			Prepared: 08/12/10		Analyzed: 08/13/10			
Benzene	0.0716	0.0050	mg/kg	0.100	ND	71.6	42.9-137		17.9	
Toluene	0.0628	0.0050	"	0.100	ND	62.8	42.6-130		11.9	
Ethylbenzene	0.0862	0.0050	"	0.100	ND	86.2	39-133		20	
m,p-Xylene	0.150	0.010	"	0.200	ND	75.1	34.7-134		20	
o-Xylene	0.0785	0.0050	"	0.100	ND	78.5	41.3-126		20	
Surrogate: 1,2-Dichloroethane-d4	0.0495		"	0.0400		124	67.4-143			
Surrogate: Toluene-d8	0.0404		"	0.0400		101	77.3-114			
Surrogate: 4-Bromofluorobenzene	0.0398		"	0.0400		99.5	78.4-125			
Matrix Spike Dup (0081203-MSD1)		Source: R008046-01			Prepared: 08/12/10		Analyzed: 08/13/10			
Benzene	0.0572	0.0050	mg/kg	0.100	ND	57.2	42.9-137	22.3	17.9	
Toluene	0.0500	0.0050	"	0.100	ND	50.0	42.6-130	22.7	11.9	
Ethylbenzene	0.0904	0.0050	"	0.100	ND	90.4	39-133	4.72	20	
m,p-Xylene	0.162	0.010	"	0.200	ND	80.9	34.7-134	7.48	20	
o-Xylene	0.0786	0.0050	"	0.100	ND	78.6	41.3-126	0.153	20	
Surrogate: 1,2-Dichloroethane-d4	0.0501		"	0.0400		125	67.4-143			
Surrogate: Toluene-d8	0.0406		"	0.0400		101	77.3-114			
Surrogate: 4-Bromofluorobenzene	0.0399		"	0.0400		99.8	78.4-125			

Summit Scientific

The results in this report apply to the samples analyzed in accordance with the chain of custody document. This analytical report must be reproduced in its entirety.



LT Environmental, Inc.
4600 West 60th Avenue
Arvada CO, 80003

Project: PDC - Avery 13, 23, 24-10 & 10B

Project Number: PDC 08166
Project Manager: Brian Dodek

Reported:
08/13/10 08:55

Notes and Definitions

DET Analyte DETECTED
ND Analyte NOT DETECTED at or above the reporting limit
NR Not Reported
dry Sample results reported on a dry weight basis
RPD Relative Percent Difference

Summit Scientific

The results in this report apply to the samples analyzed in accordance with the chain of custody document. This analytical report must be reproduced in its entirety.

A handwritten signature in black ink, appearing to be 'JMM'.

Summit Scientific

741 Corporate Circle – Suite I ♦ Golden, Colorado 80401

303.277.9310 - laboratory ♦ 303.277.9531 - fax

August 23, 2010

Brian Dodek

LT Environmental, Inc.

4600 West 60th Avenue

Arvada, CO 80003

RE: PDC - Avery 13, 23, 24-10 & 10B

Enclosed are the results of analyses for samples received by Summit Scientific on 08/20/10 17:00. If you have any questions concerning this report, please feel free to contact me.

Sincerely,

A handwritten signature in blue ink, appearing to be 'PS' followed by a long, sweeping horizontal line.

Paul Shrewsbury For Ben Shrewsbury
President / Laboratory Director

LT Environmental, Inc.
4600 West 60th Avenue
Arvada CO, 80003

Project: PDC - Avery 13, 23, 24-10 & 10B

Project Number: PDC 10025.05
Project Manager: Brian Dodek

Reported:
08/23/10 07:57

ANALYTICAL REPORT FOR SAMPLES

Sample ID	Laboratory ID	Matrix	Date Sampled	Date Received
GW02	R008117-01	Water	08/20/10 11:25	08/20/10 17:00

Summit Scientific 2008/17

741 Corporate Circle Suite 1 ♦ Golden, Colorado 80401
303-277-9310 ♦ 303-277-9531 Fax

Page 7 of 1

Client: I.T. Environmental, Inc.

Address: 4600 West 60th Avenue

Project Manager: Brian Dodek

E-Mail:

E-Mail: bdodek@itenv.comCity/State/Zip: Alameda, CO 80002
Phone: (303) 433-9788
Fax: (303) 433-1432

Phone: (303) 433-9788 Fax: (303) 433-1432

Project Name: Avery 10B 13 23-10 24-10D

Project Number: PDC10025.05

Sample Description	Date Sampled	Time Sampled	Number of Containers	Preservative				Matrix		Analyze For:						Special Instructions	
				HCl	HNO ₃	None	Other (Specify)	Groundwater	Soil	Air - Canister Serial #	Other (Specify)	GBTEX	BTEX	Table 9.10 Full	Table 9.10 Short		pH / EC
GWDZ	8-20-10	125	3	X					X								
Relinquished by: [Signature]	Date/Time: 8-20-10	Received by: [Signature] Date/Time: 8-30-10 1700							Turn Around Time (Check) <input type="checkbox"/> Same Day <input checked="" type="checkbox"/> 24 Hours <input type="checkbox"/> 48 Hours <input type="checkbox"/> 72 Hours Standard						Notes: Results by Monday (8/31/10) morning.		
Relinquished by:	Date/Time:	Received in Lab by: Date/Time:							Sample Integrity: Temperature Upon Receipt: 50 Intact: Yes No								

www.sciencedirect.com

Summit Scientific

The results in this report apply to the samples analyzed in accordance with the chain of custody document. This analytical report must be reproduced in its entirety.





LT Environmental, Inc.
4600 West 60th Avenue
Arvada CO, 80003

Project: PDC - Avery 13, 23, 24-10 & 10B

Project Number: PDC 10025.05
Project Manager: Brian Dodek

Reported:
08/23/10 07:57

GW02
R008117-01 (Water)

Summit Scientific

Volatile Organic Compounds by EPA Method 8260B

Date Sampled: **08/20/10 11:25**

Analyte	Result	Reporting Limit	Units	Dilution	Batch	Prepared	Analyzed	Method	Notes
Benzene	27	1.0	ug/l	1	0082008	08/20/10	08/21/10	EPA 8260B	
Toluene	ND	1.0	"	"	"	"	"	"	
Ethylbenzene	2.3	1.0	"	"	"	"	"	"	
Xylenes (total)	42	1.0	"	"	"	"	"	"	

Date Sampled: **08/20/10 11:25**

Analyte	Result	Reporting Limit	Units	Dilution	Batch	Prepared	Analyzed	Method	Notes
<i>Surrogate: 1,2-Dichloroethane-d4</i>		126 %	57.9-139		"	"	"	"	
<i>Surrogate: Toluene-d8</i>		95.3 %	83.1-115		"	"	"	"	
<i>Surrogate: 4-Bromofluorobenzene</i>		93.4 %	80.8-120		"	"	"	"	

Summit Scientific

The results in this report apply to the samples analyzed in accordance with the chain of custody document. This analytical report must be reproduced in its entirety.



LT Environmental, Inc.
4600 West 60th Avenue
Arvada CO, 80003

Project: PDC - Avery 13, 23, 24-10 & 10B
Project Number: PDC 10025.05
Project Manager: Brian Dodek

Reported:
08/23/10 07:57

Volatile Organic Compounds by EPA Method 8260B - Quality Control

Summit Scientific

Analyte	Reporting			Spike	Source		%REC		RPD	
	Result	Limit	Units	Level	Result	%REC	Limits	RPD	Limit	Notes

Batch 0082008 - EPA 5030 Water MS

Blank (0082008-BLK1)

Prepared & Analyzed: 08/20/10

Benzene	ND	1.0	ug/l							
Toluene	ND	1.0	"							
Ethylbenzene	ND	1.0	"							
Xylenes (total)	ND	1.0	"							
Surrogate: 1,2-Dichloroethane-d4	12.8		"	13.3		96.2	57.9-139			
Surrogate: Toluene-d8	12.3		"	13.3		92.3	83.1-115			
Surrogate: 4-Bromofluorobenzene	12.3		"	13.3		92.4	80.8-120			

LCS (0082008-BS1)

Prepared & Analyzed: 08/20/10

Benzene	26.1	1.0	ug/l	33.3		78.2	60.1-131		10.9	
Toluene	25.9	1.0	"	33.3		77.7	65.9-127		11.3	
Ethylbenzene	34.0	1.0	"	33.3		102	65.1-129		20	
m,p-Xylene	68.4	2.0	"	66.7		103	66.8-127		20	
o-Xylene	31.2	1.0	"	33.3		93.5	61.2-120		20	
Surrogate: 1,2-Dichloroethane-d4	14.2		"	13.3		107	57.9-139			
Surrogate: Toluene-d8	12.6		"	13.3		94.2	83.1-115			
Surrogate: 4-Bromofluorobenzene	12.5		"	13.3		93.8	80.8-120			

LCS (0082008-BS2)

Prepared & Analyzed: 08/20/10

Benzene	27.1	1.0	ug/l	33.3		81.4	60.1-131		10.9	
Toluene	27.0	1.0	"	33.3		81.2	65.9-127		11.3	
Ethylbenzene	34.1	1.0	"	33.3		102	65.1-129		20	
m,p-Xylene	67.7	2.0	"	66.7		102	66.8-127		20	
o-Xylene	31.0	1.0	"	33.3		92.9	61.2-120		20	
Surrogate: 1,2-Dichloroethane-d4	14.8		"	13.3		111	57.9-139			
Surrogate: Toluene-d8	13.1		"	13.3		98.3	83.1-115			
Surrogate: 4-Bromofluorobenzene	12.5		"	13.3		93.8	80.8-120			

Summit Scientific

The results in this report apply to the samples analyzed in accordance with the chain of custody document. This analytical report must be reproduced in its entirety.



LT Environmental, Inc.
4600 West 60th Avenue
Arvada CO, 80003

Project: PDC - Avery 13, 23, 24-10 & 10B
Project Number: PDC 10025.05
Project Manager: Brian Dodek

Reported:
08/23/10 07:57

Volatile Organic Compounds by EPA Method 8260B - Quality Control
Summit Scientific

Analyte	Reporting			Spike	Source		%REC		RPD	
	Result	Limit	Units	Level	Result	%REC	Limits	RPD	Limit	Notes

Batch 0082008 - EPA 5030 Water MS

LCS Dup (0082008-BSD1)

Prepared & Analyzed: 08/20/10

Benzene	24.6	1.0	ug/l	33.3		73.9	60.1-131	5.60	10.9	
Toluene	24.6	1.0	"	33.3		73.7	65.9-127	5.23	11.3	
Ethylbenzene	31.7	1.0	"	33.3		95.0	65.1-129	7.01	20	
m,p-Xylene	62.8	2.0	"	66.7		94.3	66.8-127	8.52	20	
o-Xylene	29.6	1.0	"	33.3		88.9	61.2-120	5.07	20	
Surrogate: 1,2-Dichloroethane-d4	13.1		"	13.3		98.3	57.9-139			
Surrogate: Toluene-d8	12.6		"	13.3		94.3	83.1-115			
Surrogate: 4-Bromofluorobenzene	12.8		"	13.3		95.7	80.8-120			

LCS Dup (0082008-BSD2)

Prepared & Analyzed: 08/20/10

Benzene	25.3	1.0	ug/l	33.3		76.0	60.1-131	6.90	10.9	
Toluene	25.4	1.0	"	33.3		76.1	65.9-127	6.45	11.3	
Ethylbenzene	32.4	1.0	"	33.3		97.4	65.1-129	5.08	20	
m,p-Xylene	64.0	2.0	"	66.7		96.0	66.8-127	5.65	20	
o-Xylene	29.5	1.0	"	33.3		88.4	61.2-120	4.90	20	
Surrogate: 1,2-Dichloroethane-d4	14.3		"	13.3		107	57.9-139			
Surrogate: Toluene-d8	12.5		"	13.3		93.8	83.1-115			
Surrogate: 4-Bromofluorobenzene	12.5		"	13.3		93.7	80.8-120			

Matrix Spike (0082008-MS1)

Source: R008082-01

Prepared: 08/20/10 Analyzed: 08/21/10

Benzene	24.9	1.0	ug/l	33.3	ND	74.7	52.7-130		19.3	
Toluene	25.0	1.0	"	33.3	ND	74.9	57-127		18.7	
Ethylbenzene	32.7	1.0	"	33.3	ND	98.1	59.2-127		20	
m,p-Xylene	62.2	2.0	"	66.7	ND	93.3	53.2-132		20	
o-Xylene	29.9	1.0	"	33.3	ND	89.8	56.3-117		20	
Surrogate: 1,2-Dichloroethane-d4	14.4		"	13.3		108	57.9-139			
Surrogate: Toluene-d8	12.7		"	13.3		95.5	83.1-115			
Surrogate: 4-Bromofluorobenzene	12.9		"	13.3		97.1	80.8-120			

Summit Scientific

The results in this report apply to the samples analyzed in accordance with the chain of custody document. This analytical report must be reproduced in its entirety.



LT Environmental, Inc.
4600 West 60th Avenue
Arvada CO, 80003

Project: PDC - Avery 13, 23, 24-10 & 10B
Project Number: PDC 10025.05
Project Manager: Brian Dodek

Reported:
08/23/10 07:57

Volatile Organic Compounds by EPA Method 8260B - Quality Control
Summit Scientific

Analyte	Reporting			Spike	Source		%REC		RPD	
	Result	Limit	Units	Level	Result	%REC	Limits	RPD	Limit	Notes

Batch 0082008 - EPA 5030 Water MS

Matrix Spike (0082008-MS2)		Source: R008082-02			Prepared: 08/20/10		Analyzed: 08/21/10			
Benzene	25.4	1.0	ug/l	33.3	15.0	31.2	52.7-130		19.3	
Toluene	24.9	1.0	"	33.3	ND	74.8	57-127		18.7	
Ethylbenzene	32.6	1.0	"	33.3	ND	97.9	59.2-127		20	
m,p-Xylene	63.9	2.0	"	66.7	ND	95.8	53.2-132		20	
o-Xylene	29.5	1.0	"	33.3	ND	88.5	56.3-117		20	
Surrogate: 1,2-Dichloroethane-d4	14.5		"	13.3		109	57.9-139			
Surrogate: Toluene-d8	12.8		"	13.3		96.0	83.1-115			
Surrogate: 4-Bromofluorobenzene	12.7		"	13.3		95.4	80.8-120			

Matrix Spike Dup (0082008-MSD1)		Source: R008082-01			Prepared: 08/20/10		Analyzed: 08/21/10			
Benzene	24.1	1.0	ug/l	33.3	ND	72.2	52.7-130	3.35	19.3	
Toluene	24.2	1.0	"	33.3	ND	72.7	57-127	2.97	18.7	
Ethylbenzene	32.4	1.0	"	33.3	ND	97.2	59.2-127	0.953	20	
m,p-Xylene	64.4	2.0	"	66.7	ND	96.7	53.2-132	3.57	20	
o-Xylene	30.3	1.0	"	33.3	ND	90.8	56.3-117	1.10	20	
Surrogate: 1,2-Dichloroethane-d4	13.8		"	13.3		104	57.9-139			
Surrogate: Toluene-d8	11.7		"	13.3		87.8	83.1-115			
Surrogate: 4-Bromofluorobenzene	12.7		"	13.3		95.4	80.8-120			

Matrix Spike Dup (0082008-MSD2)		Source: R008082-02			Prepared: 08/20/10		Analyzed: 08/21/10			
Benzene	24.9	1.0	ug/l	33.3	15.0	29.6	52.7-130	2.11	19.3	
Toluene	24.6	1.0	"	33.3	ND	73.7	57-127	1.50	18.7	
Ethylbenzene	32.9	1.0	"	33.3	ND	98.7	59.2-127	0.854	20	
m,p-Xylene	62.8	2.0	"	66.7	ND	94.3	53.2-132	1.64	20	
o-Xylene	30.3	1.0	"	33.3	ND	91.0	56.3-117	2.81	20	
Surrogate: 1,2-Dichloroethane-d4	14.0		"	13.3		105	57.9-139			
Surrogate: Toluene-d8	12.4		"	13.3		92.9	83.1-115			
Surrogate: 4-Bromofluorobenzene	13.0		"	13.3		97.3	80.8-120			

Summit Scientific

The results in this report apply to the samples analyzed in accordance with the chain of custody document. This analytical report must be reproduced in its entirety.



LT Environmental, Inc.
4600 West 60th Avenue
Arvada CO, 80003

Project: PDC - Avery 13, 23, 24-10 & 10B

Project Number: PDC 10025.05
Project Manager: Brian Dodek

Reported:
08/23/10 07:57

Notes and Definitions

DET Analyte DETECTED
ND Analyte NOT DETECTED at or above the reporting limit
NR Not Reported
dry Sample results reported on a dry weight basis
RPD Relative Percent Difference

Summit Scientific

A handwritten signature in black ink, appearing to be 'JD' or similar, with a long horizontal stroke extending to the right.

The results in this report apply to the samples analyzed in accordance with the chain of custody document. This analytical report must be reproduced in its entirety.

Summit Scientific

741 Corporate Circle – Suite I ♦ Golden, Colorado 80401

303.277.9310 - laboratory ♦ 303.277.9531 - fax

September 04, 2010

Brian Dodek
LT Environmental, Inc.
4600 West 60th Avenue
Arvada, CO 80003
RE: PDC - Avery

Enclosed are the results of analyses for samples received by Summit Scientific on 08/31/10 17:20. If you have any questions concerning this report, please feel free to contact me.

Sincerely,

A handwritten signature in blue ink, appearing to be 'PS' followed by a long horizontal flourish.

Paul Shrewsbury For Ben Shrewsbury
President / Laboratory Director



LT Environmental, Inc.
4600 West 60th Avenue
Arvada CO, 80003

Project: PDC - Avery
Project Number: PDC 08167.05
Project Manager: Brian Dodek

Reported:
09/04/10 15:22

ANALYTICAL REPORT FOR SAMPLES

Sample ID	Laboratory ID	Matrix	Date Sampled	Date Received
GW02	R009001-01	Water	08/31/10 12:30	08/31/10 17:20
GW03	R009001-02	Water	08/31/10 12:40	08/31/10 17:20

Summit Scientific

The results in this report apply to the samples analyzed in accordance with the chain of custody document. This analytical report must be reproduced in its entirety.

LT Environmental, Inc.
4600 West 60th Avenue
Arvada CO, 80003

Project: PDC - Avery

Project Number: PDC 08167.05

Project Manager: Brian Dodek

Reported:

09/04/10 15:22

Summit Scientific

74 | Corporate Circle Suite I ♦ Golden, Colorado 80401
303-277-9310 ♦ 303-277-9531 Fax

Page / of /

Client: LT Environmental, Inc.

Address; 4600 West 60th Avenue

City/State/Zip: Arvada, CO 80003

phone: (303) 433-9788

Telephone: (303) 425-9700

Sampler Name: Devin Durrant

Project Manager: Brian Dodek

E-Mail: bdodek@ltnv.comProject Name: AveryProject Name: 7101
Project Number: DDC 08/1506

Project Number: 16V0210-507

Preservative						Matrix			Analyze For:					Special Instructions				
Date Sampled	Time Sampled	Number of Containers	HCl	HNO ₃	None	Other (Specify)	Groundwater	Soil	Air - Canister Serial #	Other (Specify)	DRO	GBTEX	BTEX		Table 9.10 Full	Table 9.10 Short	PH / EC	SAR
Sample Description																		
GWB2	8-3-10	1230	X				X			Air - Canister Serial #				X				
GWB3	↓	1240	X				X							X				
Relinquished by:	Date/Time:	Received by:							Date/Time:	Turn Around Time (Check)					Notes:			
John Smith 8-3-10 1720		JAS 8-31-10 1720											Same Day 24 Hours 48 Hours	72 Hours Standard	<input checked="" type="checkbox"/>	wit call w/harm.		
Relinquished by:	Date/Time:	Received by:							Date/Time:						Sample Integrity: Temperature Upon Receipt: 5.0 Intact: (Yes) No			

www.e2scientific.com

Summit Scientific

The results in this report apply to the samples analyzed in accordance with the chain of custody document. This analytical report must be reproduced in its entirety.





LT Environmental, Inc.
4600 West 60th Avenue
Arvada CO, 80003

Project: PDC - Avery
Project Number: PDC 08167.05
Project Manager: Brian Dodek

Reported:
09/04/10 15:22

GW02
R009001-01 (Water)

Summit Scientific

Volatile Organic Compounds by EPA Method 8260B

Date Sampled: **08/31/10 12:30**

Analyte	Result	Reporting Limit	Units	Dilution	Batch	Prepared	Analyzed	Method	Notes
Benzene	ND	1.0	ug/l	1	0090106	09/01/10	09/03/10	EPA 8260B	
Toluene	ND	1.0	"	"	"	"	"	"	
Ethylbenzene	ND	1.0	"	"	"	"	"	"	
Xylenes (total)	ND	1.0	"	"	"	"	"	"	

Date Sampled: **08/31/10 12:30**

Analyte	Result	Reporting Limit	Units	Dilution	Batch	Prepared	Analyzed	Method	Notes
Surrogate: 1,2-Dichloroethane-d4		128 %	57.9-139		"	"	"	"	
Surrogate: Toluene-d8		90.9 %	83.1-115		"	"	"	"	
Surrogate: 4-Bromofluorobenzene		94.0 %	80.8-120		"	"	"	"	

Summit Scientific

The results in this report apply to the samples analyzed in accordance with the chain of custody document. This analytical report must be reproduced in its entirety.



LT Environmental, Inc.
4600 West 60th Avenue
Arvada CO, 80003

Project: PDC - Avery
Project Number: PDC 08167.05
Project Manager: Brian Dodek

Reported:
09/04/10 15:22

GW03
R009001-02 (Water)

Summit Scientific

Volatile Organic Compounds by EPA Method 8260B

Date Sampled: **08/31/10 12:40**

Analyte	Result	Reporting Limit	Units	Dilution	Batch	Prepared	Analyzed	Method	Notes
Benzene	ND	1.0	ug/l	1	0090106	09/01/10	09/03/10	EPA 8260B	
Toluene	ND	1.0	"	"	"	"	"	"	
Ethylbenzene	ND	1.0	"	"	"	"	"	"	
Xylenes (total)	ND	1.0	"	"	"	"	"	"	

Date Sampled: **08/31/10 12:40**

Analyte	Result	Reporting Limit	Units	Dilution	Batch	Prepared	Analyzed	Method	Notes
Surrogate: 1,2-Dichloroethane-d4		126 %	57.9-139		"	"	"	"	
Surrogate: Toluene-d8		90.1 %	83.1-115		"	"	"	"	
Surrogate: 4-Bromofluorobenzene		93.2 %	80.8-120		"	"	"	"	

Summit Scientific

The results in this report apply to the samples analyzed in accordance with the chain of custody document. This analytical report must be reproduced in its entirety.



LT Environmental, Inc.
4600 West 60th Avenue
Arvada CO, 80003

Project: PDC - Avery
Project Number: PDC 08167.05
Project Manager: Brian Dodek

Reported:
09/04/10 15:22

Volatile Organic Compounds by EPA Method 8260B - Quality Control

Summit Scientific

Analyte	Reporting			Spike	Source		%REC		RPD	
	Result	Limit	Units	Level	Result	%REC	Limits	RPD	Limit	Notes

Batch 0090106 - EPA 5030 Water MS

Blank (0090106-BLK1)

Prepared & Analyzed: 09/01/10

Benzene	ND	1.0	ug/l							
Toluene	ND	1.0	"							
Ethylbenzene	ND	1.0	"							
Xylenes (total)	ND	1.0	"							
Surrogate: 1,2-Dichloroethane-d4	16.6		"	13.3	124	57.9-139				
Surrogate: Toluene-d8	12.0		"	13.3	90.2	83.1-115				
Surrogate: 4-Bromofluorobenzene	12.2		"	13.3	91.7	80.8-120				

LCS (0090106-BS1)

Prepared & Analyzed: 09/01/10

Benzene	23.8	1.0	ug/l	33.3	71.5	60.1-131			10.9	
Toluene	25.2	1.0	"	33.3	75.7	65.9-127			11.3	
Ethylbenzene	34.1	1.0	"	33.3	102	65.1-129			20	
m,p-Xylene	70.3	2.0	"	66.7	105	66.8-127			20	
o-Xylene	32.5	1.0	"	33.3	97.4	61.2-120			20	
Surrogate: 1,2-Dichloroethane-d4	17.8		"	13.3	133	57.9-139				
Surrogate: Toluene-d8	12.4		"	13.3	92.9	83.1-115				
Surrogate: 4-Bromofluorobenzene	12.0		"	13.3	90.0	80.8-120				

LCS Dup (0090106-BSD1)

Prepared & Analyzed: 09/01/10

Benzene	23.4	1.0	ug/l	33.3	70.2	60.1-131	1.82		10.9	
Toluene	24.0	1.0	"	33.3	72.1	65.9-127	4.83		11.3	
Ethylbenzene	33.9	1.0	"	33.3	102	65.1-129	0.705		20	
m,p-Xylene	70.1	2.0	"	66.7	105	66.8-127	0.185		20	
o-Xylene	32.8	1.0	"	33.3	98.6	61.2-120	1.16		20	
Surrogate: 1,2-Dichloroethane-d4	17.3		"	13.3	130	57.9-139				
Surrogate: Toluene-d8	12.2		"	13.3	91.4	83.1-115				
Surrogate: 4-Bromofluorobenzene	12.1		"	13.3	91.1	80.8-120				

Summit Scientific

The results in this report apply to the samples analyzed in accordance with the chain of custody document. This analytical report must be reproduced in its entirety.



LT Environmental, Inc.
4600 West 60th Avenue
Arvada CO, 80003

Project: PDC - Avery
Project Number: PDC 08167.05
Project Manager: Brian Dodek

Reported:
09/04/10 15:22

Volatile Organic Compounds by EPA Method 8260B - Quality Control
Summit Scientific

Analyte	Reporting			Spike	Source		%REC		RPD	
	Result	Limit	Units	Level	Result	%REC	Limits	RPD	Limit	Notes

Batch 0090106 - EPA 5030 Water MS

Matrix Spike (0090106-MS1)				Source: R008158-01		Prepared: 09/01/10		Analyzed: 09/02/10		
Benzene	22.6	1.0	ug/l	33.3	ND	67.9	52.7-130		19.3	
Toluene	23.5	1.0	"	33.3	ND	70.6	57-127		18.7	
Ethylbenzene	32.3	1.0	"	33.3	ND	96.8	59.2-127		20	
m,p-Xylene	65.8	2.0	"	66.7	ND	98.7	53.2-132		20	
o-Xylene	31.2	1.0	"	33.3	ND	93.5	56.3-117		20	
Surrogate: 1,2-Dichloroethane-d4	17.4		"	13.3		130	57.9-139			
Surrogate: Toluene-d8	12.2		"	13.3		91.7	83.1-115			
Surrogate: 4-Bromofluorobenzene	12.0		"	13.3		89.8	80.8-120			
Matrix Spike Dup (0090106-MSD1)				Source: R008158-01		Prepared: 09/01/10		Analyzed: 09/02/10		
Benzene	22.8	1.0	ug/l	33.3	ND	68.5	52.7-130	0.792	19.3	
Toluene	23.5	1.0	"	33.3	ND	70.4	57-127	0.213	18.7	
Ethylbenzene	32.3	1.0	"	33.3	ND	96.8	59.2-127	0.0310	20	
m,p-Xylene	65.7	2.0	"	66.7	ND	98.5	53.2-132	0.167	20	
o-Xylene	30.0	1.0	"	33.3	ND	90.1	56.3-117	3.76	20	
Surrogate: 1,2-Dichloroethane-d4	17.9		"	13.3		134	57.9-139			
Surrogate: Toluene-d8	12.7		"	13.3		95.3	83.1-115			
Surrogate: 4-Bromofluorobenzene	12.0		"	13.3		90.2	80.8-120			

Summit Scientific

The results in this report apply to the samples analyzed in accordance with the chain of custody document. This analytical report must be reproduced in its entirety.



LT Environmental, Inc.
4600 West 60th Avenue
Arvada CO, 80003

Project: PDC - Avery
Project Number: PDC 08167.05
Project Manager: Brian Dodek

Reported:
09/04/10 15:22

Notes and Definitions

DET Analyte DETECTED
ND Analyte NOT DETECTED at or above the reporting limit
NR Not Reported
dry Sample results reported on a dry weight basis
RPD Relative Percent Difference

Summit Scientific

A handwritten signature in black ink, appearing to be 'JD' or similar, with a long horizontal stroke extending to the right.

The results in this report apply to the samples analyzed in accordance with the chain of custody document. This analytical report must be reproduced in its entirety.

Summit Scientific

741 Corporate Circle – Suite I ♦ Golden, Colorado 80401

303.277.9310 - laboratory ♦ 303.277.9531 - fax

September 20, 2010

Brian Dodek
LT Environmental, Inc.
4600 West 60th Avenue
Arvada, CO 80003
RE: PDC - Avery 13,23,24-100,10B

Enclosed are the results of analyses for samples received by Summit Scientific on 09/17/10 17:30. If you have any questions concerning this report, please feel free to contact me.

Sincerely,

A handwritten signature in blue ink, appearing to be 'PS' followed by a long horizontal stroke.

Paul Shrewsbury For Ben Shrewsbury
President / Laboratory Director

LT Environmental, Inc.
4600 West 60th Avenue
Arvada CO, 80003

Project: PDC - Avery 13,23,24-100,10B

Project Number: PDC 08167

Project Manager: Brian Dodek

Reported:

09/20/10 08:11

ANALYTICAL REPORT FOR SAMPLES

Sample ID	Laboratory ID	Matrix	Date Sampled	Date Received
GW01	R009153-01	Water	09/17/10 15:30	09/17/10 17:30

Summit Scientific 2009/53

741 Corporate Circle Suite I ♦ Golden, Colorado 80401
303-277-9310 ♦ 303-277-9531 Fax

Page / of

Client: LT Environmental, Inc.

Address: 4600 West 60th Avenue

City/State/Zip: Arvada, CO 80003

Phone: (303) 433-9788

Sampler Name: KOAL

Project Manager: *R. D. K.*E-Mail: RD-ALV714@DIPLOMProject Name: AgavevilleProject Name: Alfred D...
Project Number: 02-01

Project Number: F050210

Project Manager: R. D. D. K.E-Mail: RD-Job714@comcast.net

Project Name: SUPERHEROES (2017) 13

Project Name: ALFRED D. 24, 25, 26, 27, 28
Project Number: 026 20117

Referral Number: F008167

[illegible]

www.e2scientific.com

Summit Scientific

The results in this report apply to the samples analyzed in accordance with the chain of custody document. This analytical report must be reproduced in its entirety.



LT Environmental, Inc.
4600 West 60th Avenue
Arvada CO, 80003

Project: PDC - Avery 13,23,24-100,10B
Project Number: PDC 08167
Project Manager: Brian Dodek

Reported:
09/20/10 08:11

GW01
R009153-01 (Water)

Summit Scientific

Volatile Organic Compounds by EPA Method 8260B

Date Sampled: **09/17/10 15:30**

Analyte	Result	Reporting Limit	Units	Dilution	Batch	Prepared	Analyzed	Method	Notes
Benzene	7.7	1.0	ug/l	1	0091801	09/18/10	09/18/10	EPA 8260B	
Toluene	ND	1.0	"	"	"	"	"	"	
Ethylbenzene	1.6	1.0	"	"	"	"	"	"	
Xylenes (total)	10	1.0	"	"	"	"	"	"	

Date Sampled: **09/17/10 15:30**

Analyte	Result	Reporting Limit	Units	Dilution	Batch	Prepared	Analyzed	Method	Notes
<i>Surrogate: 1,2-Dichloroethane-d4</i>		<i>112 %</i>	<i>57.9-139</i>		"	"	"	"	
<i>Surrogate: Toluene-d8</i>		<i>100 %</i>	<i>83.1-115</i>		"	"	"	"	
<i>Surrogate: 4-Bromofluorobenzene</i>		<i>103 %</i>	<i>80.8-120</i>		"	"	"	"	

Summit Scientific

The results in this report apply to the samples analyzed in accordance with the chain of custody document. This analytical report must be reproduced in its entirety.



LT Environmental, Inc.
4600 West 60th Avenue
Arvada CO, 80003

Project: PDC - Avery 13,23,24-100,10B

Project Number: PDC 08167
Project Manager: Brian Dodek

Reported:
09/20/10 08:11

Volatile Organic Compounds by EPA Method 8260B - Quality Control

Summit Scientific

Analyte	Reporting			Spike Level	Source		%REC		RPD		Notes
	Result	Limit	Units		Result	%REC	Limits	RPD	Limit		

Batch 0091801 - EPA 5030 Water MS

Blank (0091801-BLK1)

Prepared & Analyzed: 09/18/10

Benzene	ND	1.0	ug/l							
Toluene	ND	1.0	"							
Ethylbenzene	ND	1.0	"							
Xylenes (total)	ND	1.0	"							
Surrogate: 1,2-Dichloroethane-d4	14.6		"	13.3	110	57.9-139				
Surrogate: Toluene-d8	13.1		"	13.3	98.1	83.1-115				
Surrogate: 4-Bromofluorobenzene	13.3		"	13.3	99.8	80.8-120				

LCS (0091801-BS1)

Prepared & Analyzed: 09/18/10

Benzene	27.8	1.0	ug/l	33.3	83.3	60.1-131			10.9	
Toluene	25.3	1.0	"	33.3	75.9	65.9-127			11.3	
Ethylbenzene	27.4	1.0	"	33.3	82.3	65.1-129			20	
m,p-Xylene	52.9	2.0	"	66.7	79.4	66.8-127			20	
o-Xylene	26.7	1.0	"	33.3	80.1	61.2-120			20	
Surrogate: 1,2-Dichloroethane-d4	13.8		"	13.3	103	57.9-139				
Surrogate: Toluene-d8	13.2		"	13.3	98.8	83.1-115				
Surrogate: 4-Bromofluorobenzene	13.2		"	13.3	99.0	80.8-120				

LCS Dup (0091801-BSD1)

Prepared & Analyzed: 09/18/10

Benzene	24.1	1.0	ug/l	33.3	72.2	60.1-131	14.3		10.9	
Toluene	22.6	1.0	"	33.3	67.8	65.9-127	11.3		11.3	
Ethylbenzene	23.8	1.0	"	33.3	71.6	65.1-129	13.9		20	
m,p-Xylene	45.9	2.0	"	66.7	68.9	66.8-127	14.2		20	
o-Xylene	24.0	1.0	"	33.3	72.0	61.2-120	10.6		20	
Surrogate: 1,2-Dichloroethane-d4	14.2		"	13.3	106	57.9-139				
Surrogate: Toluene-d8	13.5		"	13.3	101	83.1-115				
Surrogate: 4-Bromofluorobenzene	13.4		"	13.3	100	80.8-120				

Summit Scientific

The results in this report apply to the samples analyzed in accordance with the chain of custody document. This analytical report must be reproduced in its entirety.



LT Environmental, Inc.
4600 West 60th Avenue
Arvada CO, 80003

Project: PDC - Avery 13,23,24-100,10B

Project Number: PDC 08167
Project Manager: Brian Dodek

Reported:
09/20/10 08:11

Notes and Definitions

DET Analyte DETECTED
ND Analyte NOT DETECTED at or above the reporting limit
NR Not Reported
dry Sample results reported on a dry weight basis
RPD Relative Percent Difference

Summit Scientific

A handwritten signature in black ink, appearing to be 'JD' or similar, with a long horizontal stroke extending to the right.

The results in this report apply to the samples analyzed in accordance with the chain of custody document. This analytical report must be reproduced in its entirety.

Summit Scientific

741 Corporate Circle – Suite I ♦ Golden, Colorado 80401

303.277.9310 - laboratory ♦ 303.277.9531 - fax

September 24, 2010

Brian Dodek

LT Environmental, Inc.

4600 West 60th Avenue

Arvada, CO 80003

RE: PDC - Avery 13,23,24-10 & 10B

Enclosed are the results of analyses for samples received by Summit Scientific on 09/23/10 18:00. If you have any questions concerning this report, please feel free to contact me.

Sincerely,

A handwritten signature in blue ink, appearing to be 'PS', with a long horizontal flourish extending to the right.

Paul Shrewsbury For Ben Shrewsbury
President / Laboratory Director



LT Environmental, Inc.
4600 West 60th Avenue
Arvada CO, 80003

Project: PDC - Avery 13,23,24-10 & 10B
Project Number: PDC 08167
Project Manager: Brian Dodek

Reported:
09/24/10 07:33

GW01
R009203-01 (Water)

Summit Scientific

Volatile Organic Compounds by EPA Method 8260B

Date Sampled: **09/23/10 00:00**

Analyte	Result	Reporting Limit	Units	Dilution	Batch	Prepared	Analyzed	Method	Notes
Benzene	5.9	1.0	ug/l	1	0092304	09/23/10	09/24/10	EPA 8260B	
Toluene	12	1.0	"	"	"	"	"	"	
Ethylbenzene	2.9	1.0	"	"	"	"	"	"	
Xylenes (total)	25	1.0	"	"	"	"	"	"	

Date Sampled: **09/23/10 00:00**

Analyte	Result	Reporting Limit	Units	Dilution	Batch	Prepared	Analyzed	Method	Notes
<i>Surrogate: 1,2-Dichloroethane-d4</i>		99.2 %	57.9-139		"	"	"	"	
<i>Surrogate: Toluene-d8</i>		96.1 %	83.1-115		"	"	"	"	
<i>Surrogate: 4-Bromofluorobenzene</i>		95.3 %	80.8-120		"	"	"	"	

Summit Scientific

The results in this report apply to the samples analyzed in accordance with the chain of custody document. This analytical report must be reproduced in its entirety.



LT Environmental, Inc.
4600 West 60th Avenue
Arvada CO, 80003

Project: PDC - Avery 13,23,24-10 & 10B

Project Number: PDC 08167
Project Manager: Brian Dodek

Reported:
09/24/10 07:33

Volatile Organic Compounds by EPA Method 8260B - Quality Control

Summit Scientific

Analyte	Reporting			Spike	Source		%REC		RPD	
	Result	Limit	Units	Level	Result	%REC	Limits	RPD	Limit	Notes

Batch 0092304 - EPA 5030 Water MS

Blank (0092304-BLK1)

Prepared: 09/23/10 Analyzed: 09/24/10

Benzene	ND	1.0	ug/l							
Toluene	ND	1.0	"							
Ethylbenzene	ND	1.0	"							
Xylenes (total)	ND	1.0	"							
Surrogate: 1,2-Dichloroethane-d4	12.9		"	13.3		96.5	57.9-139			
Surrogate: Toluene-d8	12.6		"	13.3		94.4	83.1-115			
Surrogate: 4-Bromofluorobenzene	13.0		"	13.3		97.7	80.8-120			

LCS (0092304-BS1)

Prepared: 09/23/10 Analyzed: 09/24/10

Benzene	30.2	1.0	ug/l	33.3		90.6	60.1-131		10.9	
Toluene	27.7	1.0	"	33.3		83.2	65.9-127		11.3	
Ethylbenzene	32.2	1.0	"	33.3		96.5	65.1-129		20	
m,p-Xylene	58.7	2.0	"	66.7		88.1	66.8-127		20	
o-Xylene	28.0	1.0	"	33.3		84.1	61.2-120		20	
Surrogate: 1,2-Dichloroethane-d4	13.1		"	13.3		98.5	57.9-139			
Surrogate: Toluene-d8	12.7		"	13.3		95.2	83.1-115			
Surrogate: 4-Bromofluorobenzene	12.7		"	13.3		95.4	80.8-120			

LCS Dup (0092304-BSD1)

Prepared: 09/23/10 Analyzed: 09/24/10

Benzene	30.4	1.0	ug/l	33.3		91.3	60.1-131	0.759	10.9	
Toluene	28.0	1.0	"	33.3		84.1	65.9-127	1.04	11.3	
Ethylbenzene	32.1	1.0	"	33.3		96.2	65.1-129	0.280	20	
m,p-Xylene	59.0	2.0	"	66.7		88.5	66.8-127	0.510	20	
o-Xylene	29.0	1.0	"	33.3		86.9	61.2-120	3.30	20	
Surrogate: 1,2-Dichloroethane-d4	13.2		"	13.3		99.2	57.9-139			
Surrogate: Toluene-d8	12.6		"	13.3		94.9	83.1-115			
Surrogate: 4-Bromofluorobenzene	12.6		"	13.3		94.3	80.8-120			

Summit Scientific

The results in this report apply to the samples analyzed in accordance with the chain of custody document. This analytical report must be reproduced in its entirety.



LT Environmental, Inc.
4600 West 60th Avenue
Arvada CO, 80003

Project: PDC - Avery 13,23,24-10 & 10B
Project Number: PDC 08167
Project Manager: Brian Dodek

Reported:
09/24/10 07:33

Volatile Organic Compounds by EPA Method 8260B - Quality Control
Summit Scientific

Analyte	Reporting			Spike	Source		%REC		RPD	
	Result	Limit	Units	Level	Result	%REC	Limits	RPD	Limit	Notes

Batch 0092304 - EPA 5030 Water MS

Matrix Spike (0092304-MS1)				Source: R009179-01		Prepared: 09/23/10		Analyzed: 09/24/10		
Benzene	30.0	1.0	ug/l	33.3	ND	89.9	52.7-130		19.3	
Toluene	27.5	1.0	"	33.3	ND	82.4	57-127		18.7	
Ethylbenzene	31.8	1.0	"	33.3	ND	95.4	59.2-127		20	
m,p-Xylene	58.2	2.0	"	66.7	ND	87.3	53.2-132		20	
o-Xylene	28.2	1.0	"	33.3	ND	84.6	56.3-117		20	
Surrogate: 1,2-Dichloroethane-d4	13.3		"	13.3		99.9	57.9-139			
Surrogate: Toluene-d8	12.6		"	13.3		94.4	83.1-115			
Surrogate: 4-Bromofluorobenzene	12.7		"	13.3		95.0	80.8-120			
Matrix Spike Dup (0092304-MSD1)				Source: R009179-01		Prepared: 09/23/10		Analyzed: 09/24/10		
Benzene	31.5	1.0	ug/l	33.3	ND	94.4	52.7-130	4.85	19.3	
Toluene	28.8	1.0	"	33.3	ND	86.3	57-127	4.59	18.7	
Ethylbenzene	32.6	1.0	"	33.3	ND	97.8	59.2-127	2.42	20	
m,p-Xylene	61.0	2.0	"	66.7	ND	91.4	53.2-132	4.62	20	
o-Xylene	28.3	1.0	"	33.3	ND	85.0	56.3-117	0.495	20	
Surrogate: 1,2-Dichloroethane-d4	13.3		"	13.3		99.6	57.9-139			
Surrogate: Toluene-d8	12.7		"	13.3		95.3	83.1-115			
Surrogate: 4-Bromofluorobenzene	12.4		"	13.3		92.6	80.8-120			

Summit Scientific

The results in this report apply to the samples analyzed in accordance with the chain of custody document. This analytical report must be reproduced in its entirety.



LT Environmental, Inc.
4600 West 60th Avenue
Arvada CO, 80003

Project: PDC - Avery 13,23,24-10 & 10B

Project Number: PDC 08167
Project Manager: Brian Dodek

Reported:
09/24/10 07:33

Notes and Definitions

DET Analyte DETECTED
ND Analyte NOT DETECTED at or above the reporting limit
NR Not Reported
dry Sample results reported on a dry weight basis
RPD Relative Percent Difference

Summit Scientific

A handwritten signature in black ink, appearing to be 'JD' or similar, with a long horizontal stroke extending to the right.

The results in this report apply to the samples analyzed in accordance with the chain of custody document. This analytical report must be reproduced in its entirety.

Summit Scientific

741 Corporate Circle – Suite I ♦ Golden, Colorado 80401

303.277.9310 - laboratory ♦ 303.277.9531 - fax

October 01, 2010

Brian Dodek

LT Environmental, Inc.

4600 West 60th Avenue

Arvada, CO 80003

RE: PDC - Avery 13,23,24-100,10B

Enclosed are the results of analyses for samples received by Summit Scientific on 09/30/10 17:00. If you have any questions concerning this report, please feel free to contact me.

Sincerely,

A handwritten signature in black ink, appearing to be 'BS' or 'Shrewsbury', written in a cursive style.

Ben Shrewsbury

President / Laboratory Director

LT Environmental, Inc.
4600 West 60th Avenue
Arvada CO, 80003

Project: PDC - Avery 13,23,24-100,10B

Project Number: PDC 08167
Project Manager: Brian Dodek

Reported:
10/01/10 08:45

ANALYTICAL REPORT FOR SAMPLES

Sample ID	Laboratory ID	Matrix	Date Sampled	Date Received
GW01	R009239-01	Water	09/30/10 11:30	09/30/10 17:00

Summit Scientific 2059239

741 Corporate Circle Suite I ♦ Golden, Colorado 80401
303-277-9310 ♦ 303-277-9531 Fax

Page 1 of

Client: LT Environmental, Inc.

Address: 4600 West 60th Avenue

City/State/Zip: Arvada, CO 80003

phone: (303) 433-9788

Computer Name:

Project Manager: Brian Dodek

E-Mail: bdodek@itenv.com

Project Name: Alex 13.23.24-104103

Project Number: 010811-7

Project Number: 2508167

Sample Description			Preservative			Matrix			Analyze For:					Special Instructions				
Date Sampled	Time Sampled	Number of Containers	HCl	HNO ₃	None	Other (Specify)	Groundwater	Soil	Air - Canister Serial #	Other (Specify)	DRO	GBTEX	BTEX		Table 9.10 Full	Table 9.10 Short	PH / EC	SAR
9/30/10	1130	3	X				X	X						X				
Relinquished by:	Date/Time:	Received by:			Date/Time:	Turn Around Time (Check)			Notes:									
<i>[Signature]</i>	9/30/10	<i>[Signature]</i>			9-30-10 1700	Same Day 24 Hours 48 Hours			A.M. Results									
Relinquished by:	Date/Time:	Received by:			Date/Time:	Sample Integrity:			Temperatures Upon Receipt: 5.0									
						Intact: Yes No												
Relinquished by:	Date/Time:	Received in Lab by:			Date/Time:													

www.ejscientific.com

Summit Scientific

The results in this report apply to the samples analyzed in accordance with the chain of custody document. This analytical report must be reproduced in its entirety.



LT Environmental, Inc.
4600 West 60th Avenue
Arvada CO, 80003

Project: PDC - Avery 13,23,24-100,10B

Project Number: PDC 08167
Project Manager: Brian Dodek

Reported:
10/01/10 08:45

GW01
R009239-01 (Water)

Summit Scientific

Volatile Organic Compounds by EPA Method 8260B

Date Sampled: **09/30/10 11:30**

Analyte	Result	Reporting		Units	Dilution	Batch	Prepared	Analyzed	Method	Notes
		Limit								
Benzene	11	1.0		ug/l	1	0093005	09/30/10	09/30/10	EPA 8260B	
Toluene	17	1.0		"	"	"	"	"	"	
Ethylbenzene	6.7	1.0		"	"	"	"	"	"	
Xylenes (total)	81	1.0		"	"	"	"	"	"	

Date Sampled: **09/30/10 11:30**

Analyte	Result	Reporting		Units	Dilution	Batch	Prepared	Analyzed	Method	Notes
		Limit								
<i>Surrogate: 1,2-Dichloroethane-d4</i>		87.4 %		57.9-139		"	"	"	"	
<i>Surrogate: Toluene-d8</i>		100 %		83.1-115		"	"	"	"	
<i>Surrogate: 4-Bromofluorobenzene</i>		90.3 %		80.8-120		"	"	"	"	

Summit Scientific

The results in this report apply to the samples analyzed in accordance with the chain of custody document. This analytical report must be reproduced in its entirety.



LT Environmental, Inc.
4600 West 60th Avenue
Arvada CO, 80003

Project: PDC - Avery 13,23,24-100,10B

Project Number: PDC 08167
Project Manager: Brian Dodek

Reported:
10/01/10 08:45

Volatile Organic Compounds by EPA Method 8260B - Quality Control

Summit Scientific

Reporting				Spike	Source		%REC		RPD	
Analyte	Result	Limit	Units	Level	Result	%REC	Limits	RPD	Limit	Notes

Batch 0093005 - EPA 5030 Water MS

Blank (0093005-BLK1)

Prepared: 09/30/10 Analyzed: 10/01/10

Benzene	ND	1.0	ug/l							
Toluene	ND	1.0	"							
Ethylbenzene	ND	1.0	"							
Xylenes (total)	ND	1.0	"							
Surrogate: 1,2-Dichloroethane-d4	12.2		"	13.3		91.4	57.9-139			
Surrogate: Toluene-d8	12.6		"	13.3		94.7	83.1-115			
Surrogate: 4-Bromofluorobenzene	13.3		"	13.3		99.9	80.8-120			

LCS (0093005-BS1)

Prepared & Analyzed: 09/30/10

Benzene	31.2	1.0	ug/l	33.3		93.5	60.1-131		10.9	
Toluene	28.4	1.0	"	33.3		85.1	65.9-127		11.3	
Ethylbenzene	29.9	1.0	"	33.3		89.6	65.1-129		20	
m,p-Xylene	60.7	2.0	"	66.7		91.1	66.8-127		20	
o-Xylene	27.1	1.0	"	33.3		81.2	61.2-120		20	
Surrogate: 1,2-Dichloroethane-d4	12.7		"	13.3		95.1	57.9-139			
Surrogate: Toluene-d8	13.0		"	13.3		97.7	83.1-115			
Surrogate: 4-Bromofluorobenzene	13.0		"	13.3		97.6	80.8-120			

LCS Dup (0093005-BSD1)

Prepared & Analyzed: 09/30/10

Benzene	30.6	1.0	ug/l	33.3		91.7	60.1-131	2.04	10.9	
Toluene	28.1	1.0	"	33.3		84.4	65.9-127	0.849	11.3	
Ethylbenzene	29.4	1.0	"	33.3		88.3	65.1-129	1.52	20	
m,p-Xylene	57.5	2.0	"	66.7		86.3	66.8-127	5.36	20	
o-Xylene	26.1	1.0	"	33.3		78.3	61.2-120	3.69	20	
Surrogate: 1,2-Dichloroethane-d4	12.6		"	13.3		94.7	57.9-139			
Surrogate: Toluene-d8	13.0		"	13.3		97.7	83.1-115			
Surrogate: 4-Bromofluorobenzene	12.9		"	13.3		96.9	80.8-120			

Summit Scientific

The results in this report apply to the samples analyzed in accordance with the chain of custody document. This analytical report must be reproduced in its entirety.



LT Environmental, Inc.
4600 West 60th Avenue
Arvada CO, 80003

Project: PDC - Avery 13,23,24-100,10B

Project Number: PDC 08167
Project Manager: Brian Dodek

Reported:
10/01/10 08:45

Volatile Organic Compounds by EPA Method 8260B - Quality Control
Summit Scientific

Analyte	Reporting			Spike	Source		%REC		RPD	
	Result	Limit	Units	Level	Result	%REC	Limits	RPD	Limit	Notes

Batch 0093005 - EPA 5030 Water MS

Matrix Spike (0093005-MS1)				Source: R009232-01		Prepared: 09/30/10		Analyzed: 10/01/10		
Benzene	29.6	1.0	ug/l	33.3	ND	88.7	52.7-130		19.3	
Toluene	27.3	1.0	"	33.3	ND	81.8	57-127		18.7	
Ethylbenzene	29.0	1.0	"	33.3	ND	86.9	59.2-127		20	
m,p-Xylene	53.9	2.0	"	66.7	1.18	79.1	53.2-132		20	
o-Xylene	25.6	1.0	"	33.3	ND	76.8	56.3-117		20	
Surrogate: 1,2-Dichloroethane-d4	12.8		"	13.3		96.4	57.9-139			
Surrogate: Toluene-d8	13.0		"	13.3		97.5	83.1-115			
Surrogate: 4-Bromofluorobenzene	13.2		"	13.3		99.2	80.8-120			
Matrix Spike Dup (0093005-MSD1)				Source: R009232-01		Prepared: 09/30/10		Analyzed: 10/01/10		
Benzene	29.9	1.0	ug/l	33.3	ND	89.7	52.7-130	1.11	19.3	
Toluene	27.0	1.0	"	33.3	ND	80.9	57-127	1.03	18.7	
Ethylbenzene	28.2	1.0	"	33.3	ND	84.6	59.2-127	2.69	20	
m,p-Xylene	53.9	2.0	"	66.7	1.18	79.0	53.2-132	0.0186	20	
o-Xylene	24.7	1.0	"	33.3	ND	74.0	56.3-117	3.74	20	
Surrogate: 1,2-Dichloroethane-d4	12.8		"	13.3		95.8	57.9-139			
Surrogate: Toluene-d8	12.9		"	13.3		97.1	83.1-115			
Surrogate: 4-Bromofluorobenzene	12.9		"	13.3		97.0	80.8-120			

Summit Scientific

The results in this report apply to the samples analyzed in accordance with the chain of custody document. This analytical report must be reproduced in its entirety.



LT Environmental, Inc.
4600 West 60th Avenue
Arvada CO, 80003

Project: PDC - Avery 13,23,24-100,10B

Project Number: PDC 08167
Project Manager: Brian Dodek

Reported:
10/01/10 08:45

Notes and Definitions

DET Analyte DETECTED
ND Analyte NOT DETECTED at or above the reporting limit
NR Not Reported
dry Sample results reported on a dry weight basis
RPD Relative Percent Difference

A handwritten signature in black ink, appearing to be 'JMM'.

Summit Scientific

741 Corporate Circle – Suite I ♦ Golden, Colorado 80401

303.277.9310 - laboratory ♦ 303.277.9531 - fax

October 15, 2010

Brian Dodek

LT Environmental, Inc.

4600 West 60th Avenue

Arvada, CO 80003

RE: PDC - Avery 10B, 13, 23-10, 24-10D

Enclosed are the results of analyses for samples received by Summit Scientific on 10/14/10 17:00. If you have any questions concerning this report, please feel free to contact me.

Sincerely,

A handwritten signature in blue ink, appearing to be 'PS' followed by a long horizontal stroke.

Paul Shrewsbury For Ben Shrewsbury
President / Laboratory Director

LT Environmental, Inc.
4600 West 60th Avenue
Arvada CO, 80003

Project: PDC - Avery 10B, 13, 23-10, 24-10D

Project Number: PDC 08167.05
Project Manager: Brian Dodek

Reported:
10/15/10 07:45

ANALYTICAL REPORT FOR SAMPLES

Sample ID	Laboratory ID	Matrix	Date Sampled	Date Received
GW01	R010088-01	Water	10/14/10 14:10	10/14/10 17:00

Summit Scientific
2016087

741 Corporate Circle Suite 1 ♦ Golden, Colorado 80401
303-277-9310 ♦ 303-277-9531 Fax

Page / of

Client: LT Environmental, Inc.

Address: 4600 West 60th Avenue

City/State/Zip: Arvada, CO 80003

City/State/Zip: Phone: (303) 433-9788

Phone: (303) 433-9760
Sampler Name: Dallen Girt

Project Manager: Brian Dodek

E-Mail: bdodek@ltenv.com

Project Name: Aug-21 EB 13 23-10 24-10D

Project Name: AVERA 100-2-2017
Project Number: PDC 0816705

			Preservative						Matrix			Analyze For:									
Sample Description	Date Sampled	Time Sampled	Number of Containers	HCl	HNO ₃	None	Other (Specify)	Groundwater	Soil	Air - Canister Serial #	Other (Specify)	DRO	GBTEX	BTEX	Table 9.10 Full	Table 9.10 Short	pH / EC	SAR	Special Instructions		
				X				X													
GWOI	10-14-10	1410	3	X				X						X							
Relinquished by:	Date/Time:	Received by:			Date/Time:			Turn Around Time (Check)			Notes:										
Don Dotin 10-14-10		MS 10/14/10 1700			Same Day			72 Hours													
Relinquished by:	Date/Time:	Received by:			Date/Time:			24 Hours			Standard										
								48 Hours													
Relinquished by:	Date/Time:	Received in Lab by:			Date/Time:			Sample Integrity:			Temperature Upon Receipt: 3.0										
											Intact: Yes No										

www.e2scientific.com

Summit Scientific

The results in this report apply to the samples analyzed in accordance with the chain of custody document. This analytical report must be reproduced in its entirety.



LT Environmental, Inc.
4600 West 60th Avenue
Arvada CO, 80003

Project: PDC - Avery 10B, 13, 23-10, 24-10D
Project Number: PDC 08167.05
Project Manager: Brian Dodek

Reported:
10/15/10 07:45

GW01
R010088-01 (Water)

Summit Scientific

Volatile Organic Compounds by EPA Method 8260B

Date Sampled: **10/14/10 14:10**

Analyte	Result	Reporting Limit	Units	Dilution	Batch	Prepared	Analyzed	Method	Notes
Benzene	ND	1.0	ug/l	1	0101410	10/14/10	10/15/10	EPA 8260B	
Toluene	ND	1.0	"	"	"	"	"	"	
Ethylbenzene	ND	1.0	"	"	"	"	"	"	
Xylenes (total)	ND	1.0	"	"	"	"	"	"	

Date Sampled: **10/14/10 14:10**

Analyte	Result	Reporting Limit	Units	Dilution	Batch	Prepared	Analyzed	Method	Notes
Surrogate: 1,2-Dichloroethane-d4		95.6 %	57.9-139		"	"	"	"	
Surrogate: Toluene-d8		94.7 %	83.1-115		"	"	"	"	
Surrogate: 4-Bromofluorobenzene		100 %	80.8-120		"	"	"	"	

Summit Scientific

The results in this report apply to the samples analyzed in accordance with the chain of custody document. This analytical report must be reproduced in its entirety.



LT Environmental, Inc.
4600 West 60th Avenue
Arvada CO, 80003

Project: PDC - Avery 10B, 13, 23-10, 24-10D
Project Number: PDC 08167.05
Project Manager: Brian Dodek

Reported:
10/15/10 07:45

Volatile Organic Compounds by EPA Method 8260B - Quality Control

Summit Scientific

Analyte	Reporting			Spike	Source		%REC		RPD	
	Result	Limit	Units	Level	Result	%REC	Limits	RPD	Limit	Notes

Batch 0101410 - EPA 5030 Water MS

Blank (0101410-BLK1)

Prepared: 10/14/10 Analyzed: 10/15/10

Benzene	ND	1.0	ug/l							
Toluene	ND	1.0	"							
Ethylbenzene	ND	1.0	"							
Xylenes (total)	ND	1.0	"							
Surrogate: 1,2-Dichloroethane-d4	12.7		"	13.3		95.2	57.9-139			
Surrogate: Toluene-d8	12.5		"	13.3		94.1	83.1-115			
Surrogate: 4-Bromofluorobenzene	13.2		"	13.3		99.1	80.8-120			

LCS (0101410-BS1)

Prepared & Analyzed: 10/14/10

Benzene	27.7	1.0	ug/l	33.3		83.2	60.1-131		10.9	
Toluene	24.9	1.0	"	33.3		74.6	65.9-127		11.3	
Ethylbenzene	29.3	1.0	"	33.3		88.0	65.1-129		20	
m,p-Xylene	53.4	2.0	"	66.7		80.1	66.8-127		20	
o-Xylene	26.0	1.0	"	33.3		78.0	61.2-120		20	
Surrogate: 1,2-Dichloroethane-d4	13.4		"	13.3		101	57.9-139			
Surrogate: Toluene-d8	12.8		"	13.3		95.7	83.1-115			
Surrogate: 4-Bromofluorobenzene	12.6		"	13.3		94.6	80.8-120			

LCS Dup (0101410-BSD1)

Prepared: 10/14/10 Analyzed: 10/15/10

Benzene	30.7	1.0	ug/l	33.3		92.2	60.1-131	10.2	10.9	
Toluene	27.3	1.0	"	33.3		82.0	65.9-127	9.47	11.3	
Ethylbenzene	32.6	1.0	"	33.3		98.0	65.1-129	10.7	20	
m,p-Xylene	59.2	2.0	"	66.7		88.9	66.8-127	10.3	20	
o-Xylene	28.4	1.0	"	33.3		85.1	61.2-120	8.68	20	
Surrogate: 1,2-Dichloroethane-d4	13.4		"	13.3		101	57.9-139			
Surrogate: Toluene-d8	12.8		"	13.3		95.8	83.1-115			
Surrogate: 4-Bromofluorobenzene	13.0		"	13.3		97.4	80.8-120			

Summit Scientific

The results in this report apply to the samples analyzed in accordance with the chain of custody document. This analytical report must be reproduced in its entirety.



LT Environmental, Inc.
4600 West 60th Avenue
Arvada CO, 80003

Project: PDC - Avery 10B, 13, 23-10, 24-10D

Project Number: PDC 08167.05
Project Manager: Brian Dodek

Reported:
10/15/10 07:45

Notes and Definitions

DET Analyte DETECTED
ND Analyte NOT DETECTED at or above the reporting limit
NR Not Reported
dry Sample results reported on a dry weight basis
RPD Relative Percent Difference

Summit Scientific

A handwritten signature in black ink, appearing to be 'JD' or similar, with a long horizontal stroke extending to the right.

The results in this report apply to the samples analyzed in accordance with the chain of custody document. This analytical report must be reproduced in its entirety.