

LEGEND

○ SITE LOCATION

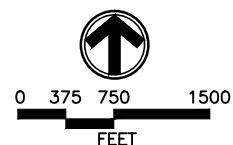

SOURCE: TOPOZONE.COM
USGS 7.5' QUADRANGLE
(NAD27)

FIGURE 1
SITE LOCATION MAP
WILLIAMSON 44-12
SESE 12-T6N-R65W
WELD COUNTY, CO
PETROLEUM DEVELOPMENT CORPORATION



PDC1002701-SL

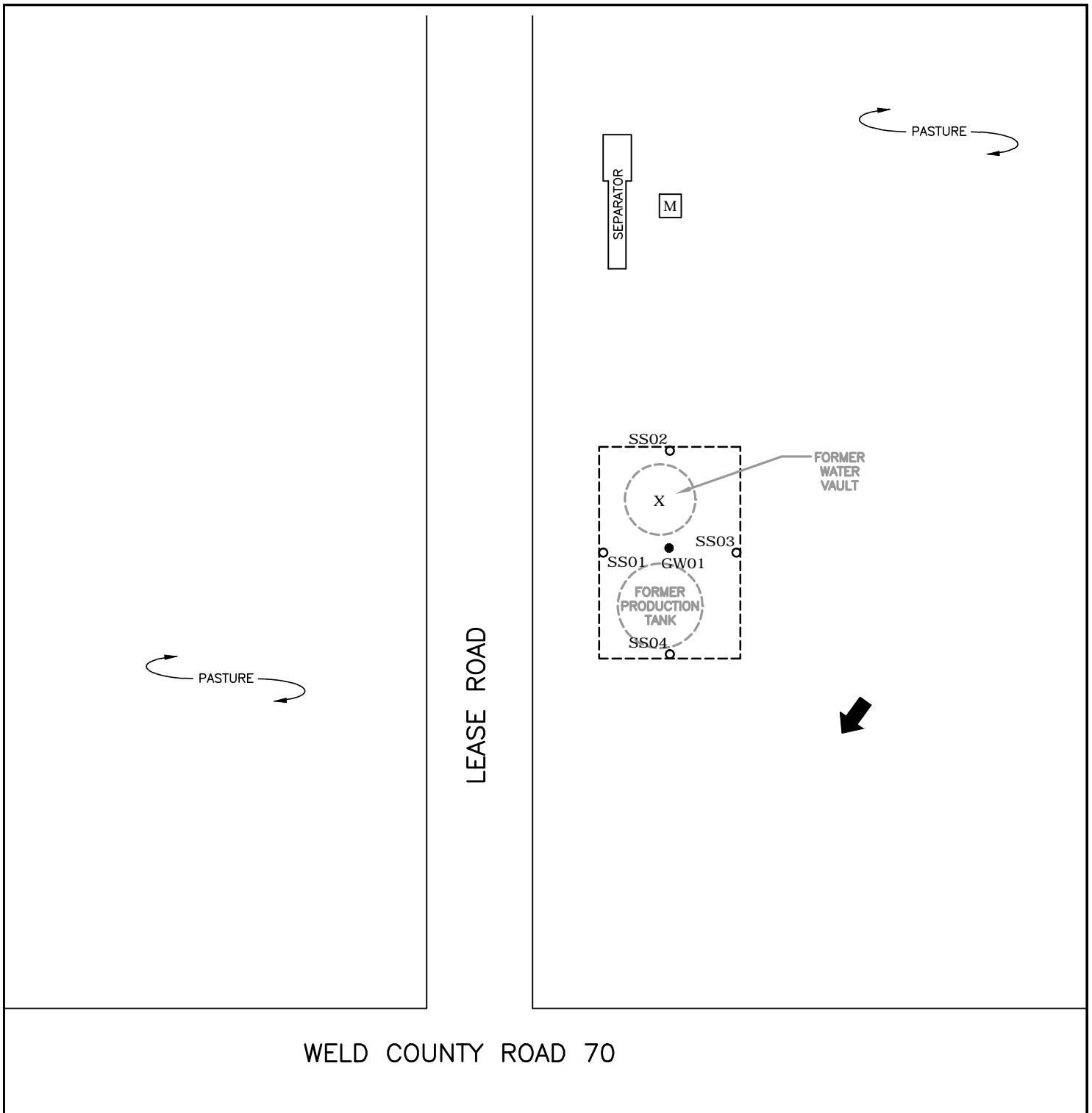

LEGEND

- SS01 ○ SOIL SAMPLE LOCATION
- GW01 ● WATER SAMPLE LOCATION
- M METER HOUSE
- X RELEASE LOCATION
- EXTENT OF EXCAVATION
- ESTIMATED GROUNDWATER FLOW DIRECTION

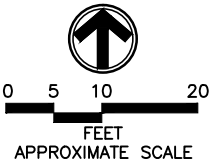

FIGURE 2
SITE MAP
WILLIAMSON 44-12
SESE 12-T6N-R65W
WELD COUNTY, CO
PETROLEUM DEVELOPMENT CORPORATION



TABLE 1
SOIL SAMPLE ANALYTICAL RESULTS
WILLIAMSON 44-12 (API No. 05-123-14071)
WELD COUNTY, COLORADO
PETROLEUM DEVELOPMENT CORPORATION

Sample ID	Depth (ft bgs)	Date Sampled	Benzene (mg/kg)	Toluene (mg/kg)	Ethyl- benzene (mg/kg)	Xylenes (mg/kg)	Naph- thalene (mg/kg)	TPH (mg/kg)
SS01	4	09/02/2010	<0.0050	<0.0050	<0.0050	<0.015	<0.0050	1.1
SS02	4	09/02/2010	<0.0050	<0.0050	<0.0050	<0.015	<0.0050	<50.5
SS03	4	09/02/2010	<0.0050	<0.0050	<0.0050	<0.015	<0.0050	<50.5
SS04	4	09/02/2010	<0.0050	<0.0050	<0.0050	<0.015	<0.0050	<50.5
Basic Standards for Soil			0.17	85	100	175	23	500

Notes: < - less than stated laboratory reporting limit

TPH - Total Petroleum Hydrocarbons (C6-C28)

API - American Petroleum Institute

Bold numbers indicate result equalled or exceeded standard.

Basic Standards for Soil are taken from 2 CCR 404-1, Table 910-1, effective April 1, 2009.

NA - Not Analyzed

mg/kg - milligrams per kilogram

ft bgs - feet below ground surface



TABLE 2
GROUNDWATER ANALYTICAL RESULTS AND FIELD PARAMETERS
WILLIAMSON 44-12 (API No. 123-14071)
WELD COUNTY, COLORADO
PETROLEUM DEVELOPMENT CORPORATION

Sample ID	Date Sampled	Benzene (ug/L)	Toluene (ug/L)	Ethyl-benzene (ug/L)	Xylenes (ug/L)	Depth to Water (ft btoc)
GW01	09/17/2010	<1.0	<1.0	<1.0	<1.0	NM
Basic Standards for Groundwater:		5	560	700	1400	

Notes: < - less than
ft btoc - feet below top of casing
Basic Standards for Groundwater are taken from the Colorado Department of Health and Environment -
Water Quality Control Commission Regulation 41, effective 4/1/2009.
Bold numbers indicate result equaled or exceeded standard.



Summit Scientific

741 Corporate Circle – Suite I ♦ Golden, Colorado 80401

303.277.9310 - laboratory ♦ 303.277.9531 - fax

September 04, 2010

Brian Dodek
LT Environmental, Inc.
4600 West 60th Avenue
Arvada, CO 80003
RE: PDC - Williamson 44-12

Enclosed are the results of analyses for samples received by Summit Scientific on 09/02/10 17:00. If you have any questions concerning this report, please feel free to contact me.

Sincerely,

A handwritten signature in blue ink, appearing to be 'PS', with a long horizontal flourish extending to the right.

Paul Shrewsbury For Ben Shrewsbury
President / Laboratory Director



LT Environmental, Inc.
4600 West 60th Avenue
Arvada CO, 80003

Project: PDC - Williamson 44-12

Project Number: PDC 10027.05
Project Manager: Brian Dodek

Reported:
09/04/10 15:35

ANALYTICAL REPORT FOR SAMPLES

Sample ID	Laboratory ID	Matrix	Date Sampled	Date Received
SS01	R009016-01	Soil	09/02/10 11:35	09/02/10 17:00
SS02	R009016-02	Soil	09/02/10 15:25	09/02/10 17:00
SS03	R009016-03	Soil	09/02/10 11:45	09/02/10 17:00
SS04	R009016-04	Soil	09/02/10 11:50	09/02/10 17:00

Summit Scientific

The results in this report apply to the samples analyzed in accordance with the chain of custody document. This analytical report must be reproduced in its entirety.

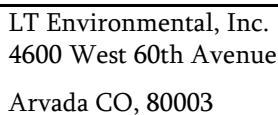

Project Number: PDC 10027.05
Project Manager: Brian Dodek

Reported:
09/04/10 15:35



74 | Corporate Circle Suite 1 ♦ Golden, Colorado 80401
303-277-9310 ♦ 303-277-9531 Fax

Page _____ of _____

Client: LT Environmental, Inc.

Address: 4600 West 60th Avenue

Project Manager:

Brian Dodek

City/State/Zip: Arvada, CO 80003

E-Mail:

bdodek@ltenv.com

Phone: (303) 433-9788

Project Name: W

answ 44-12

Sampler Name: David Giv

Project Number:

50.27.05

Sample Description	Preservative		Matrix		Analyze For:										Special Instructions			
	Date Sampled	Time Sampled	Number of Containers	HCl	HNO ₃	None	Other (Specify)	Groundwater	Soil	Air - Canister Serial #	Other (Specify)	DRO	GBTEX / MGP	BTEX		Table 9.10 Full	Table 9.10 Short	pH / EC
5501	9-2-10	1:35	1			X			X			X	X					
5502		15:35	1															
5503		1:45																
5504		1:50																

www.e2cientific.com

Summit Scientific

The results in this report apply to the samples analyzed in accordance with the chain of custody document. This analytical report must be reproduced in its entirety.





LT Environmental, Inc.
4600 West 60th Avenue
Arvada CO, 80003

Project: PDC - Williamson 44-12

Project Number: PDC 10027.05
Project Manager: Brian Dodek

Reported:
09/04/10 15:35

SS01
R009016-01 (Soil)

Summit Scientific

Total Petroleum Hydrocarbons by 8015

Date Sampled: **09/02/10 11:35**

Analyte	Result	Reporting Limit	Units	Dilution	Batch	Prepared	Analyzed	Method	Notes
C10-C28 (DRO)	ND	50	mg/kg	1	0090202	09/02/10	09/03/10	8015 DRO	

Date Sampled: **09/02/10 11:35**

Analyte	Result	Reporting Limit	Units	Dilution	Batch	Prepared	Analyzed	Method	Notes
Surrogate: o-Terphenyl		107 %	88.8-124		"	"	"	"	

Volatile Organic Compounds by EPA Method 8260B

Date Sampled: **09/02/10 11:35**

Analyte	Result	Reporting Limit	Units	Dilution	Batch	Prepared	Analyzed	Method	Notes
Naphthalene	ND	0.0050	mg/kg	1	0090203	"	09/03/10	EPA 8260B	
Benzene	ND	0.0050	"	"	"	"	"	"	
Toluene	ND	0.0050	"	"	"	"	"	"	
Ethylbenzene	ND	0.0050	"	"	"	"	"	"	
m,p-Xylene	ND	0.010	"	"	"	"	"	"	
o-Xylene	ND	0.0050	"	"	"	"	"	"	
Gasoline Range Hydrocarbons	1.1	0.50	"	"	"	"	"	"	

Date Sampled: **09/02/10 11:35**

Analyte	Result	Reporting Limit	Units	Dilution	Batch	Prepared	Analyzed	Method	Notes
Surrogate: 1,2-Dichloroethane-d4		120 %	67.4-143		"	"	"	"	
Surrogate: Toluene-d8		96.8 %	77.3-114		"	"	"	"	
Surrogate: 4-Bromofluorobenzene		102 %	78.4-125		"	"	"	"	

Summit Scientific

The results in this report apply to the samples analyzed in accordance with the chain of custody document. This analytical report must be reproduced in its entirety.



LT Environmental, Inc.
4600 West 60th Avenue
Arvada CO, 80003

Project: PDC - Williamson 44-12

Project Number: PDC 10027.05
Project Manager: Brian Dodek

Reported:
09/04/10 15:35

SS02
R009016-02 (Soil)

Summit Scientific

Total Petroleum Hydrocarbons by 8015

Date Sampled: **09/02/10 15:25**

Analyte	Result	Reporting Limit	Units	Dilution	Batch	Prepared	Analyzed	Method	Notes
C10-C28 (DRO)	ND	50	mg/kg	1	0090202	09/02/10	09/03/10	8015 DRO	

Date Sampled: **09/02/10 15:25**

Analyte	Result	Reporting Limit	Units	Dilution	Batch	Prepared	Analyzed	Method	Notes
Surrogate: o-Terphenyl		110 %	88.8-124		"	"	"	"	

Volatile Organic Compounds by EPA Method 8260B

Date Sampled: **09/02/10 15:25**

Analyte	Result	Reporting Limit	Units	Dilution	Batch	Prepared	Analyzed	Method	Notes
Naphthalene	ND	0.0050	mg/kg	1	0090203	"	09/03/10	EPA 8260B	
Benzene	ND	0.0050	"	"	"	"	"	"	
Toluene	ND	0.0050	"	"	"	"	"	"	
Ethylbenzene	ND	0.0050	"	"	"	"	"	"	
m,p-Xylene	ND	0.010	"	"	"	"	"	"	
o-Xylene	ND	0.0050	"	"	"	"	"	"	
Gasoline Range Hydrocarbons	ND	0.50	"	"	"	"	"	"	

Date Sampled: **09/02/10 15:25**

Analyte	Result	Reporting Limit	Units	Dilution	Batch	Prepared	Analyzed	Method	Notes
Surrogate: 1,2-Dichloroethane-d4		96.3 %	67.4-143		"	"	"	"	
Surrogate: Toluene-d8		97.0 %	77.3-114		"	"	"	"	
Surrogate: 4-Bromofluorobenzene		91.8 %	78.4-125		"	"	"	"	

Summit Scientific

The results in this report apply to the samples analyzed in accordance with the chain of custody document. This analytical report must be reproduced in its entirety.



LT Environmental, Inc.
4600 West 60th Avenue
Arvada CO, 80003

Project: PDC - Williamson 44-12

Project Number: PDC 10027.05
Project Manager: Brian Dodek

Reported:
09/04/10 15:35

SS03
R009016-03 (Soil)

Summit Scientific

Total Petroleum Hydrocarbons by 8015

Date Sampled: **09/02/10 11:45**

Analyte	Result	Reporting Limit	Units	Dilution	Batch	Prepared	Analyzed	Method	Notes
C10-C28 (DRO)	ND	50	mg/kg	1	0090202	09/02/10	09/03/10	8015 DRO	

Date Sampled: **09/02/10 11:45**

Analyte	Result	Reporting Limit	Units	Dilution	Batch	Prepared	Analyzed	Method	Notes
Surrogate: <i>o</i> -Terphenyl		110 %	88.8-124		"	"	"	"	

Volatile Organic Compounds by EPA Method 8260B

Date Sampled: **09/02/10 11:45**

Analyte	Result	Reporting Limit	Units	Dilution	Batch	Prepared	Analyzed	Method	Notes
Naphthalene	ND	0.0050	mg/kg	1	0090203	"	09/03/10	EPA 8260B	
Benzene	ND	0.0050	"	"	"	"	"	"	
Toluene	ND	0.0050	"	"	"	"	"	"	
Ethylbenzene	ND	0.0050	"	"	"	"	"	"	
m,p-Xylene	ND	0.010	"	"	"	"	"	"	
o-Xylene	ND	0.0050	"	"	"	"	"	"	
Gasoline Range Hydrocarbons	ND	0.50	"	"	"	"	"	"	

Date Sampled: **09/02/10 11:45**

Analyte	Result	Reporting Limit	Units	Dilution	Batch	Prepared	Analyzed	Method	Notes
Surrogate: 1,2-Dichloroethane-d4		121 %	67.4-143		"	"	"	"	
Surrogate: Toluene-d8		99.8 %	77.3-114		"	"	"	"	
Surrogate: 4-Bromofluorobenzene		102 %	78.4-125		"	"	"	"	

Summit Scientific

The results in this report apply to the samples analyzed in accordance with the chain of custody document. This analytical report must be reproduced in its entirety.



LT Environmental, Inc.
4600 West 60th Avenue
Arvada CO, 80003

Project: PDC - Williamson 44-12

Project Number: PDC 10027.05
Project Manager: Brian Dodek

Reported:
09/04/10 15:35

SS04
R009016-04 (Soil)

Summit Scientific

Total Petroleum Hydrocarbons by 8015

Date Sampled: **09/02/10 11:50**

Analyte	Result	Reporting Limit	Units	Dilution	Batch	Prepared	Analyzed	Method	Notes
C10-C28 (DRO)	ND	50	mg/kg	1	0090202	09/02/10	09/03/10	8015 DRO	

Date Sampled: **09/02/10 11:50**

Analyte	Result	Reporting Limit	Units	Dilution	Batch	Prepared	Analyzed	Method	Notes
Surrogate: <i>o</i> -Terphenyl		108 %	88.8-124		"	"	"	"	

Volatile Organic Compounds by EPA Method 8260B

Date Sampled: **09/02/10 11:50**

Analyte	Result	Reporting Limit	Units	Dilution	Batch	Prepared	Analyzed	Method	Notes
Naphthalene	ND	0.0050	mg/kg	1	0090203	"	09/03/10	EPA 8260B	
Benzene	ND	0.0050	"	"	"	"	"	"	
Toluene	ND	0.0050	"	"	"	"	"	"	
Ethylbenzene	ND	0.0050	"	"	"	"	"	"	
m,p-Xylene	ND	0.010	"	"	"	"	"	"	
o-Xylene	ND	0.0050	"	"	"	"	"	"	
Gasoline Range Hydrocarbons	ND	0.50	"	"	"	"	"	"	

Date Sampled: **09/02/10 11:50**

Analyte	Result	Reporting Limit	Units	Dilution	Batch	Prepared	Analyzed	Method	Notes
Surrogate: 1,2-Dichloroethane-d4		125 %	67.4-143		"	"	"	"	
Surrogate: Toluene-d8		99.4 %	77.3-114		"	"	"	"	
Surrogate: 4-Bromofluorobenzene		101 %	78.4-125		"	"	"	"	

Summit Scientific

The results in this report apply to the samples analyzed in accordance with the chain of custody document. This analytical report must be reproduced in its entirety.



LT Environmental, Inc.
4600 West 60th Avenue
Arvada CO, 80003

Project: PDC - Williamson 44-12
Project Number: PDC 10027.05
Project Manager: Brian Dodek

Reported:
09/04/10 15:35

Total Petroleum Hydrocarbons by 8015 - Quality Control
Summit Scientific

Analyte	Reporting			Spike	Source		%REC		RPD	
	Result	Limit	Units	Level	Result	%REC	Limits	RPD	Limit	Notes

Batch 0090202 - EPA 3550A

Blank (0090202-BLK1)

Prepared: 09/02/10 Analyzed: 09/03/10

C10-C28 (DRO) ND 50 mg/kg

Surrogate: o-Terphenyl 13.4 " 12.5 107 88.8-124

LCS (0090202-BS1)

Prepared: 09/02/10 Analyzed: 09/03/10

C10-C28 (DRO) 541 50 mg/kg 500 108 81.4-129 9.26

LCS (0090202-BS2)

Prepared: 09/02/10 Analyzed: 09/03/10

C10-C28 (DRO) ND 50 mg/kg 81.4-129 9.26

LCS Dup (0090202-BSD1)

Prepared: 09/02/10 Analyzed: 09/03/10

C10-C28 (DRO) 533 50 mg/kg 500 107 81.4-129 1.48 9.26

LCS Dup (0090202-BSD2)

Prepared: 09/02/10 Analyzed: 09/03/10

C10-C28 (DRO) ND 50 mg/kg 81.4-129 9.26

Matrix Spike (0090202-MS1)

Source: R009014-01 Prepared: 09/02/10 Analyzed: 09/03/10

C10-C28 (DRO) 537 50 mg/kg 500 ND 107 77.8-133 8.48

Matrix Spike (0090202-MS2)

Source: R009014-01 Prepared: 09/02/10 Analyzed: 09/03/10

C10-C28 (DRO) ND 50 mg/kg ND 77.8-133 8.48

Matrix Spike Dup (0090202-MSD1)

Source: R009014-01 Prepared: 09/02/10 Analyzed: 09/03/10

C10-C28 (DRO) 539 50 mg/kg 500 ND 108 77.8-133 0.316 8.48

Matrix Spike Dup (0090202-MSD2)

Source: R009014-01 Prepared: 09/02/10 Analyzed: 09/03/10

C10-C28 (DRO) ND 50 mg/kg ND 77.8-133 8.48

Summit Scientific

The results in this report apply to the samples analyzed in accordance with the chain of custody document. This analytical report must be reproduced in its entirety.



LT Environmental, Inc.
4600 West 60th Avenue
Arvada CO, 80003

Project: PDC - Williamson 44-12
Project Number: PDC 10027.05
Project Manager: Brian Dodek

Reported:
09/04/10 15:35

Volatile Organic Compounds by EPA Method 8260B - Quality Control
Summit Scientific

Analyte	Reporting			Spike	Source		%REC		RPD	
	Result	Limit	Units	Level	Result	%REC	Limits	RPD	Limit	Notes

Batch 0090203 - EPA 5030 Soil MS

Blank (0090203-BLK1)

Prepared: 09/02/10 Analyzed: 09/03/10

Naphthalene	ND	0.0050	mg/kg							
Benzene	ND	0.0050	"							
Toluene	ND	0.0050	"							
Ethylbenzene	ND	0.0050	"							
m,p-Xylene	ND	0.010	"							
o-Xylene	ND	0.0050	"							
Gasoline Range Hydrocarbons	ND	0.50	"							
Surrogate: 1,2-Dichloroethane-d4	0.0390		"	0.0400		97.4	67.4-143			
Surrogate: Toluene-d8	0.0391		"	0.0400		97.8	77.3-114			
Surrogate: 4-Bromofluorobenzene	0.0391		"	0.0400		97.7	78.4-125			

LCS (0090203-BS1)

Prepared: 09/02/10 Analyzed: 09/03/10

Naphthalene	ND	0.0050	mg/kg				67.8-151		20	
Benzene	0.0862	0.0050	"	0.100		86.2	61-139		11.1	
Toluene	0.0850	0.0050	"	0.100		85.0	64-132		10.9	
Ethylbenzene	0.0896	0.0050	"	0.100		89.6	68.7-135		20	
m,p-Xylene	0.164	0.010	"	0.200		81.9	70.4-129		20	
o-Xylene	0.0833	0.0050	"	0.100		83.3	66.9-126		20	
Surrogate: 1,2-Dichloroethane-d4	0.0429		"	0.0400		107	67.4-143			
Surrogate: Toluene-d8	0.0410		"	0.0400		102	77.3-114			
Surrogate: 4-Bromofluorobenzene	0.0388		"	0.0400		96.9	78.4-125			

LCS Dup (0090203-BSD1)

Prepared: 09/02/10 Analyzed: 09/03/10

Naphthalene	ND	0.0050	mg/kg				67.8-151		20	
Benzene	0.0894	0.0050	"	0.100		89.4	61-139	3.59	11.1	
Toluene	0.0884	0.0050	"	0.100		88.4	64-132	3.98	10.9	
Ethylbenzene	0.0890	0.0050	"	0.100		89.0	68.7-135	0.638	20	
m,p-Xylene	0.162	0.010	"	0.200		80.9	70.4-129	1.27	20	
o-Xylene	0.0839	0.0050	"	0.100		83.9	66.9-126	0.718	20	
Surrogate: 1,2-Dichloroethane-d4	0.0444		"	0.0400		111	67.4-143			
Surrogate: Toluene-d8	0.0412		"	0.0400		103	77.3-114			
Surrogate: 4-Bromofluorobenzene	0.0386		"	0.0400		96.4	78.4-125			

Summit Scientific

The results in this report apply to the samples analyzed in accordance with the chain of custody document. This analytical report must be reproduced in its entirety.



LT Environmental, Inc.
4600 West 60th Avenue
Arvada CO, 80003

Project: PDC - Williamson 44-12

Project Number: PDC 10027.05
Project Manager: Brian Dodek

Reported:
09/04/10 15:35

Volatile Organic Compounds by EPA Method 8260B - Quality Control
Summit Scientific

Analyte	Reporting			Spike	Source		%REC		RPD	
	Result	Limit	Units	Level	Result	%REC	Limits	RPD	Limit	Notes

Batch 0090203 - EPA 5030 Soil MS

Matrix Spike (0090203-MS1)		Source: R009014-01			Prepared: 09/02/10		Analyzed: 09/03/10	
Naphthalene	ND	0.0050	mg/kg		0.00		26.4-144	20
Benzene	0.0967	0.0050	"	0.100	0.0320	64.6	42.9-137	17.9
Toluene	0.0618	0.0050	"	0.100	0.00	61.8	42.6-130	11.9
Ethylbenzene	0.0587	0.0050	"	0.100	0.00	58.7	39-133	20
m,p-Xylene	0.102	0.010	"	0.200	0.00	51.0	34.7-134	20
o-Xylene	0.0531	0.0050	"	0.100	0.00	53.1	41.3-126	20
Surrogate: 1,2-Dichloroethane-d4		0.0476	"	0.0400		119	67.4-143	
Surrogate: Toluene-d8		0.0414	"	0.0400		103	77.3-114	
Surrogate: 4-Bromofluorobenzene		0.0384	"	0.0400		96.1	78.4-125	

Summit Scientific

The results in this report apply to the samples analyzed in accordance with the chain of custody document. This analytical report must be reproduced in its entirety.



LT Environmental, Inc.
4600 West 60th Avenue
Arvada CO, 80003

Project: PDC - Williamson 44-12

Project Number: PDC 10027.05
Project Manager: Brian Dodek

Reported:
09/04/10 15:35

Notes and Definitions

DET Analyte DETECTED
ND Analyte NOT DETECTED at or above the reporting limit
NR Not Reported
dry Sample results reported on a dry weight basis
RPD Relative Percent Difference

Summit Scientific

A handwritten signature in black ink, appearing to be 'JD' or similar, with a long horizontal stroke extending to the right.

The results in this report apply to the samples analyzed in accordance with the chain of custody document. This analytical report must be reproduced in its entirety.

Summit Scientific

741 Corporate Circle – Suite I ♦ Golden, Colorado 80401

303.277.9310 - laboratory ♦ 303.277.9531 - fax

September 19, 2010

Brian Dodek
LT Environmental, Inc.
4600 West 60th Avenue
Arvada, CO 80003
RE: PDC - Williamson 44-12

Enclosed are the results of analyses for samples received by Summit Scientific on 09/17/10 17:30. If you have any questions concerning this report, please feel free to contact me.

Sincerely,

A handwritten signature in blue ink, appearing to be 'LS' followed by a long horizontal stroke.

Logan Shrewsbury For Ben Shrewsbury
President / Laboratory Director

LT Environmental, Inc.
4600 West 60th Avenue
Arvada CO, 80003

Project: PDC - Williamson 44-12

Project Number: PDC 10027
Project Manager: Brian Dodek

Reported:
09/19/10 20:48

ANALYTICAL REPORT FOR SAMPLES

Sample ID	Laboratory ID	Matrix	Date Sampled	Date Received
GW01	R009154-01	Water	09/17/10 15:50	09/17/10 17:30

Summit Scientific 2009154

74 | Corporate Circle Suite I ♦ Golden, Colorado 80401
303-277-9310 ♦ 303-277-9531 Fax

Client:	LT Environmental, Inc.	Page	1	of	1
Address:	4600 West 60th Avenue	Project Manager:	John Gerroft	B. D. Dolek	
City/State/Zip:	Arvada, CO 80003	E-Mail:	jgerroft@att.net	B. Dolek@Hearst.com	
Phone:	(303) 433-9788	Fax:	(303) 433-1432	Project Name:	Williamson 44-17
Sampler Name:	Shaver	Project Number:	PSG10027		

[illegible]

www.s2scientific.com

Summit Scientific

The results in this report apply to the samples analyzed in accordance with the chain of custody document. This analytical report must be reproduced in its entirety.



LT Environmental, Inc.
4600 West 60th Avenue
Arvada CO, 80003

Project: PDC - Williamson 44-12

Project Number: PDC 10027
Project Manager: Brian Dodek

Reported:
09/19/10 20:48

GW01
R009154-01 (Water)

Summit Scientific

Volatile Organic Compounds by EPA Method 8260B

Date Sampled: **09/17/10 15:50**

Analyte	Result	Reporting		Units	Dilution	Batch	Prepared	Analyzed	Method	Notes
		Limit								
Benzene	ND	1.0		ug/l	1	0091801	09/18/10	09/18/10	EPA 8260B	
Toluene	ND	1.0		"	"	"	"	"	"	
Ethylbenzene	ND	1.0		"	"	"	"	"	"	
Xylenes (total)	ND	1.0		"	"	"	"	"	"	

Date Sampled: **09/17/10 15:50**

Analyte	Result	Reporting		Units	Dilution	Batch	Prepared	Analyzed	Method	Notes
		Limit								
Surrogate: 1,2-Dichloroethane-d4		111 %		57.9-139		"	"	"	"	
Surrogate: Toluene-d8		100 %		83.1-115		"	"	"	"	
Surrogate: 4-Bromofluorobenzene		106 %		80.8-120		"	"	"	"	

Summit Scientific

The results in this report apply to the samples analyzed in accordance with the chain of custody document. This analytical report must be reproduced in its entirety.



LT Environmental, Inc.
4600 West 60th Avenue
Arvada CO, 80003

Project: PDC - Williamson 44-12
Project Number: PDC 10027
Project Manager: Brian Dodek

Reported:
09/19/10 20:48

Volatile Organic Compounds by EPA Method 8260B - Quality Control

Summit Scientific

Analyte	Reporting			Spike	Source	%REC		RPD		
	Result	Limit	Units	Level	Result	%REC	Limits	RPD	Limit	Notes

Batch 0091801 - EPA 5030 Water MS

Blank (0091801-BLK1)

Prepared & Analyzed: 09/18/10

Benzene	ND	1.0	ug/l							
Toluene	ND	1.0	"							
Ethylbenzene	ND	1.0	"							
Xylenes (total)	ND	1.0	"							
Surrogate: 1,2-Dichloroethane-d4	14.6		"	13.3	110	57.9-139				
Surrogate: Toluene-d8	13.1		"	13.3	98.1	83.1-115				
Surrogate: 4-Bromofluorobenzene	13.3		"	13.3	99.8	80.8-120				

LCS (0091801-BS1)

Prepared & Analyzed: 09/18/10

Benzene	27.8	1.0	ug/l	33.3	83.3	60.1-131			10.9	
Toluene	25.3	1.0	"	33.3	75.9	65.9-127			11.3	
Ethylbenzene	27.4	1.0	"	33.3	82.3	65.1-129			20	
m,p-Xylene	52.9	2.0	"	66.7	79.4	66.8-127			20	
o-Xylene	26.7	1.0	"	33.3	80.1	61.2-120			20	
Surrogate: 1,2-Dichloroethane-d4	13.8		"	13.3	103	57.9-139				
Surrogate: Toluene-d8	13.2		"	13.3	98.8	83.1-115				
Surrogate: 4-Bromofluorobenzene	13.2		"	13.3	99.0	80.8-120				

LCS Dup (0091801-BSD1)

Prepared & Analyzed: 09/18/10

Benzene	24.1	1.0	ug/l	33.3	72.2	60.1-131	14.3		10.9	
Toluene	22.6	1.0	"	33.3	67.8	65.9-127	11.3		11.3	
Ethylbenzene	23.8	1.0	"	33.3	71.6	65.1-129	13.9		20	
m,p-Xylene	45.9	2.0	"	66.7	68.9	66.8-127	14.2		20	
o-Xylene	24.0	1.0	"	33.3	72.0	61.2-120	10.6		20	
Surrogate: 1,2-Dichloroethane-d4	14.2		"	13.3	106	57.9-139				
Surrogate: Toluene-d8	13.5		"	13.3	101	83.1-115				
Surrogate: 4-Bromofluorobenzene	13.4		"	13.3	100	80.8-120				

Summit Scientific

The results in this report apply to the samples analyzed in accordance with the chain of custody document. This analytical report must be reproduced in its entirety.



LT Environmental, Inc.
4600 West 60th Avenue
Arvada CO, 80003

Project: PDC - Williamson 44-12

Project Number: PDC 10027
Project Manager: Brian Dodek

Reported:
09/19/10 20:48

Notes and Definitions

DET Analyte DETECTED
ND Analyte NOT DETECTED at or above the reporting limit
NR Not Reported
dry Sample results reported on a dry weight basis
RPD Relative Percent Difference

Summit Scientific

A handwritten signature in black ink, appearing to be 'JD' or similar, with a long horizontal stroke extending to the right.

The results in this report apply to the samples analyzed in accordance with the chain of custody document. This analytical report must be reproduced in its entirety.