

Location:	COLORADO	Slot:	SLOT#03 DRY CREEK 4-27 (1169'FNL & 1213'FWL)
Field:	WELD COUNTY (KERR MCGEE)	Well:	DRY CREEK 4-27
Facility:	SEC.27-T1N-R67W	Wellbore:	DRY CREEK 4-27 PWB

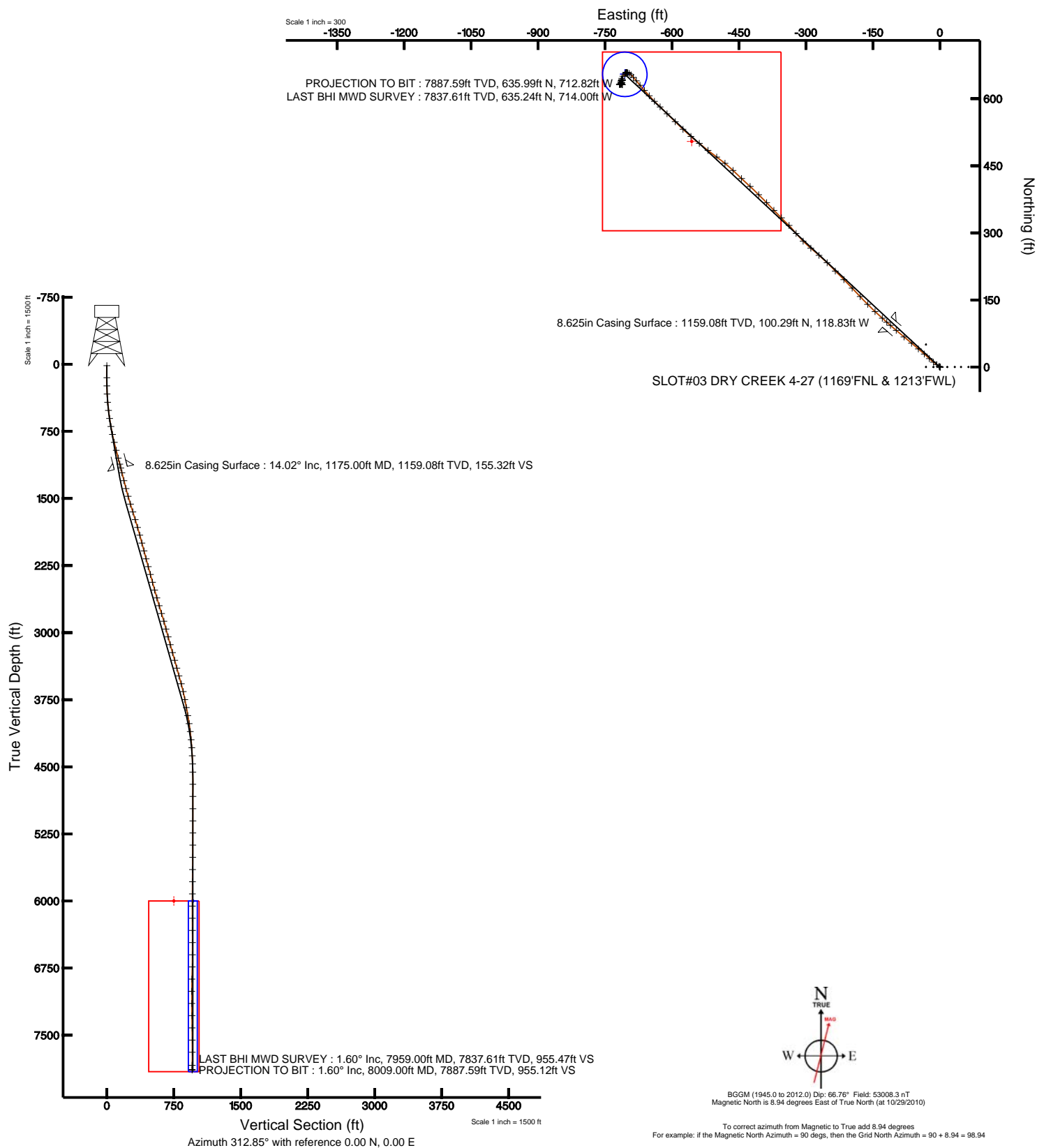

Plot reference weight is DRY CREEK 4-27 (REV-A.0) PWP True vertical depths are referenced to XTREME 12 (RT) Measured depths are referenced to XTREME 12 (RT) XTREME 12 (RT) to Mean Sea Level: 5022 feet Mean Sea Level to Mud line (Facility: SEC 27-T1N-R67W): 0 feet Coordinates are in feet referenced by Slat		Grid System: NAD83 / Lambert Colorado State Planes, Northern Zone (501). US feet North Reference: True north Scale: True distance Depths are in feet Created by: croskorn on 11/10/2010
---	--	---





# Actual Wellpath Report

DRY CREEK 4-27 AWP

Page 1 of 5



INTEQ

## REFERENCE WELLPATH IDENTIFICATION

Operator	KERR MCGEE OIL & GAS ONSHORE LP	Slot	SLOT#03 DRY CREEK 4-27 (1169'FNL & 1213'FWL)
Area	COLORADO	Well	DRY CREEK 4-27
Field	WELD COUNTY (KERR MCGEE)	Wellbore	DRY CREEK 4-27 awb
Facility	SEC.27-T1N-R67W		

## REPORT SETUP INFORMATION

Projection System	NAD83 / Lambert Colorado State Planes, Northern Zone (501), US feet	Software System	WellArchitect® 2.0
North Reference	True	User	Cookdanm
Scale	0.999964	Report Generated	11/1/2010 at 4:42:31 PM
Convergence at slot	0.40° East	Database/Source file	Denver Server/DRY_CREEK_4-27_awb.xml

## WELLPATH LOCATION

	Local coordinates		Grid coordinates		Geographic coordinates	
	North[ft]	East[ft]	Easting[USft]	Northing[USft]	Latitude	Longitude
Slot Location	0.00	30.81	3173128.79	1252968.83	40°01'34.068"N	104°52'54.408"W
Facility Reference Pt			3173097.99	1252968.61	40°01'34.068"N	104°52'54.804"W
Field Reference Pt			3197771.84	1268891.29	40°04'09.600"N	104°47'36.000"W

## WELLPATH DATUM

Calculation method	Minimum curvature	XTREME 12 (RT) to Facility Vertical Datum	5022.00ft
Horizontal Reference Pt	Slot	XTREME 12 (RT) to Mean Sea Level	5022.00ft
Vertical Reference Pt	XTREME 12 (RT)	Facility Vertical Datum to Mud Line (Facility)	0.00ft
MD Reference Pt	XTREME 12 (RT)	Section Origin	N 0.00, E 0.00 ft
Field Vertical Reference	Mean Sea Level	Section Azimuth	312.85°



# Actual Wellpath Report

DRY CREEK 4-27 AWP

Page 2 of 5



## REFERENCE WELLPATH IDENTIFICATION

Operator	KERR MCGEE OIL & GAS ONSHORE LP	Slot	SLOT#03 DRY CREEK 4-27 (1169'FNL & 1213'FWL)
Area	COLORADO	Well	DRY CREEK 4-27
Field	WELD COUNTY (KERR MCGEE)	Wellbore	DRY CREEK 4-27 awb
Facility	SEC.27-T1N-R67W		

## WELLPATH DATA (78 stations) † = interpolated/extrapolated station

MD [ft]	Inclination [°]	Azimuth [°]	TVD [ft]	Vert Sect [ft]	North [ft]	East [ft]	DLS [°/100ft]	Comments
0.00†	0.000	106.400	0.00	0.00	0.00	0.00	0.00	
15.00	0.000	106.400	15.00	0.00	0.00	0.00	0.00	
149.00	0.700	106.400	149.00	-0.73	-0.23	0.79	0.52	
240.00	0.600	305.700	239.99	-0.76	-0.11	0.93	1.41	
332.00	3.200	305.000	331.94	2.26	1.64	-1.56	2.83	
424.00	4.600	304.300	423.72	8.46	5.20	-6.71	1.52	
516.00	6.900	308.500	515.25	17.62	10.72	-14.09	2.54	
607.00	8.700	313.100	605.41	29.95	18.82	-23.39	2.09	
698.00	10.600	311.000	695.12	45.20	29.02	-34.74	2.12	
788.00	11.800	311.300	783.40	62.67	40.52	-47.90	1.33	
879.00	13.500	308.900	872.19	82.57	53.33	-63.15	1.95	
970.00	14.300	309.900	960.52	104.39	67.21	-80.04	0.92	
1061.00	14.700	311.000	1048.62	127.16	82.00	-97.38	0.53	
1130.00	14.200	309.900	1115.44	144.36	93.17	-110.48	0.83	
1230.00	13.800	312.400	1212.47	168.53	109.08	-128.70	0.73	
1321.00	14.400	312.400	1300.73	190.70	124.03	-145.07	0.66	
1412.00	15.000	315.900	1388.75	213.78	140.11	-161.62	1.18	
1502.00	16.100	316.600	1475.46	237.86	157.55	-178.30	1.24	
1593.00	17.100	316.300	1562.66	263.81	176.39	-196.21	1.10	
1684.00	17.000	314.800	1649.66	290.46	195.43	-214.89	0.50	
1775.00	17.600	315.500	1736.55	317.50	214.62	-233.98	0.70	
1866.00	15.900	314.800	1823.68	343.70	233.22	-252.47	1.88	
1956.00	15.900	310.300	1910.24	368.34	249.88	-270.62	1.37	
2047.00	15.100	311.700	1997.93	392.64	265.83	-288.97	0.97	
2138.00	14.600	313.400	2085.89	415.96	281.59	-306.16	0.73	
2229.00	15.100	321.200	2173.86	439.16	298.71	-321.92	2.26	
2320.00	15.400	316.300	2261.66	462.95	316.69	-337.69	1.45	
2411.00	15.300	313.100	2349.42	487.02	333.62	-354.81	0.94	
2501.00	15.200	316.600	2436.25	510.66	350.31	-371.59	1.03	
2592.00	15.200	316.600	2524.07	534.47	367.65	-387.98	0.00	
2683.00	16.900	314.100	2611.52	559.60	385.52	-405.68	2.02	
2774.00	17.000	313.100	2698.56	586.13	403.81	-424.89	0.34	
2865.00	16.500	312.400	2785.70	612.35	421.62	-444.14	0.59	
2956.00	16.900	314.100	2872.87	638.50	439.54	-463.19	0.69	
3046.00	14.400	308.500	2959.53	662.74	455.61	-481.34	3.24	
3137.00	15.200	306.100	3047.51	685.87	469.68	-499.84	1.11	
3228.00	16.000	308.500	3135.16	710.23	484.52	-519.29	1.13	
3319.00	15.900	309.600	3222.65	735.18	500.27	-538.71	0.35	
3409.00	15.600	308.900	3309.27	759.56	515.73	-557.63	0.39	
3500.00	14.900	315.500	3397.08	783.45	531.76	-575.35	2.06	
3591.00	16.100	313.100	3484.77	807.76	548.73	-592.77	1.49	
3682.00	16.600	315.500	3572.09	833.36	566.62	-611.09	0.92	
3772.00	11.400	313.400	3659.38	855.11	581.91	-626.58	5.80	
3863.00	11.100	314.800	3748.64	872.86	594.26	-639.33	0.45	
3954.00	10.500	318.700	3838.02	889.86	606.67	-651.01	1.04	



# Actual Wellpath Report

DRY CREEK 4-27 AWP

Page 3 of 5



INTEQ

REFERENCE WELLPATH IDENTIFICATION			
Operator	KERR MCGEE OIL & GAS ONSHORE LP	Slot	SLOT#03 DRY CREEK 4-27 (1169'FNL & 1213'FWL)
Area	COLORADO	Well	DRY CREEK 4-27
Field	WELD COUNTY (KERR MCGEE)	Wellbore	DRY CREEK 4-27 awb
Facility	SEC.27-T1N-R67W		

WELLPATH DATA (78 stations)								
MD [ft]	Inclination [°]	Azimuth [°]	TVD [ft]	Vert Sect [ft]	North [ft]	East [ft]	DLS [°/100ft]	Comments
4045.00	9.800	318.000	3927.60	905.83	618.65	-661.67	0.78	
4136.00	9.500	320.800	4017.31	920.98	630.23	-671.60	0.61	
4226.00	7.300	319.100	4106.34	934.02	640.30	-680.04	2.46	
4317.00	5.600	320.500	4196.76	944.17	648.10	-686.65	1.88	
4408.00	3.700	312.000	4287.46	951.50	653.49	-691.65	2.22	
4498.00	3.000	300.400	4377.31	956.71	656.63	-695.84	1.08	
4589.00	1.600	291.600	4468.23	960.22	658.30	-699.08	1.58	
4680.00	0.900	271.900	4559.21	961.94	658.79	-700.97	0.89	
4816.00	0.400	249.100	4695.20	962.96	658.66	-702.48	0.41	
4952.00	0.100	300.100	4831.20	963.28	658.55	-703.03	0.25	
5089.00	0.100	127.500	4968.20	963.28	658.53	-703.04	0.15	
5225.00	0.600	224.100	5104.20	963.18	657.95	-703.44	0.46	
5361.00	2.400	217.800	5240.14	962.94	655.19	-705.68	1.33	
5497.00	2.900	224.100	5376.00	962.77	650.47	-709.82	0.42	
5633.00	1.900	183.400	5511.89	961.41	645.75	-712.35	1.41	
5770.00	0.400	151.000	5648.86	959.51	643.06	-712.25	1.15	
5906.00	0.300	162.600	5784.85	958.75	642.31	-711.92	0.09	
6042.00	0.300	118.700	5920.85	958.10	641.80	-711.50	0.16	
6178.00	0.100	47.300	6056.85	957.74	641.71	-711.10	0.21	
6315.00	0.400	236.800	6193.85	957.85	641.52	-711.41	0.36	
6451.00	0.500	256.500	6329.85	958.29	641.13	-712.38	0.13	
6587.00	0.400	238.200	6465.84	958.75	640.74	-713.36	0.13	
6723.00	0.800	206.900	6601.83	958.61	639.64	-714.20	0.37	
6859.00	1.500	164.400	6737.81	956.83	637.08	-714.15	0.78	
6995.00	2.100	143.300	6873.74	952.87	633.37	-712.18	0.65	
7132.00	0.200	298.300	7010.71	950.63	631.47	-710.89	1.67	
7268.00	1.100	275.500	7146.70	951.90	631.71	-712.40	0.68	
7404.00	1.100	269.500	7282.68	953.88	631.82	-715.00	0.08	
7541.00	0.700	267.400	7419.66	955.43	631.77	-717.15	0.29	
7677.00	0.400	20.200	7555.66	956.19	632.18	-717.82	0.68	
7813.00	1.000	51.900	7691.65	956.19	633.36	-716.72	0.51	
7959.00	1.600	57.500	7837.61	955.47	635.24	-714.00	0.42	LAST BHI MWD SURVEY
8009.00	1.600	57.500	7887.59	955.12	635.99	-712.82	0.00	PROJECTION TO BIT



# Actual Wellpath Report

DRY CREEK 4-27 AWP

Page 4 of 5



INTEQ

REFERENCE WELLPATH IDENTIFICATION			
Operator	KERR MCGEE OIL & GAS ONSHORE LP	Slot	SLOT#03 DRY CREEK 4-27 (1169'FNL & 1213'FWL)
Area	COLORADO	Well	DRY CREEK 4-27
Field	WELD COUNTY (KERR MCGEE)	Wellbore	DRY CREEK 4-27 awb
Facility	SEC.27-T1N-R67W		

HOLE & CASING SECTIONS Ref Wellbore: DRY CREEK 4-27 awb Ref Wellpath: DRY CREEK 4-27 AWP									
String/Diameter	Start MD [ft]	End MD [ft]	Interval [ft]	Start TVD [ft]	End TVD [ft]	Start N/S [ft]	Start E/W [ft]	End N/S [ft]	End E/W [ft]
12.25in Open Hole	15.00	1185.00	1170.00	15.00	1168.79	0.00	0.00	101.88	-120.65
8.625in Casing Surface	15.00	1175.00	1160.00	15.00	1159.08	0.00	0.00	100.29	-118.83
7.875in Open Hole	1175.00	8009.00	6834.00	1159.08	7887.59	100.29	-118.83	635.99	-712.82

TARGETS									
Name	MD [ft]	TVD [ft]	North [ft]	East [ft]	Grid East [srv ft]	Grid North [srv ft]	Latitude	Longitude	Shape
DRY CREEK 4-27 BHL ON PLAT (510'FNL & 510'FWL, REV-1)		6000.00	655.73	-705.72	3172418.54	1253619.60	40°01'40.548"N	104°53'03.480"W	point
DRY CREEK 4-27 GEO TARGET 50' RADIUS (511'FNL & 510'FWL, REV-2)		6000.00	654.73	-705.72	3172418.55	1253618.60	40°01'40.538"N	104°53'03.480"W	circle
DRY CREEK 4-27 LEGAL BOX (50'N,350'S,50'W,350'E OF THE GEO TARGET)		6000.00	504.73	-555.72	3172569.59	1253469.65	40°01'39.056"N	104°53'01.552"W	square

WELLPATH COMPOSITION Ref Wellbore: DRY CREEK 4-27 awb Ref Wellpath: DRY CREEK 4-27 AWP				
Start MD [ft]	End MD [ft]	Positional Uncertainty Model	Log Name/Comment	Wellbore
15.00	1130.00	NaviTrak (Standard)	BHI MWD SURVEYS 12.25 HOLE <149-1130>	DRY CREEK 4-27 awb
1130.00	7959.00	NaviTrak (Standard)	BHI MWD SURVEYS 7.875 HOLE <1230-7959>	DRY CREEK 4-27 awb
7959.00	8009.00	Blind Drilling (std)	Projection to bit	DRY CREEK 4-27 awb



# Actual Wellpath Report

DRY CREEK 4-27 AWP

Page 5 of 5



INTEQ

## REFERENCE WELLPATH IDENTIFICATION

Operator	KERR MCGEE OIL & GAS ONSHORE LP	Slot	SLOT#03 DRY CREEK 4-27 (1169'FNL & 1213'FWL)
Area	COLORADO	Well	DRY CREEK 4-27
Field	WELD COUNTY (KERR MCGEE)	Wellbore	DRY CREEK 4-27 awb
Facility	SEC.27-T1N-R67W		

## WELLPATH COMMENTS

MD [ft]	Inclination [°]	Azimuth [°]	TVD [ft]	Comment
7959.00	1.600	57.500	7837.61	LAST BHI MWD SURVEY
8009.00	1.600	57.500	7887.59	PROJECTION TO BIT