

T11N, R97W, 6th P.M.

WEXPRO COMPANY

Well location, POWDER WASH #3-1,
located as shown in the SE 1/4 NE 1/4
of Section 3, T11N, R97W, 6th P.M.,
Moffat County, Colorado.

BASIS OF ELEVATION

SPOT ELEVATION LOCATED AT THE SOUTHEAST CORNER OF
SECTION 4, T11N, R97W, 6th P.M. TAKEN FROM THE POWDER
WASH QUADRANGLE, COLORADO, MOFFAT COUNTY, 7.5
MINUTE SERIES (TOPOGRAPHICAL MAP) PUBLISHED BY THE
UNITED STATES DEPARTMENT OF THE INTERIOR, GEOLOGICAL
SURVEY. SAID ELEVATION IS MARKED AS BEING 6644 FEET.

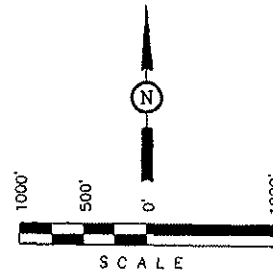

CERTIFICATE

THIS IS TO CERTIFY THAT THE ABOVE PLAT WAS PREPARED FROM
FIELD NOTES OF ACTUAL SURVEY MADE BY ME OR UNDER MY
SUPERVISION AND THAT THE SAME ARE TRUE AND CORRECT TO THE
BEST OF MY KNOWLEDGE AND BELIEF.

REGISTERED LAND SURVEYOR
STATE OF COLORADO

REVISED: 05-12-09

UNTAH ENGINEERING & LAND SURVEYING
85 SOUTH 200 EAST - VERNAL, UTAH 84078
(435) 789-1017

SCALE 1" = 1000'	DATE SURVEYED: 07-15-08	DATE DRAWN: 07-23-08
PARTY T.A. C.D. S.L.	REFERENCES G.L.O. PLAT	
WEATHER HOT	FILE WEXPRO COMPANY	

PDOP = 1.6

N89°53'28"E - 5284.10' (Meas.)

Set Marked Stone
Lot: 40.949583
Long: 108.267917

T12N

T11N

3/8" Rebar,
Pile of Stones,
Replaced Rebar,
w/ 3/4" Rebar
& 2" Alum. Cap
Lot: 40.949556
Long: 108.267039

Lot 7

Lot 6

Lot 5

Lot 8

Set Marked Stone,
Pile of Stones,
Steel Post
Lot: 40.942372
Long: 108.267022

POWDER WASH #3-1
Elev. Ungraded Ground = 6785'

NOTE:
SEE ADDENDUM TO LEGAL PLAT FOR
EXISTING IMPROVEMENTS WITHIN 400'
OF THE PROPOSED WELL HEAD.

Set Marked Stone
Lot: 40.942383
Long: 108.267894

N00°05'44"W - 2618.14' (Meas.)

Set Marked Stone,
Pile of Stones,
Steel Post
Lot: 40.935067
Long: 108.267022

BASIS OF BEARINGS
BASIS OF BEARINGS IS A G.P.S. OBSERVATION.

N89°41'58"E - 5282.44' (Meas.)

(NAD 83)
LATITUDE = 40°56'37.81" (40.943836)
LONGITUDE = 108°16'13.26" (108.270350)
(NAD 27)
LATITUDE = 40°56'37.94" (40.943872)
LONGITUDE = 108°16'10.92" (108.269700)

LEGEND:

- └─ = 90° SYMBOL
- = PROPOSED WELL HEAD.
- ▲ = SECTION CORNERS LOCATED.

01/12/2008

081-07596

COGCC

SEP 04 2009

RECEIVED

RECEIVED

SEP 04 2009

COGCC

WEXPRO COMPANY

TYPICAL CROSS SECTION FOR

POWDER WASH #3-1
SECTION 3, T11N, R97W, 6TH P.M.
2093' FNL 678' FEL

FIGURE #2

1" = 40'
X-Section
Scale
1" = 100'
DATE: 05-12-09
DRAWN BY: S.L.

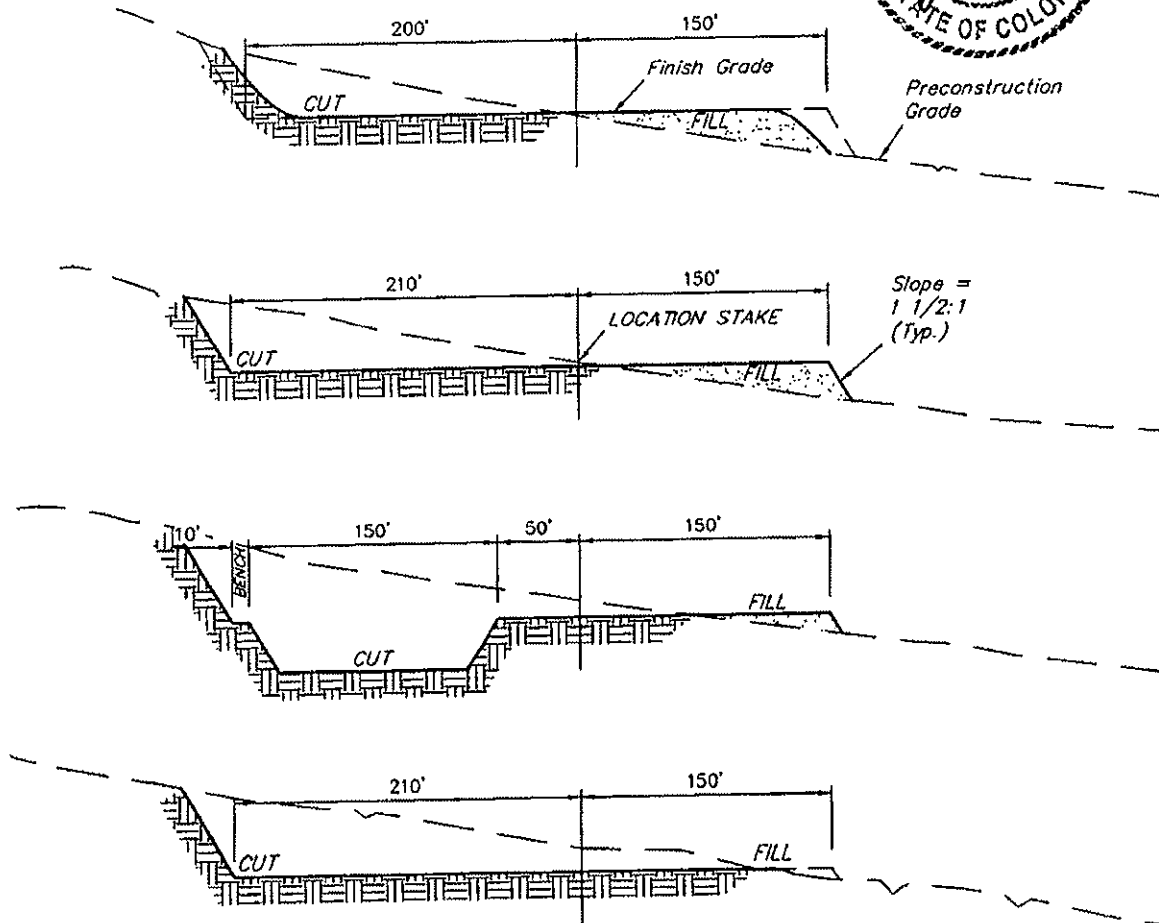
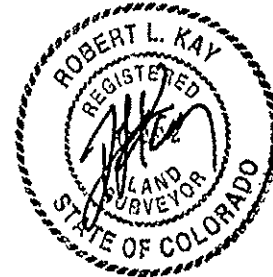

APPROXIMATE ACREAGES

WELL SITE DISTURBANCE = ± 4.894 ACRES
ACCESS ROAD DISTURBANCE = ± 0.196 ACRES
SECONDARY ACCESS ROAD DISTURBANCE = ± 0.223 ACRES
PIPELINE DISTURBANCE = ± 0.831 ACRES
TOTAL = ± 6.144 ACRES

* NOTE:
FILL QUANTITY INCLUDES
5% FOR COMPACTION

NOTE:
Topsoil should not be
Stripped Below Finished
Grade on Substructure Area.

APPROXIMATE YARDAGES

(6") Topsoil Stripping = 3,280 Cu. Yds.
Remaining Location = 41,740 Cu. Yds.
TOTAL CUT = 45,020 CU.YDS.
FILL = 9,890 CU.YDS.

EXCESS MATERIAL = 35,130 Cu. Yds.
Topsoil & Pit Backfill = 8,230 Cu. Yds.
(1/2 Pit Vol.)
EXCESS UNBALANCE = 26,900 Cu. Yds.
(After Interim Rehabilitation)

UINTAH ENGINEERING & LAND SURVEYING
85 So. 200 East • Vernal, Utah 84078 • (435) 789-1017

RECEIVED

SEP 04 2009

WEXPRO COMPANY

COGCC

FIGURE #3

TYPICAL RIG LAYOUT FOR

POWDER WASH #3-1

SECTION 3, T11N, R97W, 6TH P.M.

2093' FNL 678' FEL

SCALE: 1" = 60'

DATE: 05-12-09

DRAWN BY: S.L.

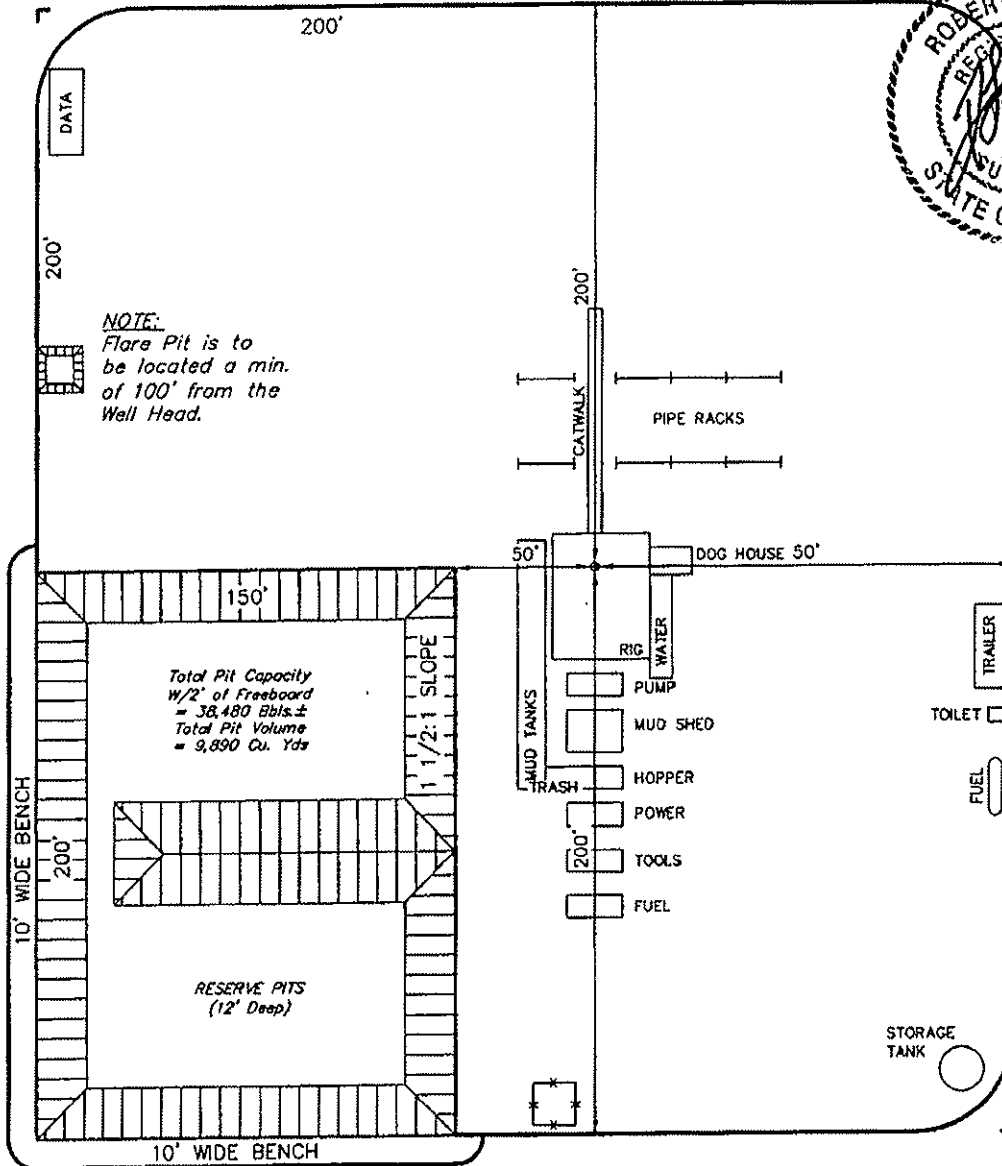

UINTAH ENGINEERING & LAND SURVEYING
85 So. 200 East • Vernal, Utah 84078 • (435) 789-1017

RECEIVED

SEP 04 2009

WEXPRO COMPANY
ADDENDUM TO LEGAL PLAT FOR

POWDER WASH #3-1
SECTION 3, T11N, R97W, 6TH P.M.
2093' FNL 678' FEL

Construct
Silt Fence

SCALE: 1" = 60'
DATE: 05-12-09
DRAWN BY: S.L.

