

EOG RESOURCES, INC.
CRITTER CREEK #26-33H
SECTION 33, T11N, R63W, 6th P.M.

PROCEED IN A WESTERLY DIRECTION FROM HEREFORD, COLORADO ALONG COUNTY ROAD 136 APPROXIMATELY 1.5 MILES TO THE JUNCTION OF COUNTY ROAD 136 AND COUNTY ROAD 77 TO THE SOUTH; TURN LEFT AND PROCEED IN A SOUTHERLY DIRECTION APPROXIMATELY 2.0 MILES TO THE JUNCTION OF COUNTY ROAD 77 AND COUNTY ROAD 132 TO THE WEST; TURN RIGHT AND PROCEED IN A WESTERLY DIRECTION APPROXIMATELY 5.0 MILES TO THE JUNCTION OF COUNTY ROAD 132 AND COUNTY ROAD 67 TO THE SOUTH; TURN LEFT AND PROCEED IN A SOUTHERLY DIRECTION APPROXIMATELY 4.9 MILES TO THE BEGINNING OF THE PROPOSED ACCESS ROAD TO THE WEST; FOLLOW ROAD FLAGS IN A WESTERLY DIRECTION APPROXIMATELY 289' TO THE PROPOSED LOCATION.

TOTAL DISTANCE FROM HEREFORD, COLORADO TO THE PROPOSED LOCATION IS APPROXIMATELY 13.4 MILES.

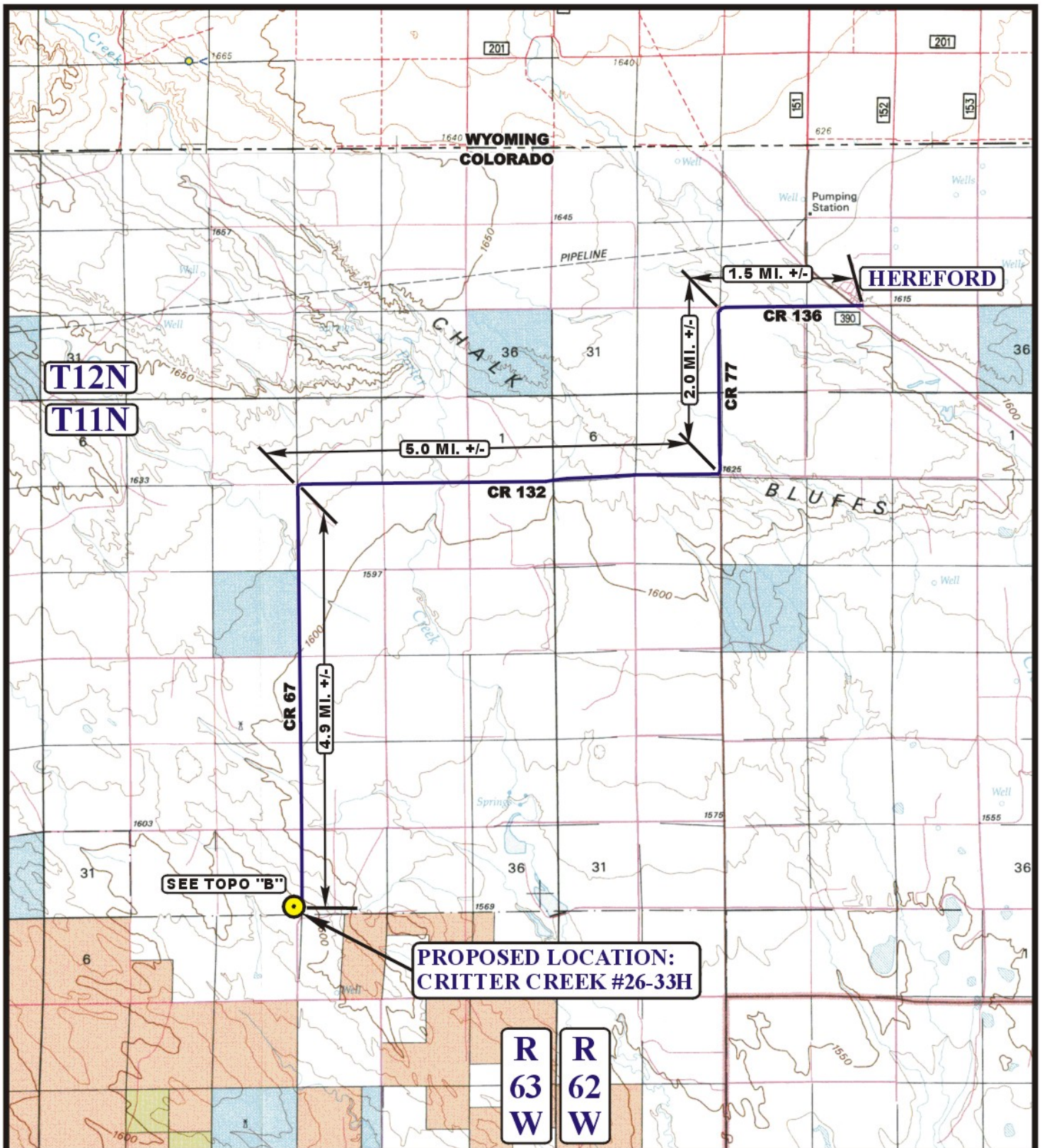

LEGEND:

PROPOSED LOCATION

N

EOG RESOURCES, INC.

CRITTER CREEK #26-33H
SECTION 33, T11N, R63W, 6th P.M.
501' FSL 501' FEL

UEIS

Uintah Engineering & Land Surveying
 85 South 200 East Vernal, Utah 84078
 (435) 789-1017 * FAX (435) 789-1813

ACCESS ROAD
MAP

01 27 10
 MONTH DAY YEAR

A
TOPO

SCALE: 1:100,000 DRAWN BY: J.H. REV: 10-05-10 Z.L.

