

KERR MCGEE OIL & GAS ONSHORE LP

Location: COLORADO Slot: SLOT#22 HIGHWAY 160 7-2 (1496'FNL & 1659'FEL)
 Field: WELD COUNTY (KERR MCGEE) Well: HIGHWAY 160 7-2
 Facility: SEC.02-T1N-R66W Wellbore: HIGHWAY 160 7-2 PWB

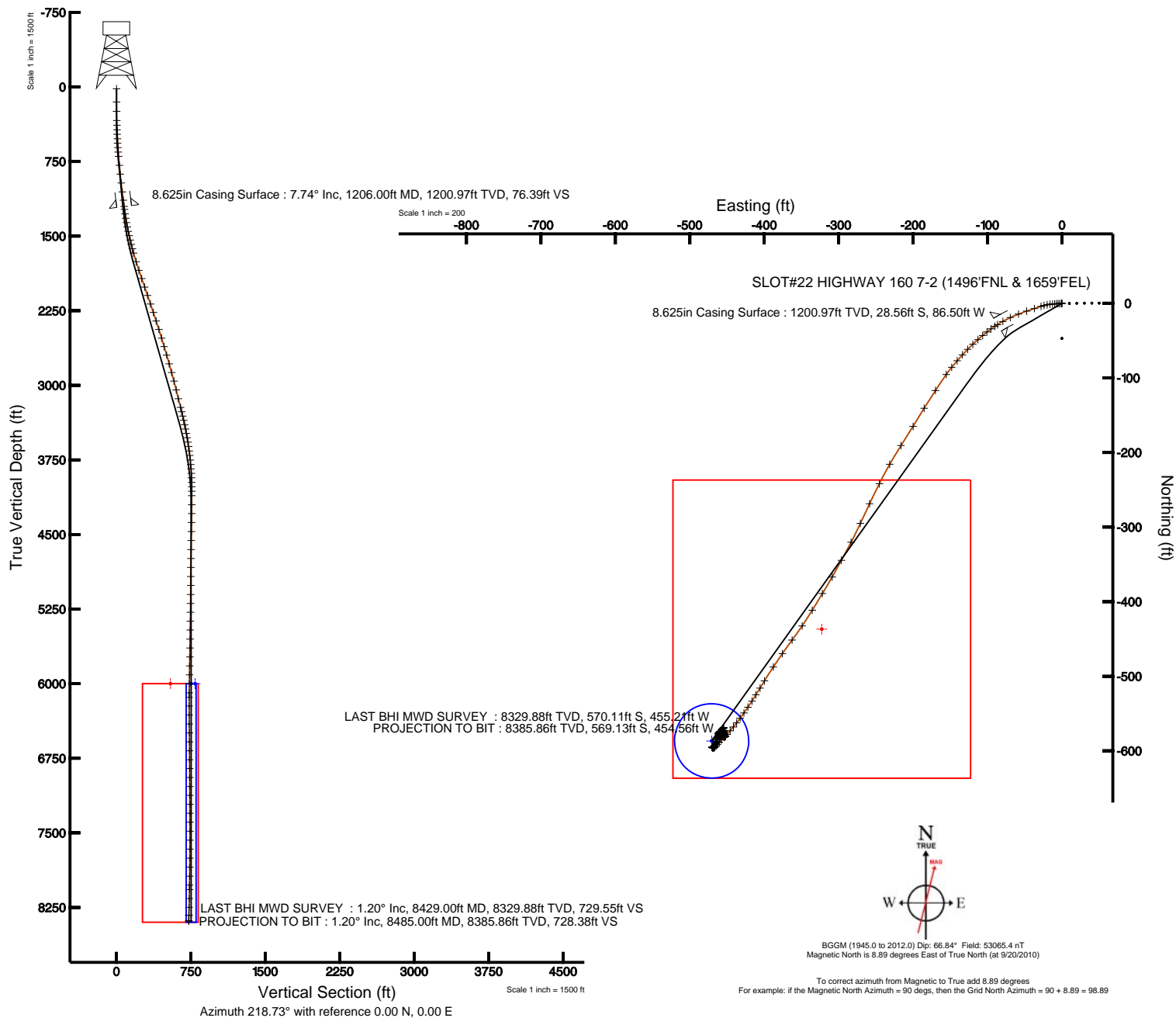

Plot reference wellpath is HIGHWAY 160 7-2 (REV-A.0) PWB	
True vertical depths are referenced to XTREME 8 (RT)	Grid System: NAD83 / Lambert Colorado State Planes, Northern Zone (501), US feet
Measured depths are referenced to XTREME 8 (RT)	North Reference: True north
XTREME 8 (RT) to Mean Sea Level: 5122 feet	Scale: True distance
Mean Sea Level to Mud line (Facility: SEC.02-T1N-R66W): 0 feet	Depths are in feet
Coordinates are in feet referenced to Slot	Created by: cookdamm on 10/26/2010





Actual Wellpath Report

HIGHWAY 160 7-2 AWP

Page 1 of 6



INTEQ

REFERENCE WELLPATH IDENTIFICATION

Operator	KERR MCGEE OIL & GAS ONSHORE LP	Slot	SLOT#22 HIGHWAY 160 7-2 (1496'FNL & 1659'FEL)
Area	COLORADO	Well	HIGHWAY 160 7-2
Field	WELD COUNTY (KERR MCGEE)	Wellbore	HIGHWAY 160 7-2 AWB
Facility	SEC.02-T1N-R66W		

REPORT SETUP INFORMATION

Projection System	NAD83 / Lambert Colorado State Planes, Northern Zone (501), US feet	Software System	WellArchitect® 2.0
North Reference	True	User	Cookdanm
Scale	0.999961	Report Generated	10/26/2010 at 10:31:10 AM
Convergence at slot	0.49° East	Database/Source file	Denver Server/HIGHWAY_160_7-2_AWB.xml

WELLPATH LOCATION

	Local coordinates		Grid coordinates		Geographic coordinates	
	North[ft]	East[ft]	Easting[USft]	Northing[USft]	Latitude	Longitude
Slot Location	-298.97	2395.29	3212439.32	1274082.95	40°04'59.707"N	104°44'26.765"W
Facility Reference Pt			3210041.69	1274361.62	40°05'02.663"N	104°44'57.581"W
Field Reference Pt			3197771.84	1268891.29	40°04'09.600"N	104°47'36.000"W

WELLPATH DATUM

Calculation method	Minimum curvature	XTREME 8 (RT) to Facility Vertical Datum	5122.00ft
Horizontal Reference Pt	Slot	XTREME 8 (RT) to Mean Sea Level	5122.00ft
Vertical Reference Pt	XTREME 8 (RT)	Facility Vertical Datum to Mud Line (Facility)	0.00ft
MD Reference Pt	XTREME 8 (RT)	Section Origin	N 0.00, E 0.00 ft
Field Vertical Reference	Mean Sea Level	Section Azimuth	218.73°



Actual Wellpath Report

HIGHWAY 160 7-2 AWP

Page 2 of 6



INTEQ

REFERENCE WELLPATH IDENTIFICATION

Operator	KERR MCGEE OIL & GAS ONSHORE LP	Slot	SLOT#22 HIGHWAY 160 7-2 (1496'FNL & 1659'FEL)
Area	COLORADO	Well	HIGHWAY 160 7-2
Field	WELD COUNTY (KERR MCGEE)	Wellbore	HIGHWAY 160 7-2 AWB
Facility	SEC.02-T1N-R66W		

WELLPATH DATA (116 stations) † = interpolated/extrapolated station

MD [ft]	Inclination [°]	Azimuth [°]	TVD [ft]	Vert Sect [ft]	North [ft]	East [ft]	DLS [°/100ft]	Comments
0.00†	0.000	229.700	0.00	0.00	0.00	0.00	0.00	
17.00	0.000	229.700	17.00	0.00	0.00	0.00	0.00	
151.00	0.100	229.700	151.00	0.11	-0.08	-0.09	0.07	
244.00	0.900	256.400	244.00	0.77	-0.30	-0.86	0.87	
337.00	2.200	273.300	336.96	2.39	-0.37	-3.35	1.47	
384.00	2.600	265.200	383.92	3.64	-0.41	-5.32	1.11	
430.00	2.600	268.300	429.87	5.04	-0.52	-7.40	0.31	
475.00	3.300	264.800	474.81	6.60	-0.67	-9.71	1.61	
520.00	4.000	266.600	519.72	8.55	-0.88	-12.57	1.58	
565.00	4.700	264.500	564.59	10.89	-1.15	-15.97	1.60	
610.00	5.200	257.400	609.42	13.77	-1.77	-19.79	1.76	
655.00	5.500	256.000	654.23	17.08	-2.74	-23.88	0.73	
699.00	5.600	251.800	698.02	20.55	-3.92	-27.96	0.95	
789.00	6.500	251.100	787.52	28.53	-6.94	-36.95	1.00	
878.00	7.600	252.200	875.84	37.70	-10.37	-47.32	1.25	
968.00	7.300	248.000	965.08	47.65	-14.34	-58.29	0.69	
1058.00	8.000	246.200	1054.28	58.20	-19.00	-69.32	0.82	
1143.00	7.400	238.500	1138.52	68.60	-24.25	-79.40	1.40	
1236.00	7.900	239.200	1230.69	80.22	-30.65	-90.00	0.55	
1281.00	8.500	233.900	1275.23	86.33	-34.20	-95.34	2.14	
1325.00	9.200	232.100	1318.71	92.89	-38.27	-100.74	1.71	
1370.00	10.100	229.000	1363.07	100.27	-43.07	-106.56	2.31	
1415.00	11.400	228.600	1407.28	108.53	-48.60	-112.88	2.89	
1460.00	12.300	226.500	1451.32	117.67	-54.84	-119.69	2.22	
1504.00	12.800	224.500	1494.27	127.16	-61.54	-126.50	1.51	
1550.00	13.200	223.300	1539.09	137.46	-69.00	-133.68	1.05	
1595.00	14.100	219.500	1582.82	148.07	-76.97	-140.69	2.82	
1640.00	15.300	220.200	1626.35	159.48	-85.74	-148.01	2.70	
1686.00	15.500	214.600	1670.70	171.68	-95.43	-155.42	3.26	
1776.00	17.900	213.900	1756.89	197.46	-116.81	-169.96	2.68	
1867.00	18.300	211.000	1843.39	225.55	-140.67	-185.12	1.08	
1955.00	19.600	211.700	1926.62	253.89	-165.07	-199.99	1.50	
2046.00	19.300	213.200	2012.43	284.01	-190.64	-216.25	0.64	
2135.00	19.300	208.900	2096.43	313.14	-215.82	-231.41	1.60	
2225.00	19.100	206.800	2181.43	342.21	-241.99	-245.24	0.80	
2316.00	19.200	205.800	2267.39	371.36	-268.75	-258.46	0.38	
2406.00	18.500	204.400	2352.56	399.62	-295.08	-270.80	0.93	
2496.00	18.000	208.200	2438.04	427.12	-320.34	-283.27	1.43	
2587.00	17.200	208.200	2524.78	454.18	-344.58	-296.27	0.88	
2676.00	16.300	210.000	2610.00	479.46	-367.00	-308.74	1.17	
2766.00	16.900	211.400	2696.25	504.92	-389.10	-321.87	0.80	
2857.00	16.600	211.000	2783.39	530.92	-411.54	-335.45	0.35	
2948.00	15.300	214.900	2870.89	555.78	-432.53	-349.02	1.85	
3038.00	14.800	216.300	2957.80	579.11	-451.53	-362.62	0.69	
3129.00	13.700	214.600	3046.00	601.47	-469.77	-375.62	1.29	



Actual Wellpath Report

HIGHWAY 160 7-2 AWP

Page 3 of 6



INTEQ

REFERENCE WELLPATH IDENTIFICATION

Operator	KERR MCGEE OIL & GAS ONSHORE LP	Slot	SLOT#22 HIGHWAY 160 7-2 (1496'FNL & 1659'FEL)
Area	COLORADO	Well	HIGHWAY 160 7-2
Field	WELD COUNTY (KERR MCGEE)	Wellbore	HIGHWAY 160 7-2 AWB
Facility	SEC.02-T1N-R66W		

WELLPATH DATA (116 stations)

MD [ft]	Inclination [°]	Azimuth [°]	TVD [ft]	Vert Sect [ft]	North [ft]	East [ft]	DLS [°/100ft]	Comments
3220.00	13.800	213.900	3134.39	623.04	-487.65	-387.79	0.21	
3310.00	14.800	211.400	3221.60	645.13	-506.37	-399.77	1.31	
3355.00	14.000	211.400	3265.19	656.23	-515.92	-405.60	1.78	
3400.00	13.500	212.100	3308.90	666.85	-525.01	-411.23	1.17	
3444.00	12.500	212.100	3351.77	676.68	-533.40	-416.48	2.27	
3489.00	12.600	214.600	3395.70	686.41	-541.56	-421.86	1.23	
3533.00	11.900	214.900	3438.69	695.73	-549.24	-427.18	1.60	
3578.00	10.500	217.400	3482.84	704.46	-556.30	-432.33	3.29	
3623.00	9.600	217.400	3527.15	712.31	-562.54	-437.10	2.00	
3667.00	8.900	219.500	3570.57	719.38	-568.08	-441.49	1.77	
3712.00	8.300	220.900	3615.07	726.10	-573.22	-445.83	1.41	
3758.00	7.700	221.600	3660.62	732.50	-578.03	-450.05	1.32	
3803.00	6.500	227.600	3705.27	738.03	-582.01	-453.93	3.13	
3849.00	6.000	226.200	3751.00	742.98	-585.43	-457.59	1.14	
3894.00	5.200	217.700	3795.79	747.35	-588.67	-460.53	2.56	
3939.00	4.100	221.200	3840.64	751.00	-591.49	-462.84	2.52	
3984.00	3.600	215.300	3885.54	754.02	-593.85	-464.72	1.42	
4029.00	2.200	237.100	3930.48	756.25	-595.48	-466.26	3.91	
4075.00	1.600	247.600	3976.45	757.65	-596.20	-467.59	1.50	
4118.00	1.200	264.100	4019.44	758.49	-596.48	-468.60	1.31	
4163.00	1.100	323.200	4064.43	758.71	-596.18	-469.32	2.53	
4208.00	1.100	304.900	4109.43	758.64	-595.59	-469.94	0.78	
4299.00	0.200	104.900	4200.42	758.63	-595.13	-470.50	1.42	
4388.00	0.900	76.400	4289.42	758.01	-595.00	-469.67	0.82	
4478.00	1.100	50.700	4379.40	756.61	-594.29	-468.32	0.54	
4569.00	1.100	38.400	4470.39	754.88	-593.05	-467.10	0.26	
4659.00	1.900	44.400	4560.35	752.53	-591.31	-465.52	0.90	
4750.00	0.400	335.500	4651.34	750.89	-589.94	-464.59	1.97	
4840.00	0.500	5.000	4741.33	750.42	-589.26	-464.69	0.28	
4930.00	1.100	30.300	4831.32	749.24	-588.13	-464.22	0.76	
5021.00	0.300	253.600	4922.32	748.57	-587.44	-464.01	1.47	
5111.00	0.700	333.000	5012.32	748.54	-587.02	-464.48	0.79	
5202.00	1.500	345.700	5103.30	747.59	-585.37	-465.03	0.91	
5292.00	0.600	40.200	5193.28	746.41	-583.87	-465.02	1.39	
5381.00	0.800	50.400	5282.28	745.34	-583.11	-464.24	0.26	
5471.00	1.200	26.100	5372.26	743.80	-581.87	-463.34	0.64	
5560.00	0.900	68.700	5461.25	742.29	-580.78	-462.28	0.91	
5650.00	0.600	98.500	5551.24	741.44	-580.59	-461.15	0.54	
5741.00	0.800	57.800	5642.24	740.60	-580.32	-460.14	0.57	
5831.00	1.100	52.100	5732.22	739.16	-579.46	-458.93	0.35	
5920.00	1.100	48.600	5821.21	737.49	-578.37	-457.61	0.08	
6010.00	1.100	30.000	5911.19	735.79	-577.05	-456.53	0.40	
6100.00	1.500	34.200	6001.17	733.76	-575.32	-455.44	0.46	
6191.00	1.300	33.500	6092.14	731.54	-573.48	-454.20	0.22	
6236.00	0.400	301.000	6137.14	731.06	-572.97	-454.05	3.06	



Actual Wellpath Report

HIGHWAY 160 7-2 AWP

Page 4 of 6



INTEQ

REFERENCE WELLPATH IDENTIFICATION

Operator	KERR MCGEE OIL & GAS ONSHORE LP	Slot	SLOT#22 HIGHWAY 160 7-2 (1496'FNL & 1659'FEL)
Area	COLORADO	Well	HIGHWAY 160 7-2
Field	WELD COUNTY (KERR MCGEE)	Wellbore	HIGHWAY 160 7-2 AWP
Facility	SEC.02-T1N-R66W		

WELLPATH DATA (116 stations)

MD [ft]	Inclination [°]	Azimuth [°]	TVD [ft]	Vert Sect [ft]	North [ft]	East [ft]	DLS [°/100ft]	Comments
6324.00	0.800	226.200	6225.13	731.71	-573.24	-454.76	0.90	
6414.00	0.300	62.000	6315.13	732.11	-573.56	-455.01	1.21	
6505.00	1.200	165.700	6406.12	732.47	-574.37	-454.56	1.43	
6595.00	1.700	171.700	6496.10	733.94	-576.61	-454.14	0.58	
6685.00	1.300	144.600	6586.07	735.13	-578.76	-453.35	0.89	
6775.00	0.800	143.900	6676.05	735.58	-580.10	-452.39	0.56	
6864.00	0.400	184.700	6765.05	736.00	-580.91	-452.05	0.63	
6953.00	0.700	265.200	6854.04	736.63	-581.27	-452.62	0.84	
7043.00	1.000	262.700	6944.03	737.57	-581.41	-453.94	0.34	
7134.00	0.900	288.700	7035.02	738.39	-581.29	-455.41	0.48	
7223.00	1.100	295.400	7124.01	738.83	-580.69	-456.84	0.26	
7313.00	0.300	287.700	7214.00	739.11	-580.25	-457.85	0.89	
7402.00	0.700	272.900	7303.00	739.51	-580.15	-458.61	0.47	
7493.00	0.700	297.900	7393.99	739.94	-579.87	-459.66	0.33	
7584.00	0.700	293.700	7484.98	740.19	-579.38	-460.66	0.06	
7674.00	0.300	337.300	7574.98	740.22	-578.94	-461.25	0.58	
7764.00	0.800	344.600	7664.97	739.74	-578.12	-461.51	0.56	
7855.00	0.500	345.300	7755.97	739.13	-577.12	-461.78	0.33	
7945.00	0.500	17.300	7845.96	738.53	-576.37	-461.76	0.31	
8036.00	1.000	44.800	7936.96	737.37	-575.43	-461.08	0.66	
8126.00	1.000	51.400	8026.94	735.82	-574.38	-459.92	0.13	
8171.00	1.200	53.400	8071.94	734.98	-573.85	-459.23	0.45	
8260.00	1.100	54.200	8160.92	733.26	-572.80	-457.79	0.11	
8349.00	1.400	43.700	8249.90	731.35	-571.51	-456.35	0.42	
8429.00	1.200	33.500	8329.88	729.55	-570.11	-455.21	0.38	LAST BHI MWD SURVEY
8485.00	1.200	33.500	8385.86	728.38	-569.13	-454.56	0.00	PROJECTION TO BIT

HOLE & CASING SECTIONS Ref Wellbore: HIGHWAY 160 7-2 AWP Ref Wellpath: HIGHWAY 160 7-2 AWP

String/Diameter	Start MD [ft]	End MD [ft]	Interval [ft]	Start TVD [ft]	End TVD [ft]	Start N/S [ft]	Start E/W [ft]	End N/S [ft]	End E/W [ft]
12.25in Open Hole	17.00	1206.00	1189.00	17.00	1200.97	0.00	0.00	-28.56	-86.50
8.625in Casing Surface	17.00	1206.00	1189.00	17.00	1200.97	0.00	0.00	-28.56	-86.50
7.875in Open Hole	1206.00	8485.00	7279.00	1200.97	8385.86	-28.56	-86.50	-569.13	-454.56



Actual Wellpath Report

HIGHWAY 160 7-2 AWP

Page 5 of 6



INTEQ

REFERENCE WELLPATH IDENTIFICATION

Operator	KERR MCGEE OIL & GAS ONSHORE LP	Slot	SLOT#22 HIGHWAY 160 7-2 (1496'FNL & 1659'FEL)
Area	COLORADO	Well	HIGHWAY 160 7-2
Field	WELD COUNTY (KERR MCGEE)	Wellbore	HIGHWAY 160 7-2 AWB
Facility	SEC.02-T1N-R66W		

TARGETS

Name	MD [ft]	TVD [ft]	North [ft]	East [ft]	Grid East [srv ft]	Grid North [srv ft]	Latitude	Longitude	Shape
HIGHWAY 160 7-2 BHL ON PLAT (2130'FNL & 2130'FEL, REV-1)		6000.00	-637.87	-470.67	3211974.14	1273441.10	40°04'53.404"N	104°44'32.820"W	point
HIGHWAY 160 7-2 GEO TARGET 50' RADIUS (2079'FNL & 2130'FEL, REV-2)		6000.00	-586.87	-470.67	3211973.71	1273492.09	40°04'53.908"N	104°44'32.820"W	circle
HIGHWAY 160 7-2 LEGAL BOX (50'S,350'N,348'E,52'W OF GEO TARGET)		6000.00	-436.87	-322.67	3212120.41	1273643.35	40°04'55.390"N	104°44'30.916"W	square

WELLPATH COMPOSITION Ref Wellbore: HIGHWAY 160 7-2 AWB Ref Wellpath: HIGHWAY 160 7-2 AWP

Start MD [ft]	End MD [ft]	Positional Uncertainty Model	Log Name/Comment	Wellbore
17.00	1143.00	NaviTrak (Standard)	SURFACE BHI MWD SURVEYS 12.25 HOLE <151-1143>	HIGHWAY 160 7-2 AWB
1143.00	8429.00	NaviTrak (Standard)	BHI MWD SURVEYS 7.875 HOLE <1236-8429>	HIGHWAY 160 7-2 AWB
8429.00	8485.00	Blind Drilling (std)	Projection to bit	HIGHWAY 160 7-2 AWB



Actual Wellpath Report

HIGHWAY 160 7-2 AWP

Page 6 of 6



INTEQ

REFERENCE WELLPATH IDENTIFICATION

Operator	KERR MCGEE OIL & GAS ONSHORE LP	Slot	SLOT#22 HIGHWAY 160 7-2 (1496'FNL & 1659'FEL)
Area	COLORADO	Well	HIGHWAY 160 7-2
Field	WELD COUNTY (KERR MCGEE)	Wellbore	HIGHWAY 160 7-2 AWB
Facility	SEC.02-T1N-R66W		

WELLPATH COMMENTS

MD [ft]	Inclination [°]	Azimuth [°]	TVD [ft]	Comment
8429.00	1.200	33.500	8329.88	LAST BHI MWD SURVEY
8485.00	1.200	33.500	8385.86	PROJECTION TO BIT