

WELL LOCATION CERTIFICATE

SECTION: 36
TOWNSHIP: 2N
RANGE: 47W

FOUND #5 REBAR WITH 1 1/2"
ALUMINUM CAP LS 17??

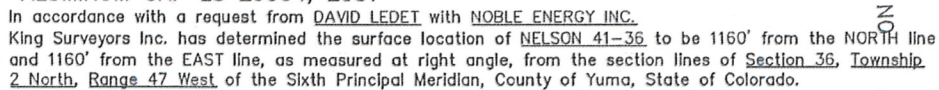

NOTE:

- SURFACE LOCATION

LEGEND

- ### NOTE

NEAREST PROPERTY LINE: 1160 NORTH & EAST

NT



10/1/2010

Michael Chad Dilka On Behalf Of King Surveyors, Inc.
Colorado Licensed Professional Land Surveyor #38106

PROJECT#: 2010378